

# Ground Floor

Approx. 59.7 sq. metres (642.9 sq. feet)

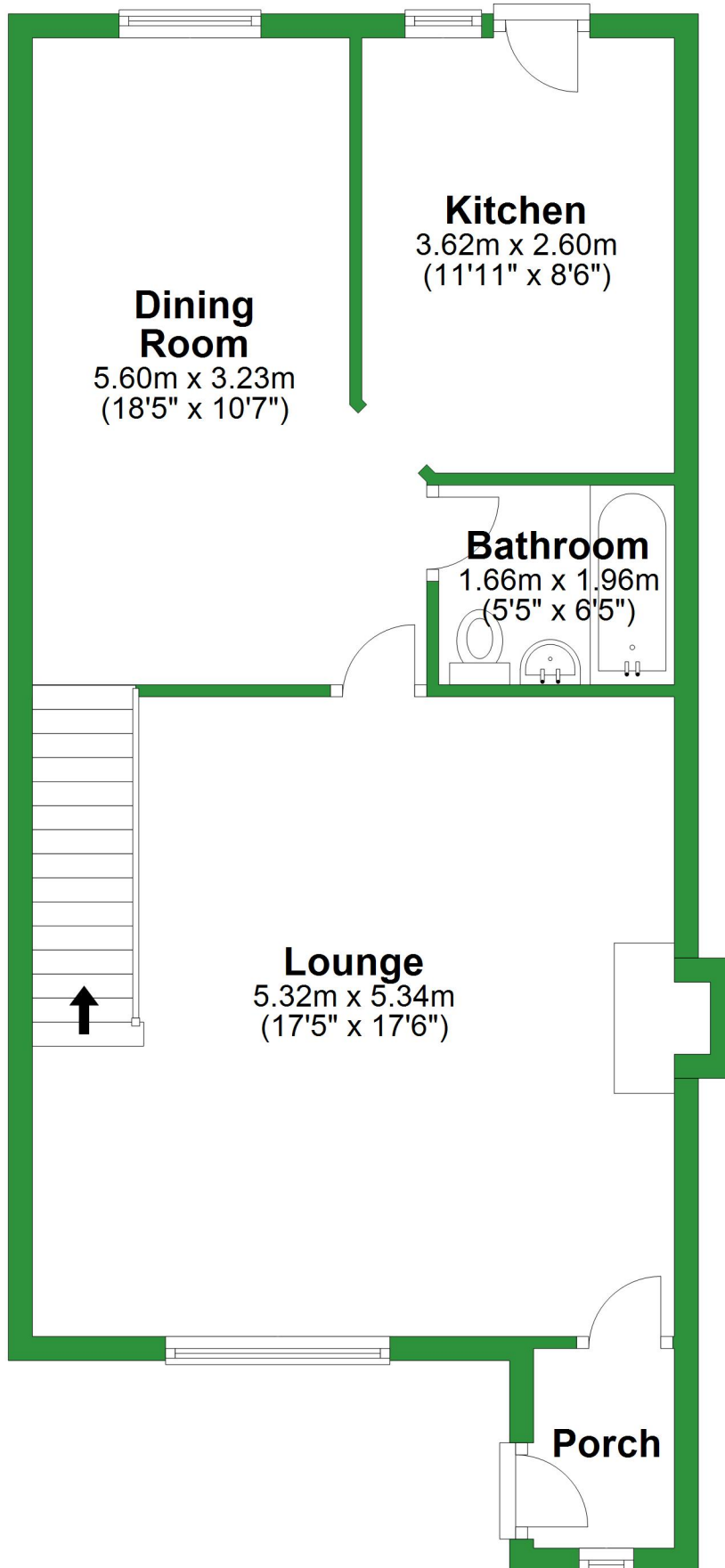

Total area: approx. 110.4 sq. metres (1188.1 sq. feet)

For illustrative purposes only. Not to scale. All sizes are approximate.  
Plan produced using PlanUp.

# First Floor

Approx. 50.6 sq. metres (545.2 sq. feet)

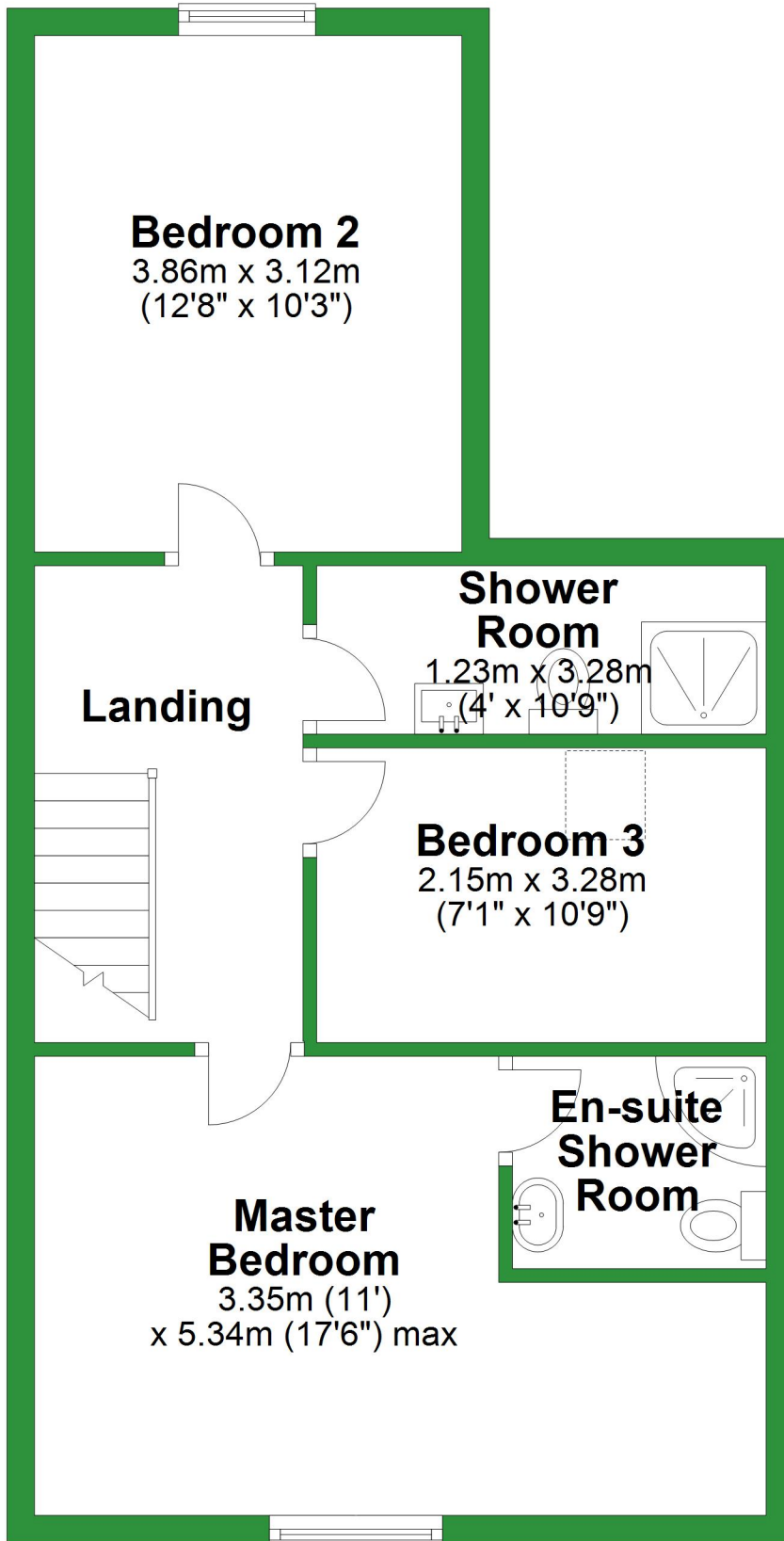

# Ground Floor

Approx. 59.7 sq. metres (642.9 sq. feet)

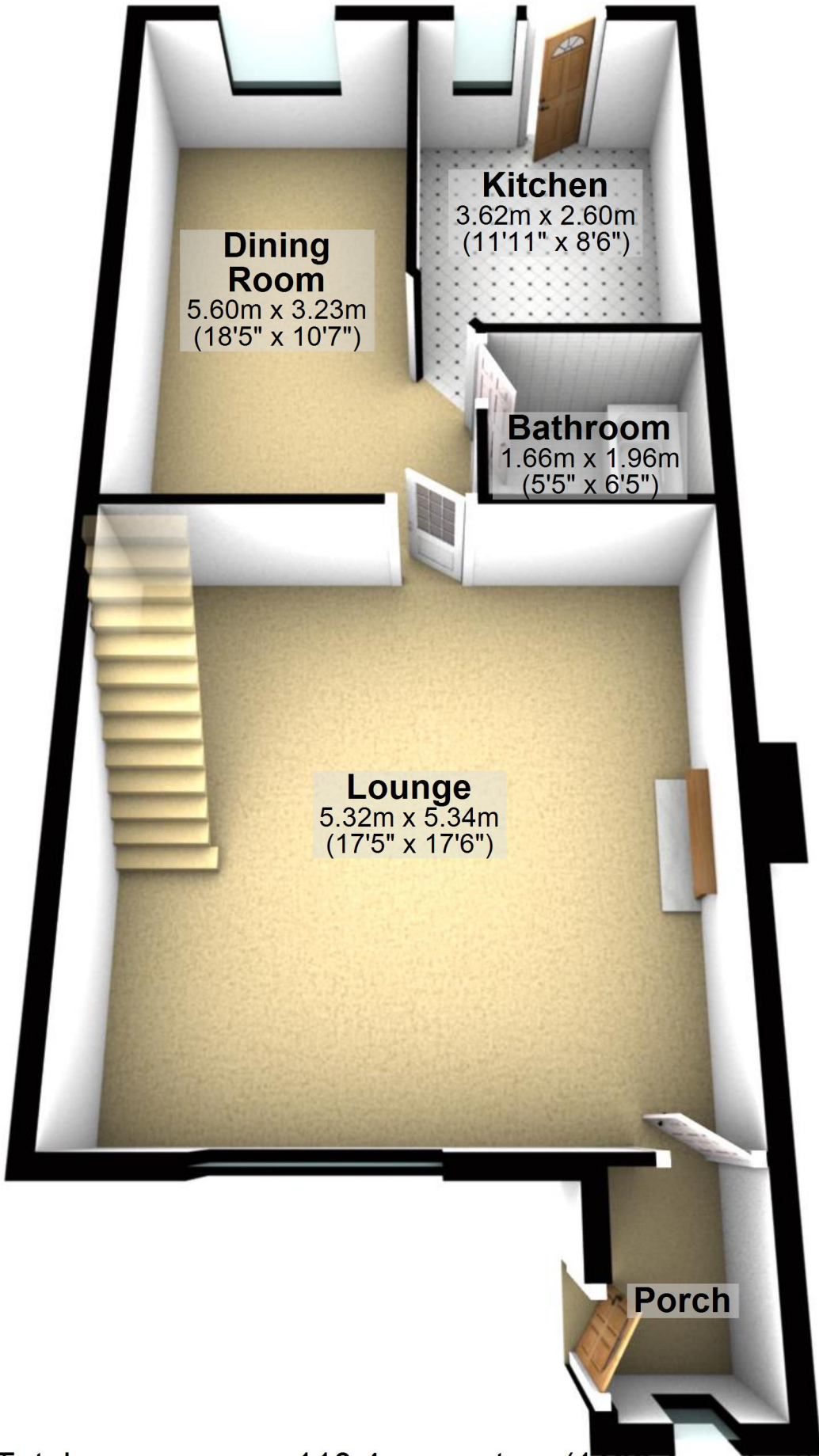

## Dining Room

5.60m x 3.23m  
(18'5" x 10'7")

## Kitchen

3.62m x 2.60m  
(11'11" x 8'6")

## Bathroom

1.66m x 1.96m  
(5'5" x 6'5")

## Lounge

5.32m x 5.34m  
(17'5" x 17'6")

## Porch

Total area: approx. 110.4 sq. metres (1188.1 sq. feet)

For illustrative purposes only. Not to scale. All sizes are approximate.

Plan produced using PlanUp.

# First Floor

Approx. 50.6 sq. metres (545.2 sq. feet)

