

# Ground Floor

Approx. 67.9 sq. metres (730.7 sq. feet)

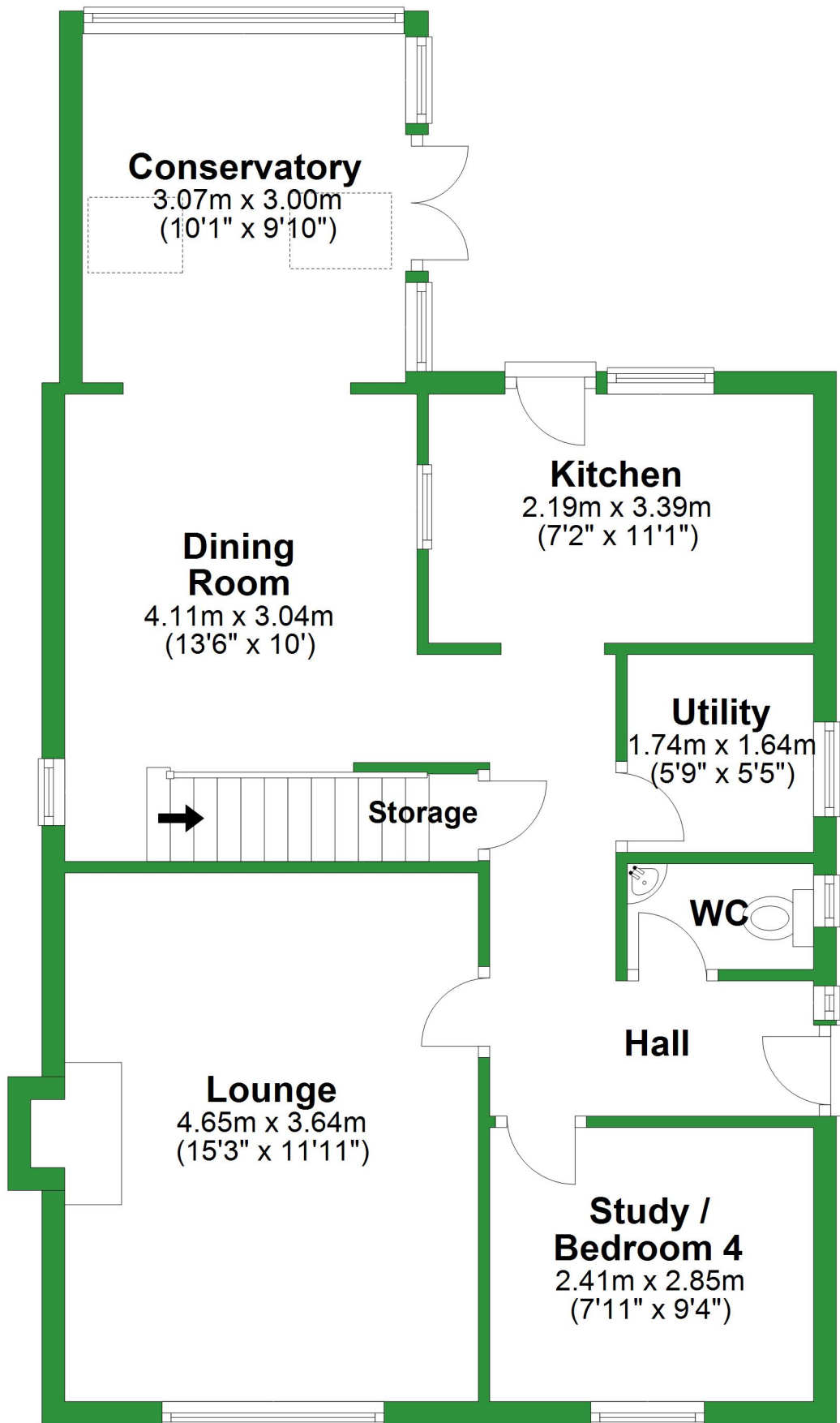

Total area: approx. 112.7 sq. metres (1213.1 sq. feet)

For illustrative purposes only. Not to scale. All sizes are approximate.  
Plan produced using PlanUp.

# First Floor

Approx. 44.8 sq. metres (482.4 sq. feet)

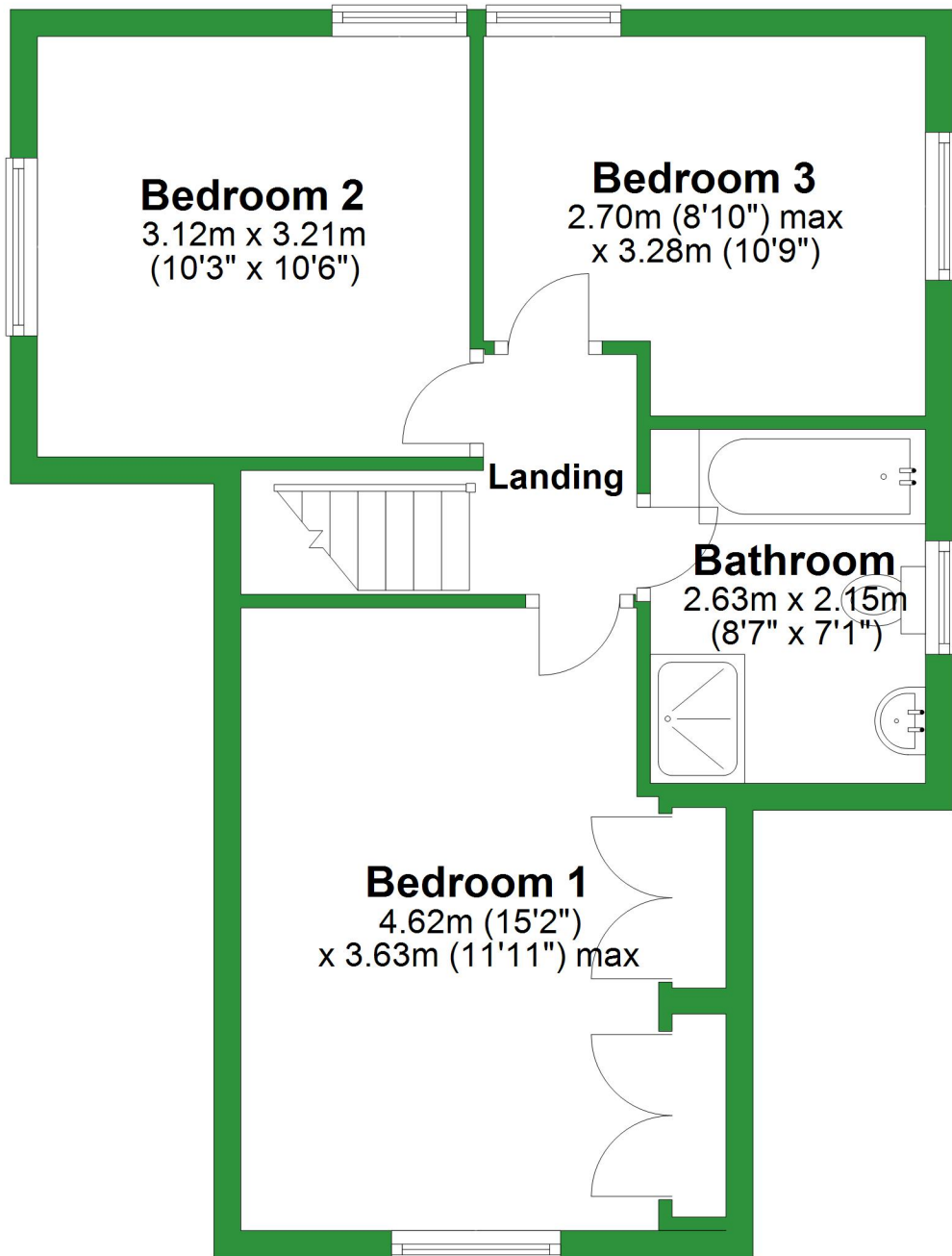

# Ground Floor

Approx. 67.9 sq. metres (730.7 sq. feet)

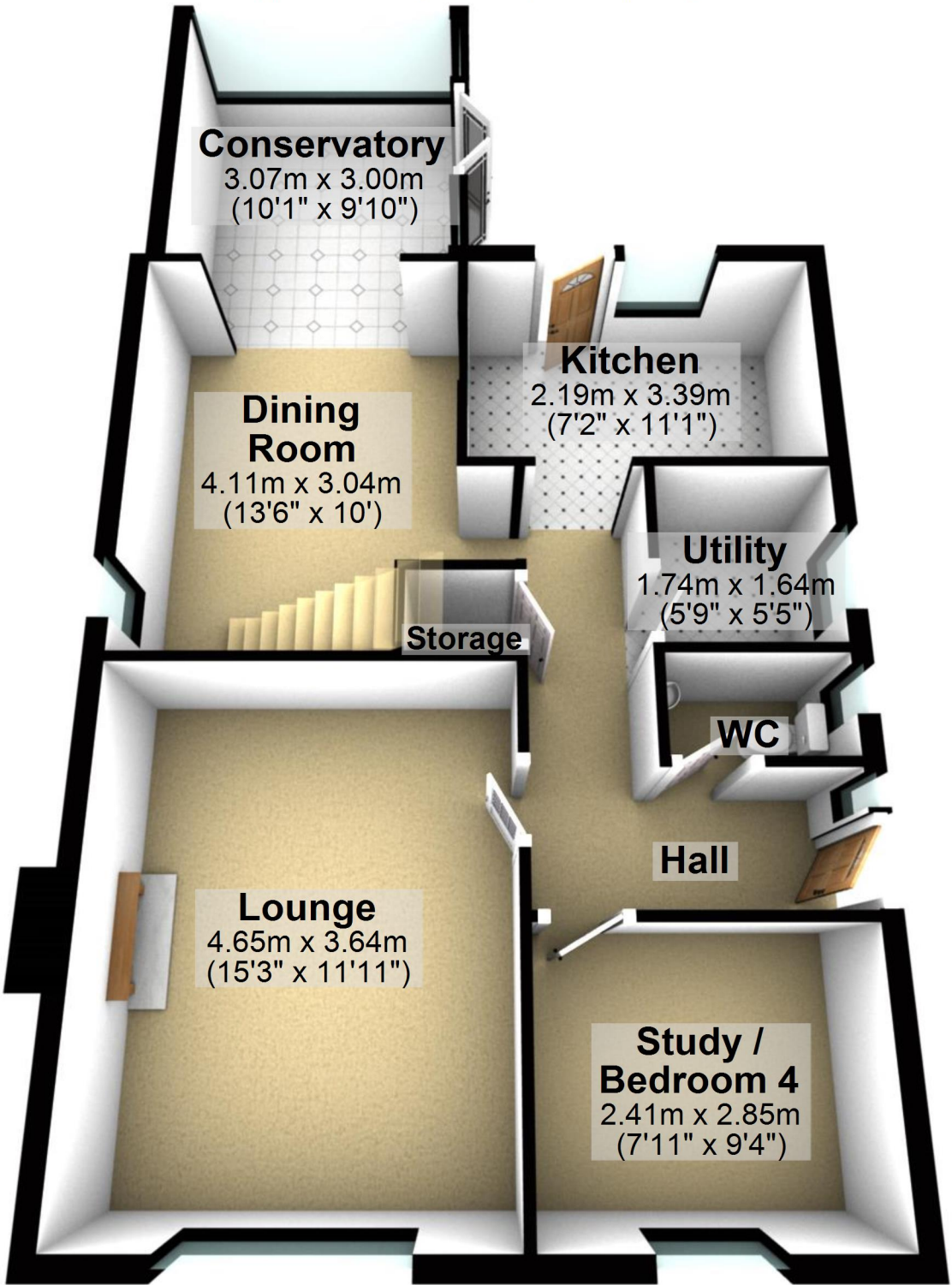

Total area: approx. 112.7 sq. metres (1213.1 sq. feet)

For illustrative purposes only. Not to scale. All sizes are approximate.

Plan produced using PlanUp.

# First Floor

Approx. 44.8 sq. metres (482.4 sq. feet)

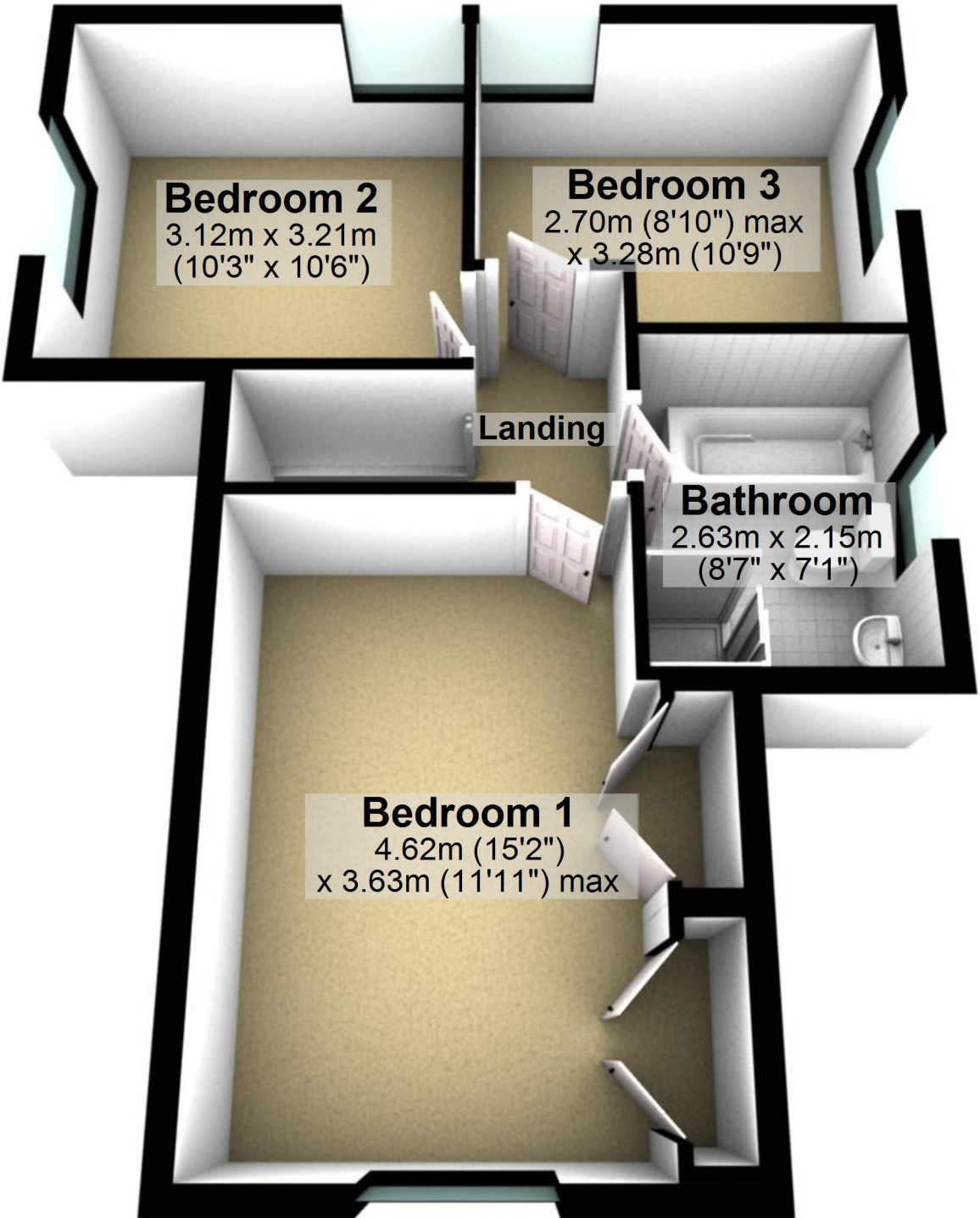

**Bedroom 2**  
3.12m x 3.21m  
(10'3" x 10'6")

**Bedroom 3**  
2.70m (8'10") max  
x 3.28m (10'9")

**Landing**

**Bathroom**  
2.63m x 2.15m  
(8'7" x 7'1")

**Bedroom 1**  
4.62m (15'2")  
x 3.63m (11'11") max