

# Ground Floor

Approx. 40.3 sq. metres (433.7 sq. feet)

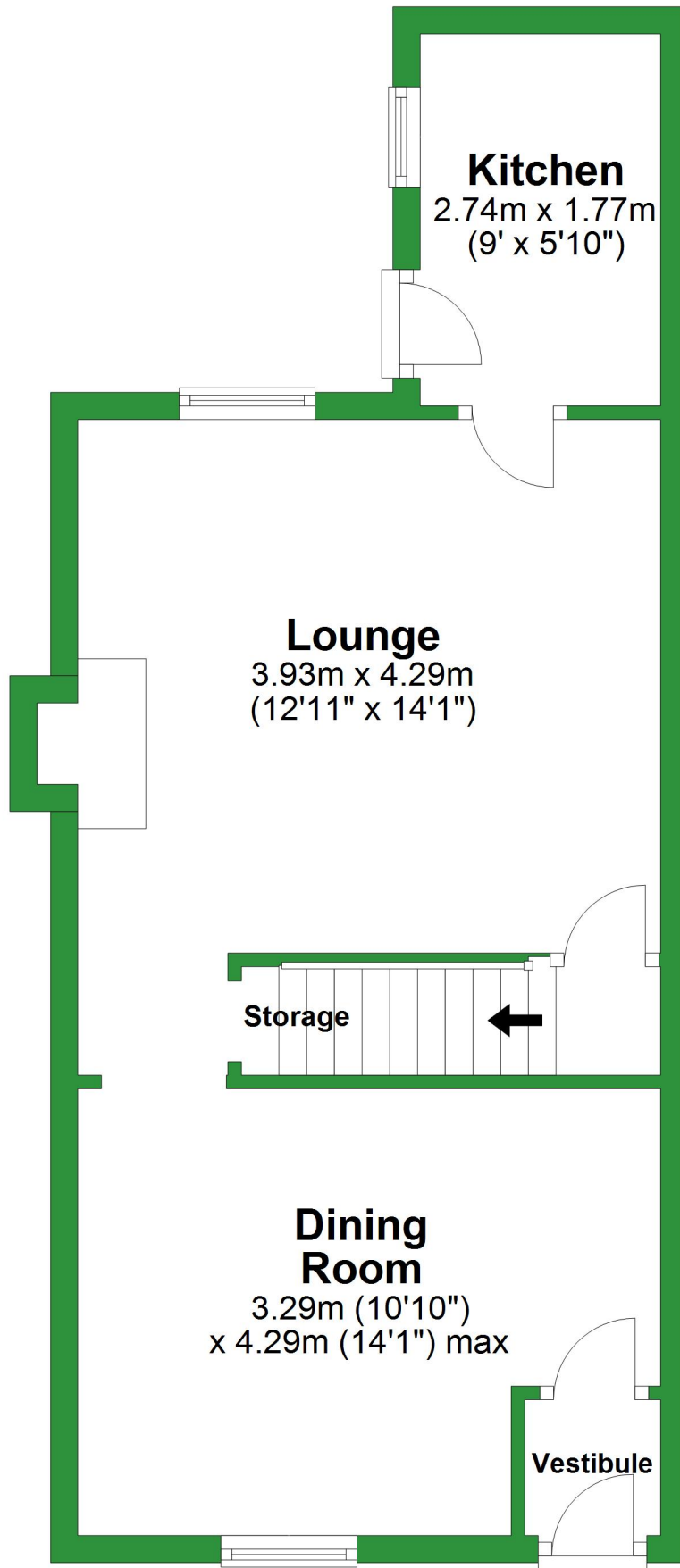

Total area: approx. 75.4 sq. metres (812.0 sq. feet)

For illustrative purposes only. Not to scale. All sizes are approximate.  
Plan produced using PlanUp.

# First Floor

Approx. 35.1 sq. metres (378.3 sq. feet)

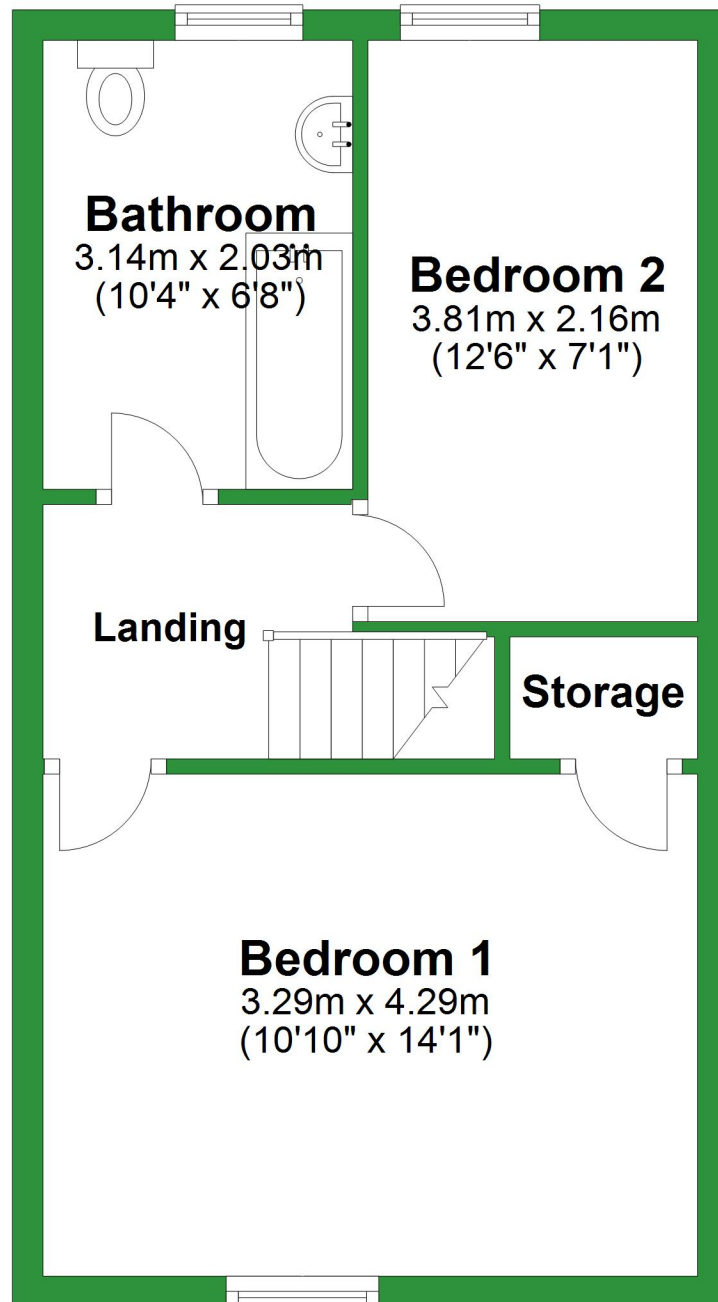

# Ground Floor

Approx. 40.3 sq. metres (433.7 sq. feet)

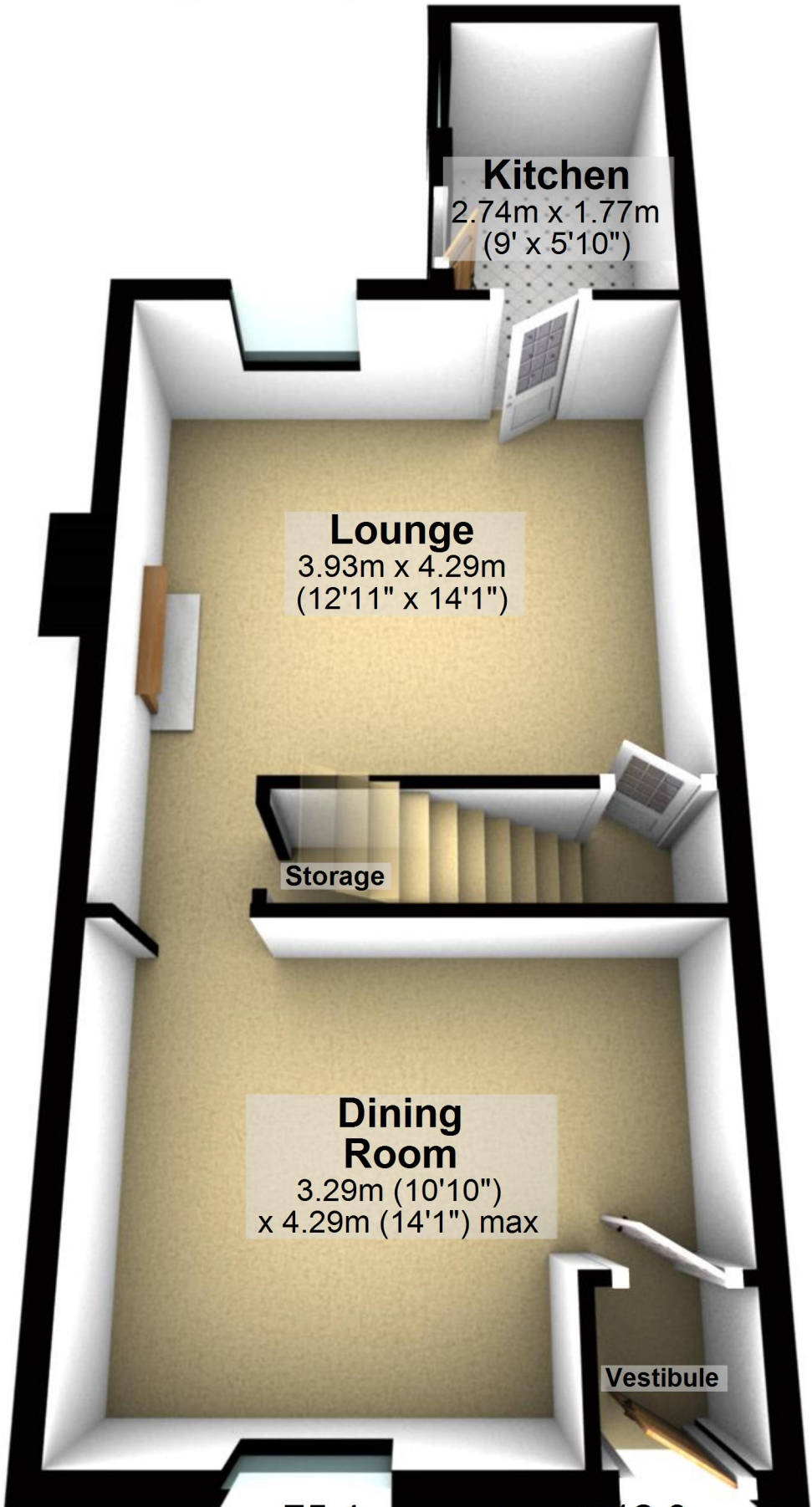

Total area: approx. 75.4 sq. metres (812.0 sq. feet)

For illustrative purposes only. Not to scale. All sizes are approximate.

Plan produced using PlanUp.

# First Floor

Approx. 35.1 sq. metres (378.3 sq. feet)

