

# Ground Floor

Approx. 46.1 sq. metres (496.5 sq. feet)

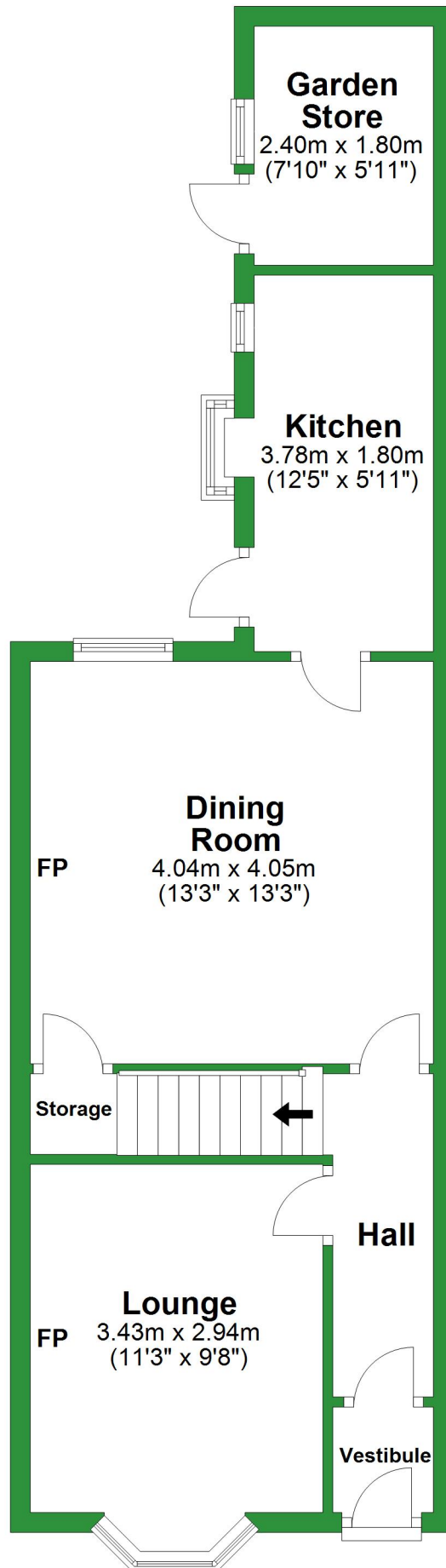

Total area: approx. 80.7 sq. metres (869.1 sq. feet)

For illustrative purposes only. Not to scale. All sizes are approximate.  
Plan produced using PlanUp.

## First Floor

Approx. 34.6 sq. metres (372.6 sq. feet)

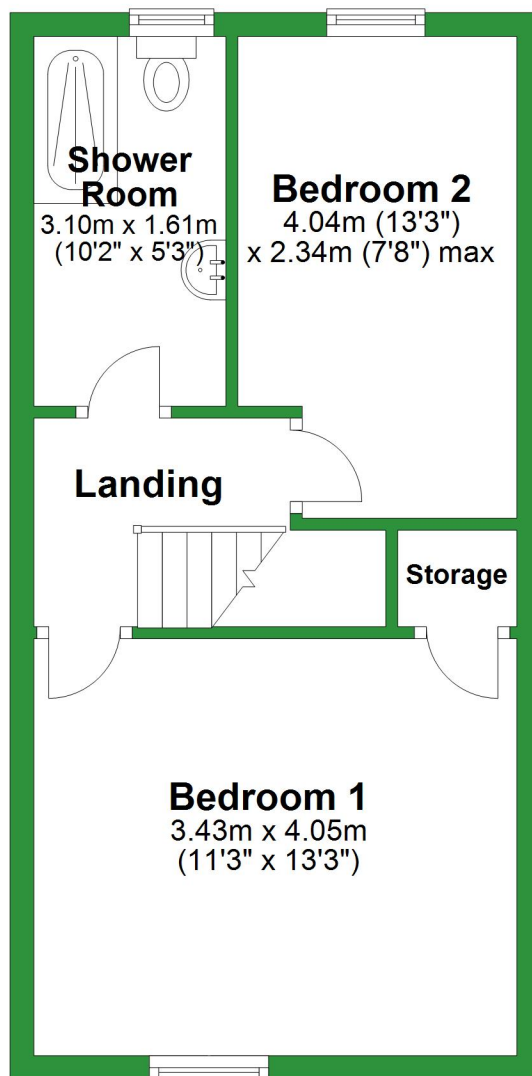

# Ground Floor

Approx. 46.1 sq. metres (496.5 sq. feet)

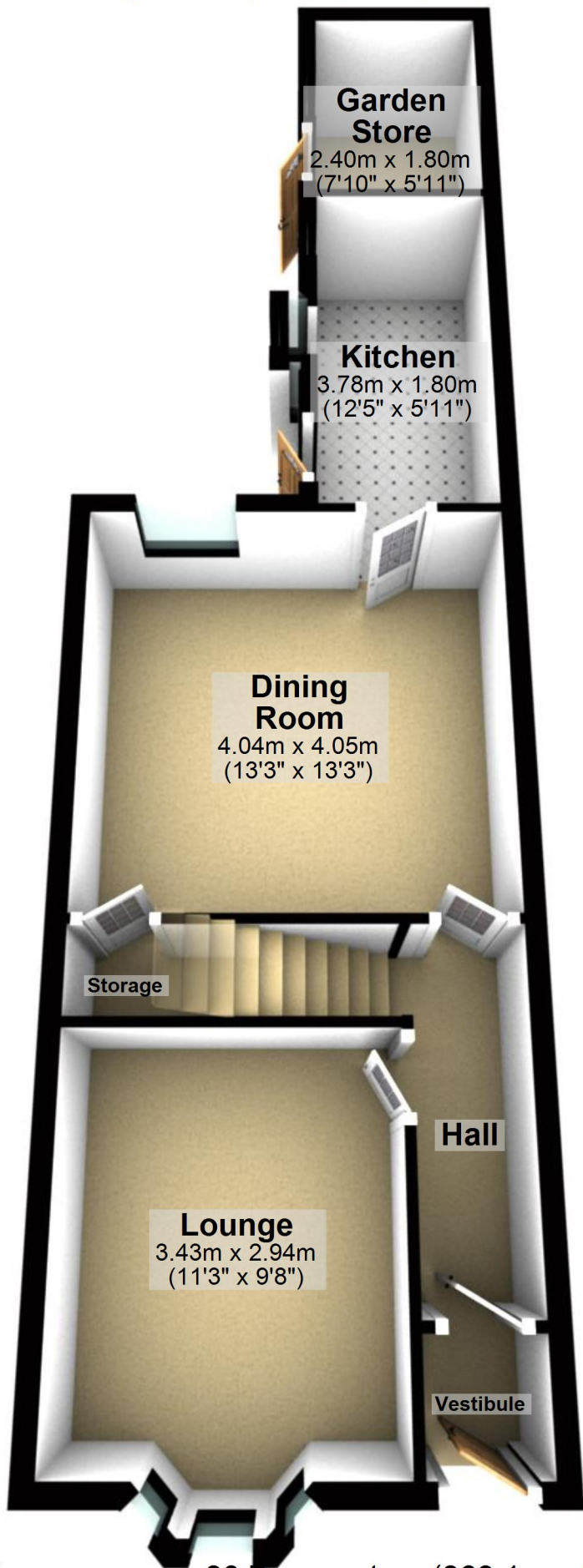

Total area: approx. 80.7 sq. metres (869.1 sq. feet)

For illustrative purposes only. Not to scale. All sizes are approximate.

Plan produced using PlanUp.

# First Floor

Approx. 34.6 sq. metres (372.6 sq. feet)

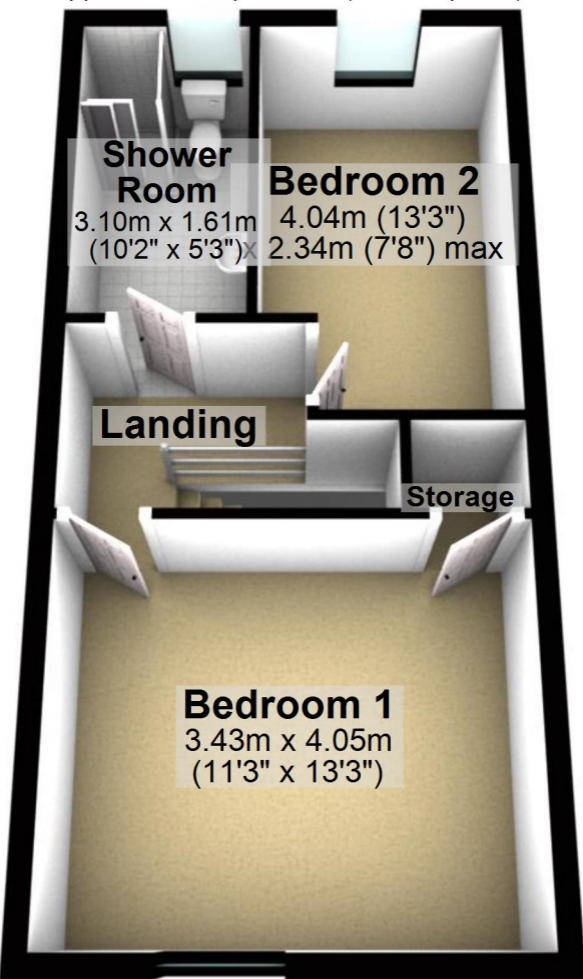

**Shower Room**

3.10m x 1.61m  
(10'2" x 5'3")

**Bedroom 2**

4.04m (13'3")  
2.34m (7'8") max

**Landing**

**Storage**

**Bedroom 1**

3.43m x 4.05m  
(11'3" x 13'3")