

# Ground Floor

Approx. 37.6 sq. metres (404.6 sq. feet)

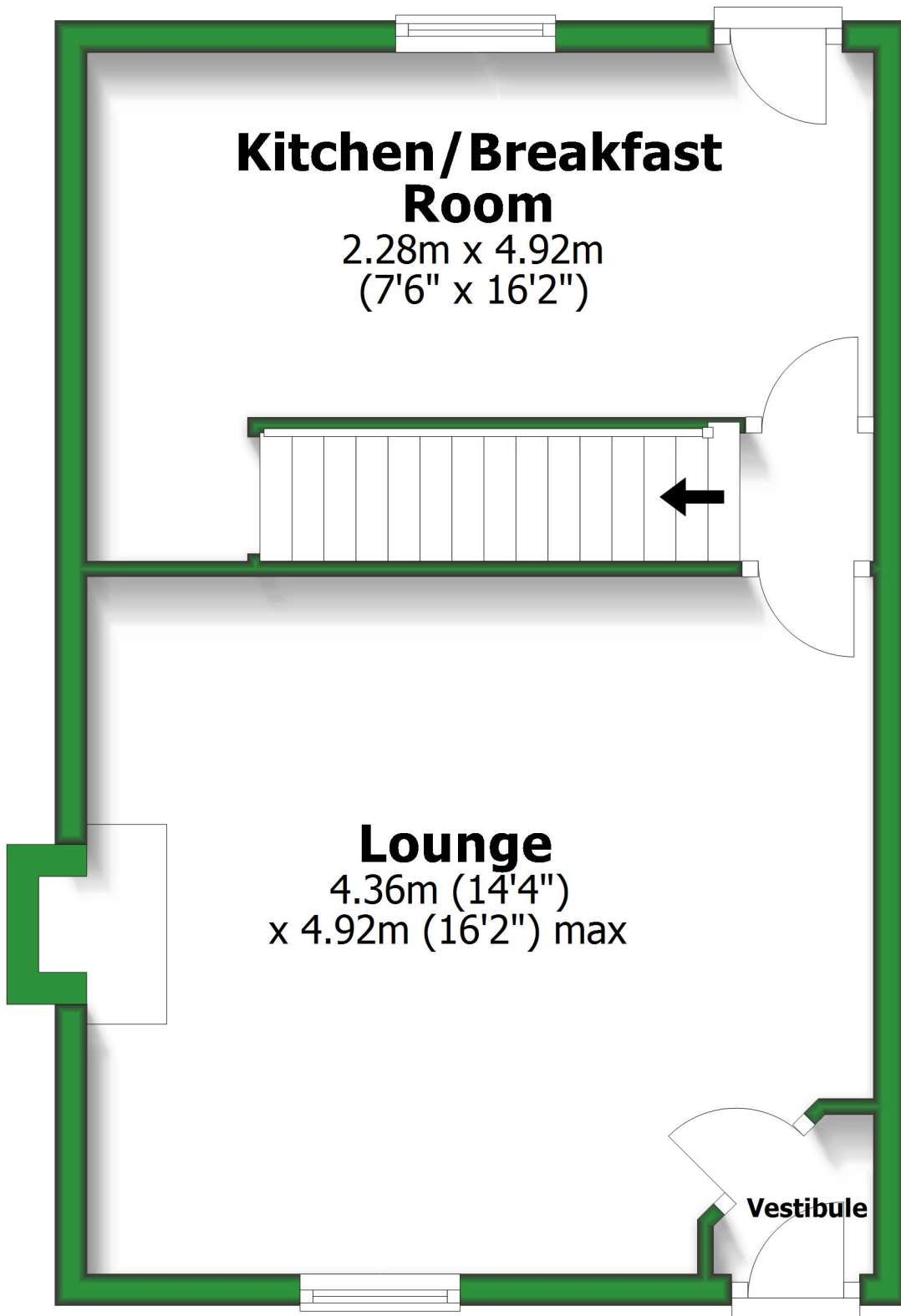

Total area: approx. 103.2 sq. metres (1110.5 sq. feet)

For illustrative purposes only. Not to scale. All sizes are approximate.

Plan produced using PlanUp.

# First Floor

Approx. 37.6 sq. metres (404.6 sq. feet)

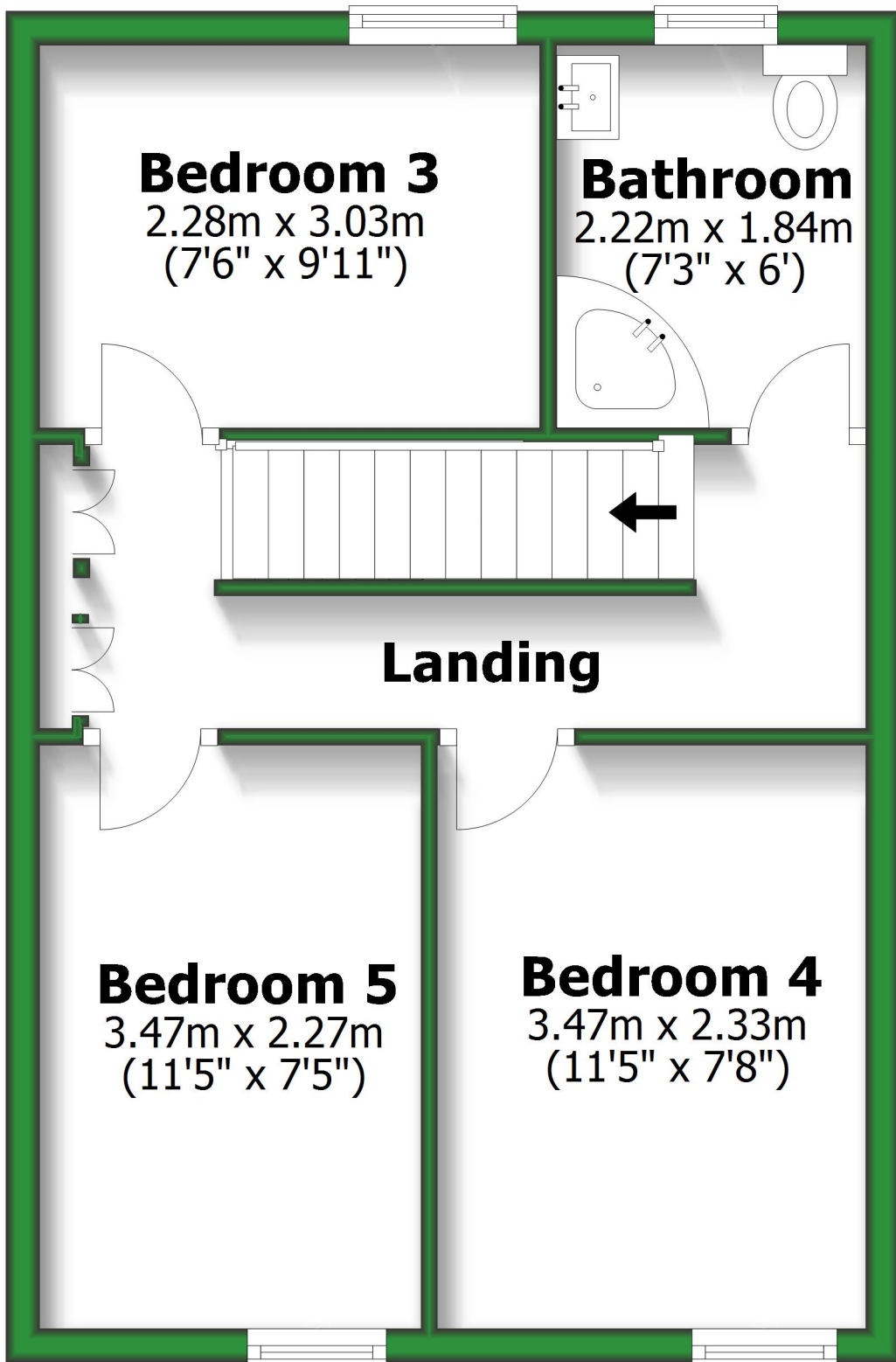

Approx. 28.0 sq. metres (301.3 sq. feet)

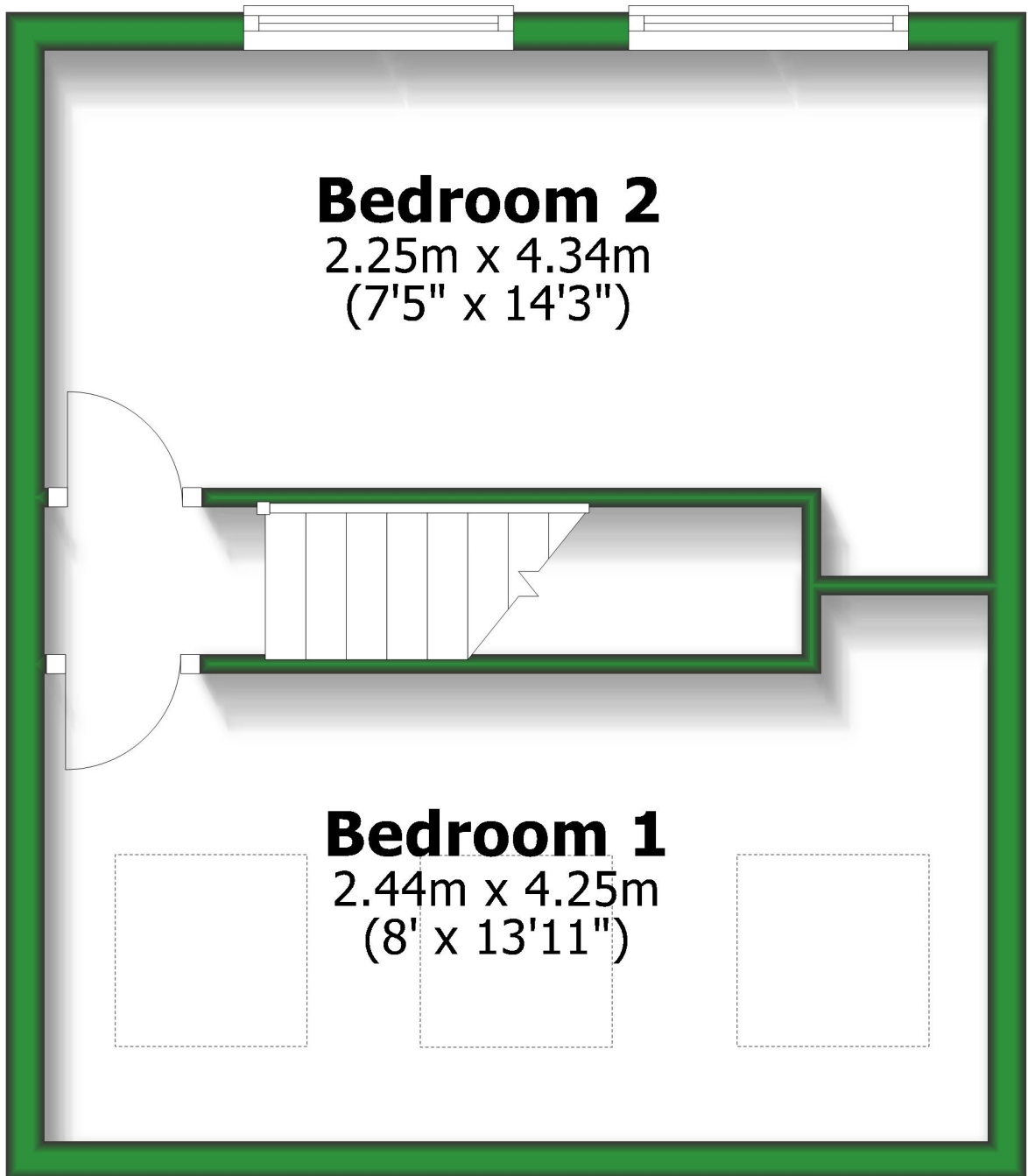

# Ground Floor

Approx. 37.6 sq. metres (404.6 sq. feet)

## Kitchen/Breakfast Room

2.28m x 4.92m  
(7'6" x 16'2")

## Lounge

4.36m (14'4")  
x 4.92m (16'2") max

Vestibule

Total area: approx. 103.2 sq. metres (1110.5 sq. feet)

For illustrative purposes only. Not to scale. All sizes are approximate.

Plan produced using PlanUp.

# First Floor

Approx. 37.6 sq. metres (404.6 sq. feet)

## Bedroom 3

2.28m x 3.03m  
(7'6" x 9'11")

## Bathroom

2.22m x 1.84m  
(7'3" x 6')

## Landing

## Bedroom 5

3.47m x 2.27m  
(11'5" x 7'5")

## Bedroom 4

3.47m x 2.33m  
(11'5" x 7'8")

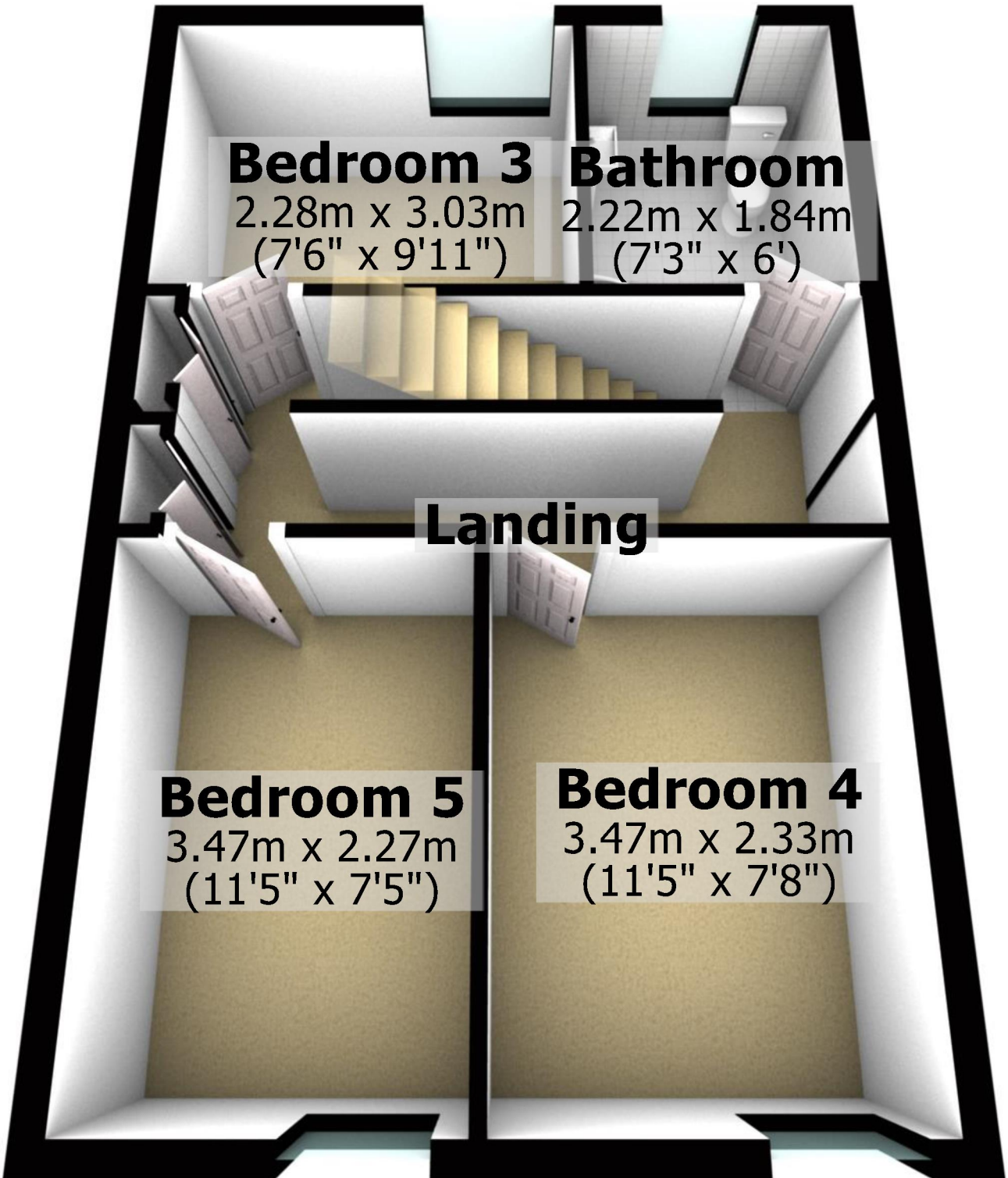



# Second Floor

Approx. 28.0 sq. metres (301.3 sq. feet)

## Bedroom 2

2.25m x 4.34m  
(7'5" x 14'3")

## Bedroom 1

2.44m x 4.25m  
(8' x 13'11")

