

# Ground Floor

Approx. 59.3 sq. metres (638.7 sq. feet)

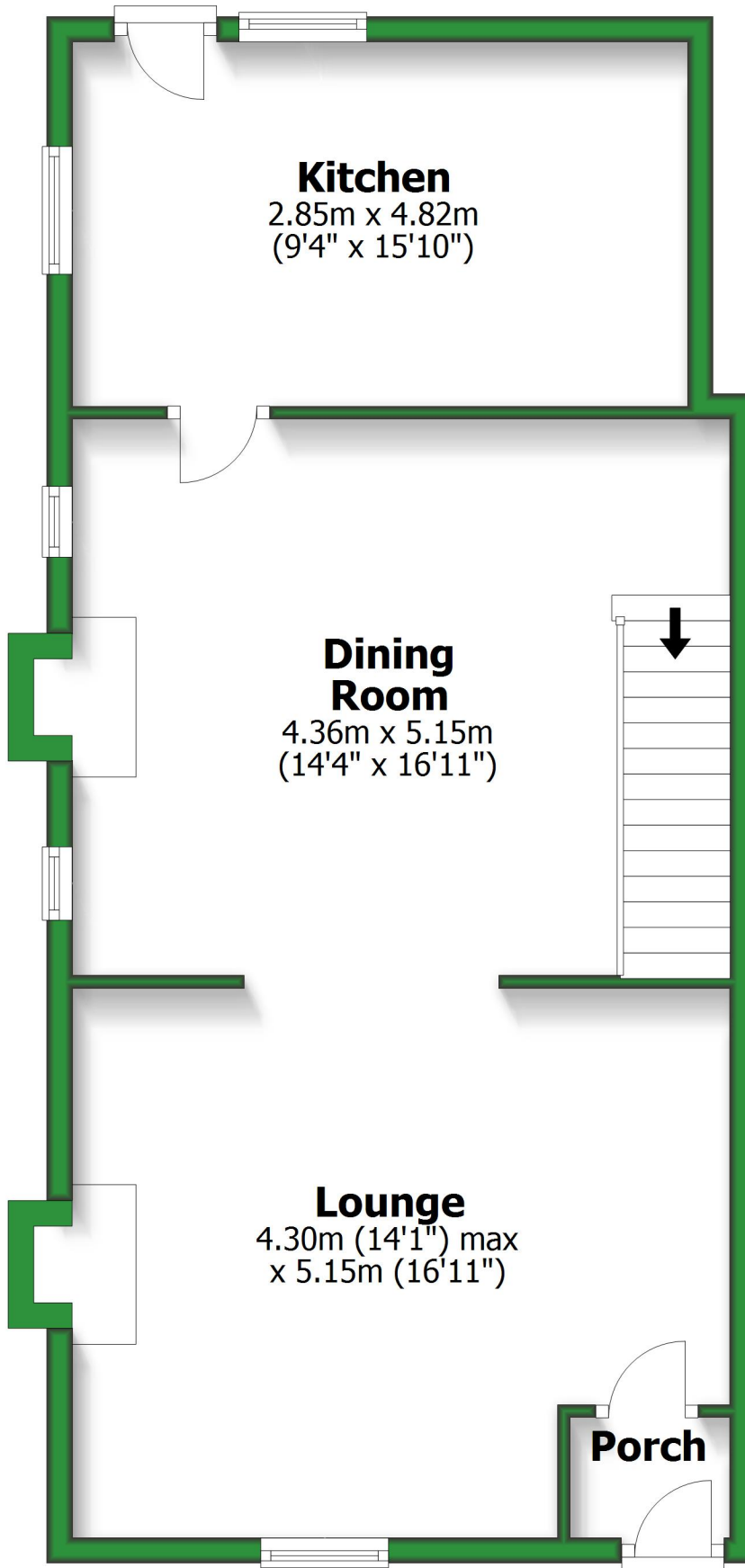

Total area: approx. 102.7 sq. metres (1105.0 sq. feet)

For illustrative purposes only. Not to scale. All sizes are approximate.  
Plan produced using PlanUp.

# First Floor

Approx. 43.3 sq. metres (466.4 sq. feet)

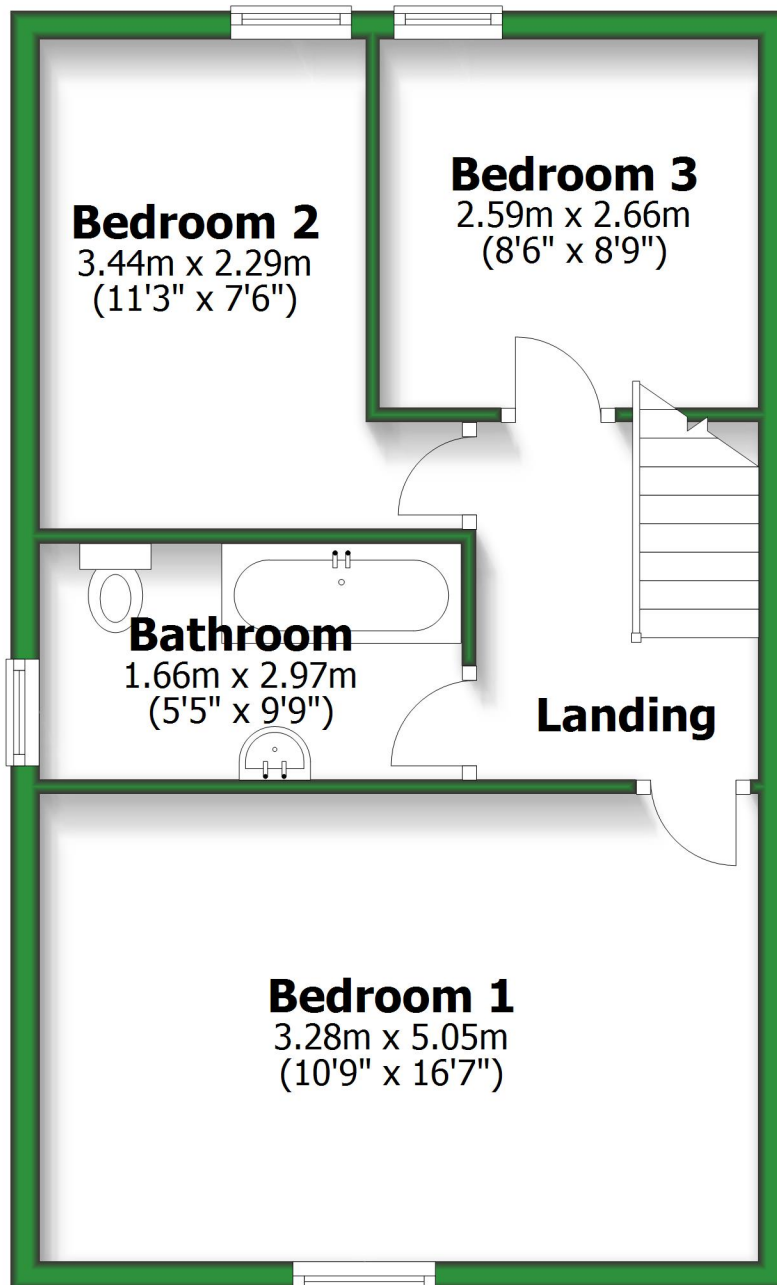

# Ground Floor

Approx. 59.3 sq. metres (638.7 sq. feet)

## Kitchen

2.85m x 4.82m  
(9'4" x 15'10")

## Dining Room

4.36m x 5.15m  
(14'4" x 16'11")

## Lounge

4.30m (14'1" max)  
x 5.15m (16'11")

## Porch

Total area: approx. 102.7 sq. metres (1105.0 sq. feet)

For illustrative purposes only. Not to scale. All sizes are approximate.

Plan produced using PlanUp.

# First Floor

Approx. 43.3 sq. metres (466.4 sq. feet)

## Bedroom 2

3.44m x 2.29m  
(11'3" x 7'6")

## Bedroom 3

2.59m x 2.66m  
(8'6" x 8'9")

## Bathroom

1.66m x 2.97m  
(5'5" x 9'9")

## Landing

## Bedroom 1

3.28m x 5.05m  
(10'9" x 16'7")

