

# Ground Floor

Approx. 39.9 sq. metres (429.5 sq. feet)

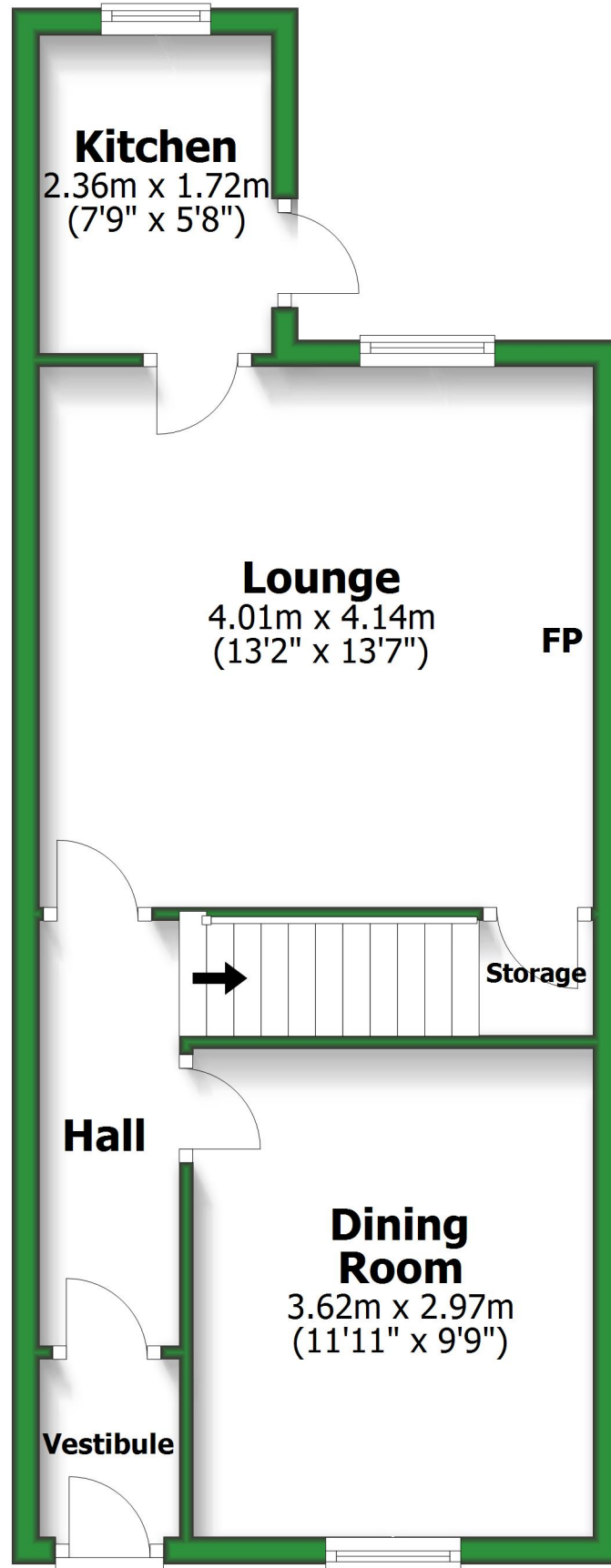

Total area: approx. 75.6 sq. metres (813.8 sq. feet)

For illustrative purposes only. Not to scale. All sizes are approximate.  
Plan produced using PlanUp.

# First Floor

Approx. 35.7 sq. metres (384.3 sq. feet)

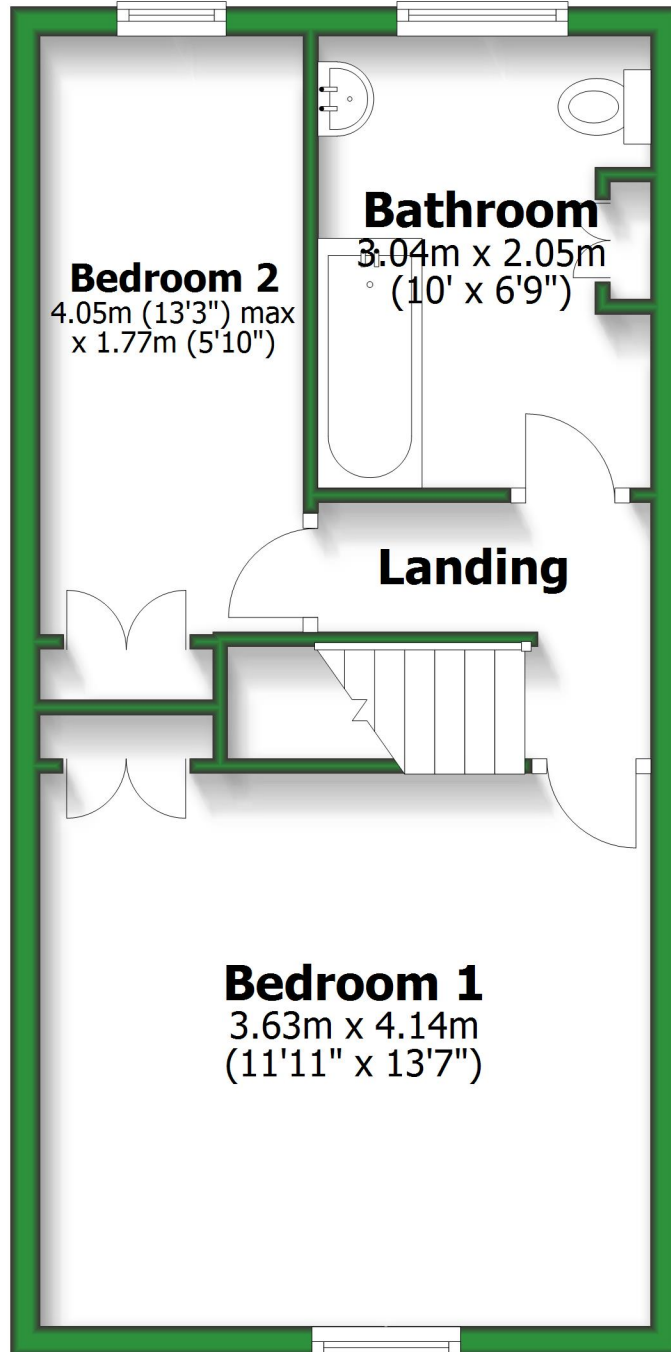

# Ground Floor

Approx. 39.9 sq. metres (429.5 sq. feet)

## Kitchen

2.36m x 1.72m  
(7'9" x 5'8")

## Lounge

4.01m x 4.14m  
(13'2" x 13'7")

Storage

## Hall

## Dining Room

3.62m x 2.97m  
(11'11" x 9'9")

Vestibule

Total area: approx. 75.6 sq. metres (813.8 sq. feet)

For illustrative purposes only. Not to scale. All sizes are approximate.

Plan produced using PlanUp.

# First Floor

Approx. 35.7 sq. metres (384.3 sq. feet)

