

# Ground Floor

Approx. 78.3 sq. metres (842.5 sq. feet)

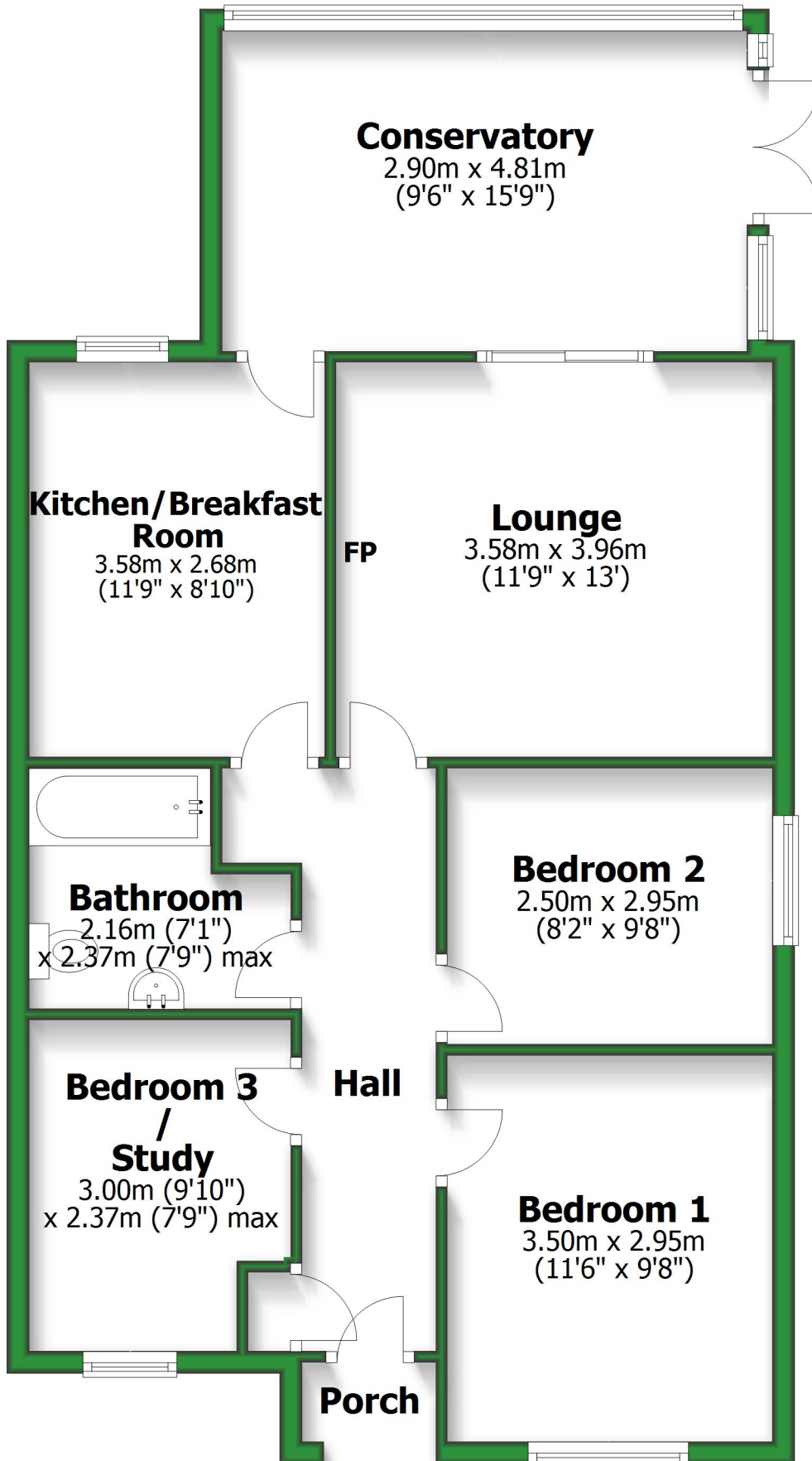

Total area: approx. 78.3 sq. metres (842.5 sq. feet)

For illustrative purposes only. Not to scale. All sizes are approximate.  
Plan produced using PlanUp.

# Ground Floor

Approx. 78.3 sq. metres (842.5 sq. feet)

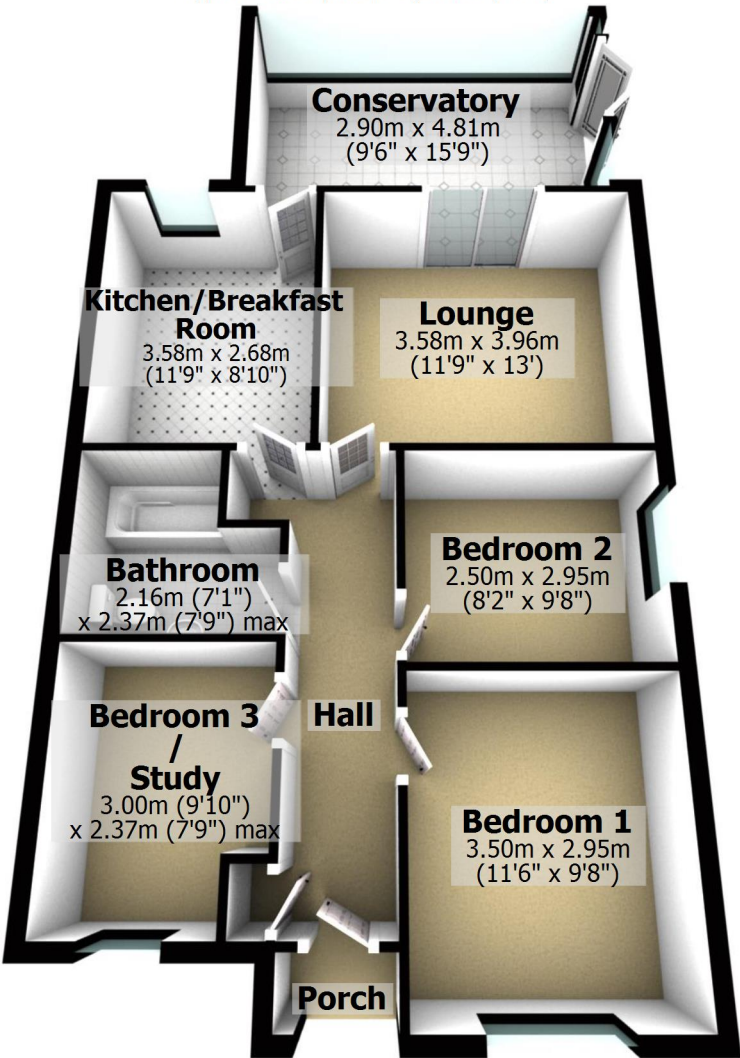

Total area: approx. 78.3 sq. metres (842.5 sq. feet)

For illustrative purposes only. Not to scale. All sizes are approximate.

Plan produced using PlanUp.

# Ground Floor

Approx. 31.5 sq. metres (339.3 sq. feet)

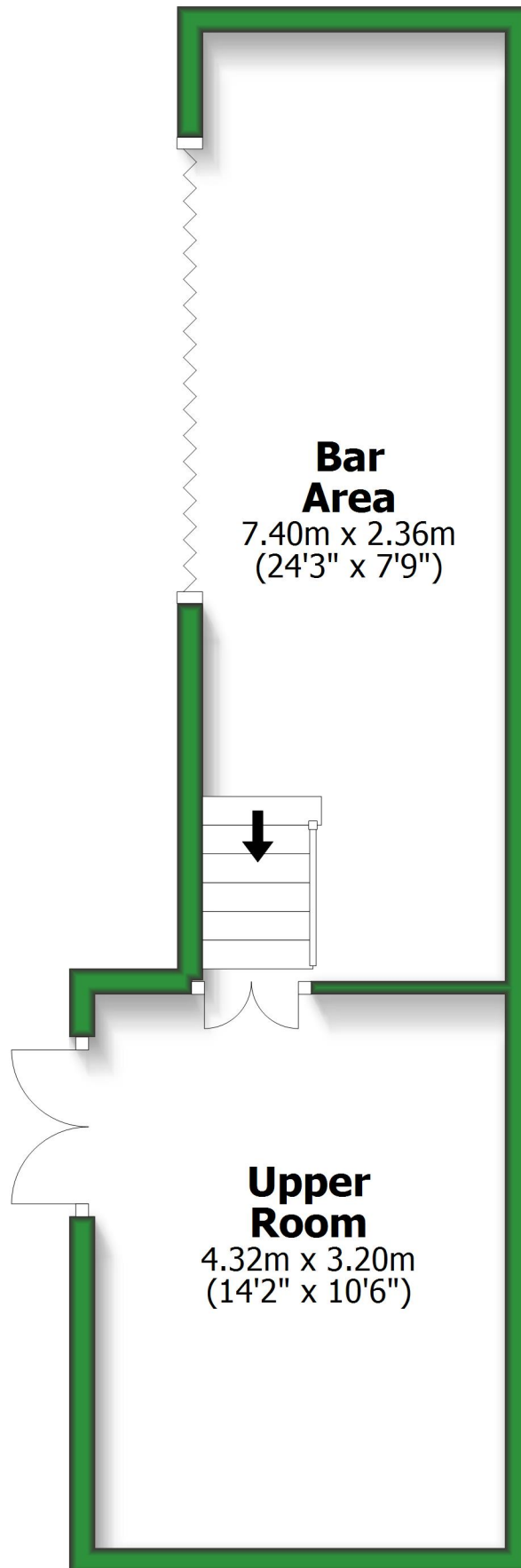

Total area: approx. 31.5 sq. metres (339.3 sq. feet)

For illustrative purposes only. Not to scale. All sizes are approximate.  
Plan produced using PlanUp.

# Ground Floor

Approx. 31.5 sq. metres (339.3 sq. feet)

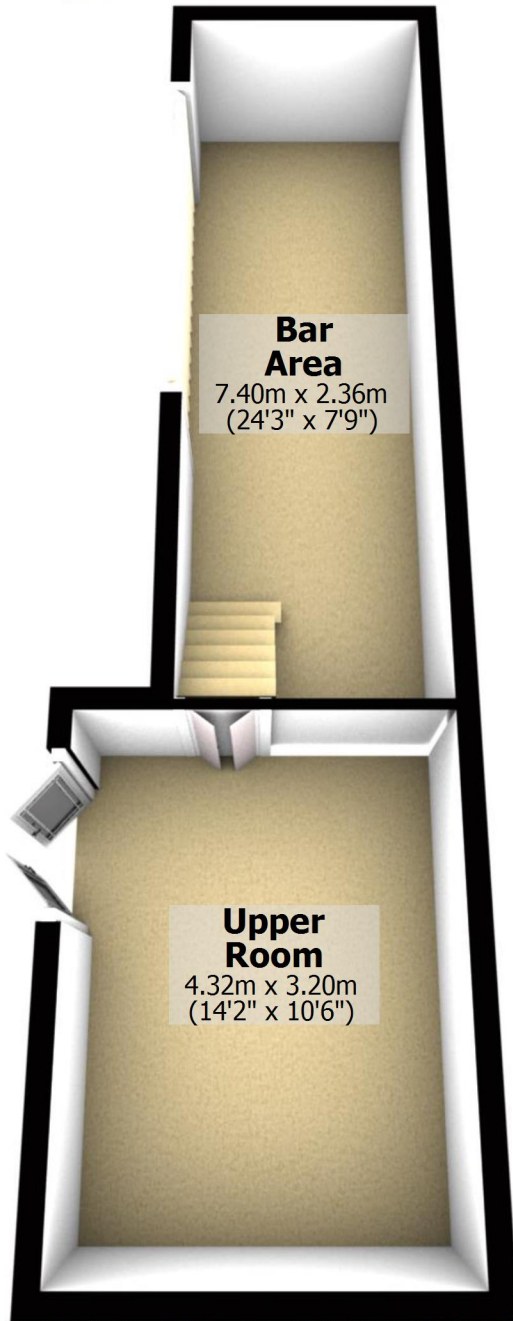

Total area: approx. 31.5 sq. metres (339.3 sq. feet)

For illustrative purposes only. Not to scale. All sizes are approximate.

Plan produced using PlanUp.