

# Ground Floor

Approx. 110.4 sq. metres (1188.3 sq. feet)

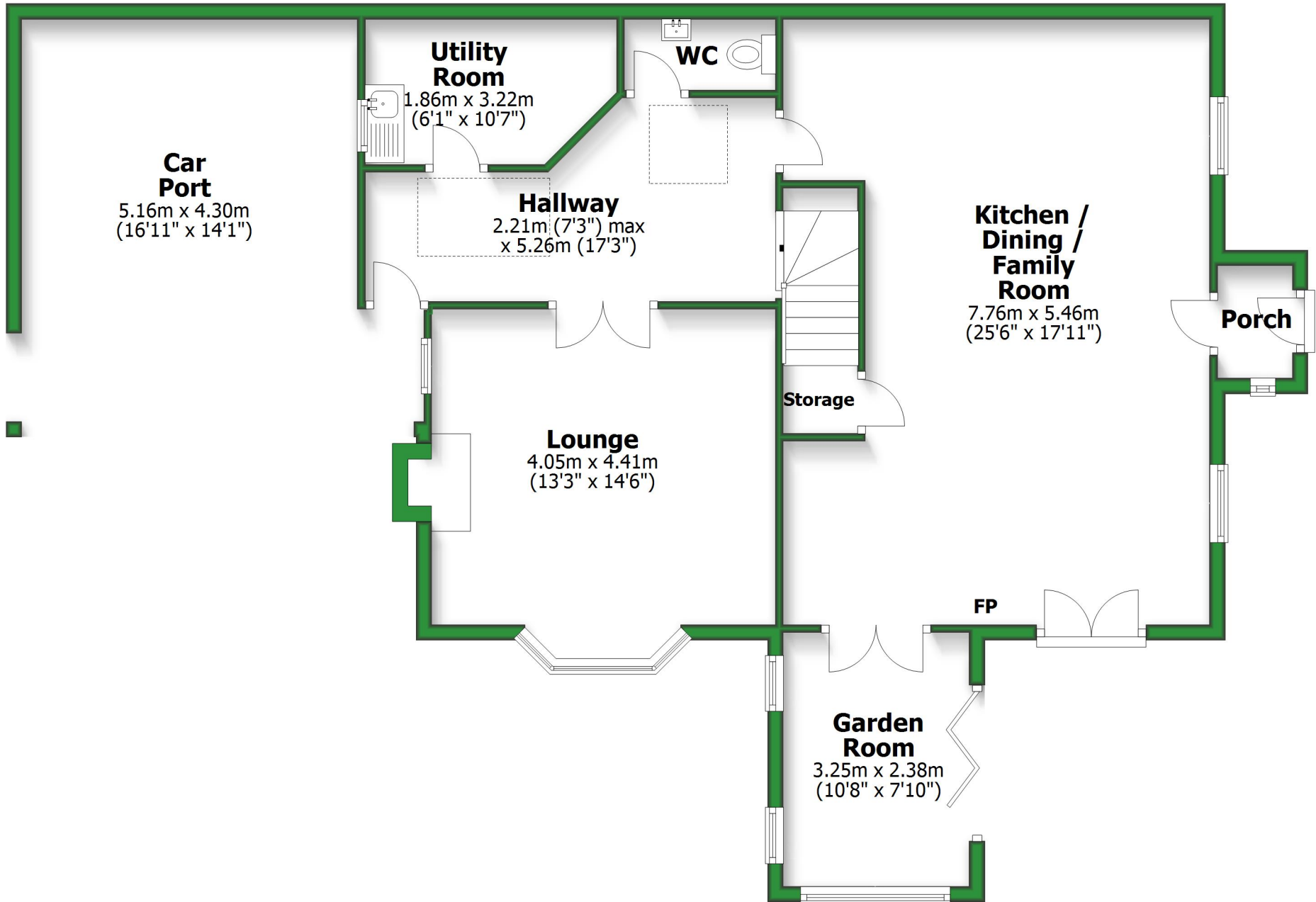

Total area: approx. 171.0 sq. metres (1840.2 sq. feet)

For illustrative purposes only. Not to scale. All sizes are approximate.

Plan produced using PlanUp.

# First Floor

Approx. 60.6 sq metres (651.9 sq. feet)

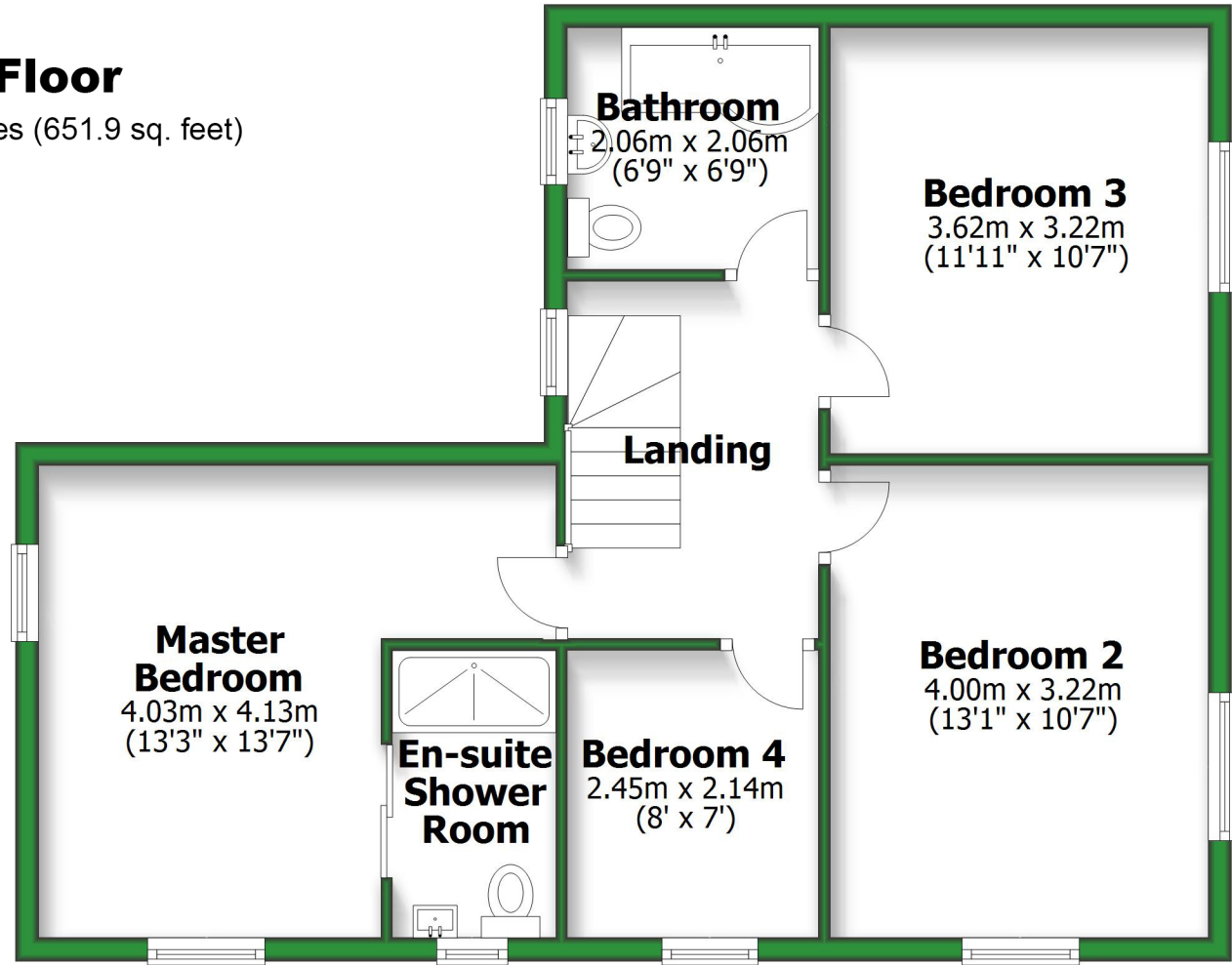

# Ground Floor

Approx. 110.4 sq. metres (1188.3 sq. feet)

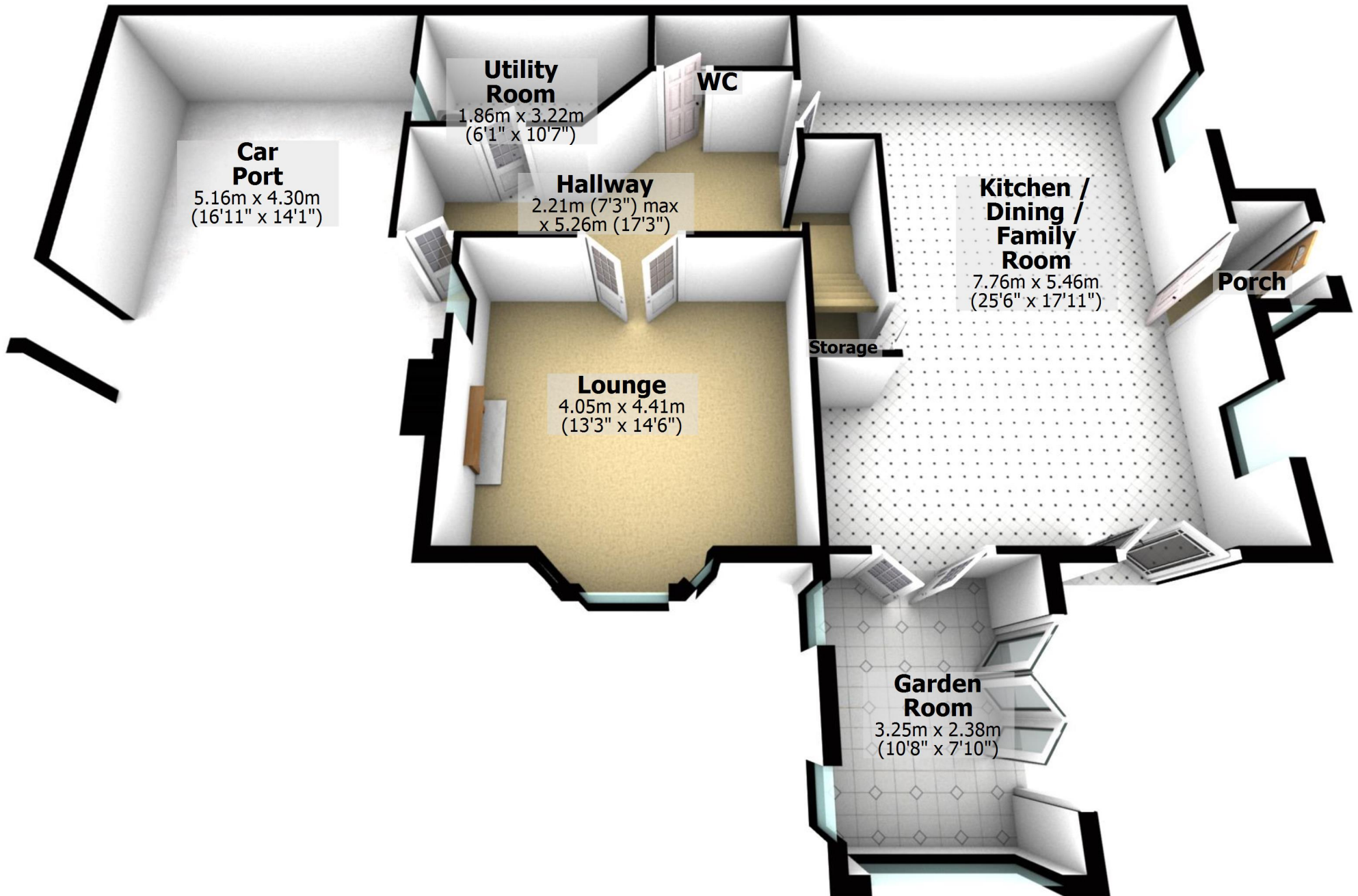

Total area: approx. 171.0 sq. metres (1840.2 sq. feet)

For illustrative purposes only. Not to scale. All sizes are approximate.  
Plan produced using PlanUp.

# First Floor

Approx. 60.6 sq. metres (651.9 sq. feet)

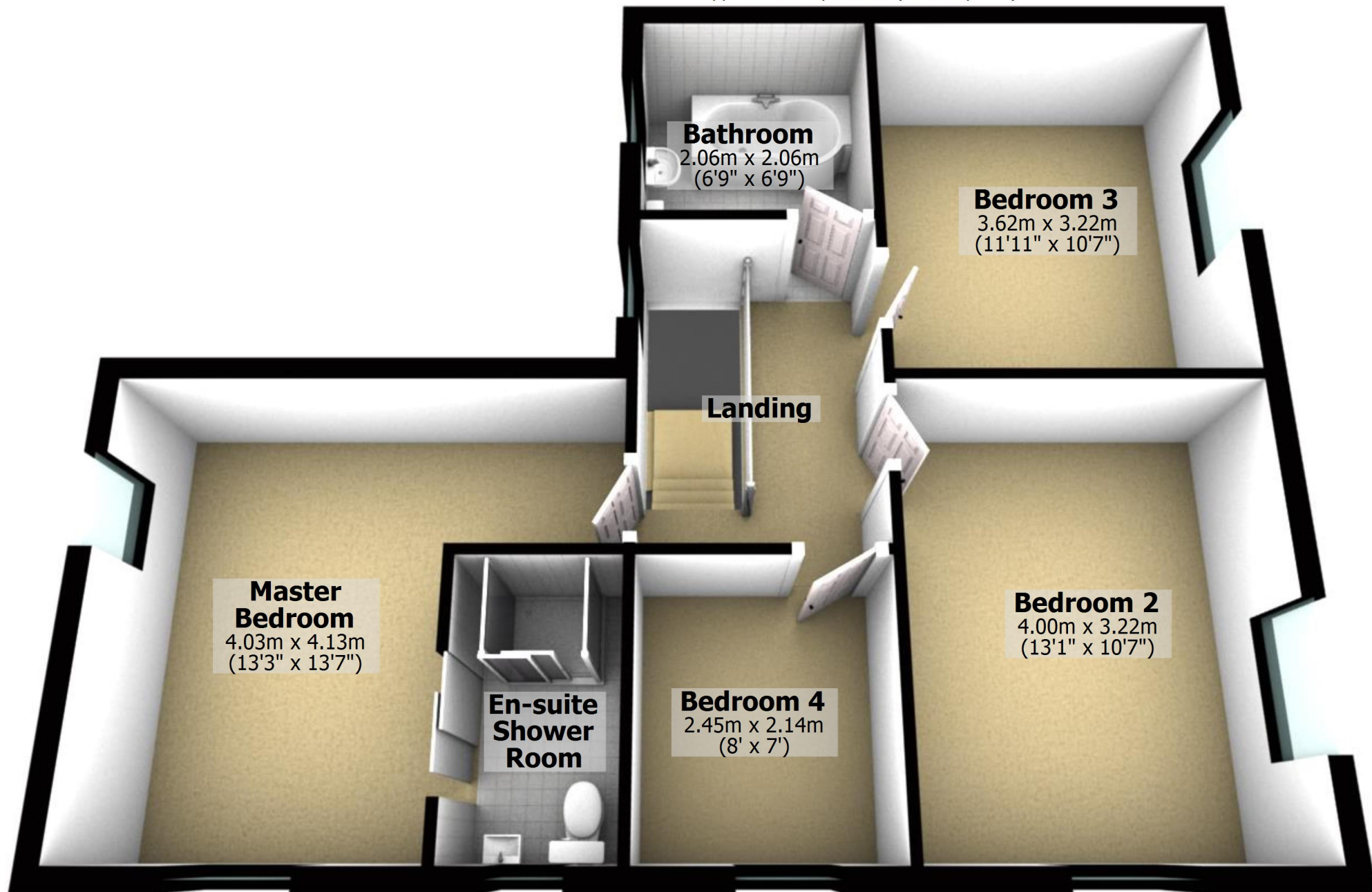

**Bathroom**  
2.06m x 2.06m  
(6'9" x 6'9")

**Bedroom 3**  
3.62m x 3.22m  
(11'11" x 10'7")

**Landing**

**Master Bedroom**  
4.03m x 4.13m  
(13'3" x 13'7")

**En-suite Shower Room**

**Bedroom 4**  
2.45m x 2.14m  
(8' x 7')

**Bedroom 2**  
4.00m x 3.22m  
(13'1" x 10'7")