

Ground Floor

Approx. 90.2 sq. metres (971.2 sq. feet)

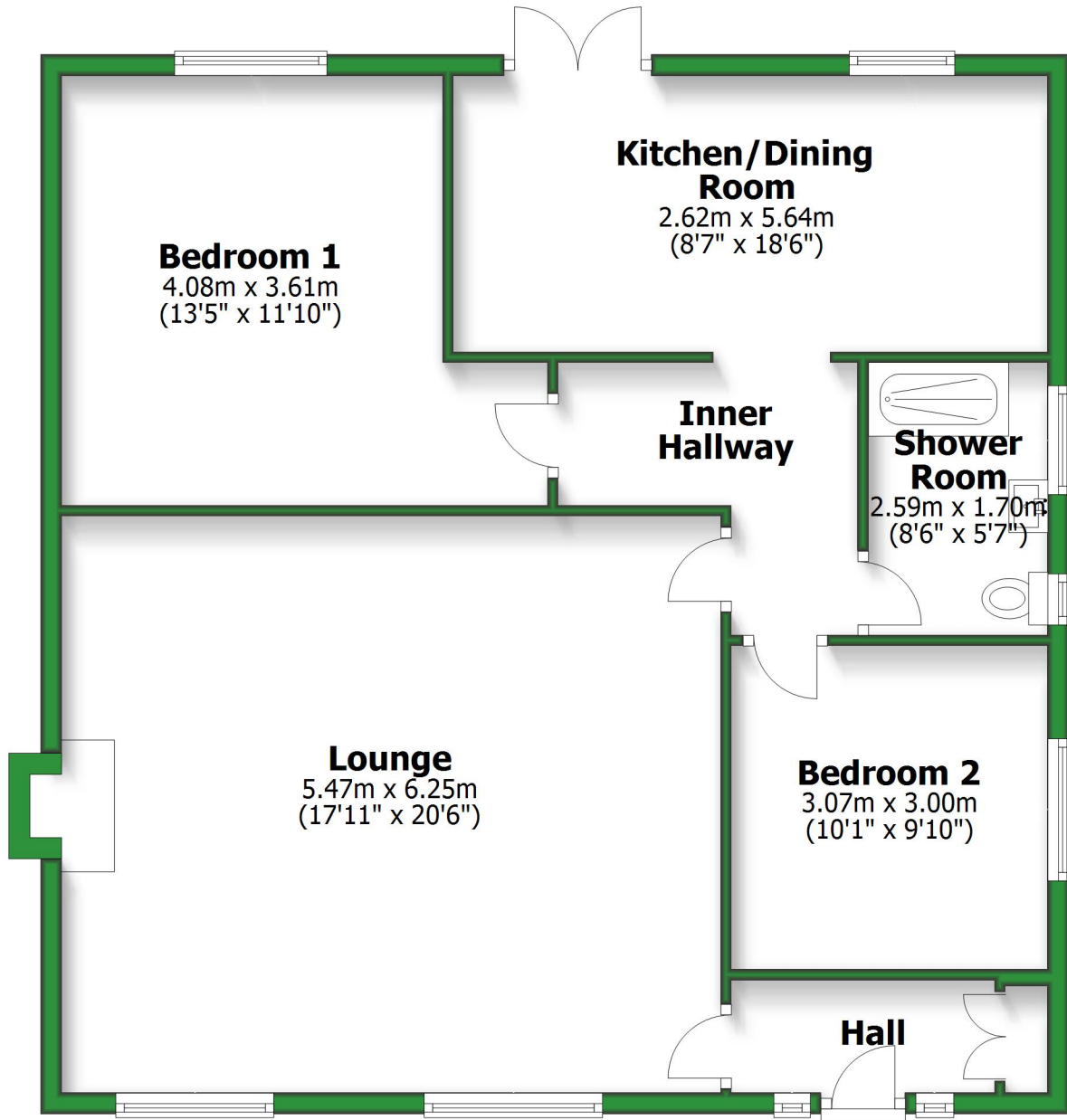

Total area: approx. 90.2 sq. metres (971.2 sq. feet)

For illustrative purposes only. Not to scale. All sizes are approximate.

Plan produced using PlanUp.

Ground Floor

Approx. 90.2 sq. metres (971.2 sq. feet)



Bedroom 1
4.08m x 3.61m
(13'5" x 11'10")

Kitchen/Dining Room

2.62m x 5.64m
(8'7" x 18'6")

Inner Hallway

Shower Room

2.59m x 1.70m
(8'6" x 5'7")

Lounge
5.47m x 6.25m
(17'11" x 20'6")

Bedroom 2
3.07m x 3.00m
(10'1" x 9'10")

Hall

Total area: approx. 90.2 sq. metres (971.2 sq. feet)

For illustrative purposes only. Not to scale. All sizes are approximate.

Plan produced using PlanUp.