

Ground Floor

Approx. 57.7 sq. metres (620.8 sq. feet)

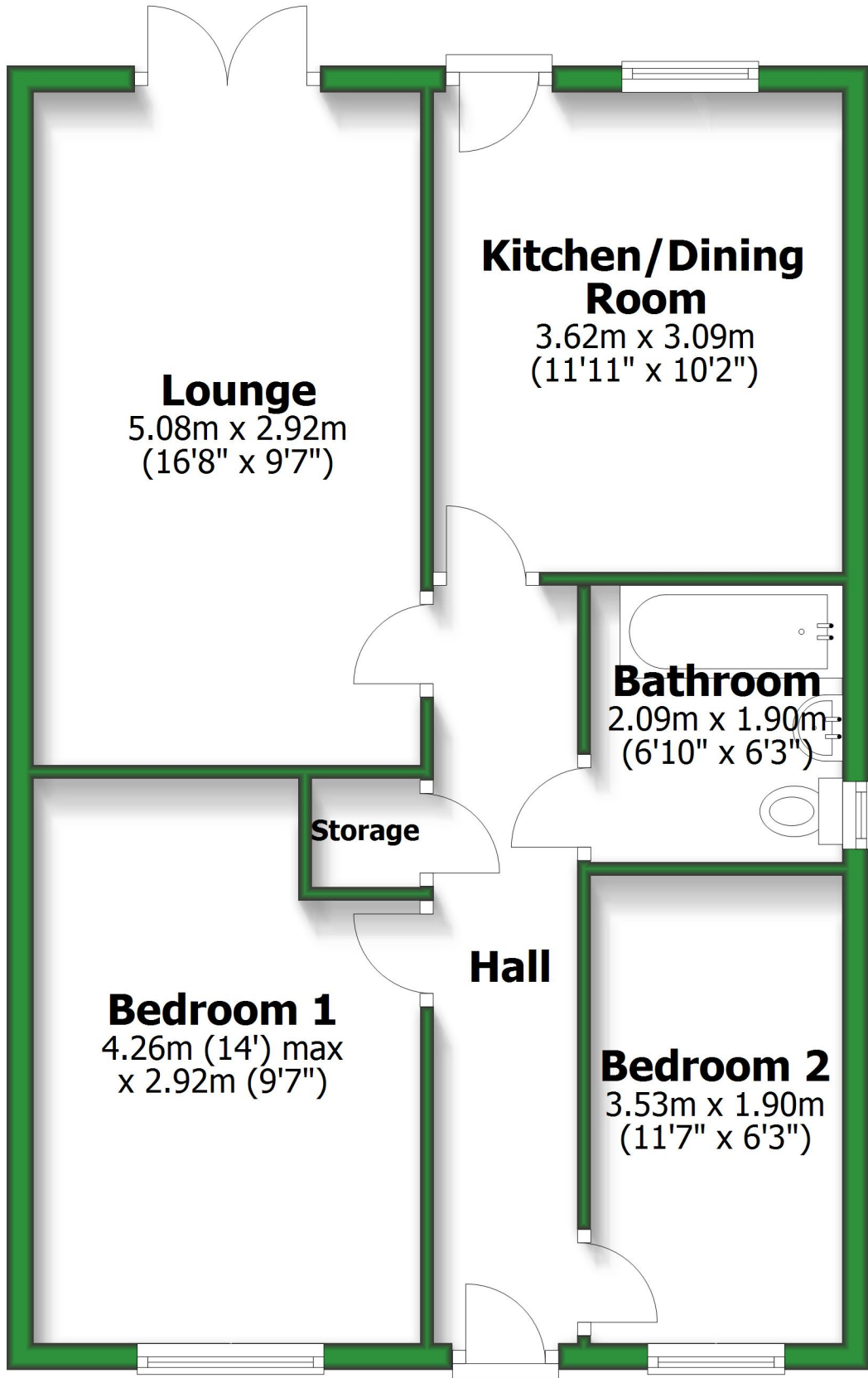

Total area: approx. 57.7 sq. metres (620.8 sq. feet)

For illustrative purposes only. Not to scale. All sizes are approximate.

Plan produced using PlanUp.

Ground Floor

Approx. 57.7 sq. metres (620.8 sq. feet)

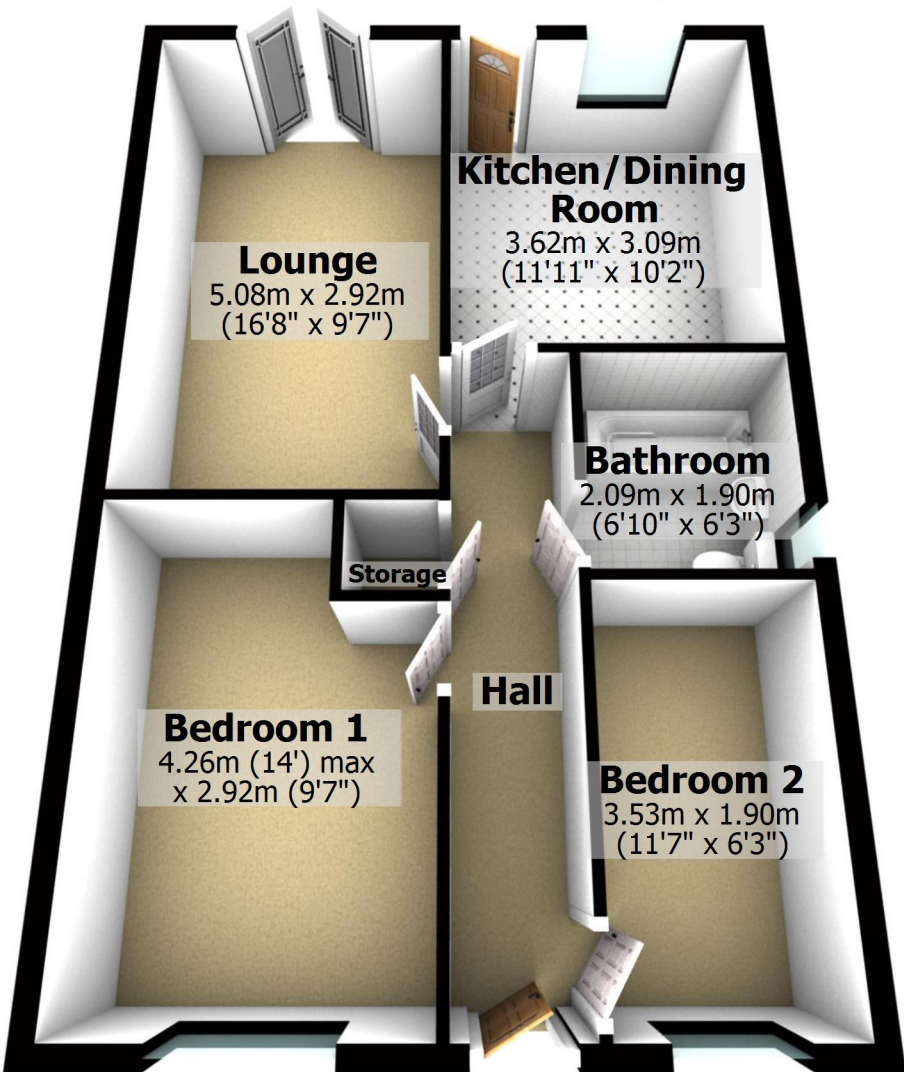

Total area: approx. 57.7 sq. metres (620.8 sq. feet)

For illustrative purposes only. Not to scale. All sizes are approximate.

Plan produced using PlanUp.