

# Ground Floor

Approx. 64.2 sq. metres (690.8 sq. feet)

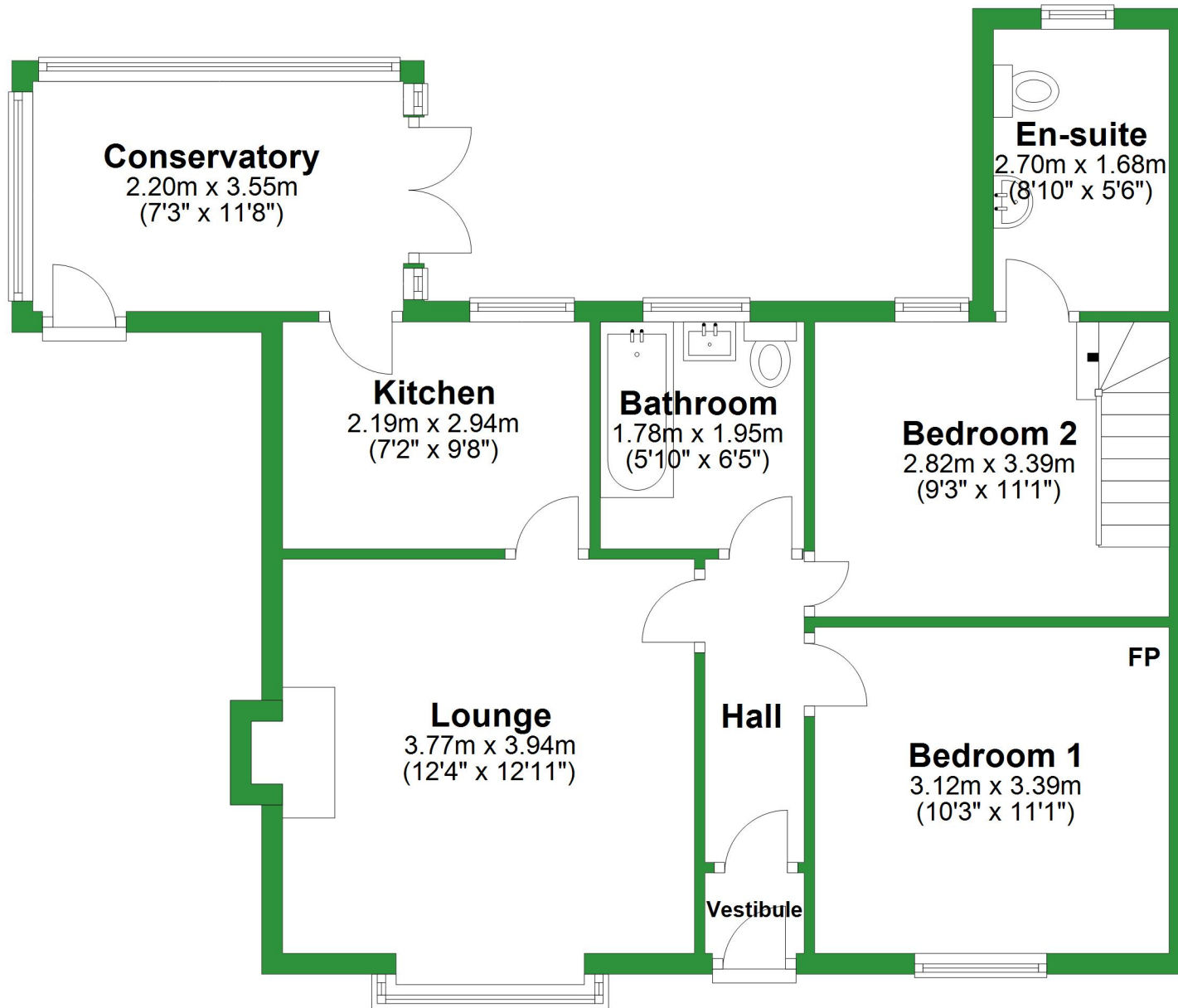

Total area: approx. 81.8 sq. metres (880.9 sq. feet)

For illustrative purposes only. Not to scale. All sizes are approximate.

Plan produced using PlanUp.

## First Floor

Approx. 17.7 sq. metres (190.1 sq. feet)

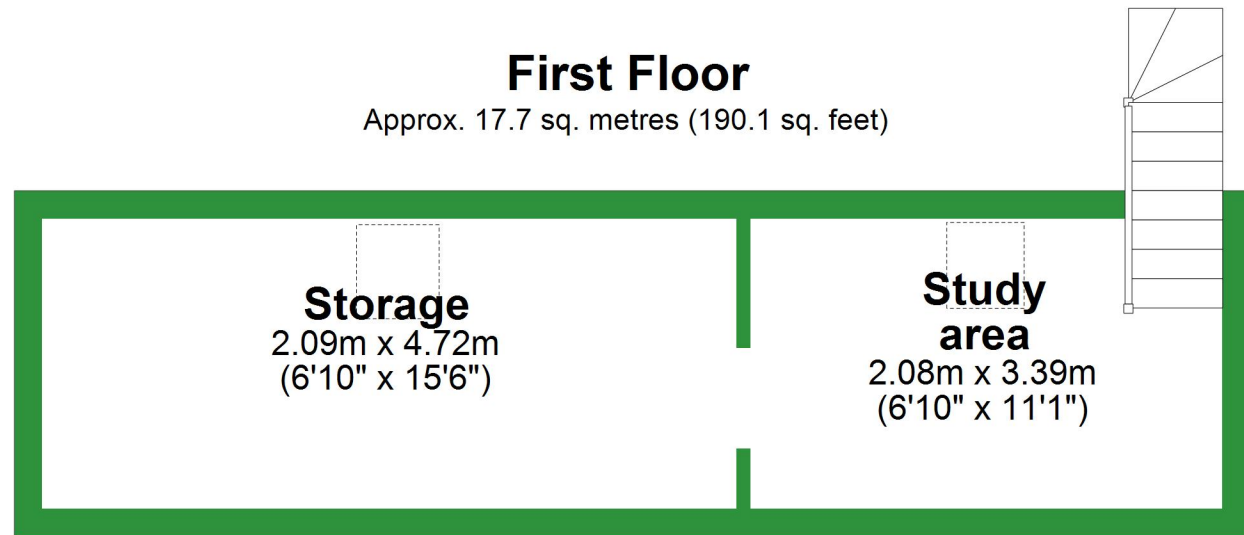

# Ground Floor

Approx. 64.2 sq. metres (690.8 sq. feet)



Total area: approx. 81.8 sq. metres (880.9 sq. feet)

For illustrative purposes only. Not to scale. All sizes are approximate.

Plan produced using PlanUp.

## First Floor

Approx. 17.7 sq. metres (190.1 sq. feet)

### Storage

2.09m x 4.72m  
(6'10" x 15'6")

### Study area

2.08m x 3.39m  
(6'10" x 11'1")

