

# Ground Floor

Approx. 42.0 sq. metres (452.1 sq. feet)

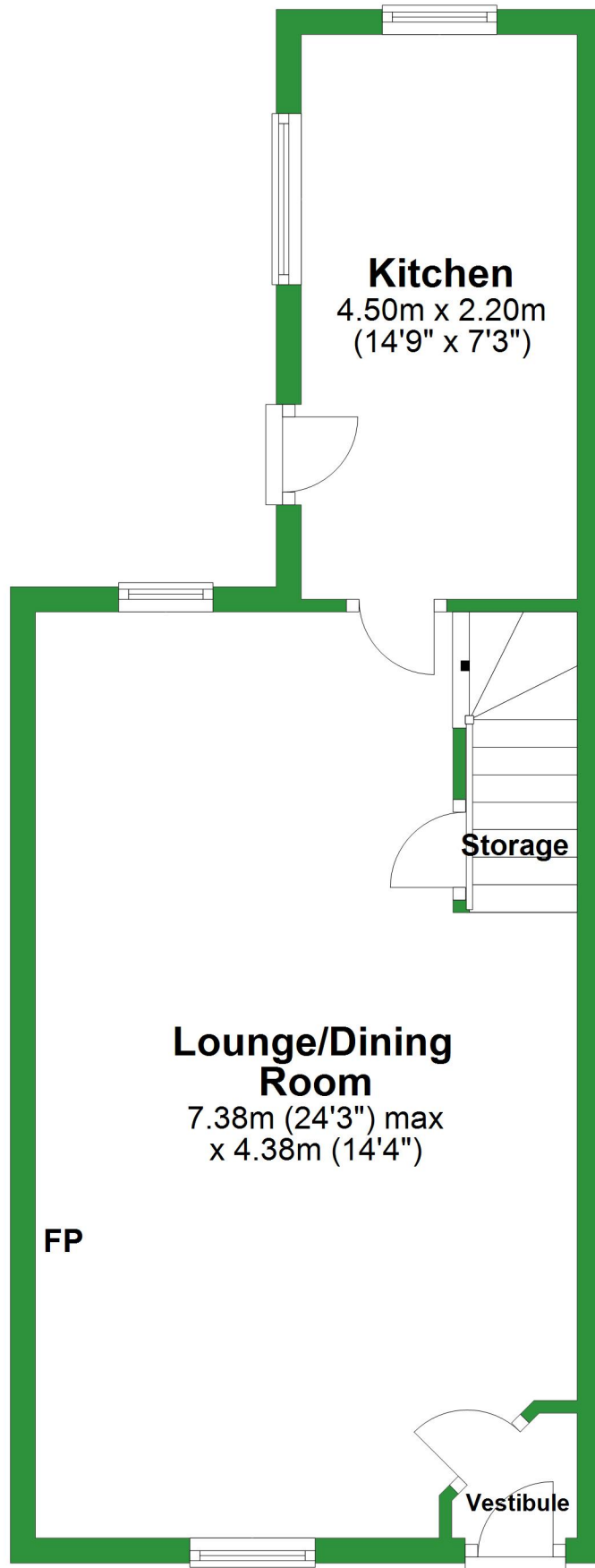

Total area: approx. 73.9 sq. metres (795.3 sq. feet)

For illustrative purposes only. Not to scale. All sizes are approximate.  
Plan produced using PlanUp.

## First Floor

Approx. 31.9 sq. metres (343.2 sq. feet)

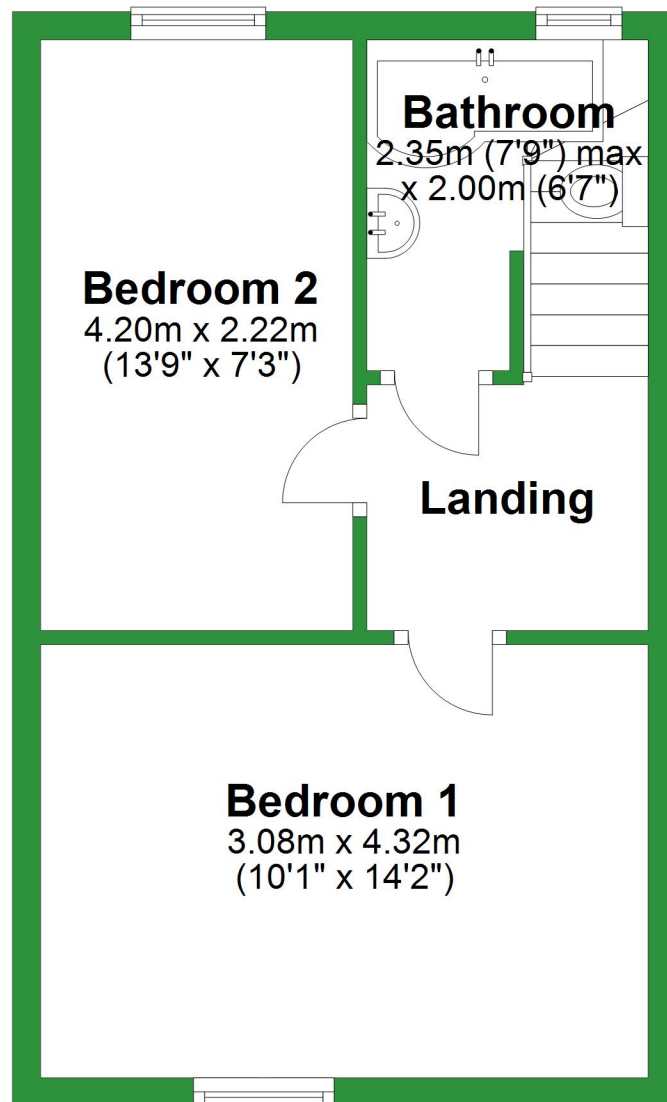

# Ground Floor

Approx. 42.0 sq. metres (452.1 sq. feet)

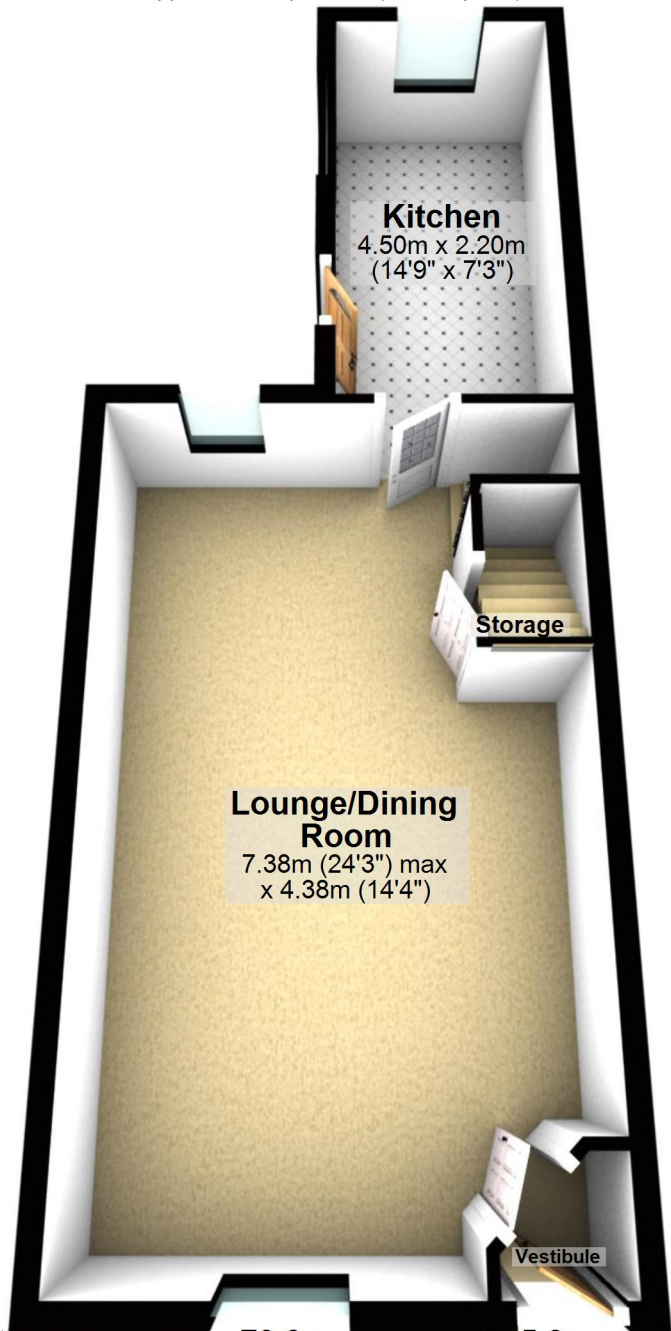

## Kitchen

4.50m x 2.20m  
(14'9" x 7'3")

Storage

## Lounge/Dining Room

7.38m (24'3") max  
x 4.38m (14'4")

Vestibule

Total area: approx. 73.9 sq. metres (795.3 sq. feet)

For illustrative purposes only. Not to scale. All sizes are approximate.

Plan produced using PlanUp.

## First Floor

Approx. 31.9 sq. metres (343.2 sq. feet)

