

# Ground Floor

Approx. 45.1 sq. metres (486.0 sq. feet)

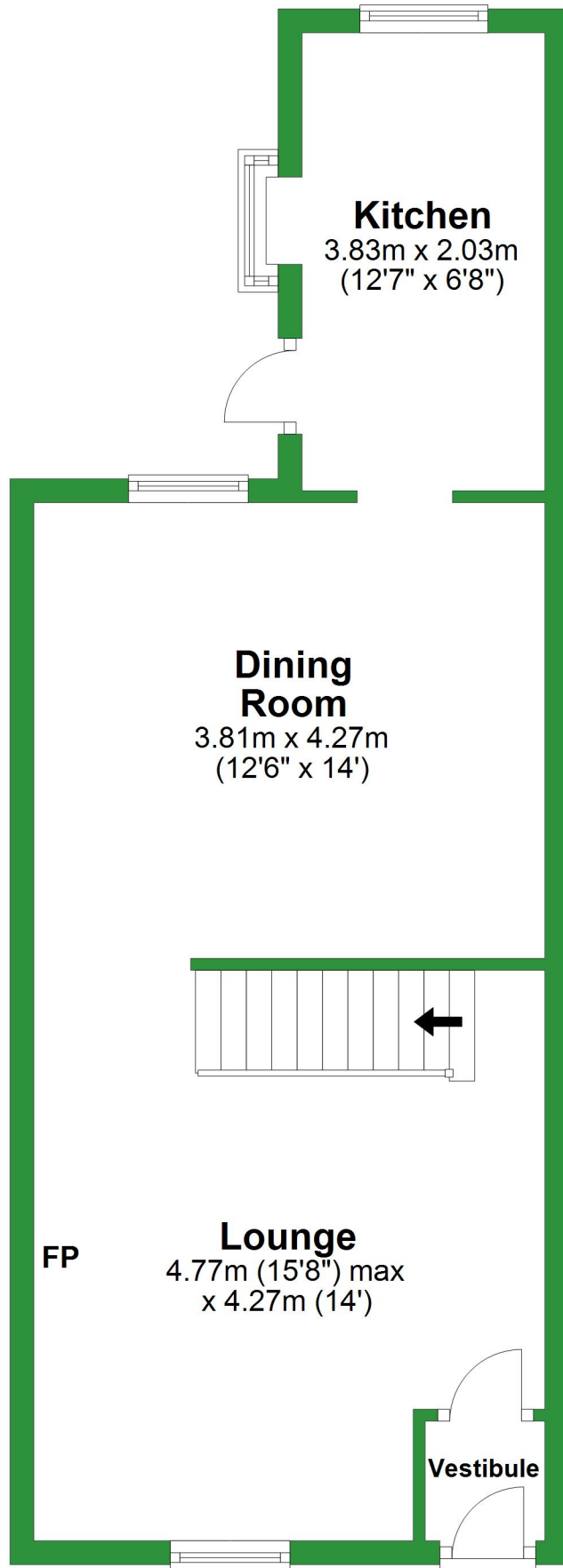

Total area: approx. 82.2 sq. metres (884.9 sq. feet)

For illustrative purposes only. Not to scale. All sizes are approximate.  
Plan produced using PlanUp.

# First Floor

Approx. 37.1 sq. metres (398.9 sq. feet)

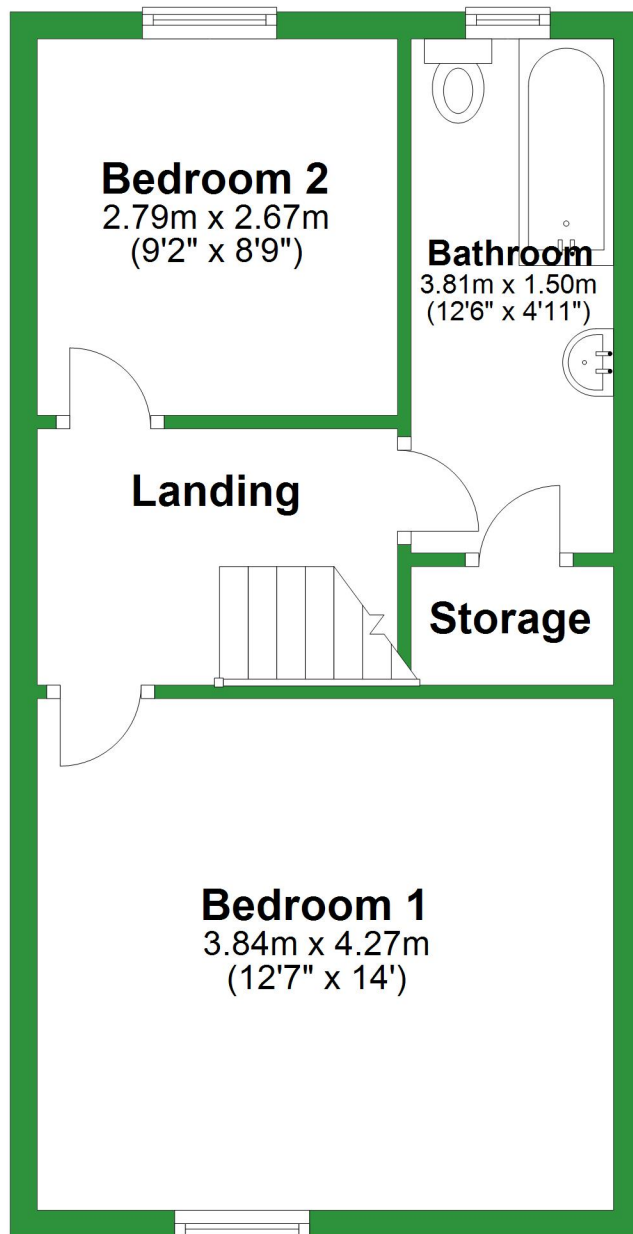

# Ground Floor

Approx. 45.1 sq. metres (486.0 sq. feet)

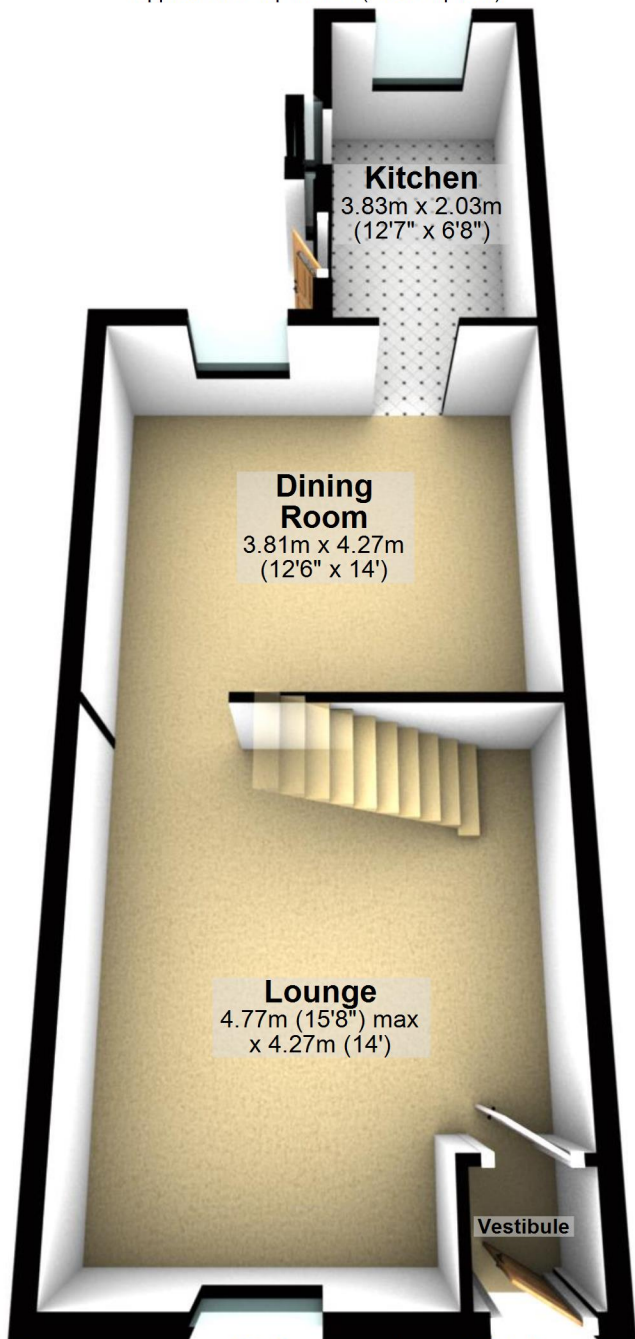

Total area: approx. 82.2 sq. metres (884.9 sq. feet)

For illustrative purposes only. Not to scale. All sizes are approximate.

Plan produced using PlanUp.

# First Floor

Approx. 37.1 sq. metres (398.9 sq. feet)

