

# Ground Floor

Approx. 108.3 sq. metres (1165.7 sq. feet)

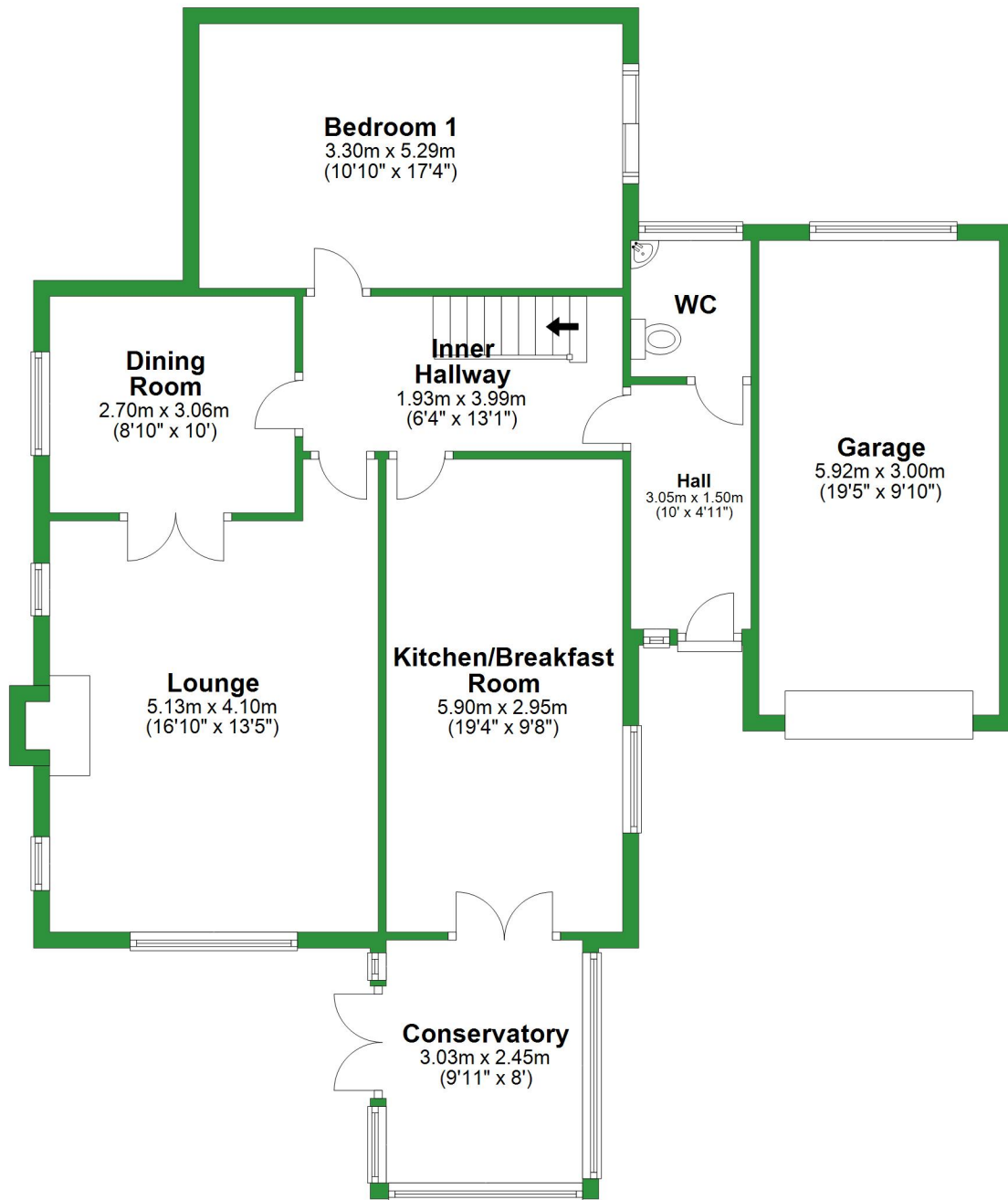

Total area: approx. 188.3 sq. metres (2026.8 sq. feet)

For illustrative purposes only. Not to scale. All sizes are approximate.  
Plan produced using PlanUp.

Approx. 80.0 sq. metres (861.1 sq. feet)

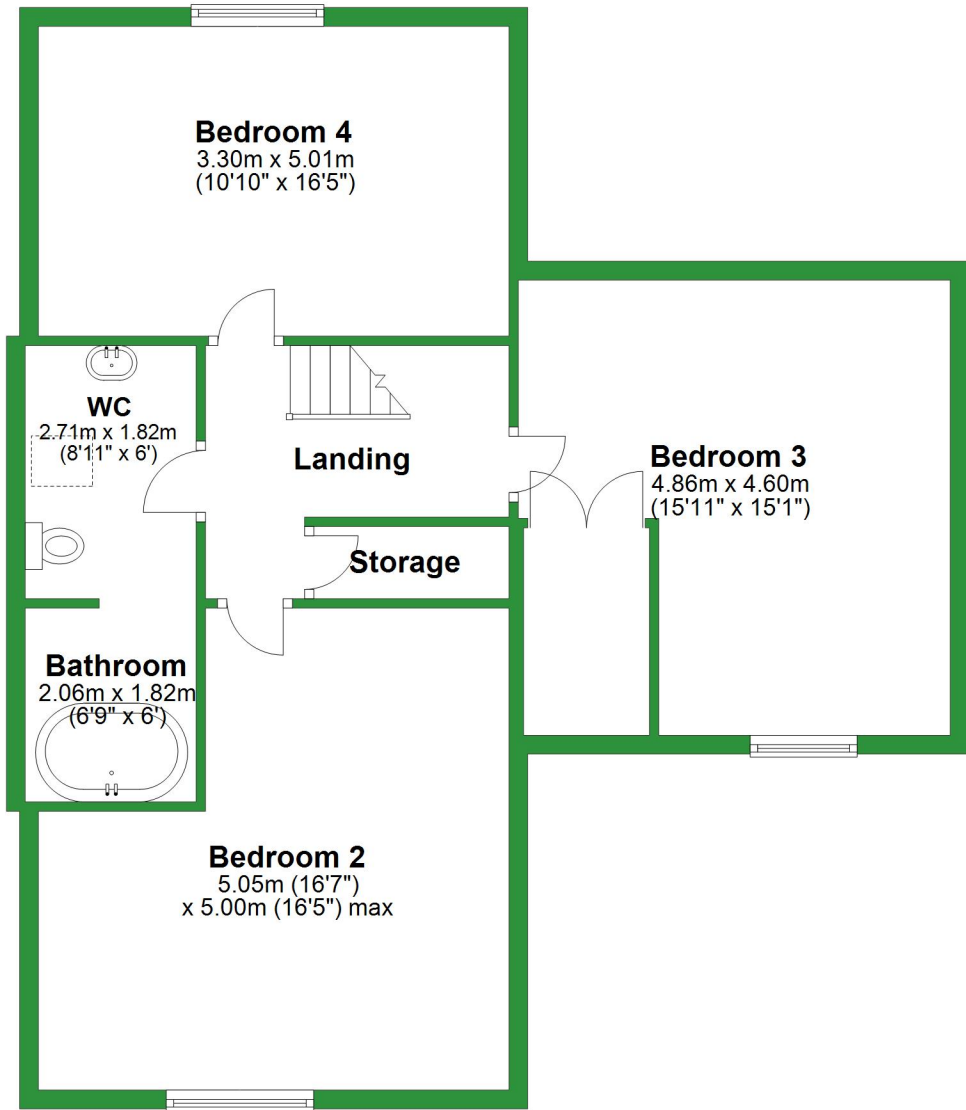

# Ground Floor

Approx. 108.3 sq. metres (1165.7 sq. feet)

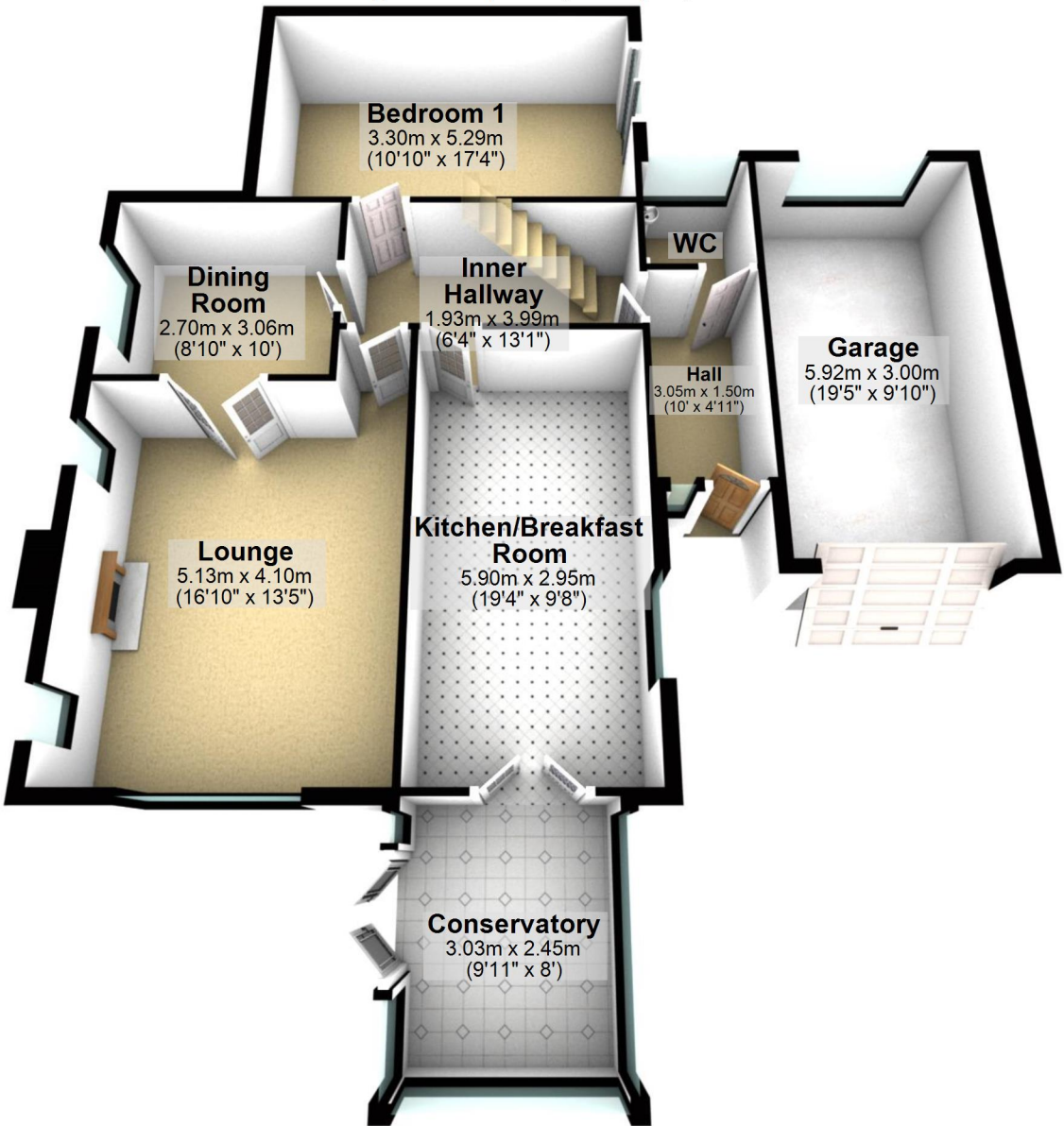

Total area: approx. 188.3 sq. metres (2026.8 sq. feet)

For illustrative purposes only. Not to scale. All sizes are approximate.  
Plan produced using PlanUp.

# First Floor

Approx. 80.0 sq. metres (861.1 sq. feet)

**Bedroom 4**  
3.30m x 5.01m  
(10'10" x 16'5")

**WC**  
2.71m x 1.82m  
(8'11" x 6')

**Landing**

**Bedroom 3**  
4.86m x 4.60m  
(15'11" x 15'1")

**Storage**

**Bathroom**  
2.06m x 1.82m  
(6'9" x 6')

**Bedroom 2**  
5.05m (16'7")  
x 5.00m (16'5") max

