

# Ground Floor

Approx. 41.5 sq. metres (446.7 sq. feet)

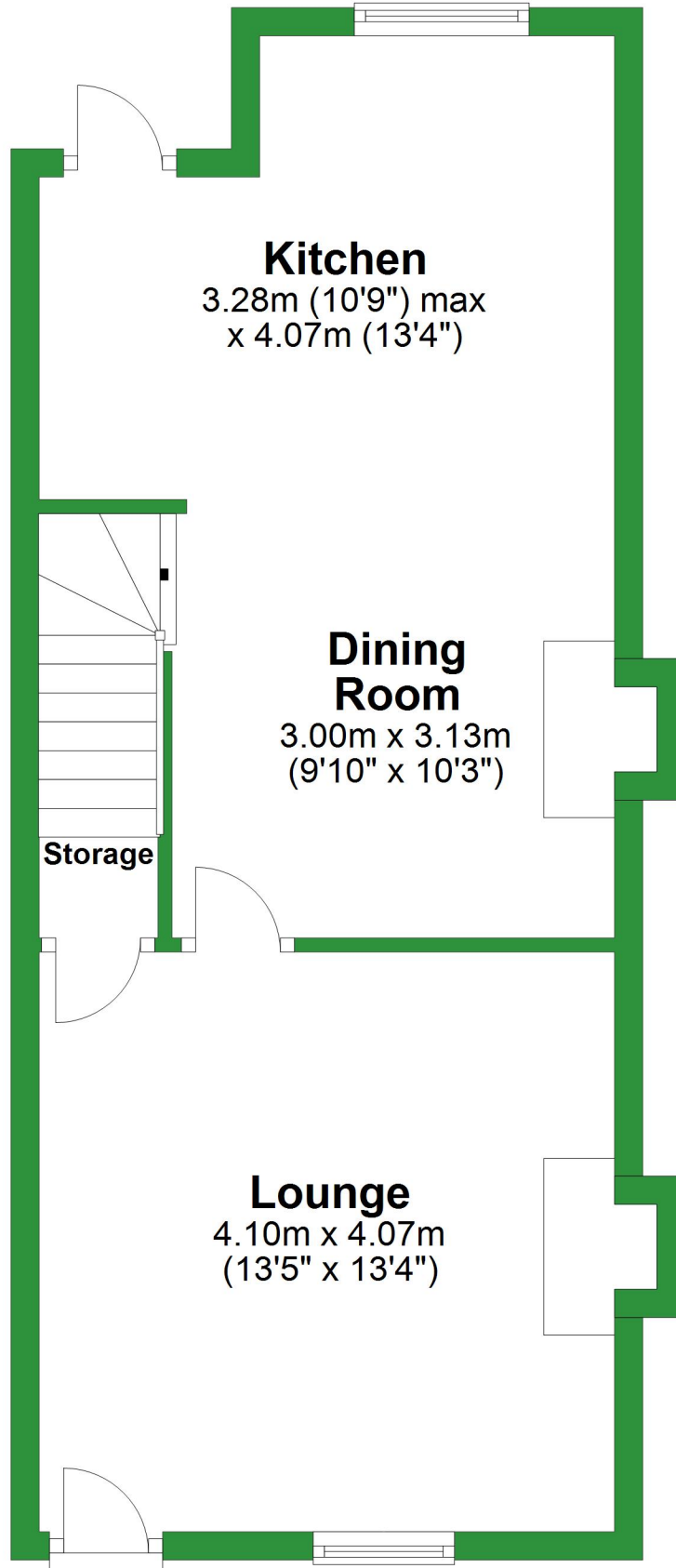

Total area: approx. 72.4 sq. metres (779.2 sq. feet)

For illustrative purposes only. Not to scale. All sizes are approximate.  
Plan produced using PlanUp.

# First Floor

Approx. 30.9 sq. metres (332.4 sq. feet)

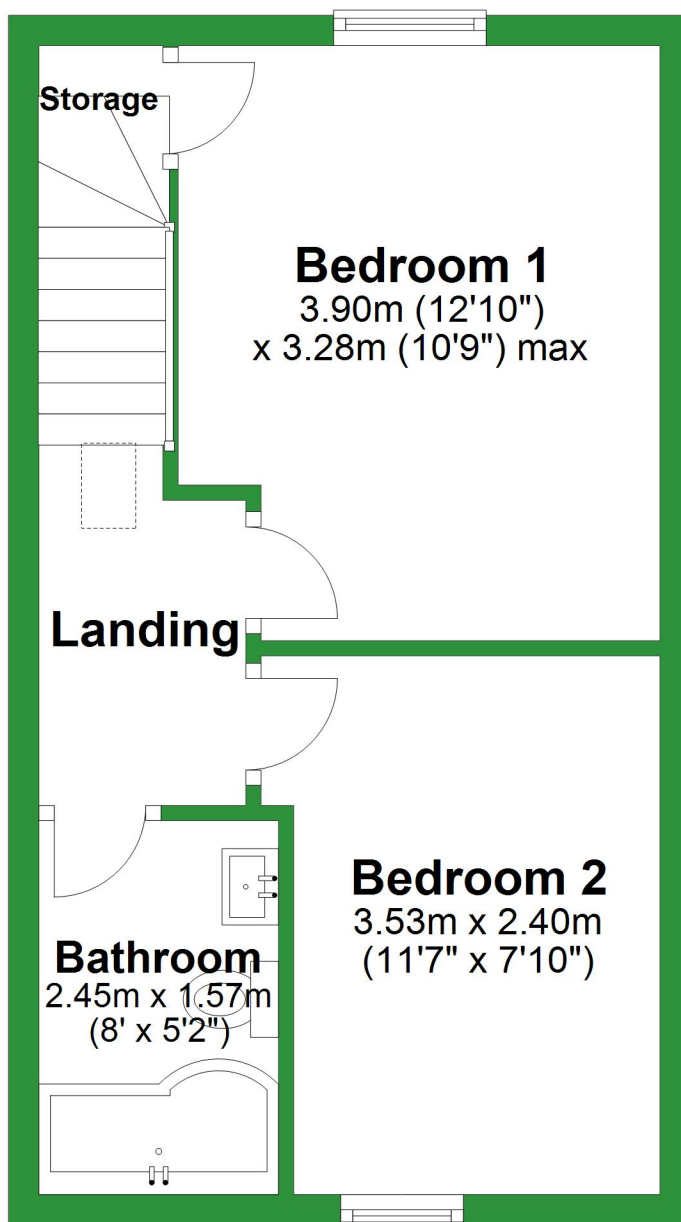

# Ground Floor

Approx. 41.5 sq. metres (446.7 sq. feet)

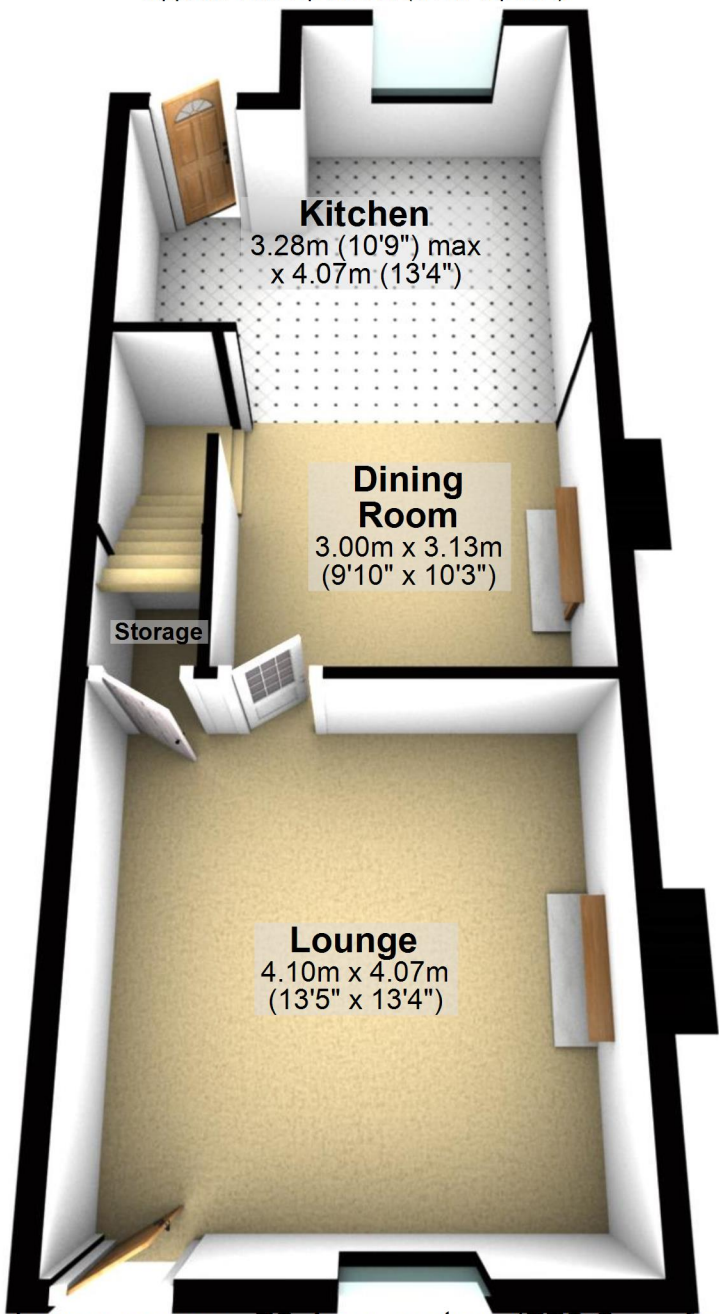

## Kitchen

3.28m (10'9") max  
x 4.07m (13'4")

## Dining Room

3.00m x 3.13m  
(9'10" x 10'3")

Storage

## Lounge

4.10m x 4.07m  
(13'5" x 13'4")

Total area: approx. 72.4 sq. metres (779.2 sq. feet)

For illustrative purposes only. Not to scale. All sizes are approximate.

Plan produced using PlanUp.

# First Floor

Approx. 30.9 sq. metres (332.4 sq. feet)

