

# Ground Floor

Approx. 28.7 sq. metres (309.4 sq. feet)

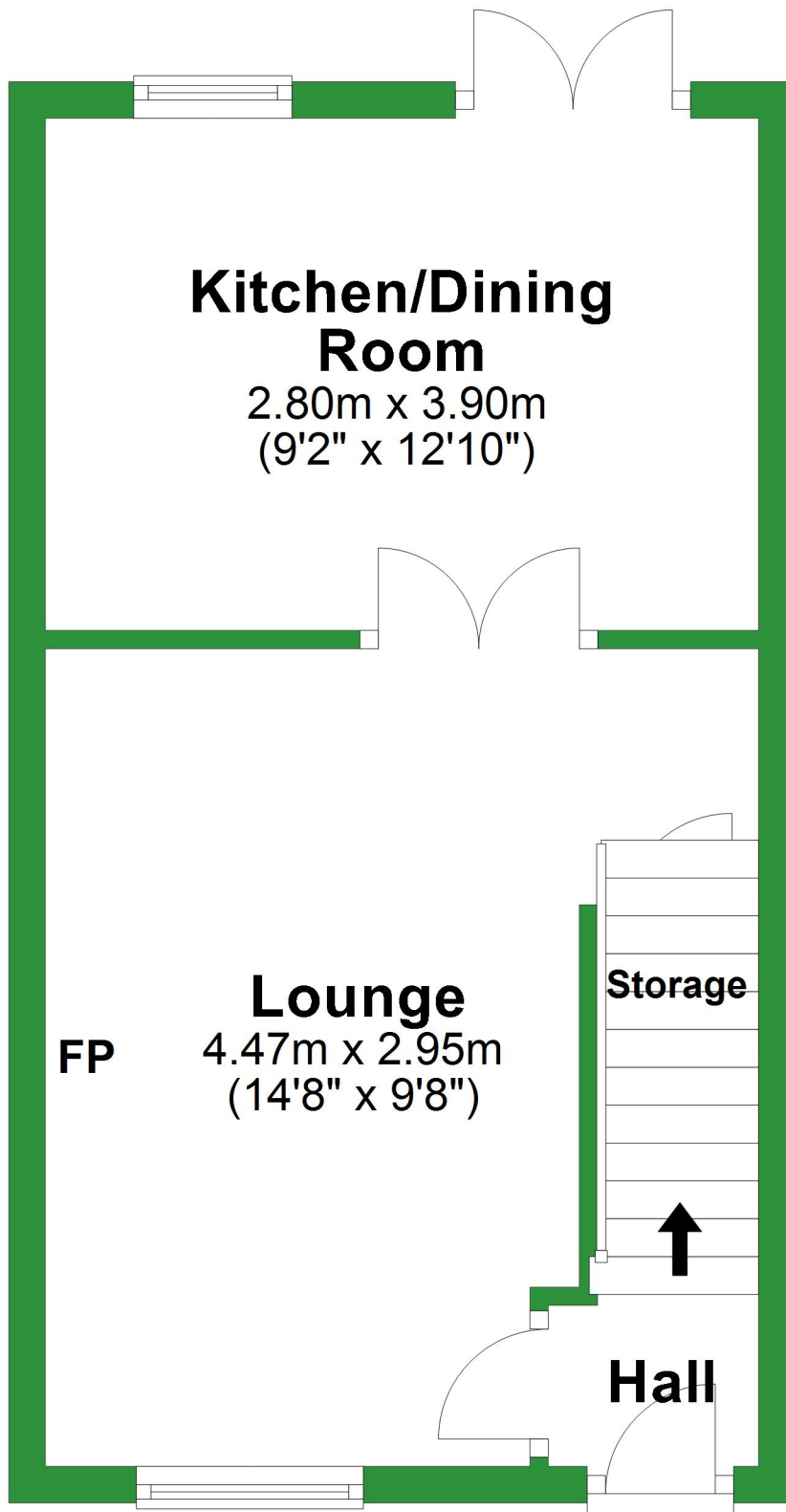

Total area: approx. 57.5 sq. metres (618.8 sq. feet)

For illustrative purposes only. Not to scale. All sizes are approximate.

Plan produced using PlanUp.

# First Floor

Approx. 28.7 sq. metres (309.4 sq. feet)

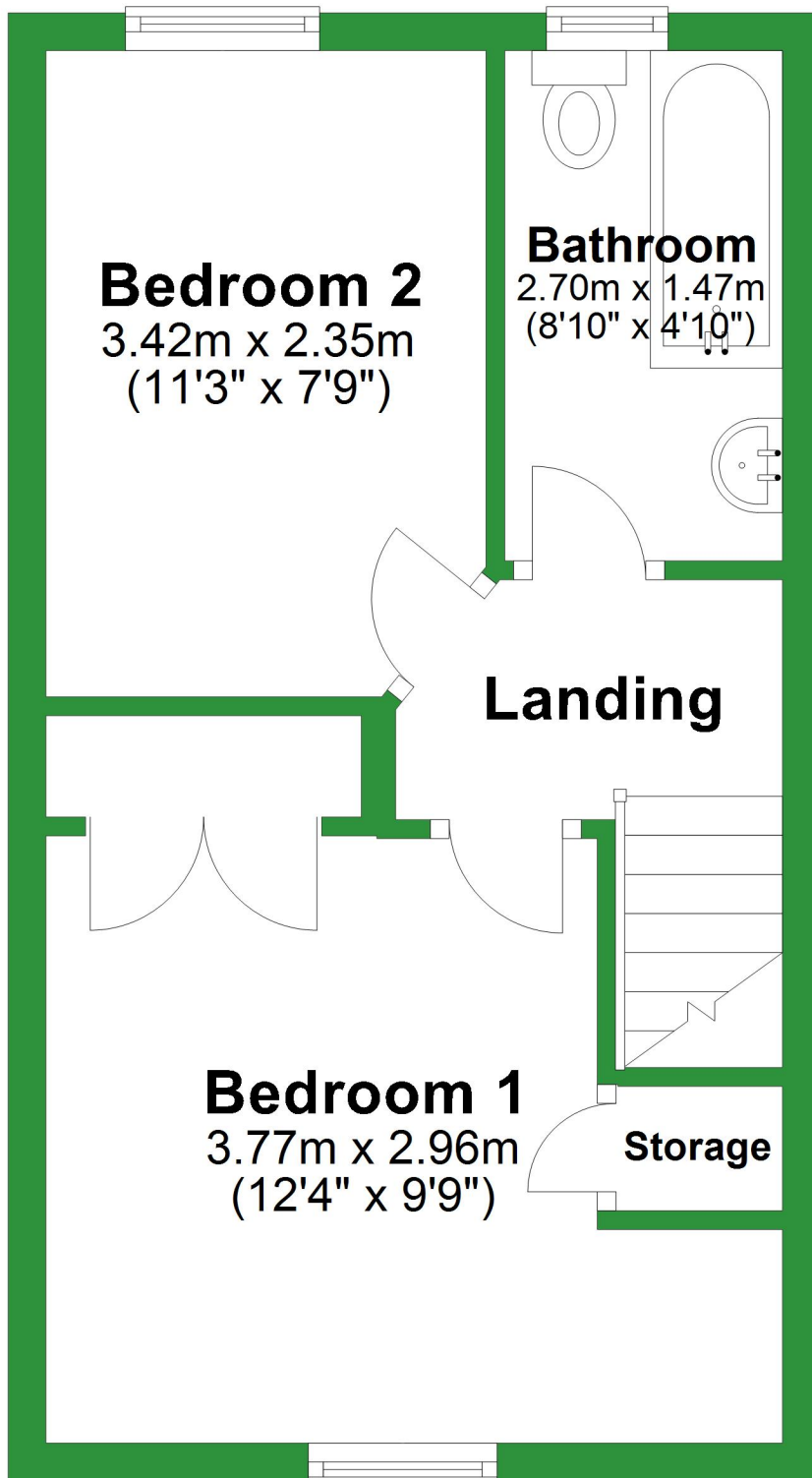

# Ground Floor

Approx. 28.7 sq. metres (309.4 sq. feet)

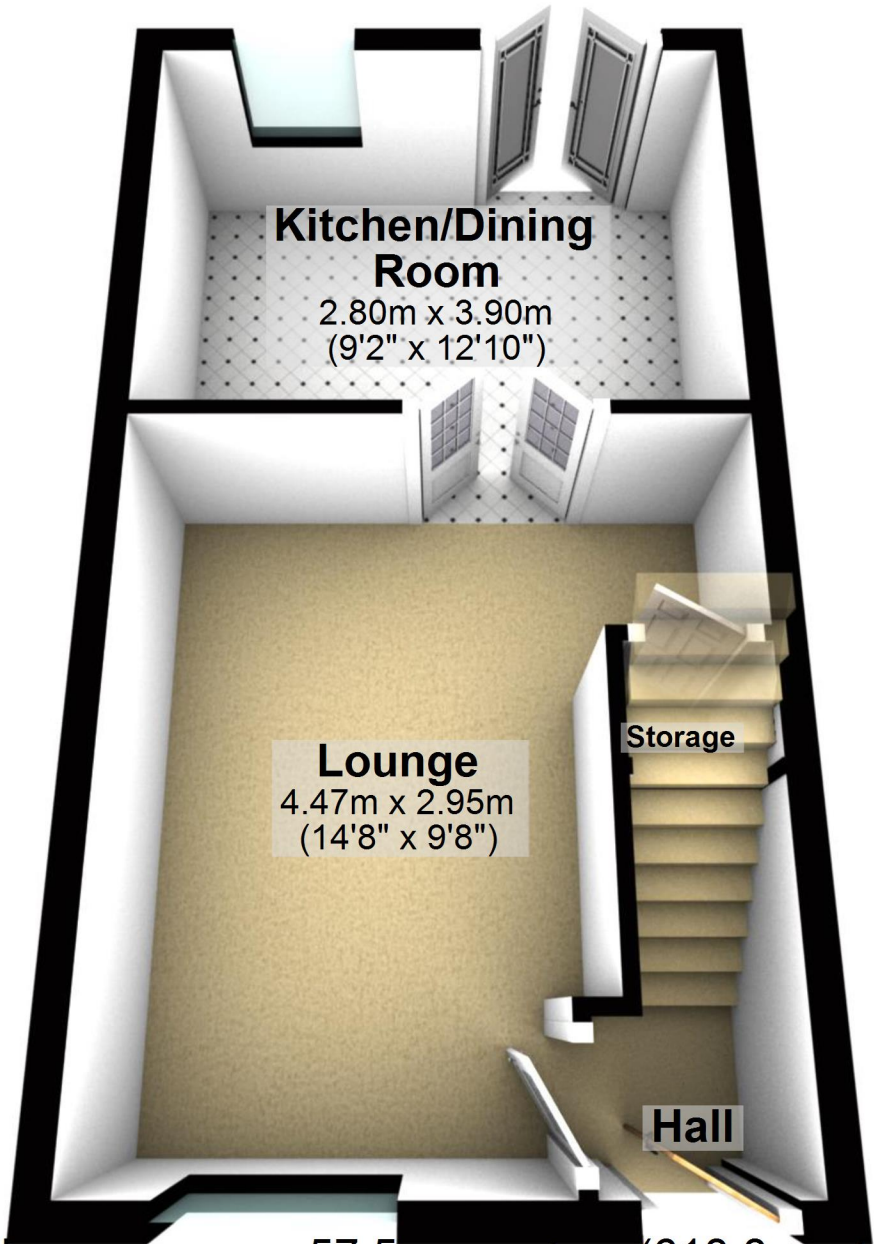

Total area: approx. 57.5 sq. metres (618.8 sq. feet)

For illustrative purposes only. Not to scale. All sizes are approximate.

Plan produced using PlanUp.

# First Floor

Approx. 28.7 sq. metres (309.4 sq. feet)

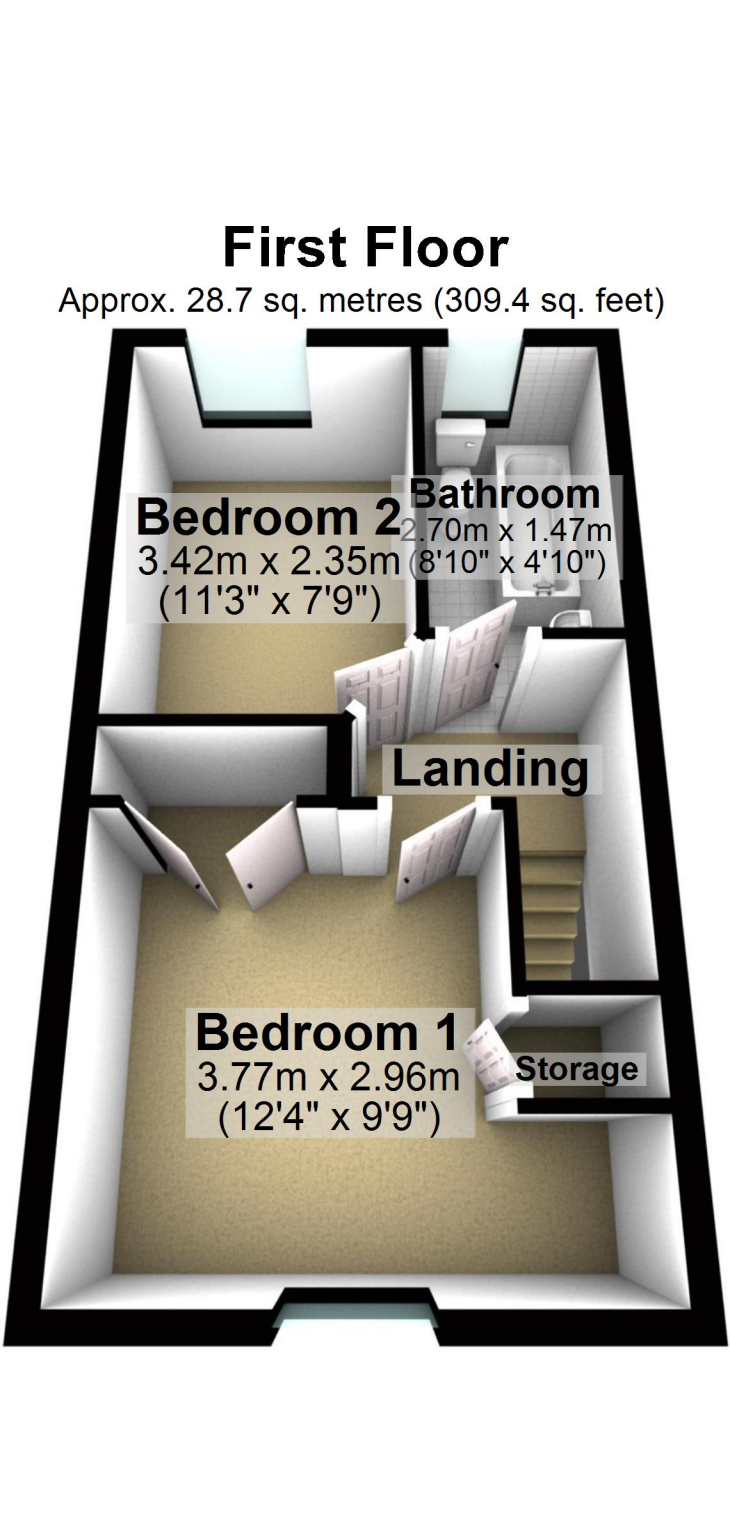

**Bedroom 2**  
3.42m x 2.35m  
(11'3" x 7'9")

**Bathroom**

2.70m x 1.47m  
(8'10" x 4'10")

**Landing**

**Bedroom 1**  
3.77m x 2.96m  
(12'4" x 9'9")

**Storage**