

# Ground Floor

Approx. 42.4 sq. metres (456.7 sq. feet)

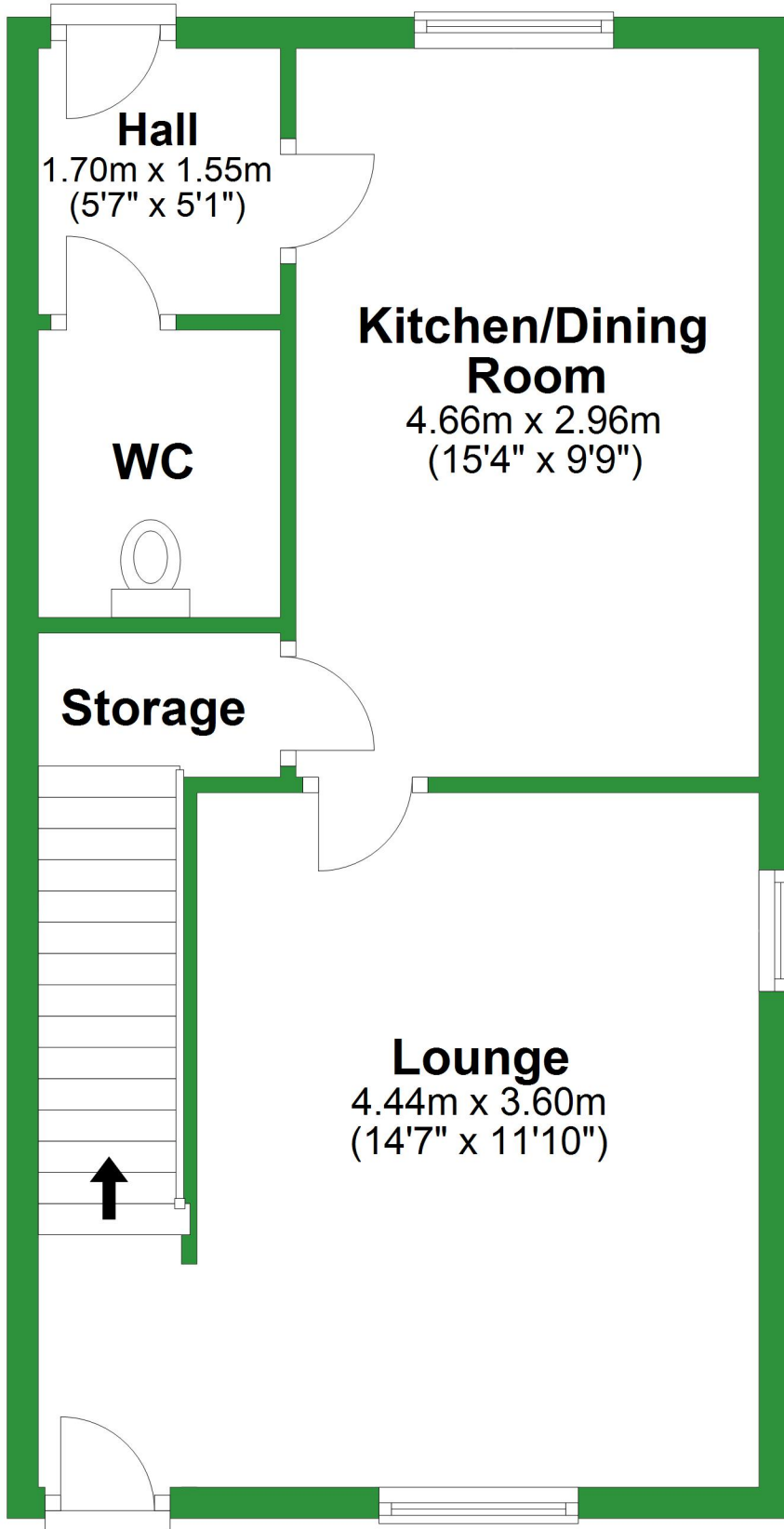

Total area: approx. 84.9 sq. metres (913.4 sq. feet)

For illustrative purposes only. Not to scale. All sizes are approximate.

Plan produced using PlanUp.

# First Floor

Approx. 42.4 sq. metres (456.7 sq. feet)

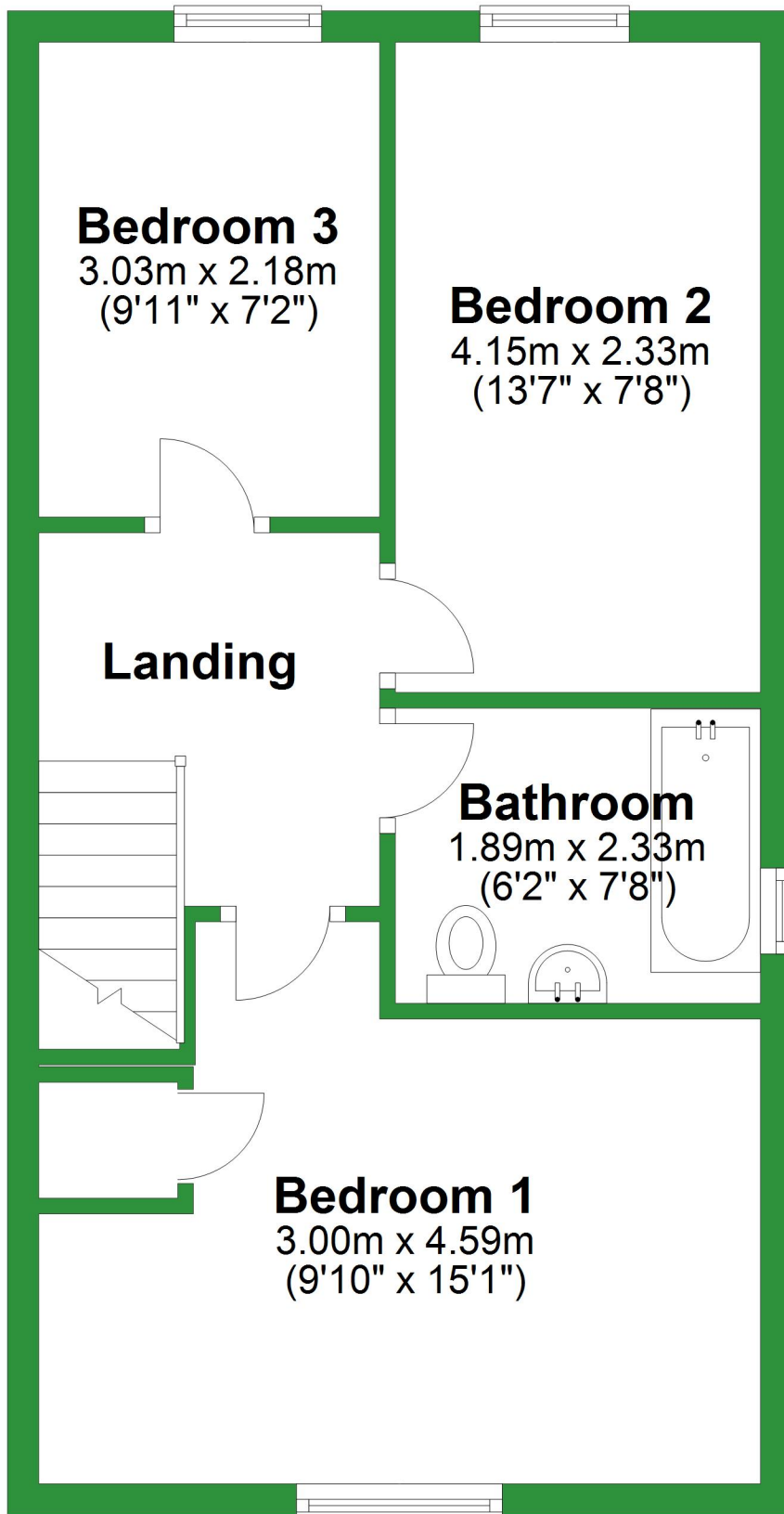

# Ground Floor

Approx. 42.4 sq. metres (456.7 sq. feet)

## Hall

1.70m x 1.55m  
(5'7" x 5'1")

## WC

## Kitchen/Dining Room

4.66m x 2.96m  
(15'4" x 9'9")

## Storage

## Lounge

4.44m x 3.60m  
(14'7" x 11'10")

Total area: approx. 84.9 sq. metres (913.4 sq. feet)

For illustrative purposes only. Not to scale. All sizes are approximate.

Plan produced using PlanUp.

# First Floor

Approx. 42.4 sq. metres (456.7 sq. feet)

## Bedroom 3

3.03m x 2.18m  
(9'11" x 7'2")

## Bedroom 2

4.15m x 2.33m  
(13'7" x 7'8")

## Landing

## Bathroom

1.89m x 2.33m  
(6'2" x 7'8")

## Bedroom 1

3.00m x 4.59m  
(9'10" x 15'1")

