

Ground Floor

Approx. 42.3 sq. metres (455.8 sq. feet)

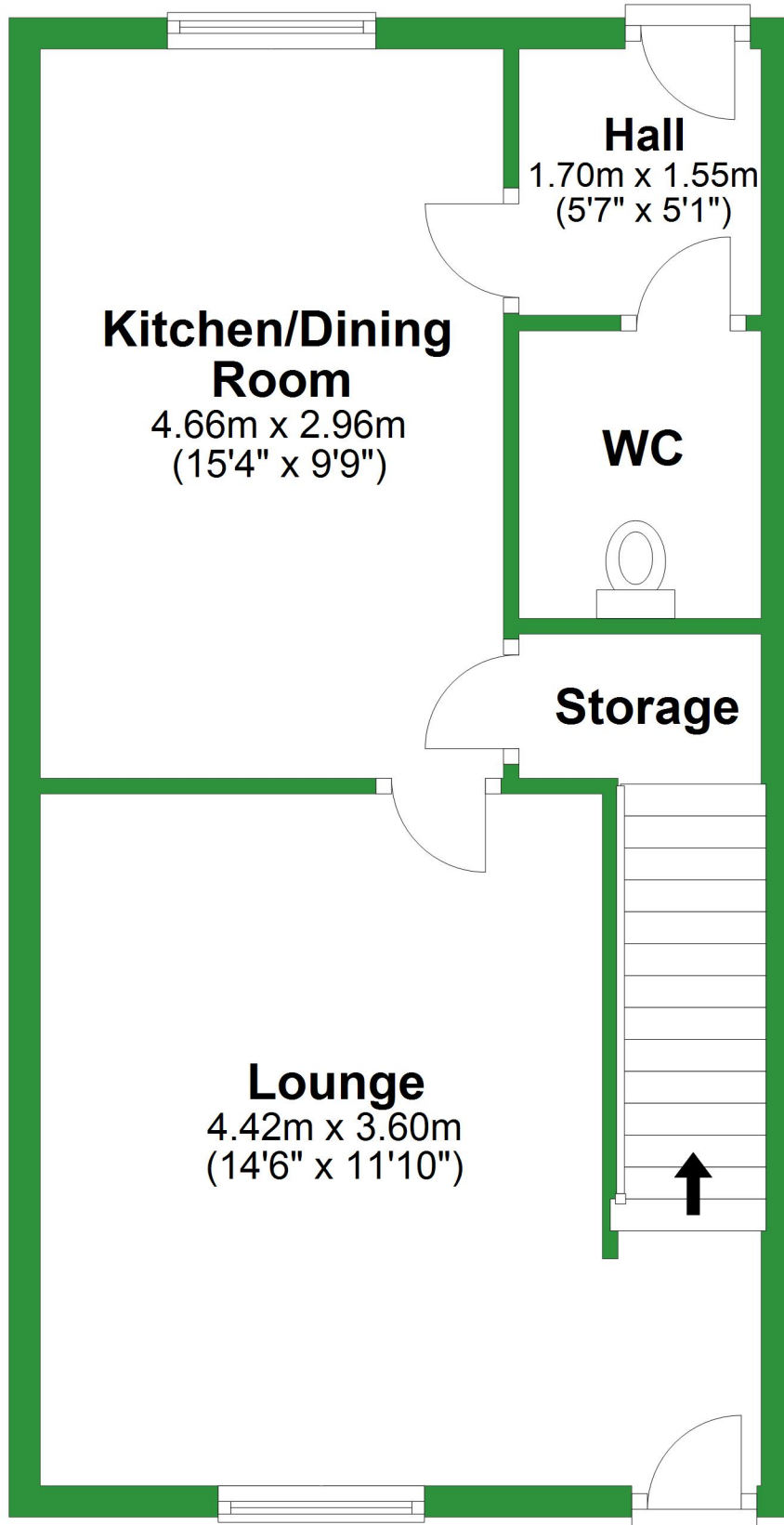

Total area: approx. 84.7 sq. metres (911.5 sq. feet)

For illustrative purposes only. Not to scale. All sizes are approximate.

Plan produced using PlanUp.

First Floor

Approx. 42.3 sq. metres (455.8 sq. feet)

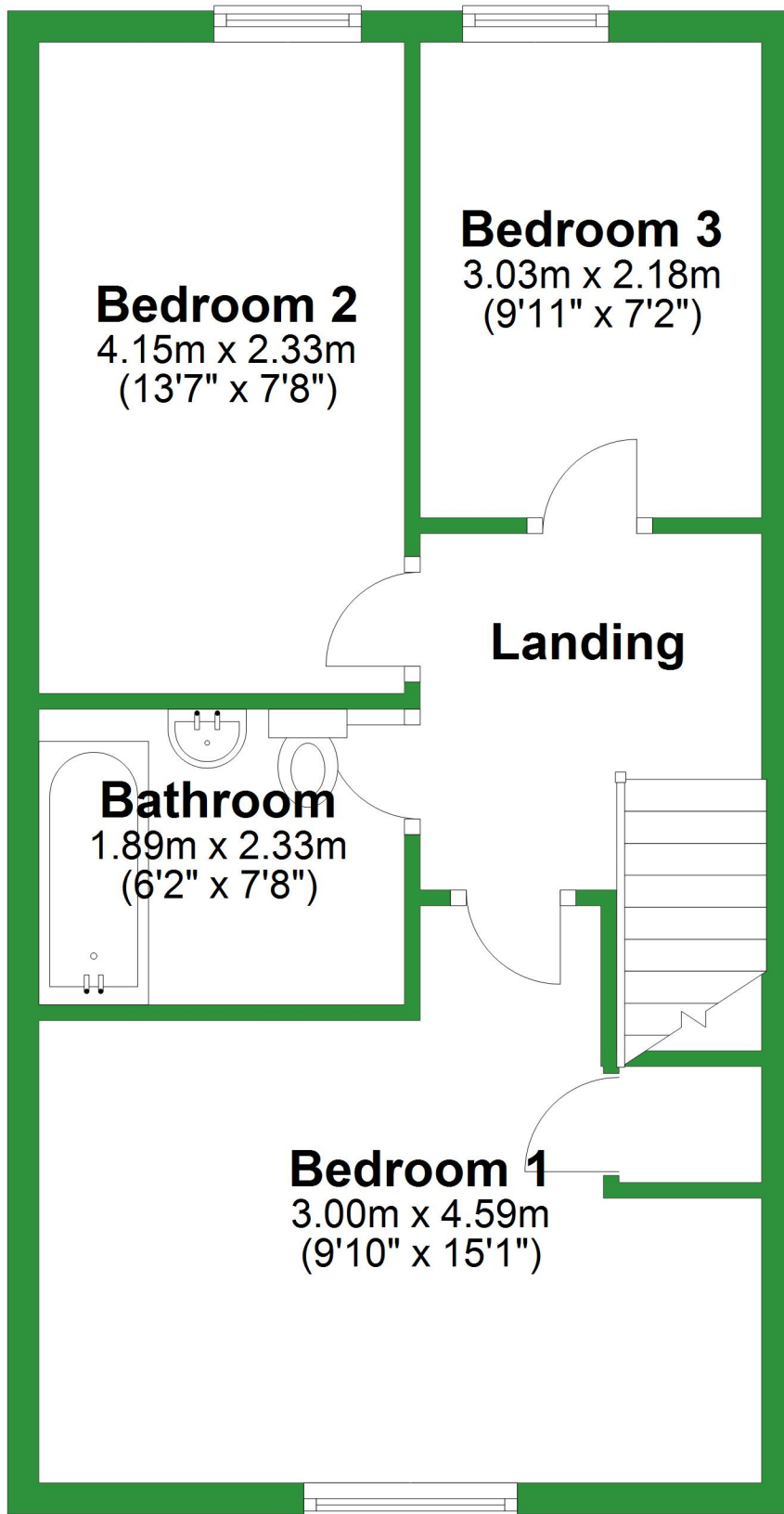

Ground Floor

Approx. 42.3 sq. metres (455.8 sq. feet)

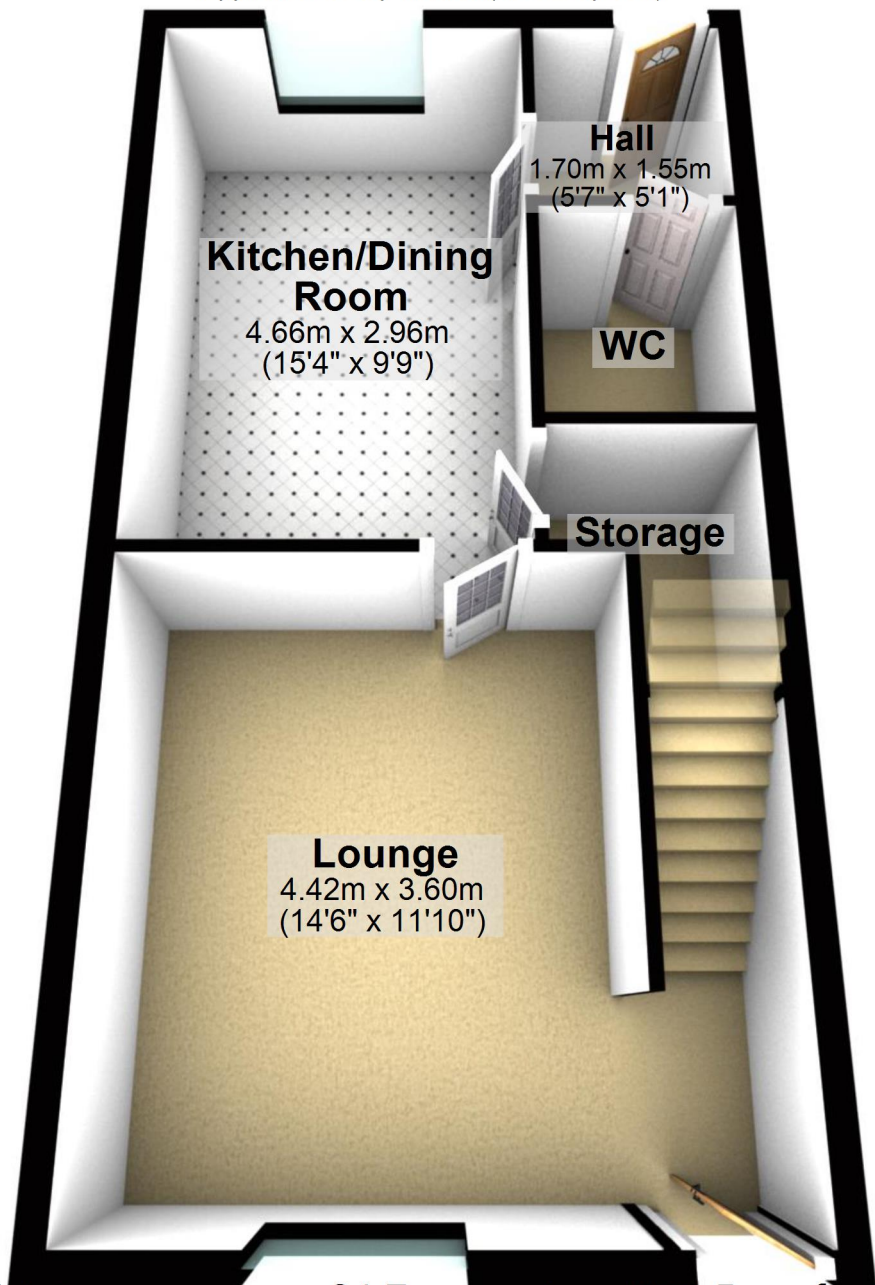

Total area: approx. 84.7 sq. metres (911.5 sq. feet)

For illustrative purposes only. Not to scale. All sizes are approximate.

Plan produced using PlanUp.

First Floor

Approx. 42.3 sq. metres (455.8 sq. feet)



Bedroom 2
4.15m x 2.33m
(13'7" x 7'8")

Bedroom 3
3.03m x 2.18m
(9'11" x 7'2")

The floor plan shows a rectangular layout with three bedrooms, a bathroom, and a central landing. Bedroom 2 is at the top left, Bedroom 3 is at the top right, and Bedroom 1 is at the bottom. The bathroom is on the left side, and the landing is in the center-right. A staircase is located in the landing area. The walls are white, and the floor is a light brown color. There are several doors and windows shown in a 3D perspective.

Bathroom
1.89m x 2.33m
(6'2" x 7'8")

Landing

Bedroom 1
3.00m x 4.59m
(9'10" x 15'1")