

# Basement

Approx. 28.4 sq. metres (305.2 sq. feet)

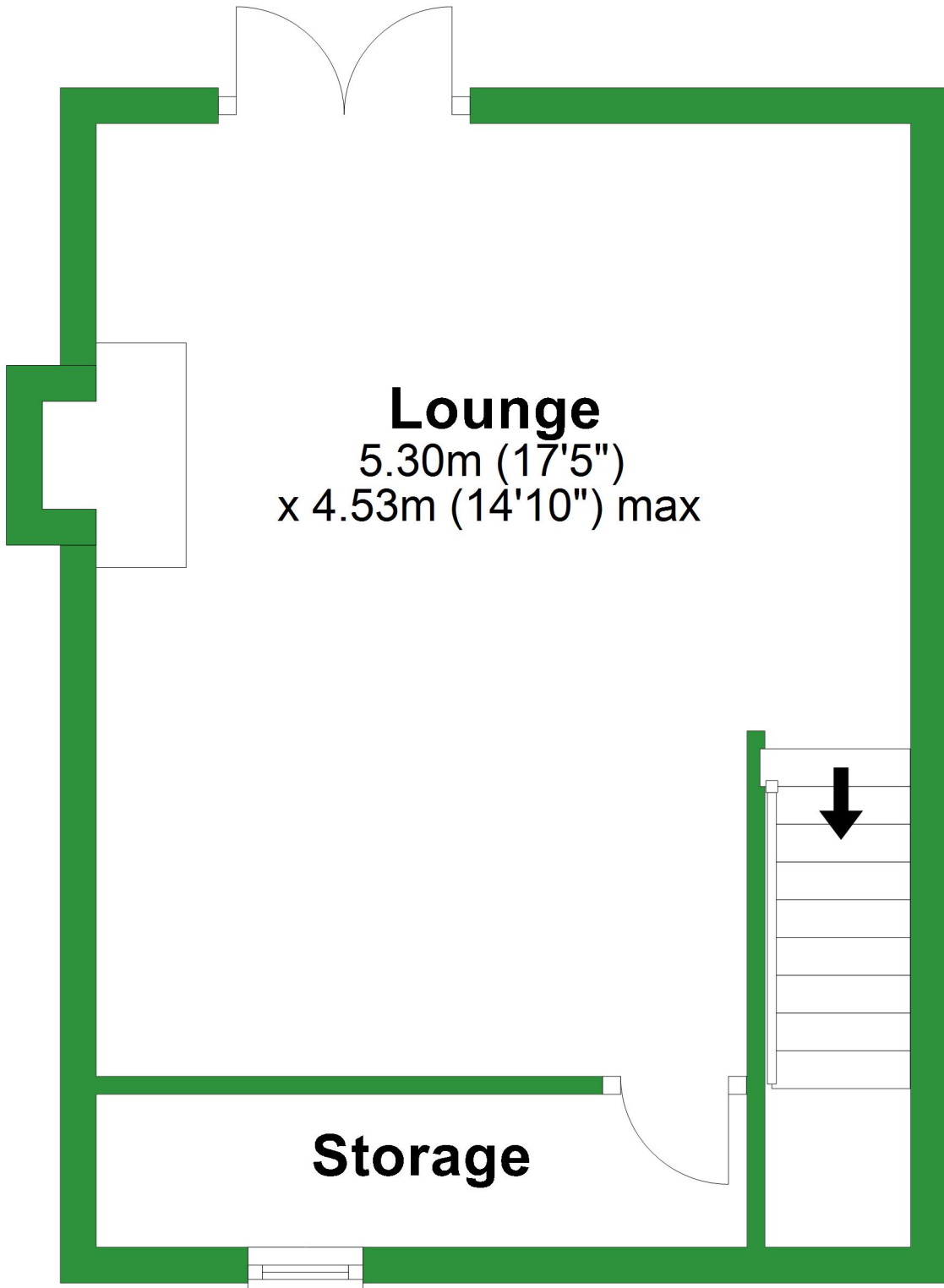

Total area: approx. 85.0 sq. metres (914.7 sq. feet)

For illustrative purposes only. Not to scale. All sizes are approximate.

Plan produced using PlanUp.

# Ground Floor

Approx. 28.3 sq. metres (304.8 sq. feet)

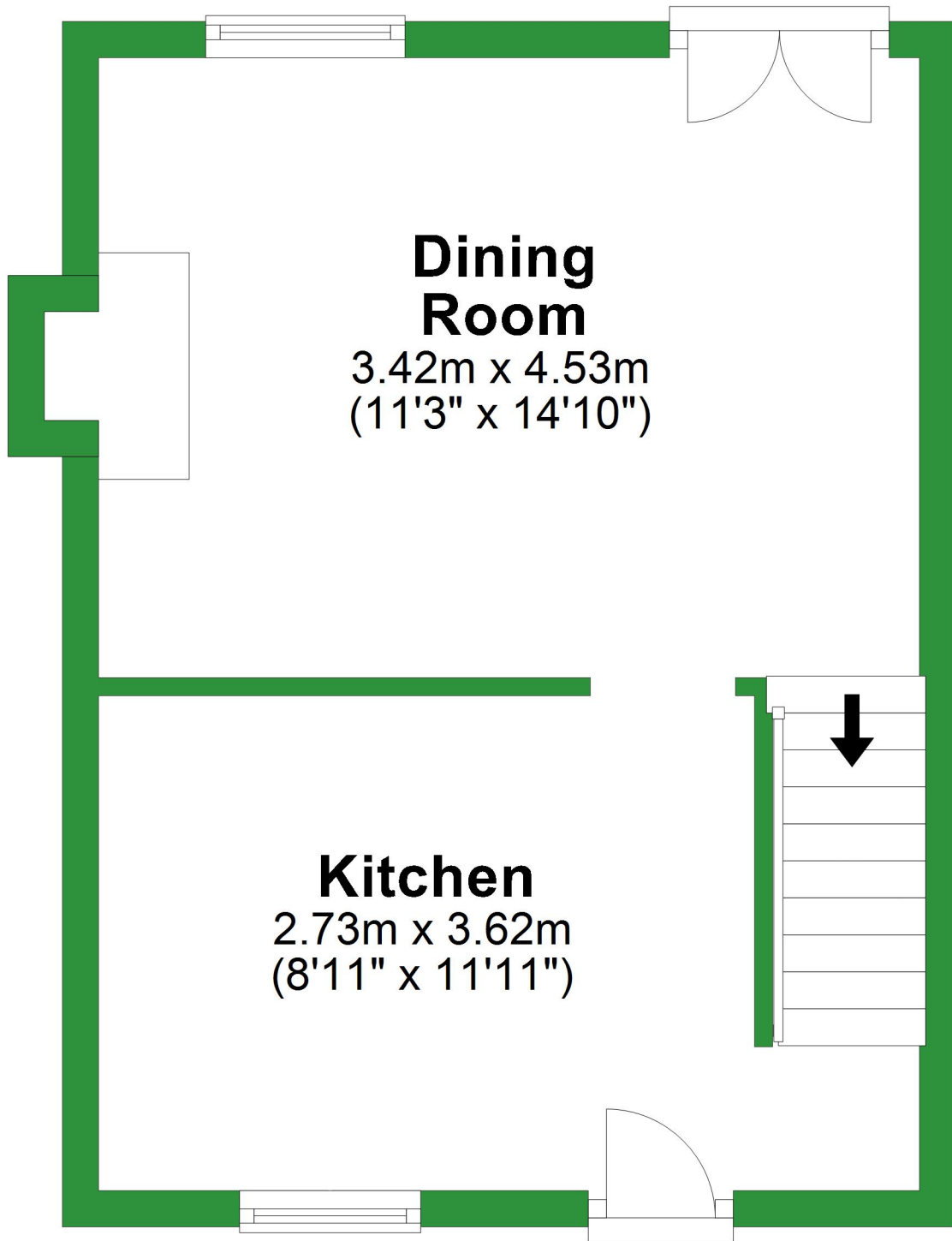

# First Floor

Approx. 28.3 sq. metres (304.8 sq. feet)

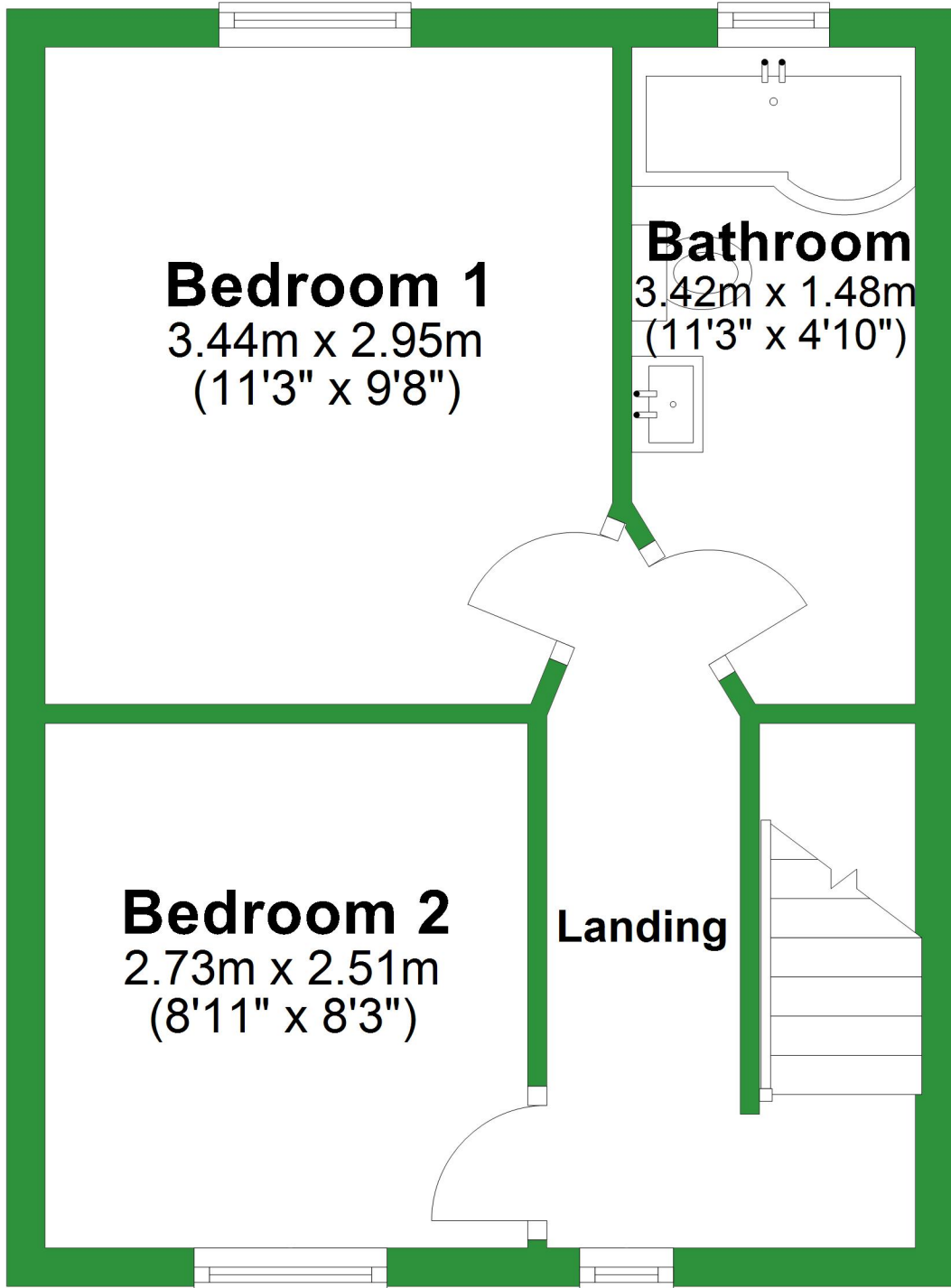

# Basement

Approx. 28.4 sq. metres (305.2 sq. feet)

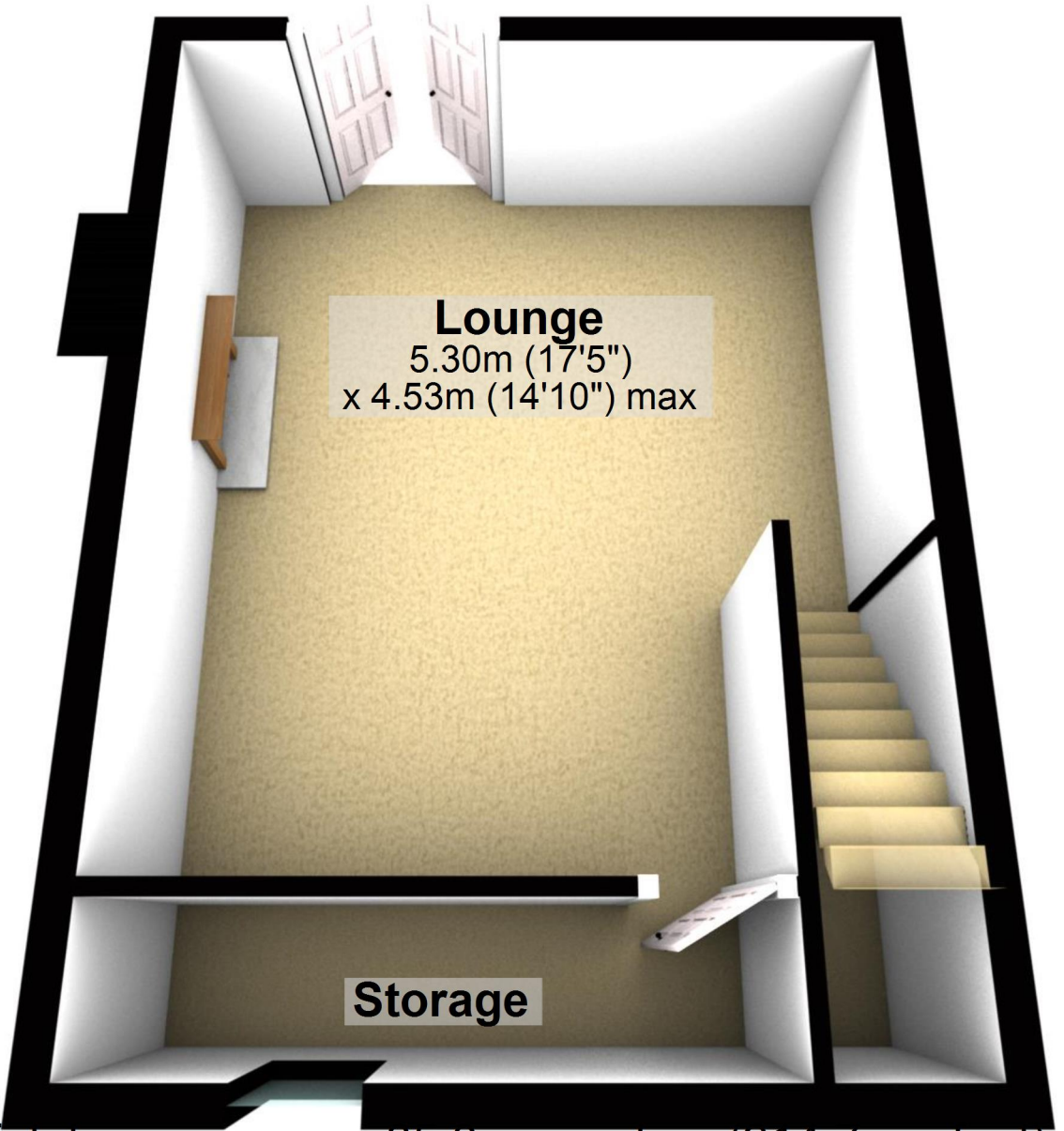

**Lounge**  
5.30m (17'5")  
x 4.53m (14'10") max

**Storage**

Total area: approx. 85.0 sq. metres (914.7 sq. feet)

For illustrative purposes only. Not to scale. All sizes are approximate.

Plan produced using PlanUp.

# Ground Floor

Approx. 28.3 sq. metres (304.8 sq. feet)

## Dining Room

3.42m x 4.53m  
(11'3" x 14'10")

## Kitchen

2.73m x 3.62m  
(8'11" x 11'11")

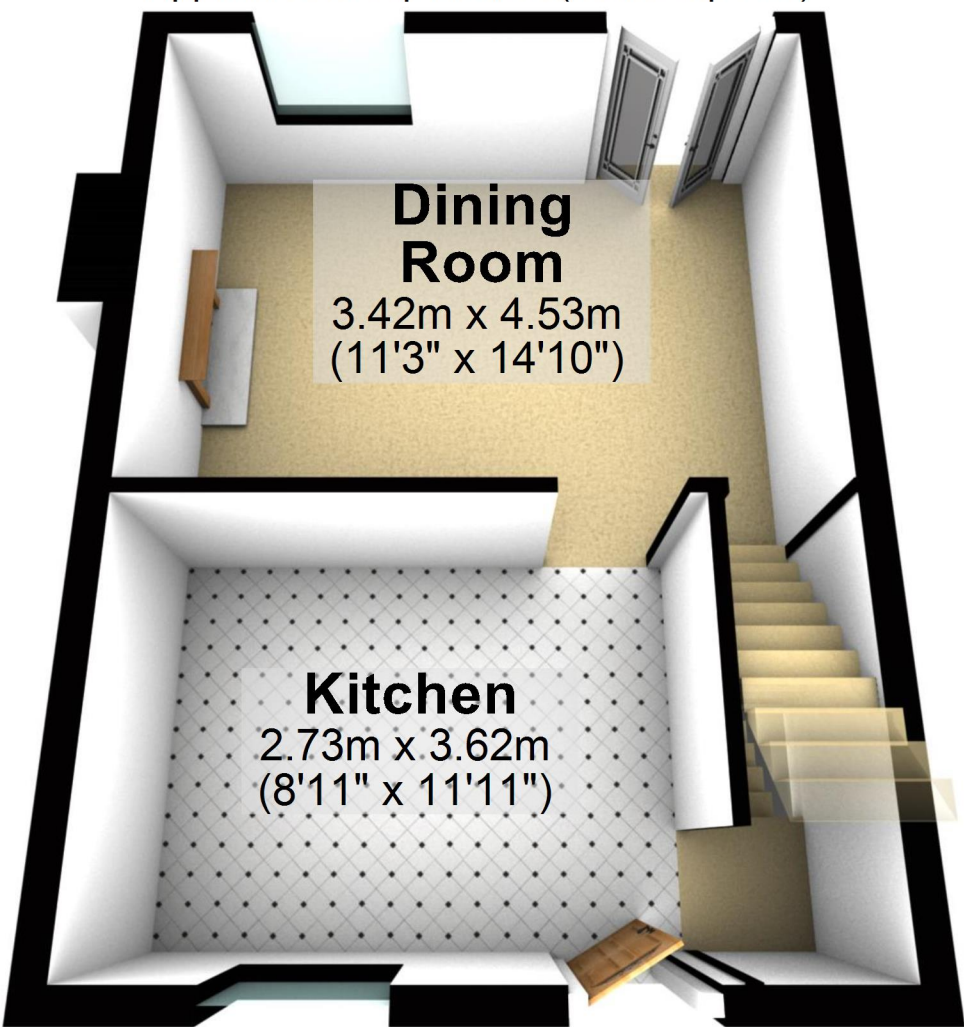

# First Floor

Approx. 28.3 sq. metres (304.8 sq. feet)

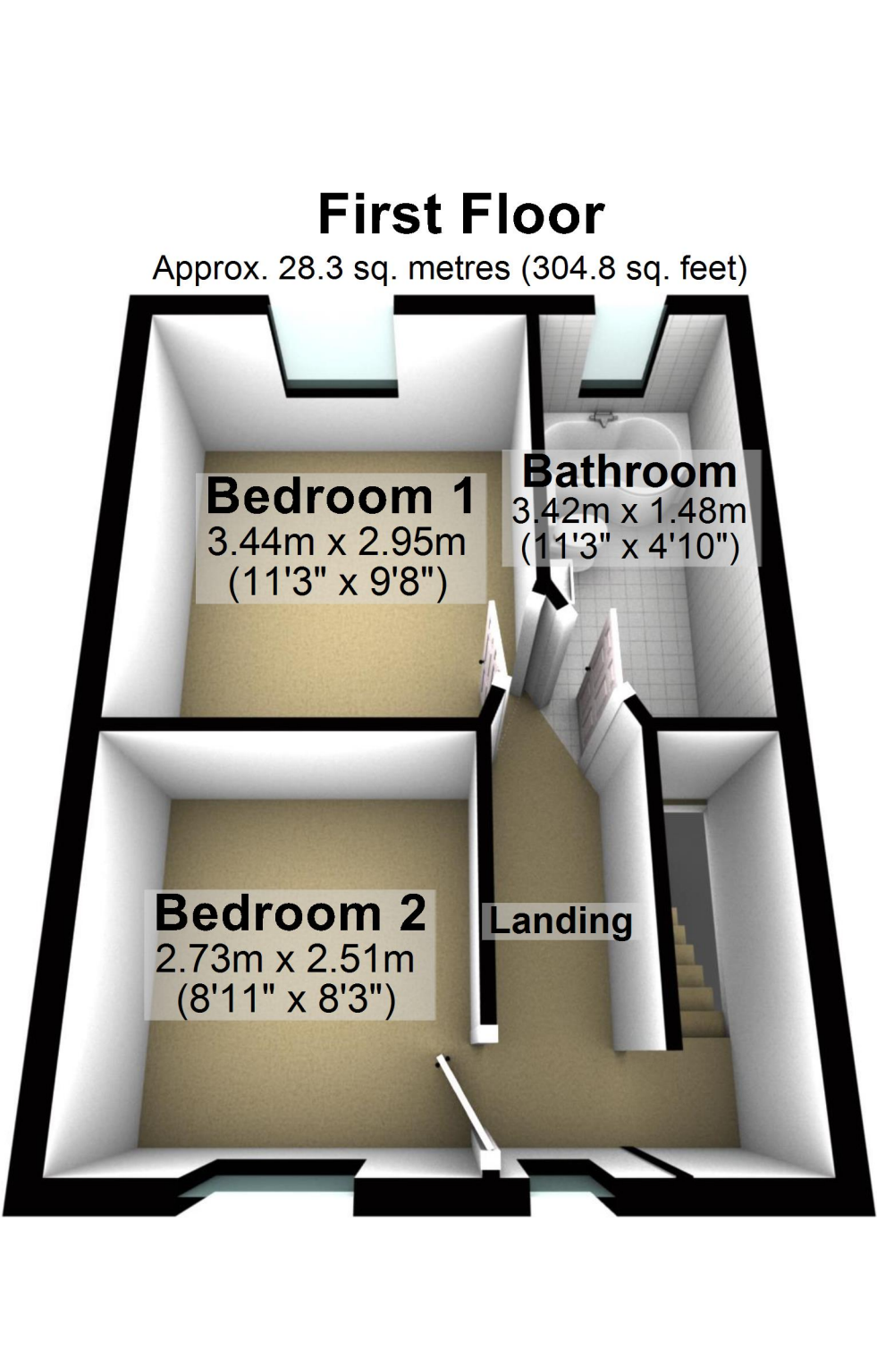

**Bedroom 1**  
3.44m x 2.95m  
(11'3" x 9'8")

**Bathroom**  
3.42m x 1.48m  
(11'3" x 4'10")

**Bedroom 2**  
2.73m x 2.51m  
(8'11" x 8'3")

**Landing**