

Ground Floor

Approx. 41.1 sq. metres (442.4 sq. feet)

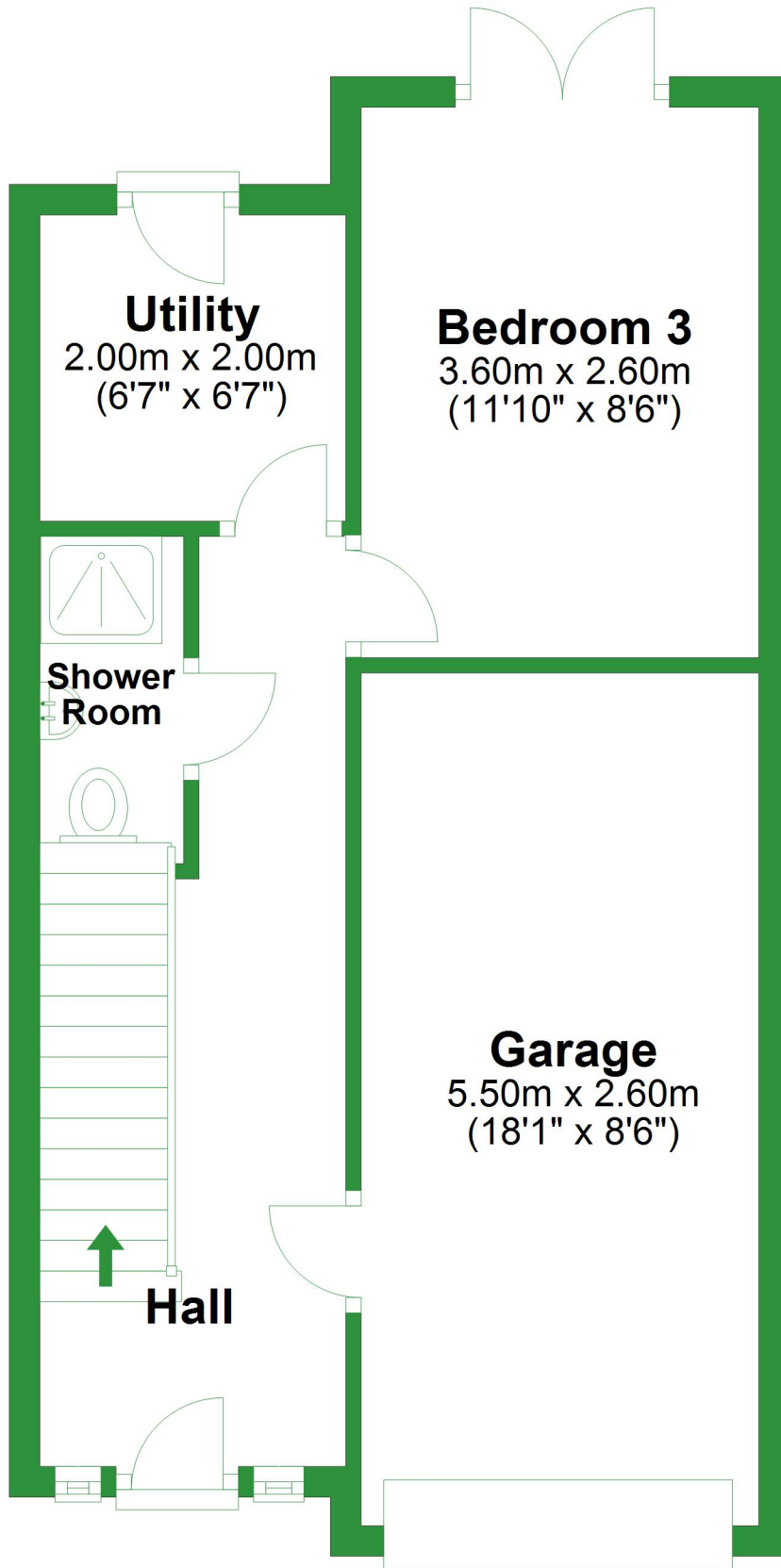

Total area: approx. 123.7 sq. metres (1331.8 sq. feet)

For illustrative purposes only. Not to scale. All sizes are approximate.
Plan produced using PlanUp.

First Floor

Approx. 41.3 sq. metres (444.7 sq. feet)

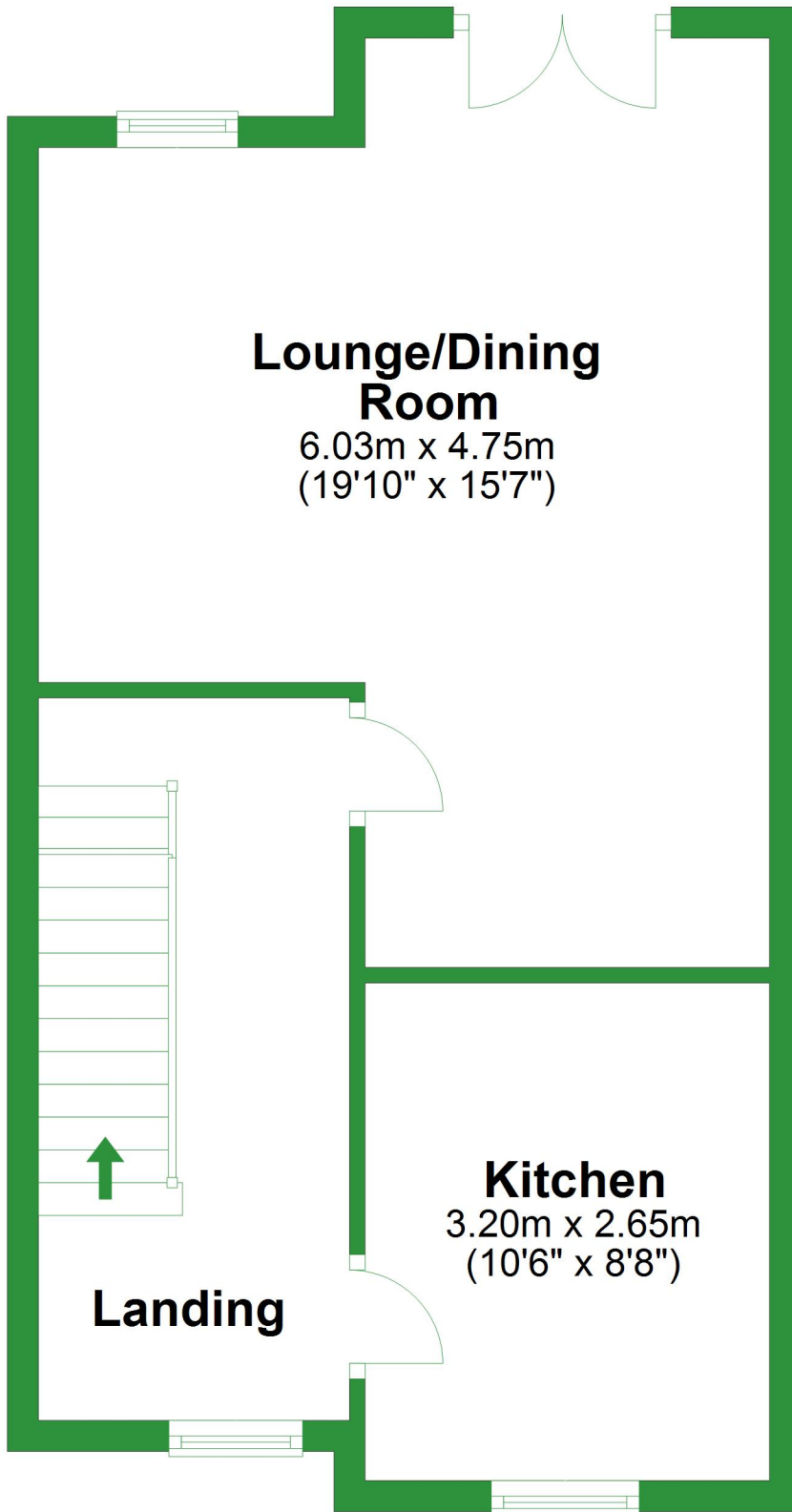

Lounge/Dining Room

6.03m x 4.75m
(19'10" x 15'7")

Kitchen

3.20m x 2.65m
(10'6" x 8'8")

Landing

Second Floor

Approx. 41.3 sq. metres (444.6 sq. feet)

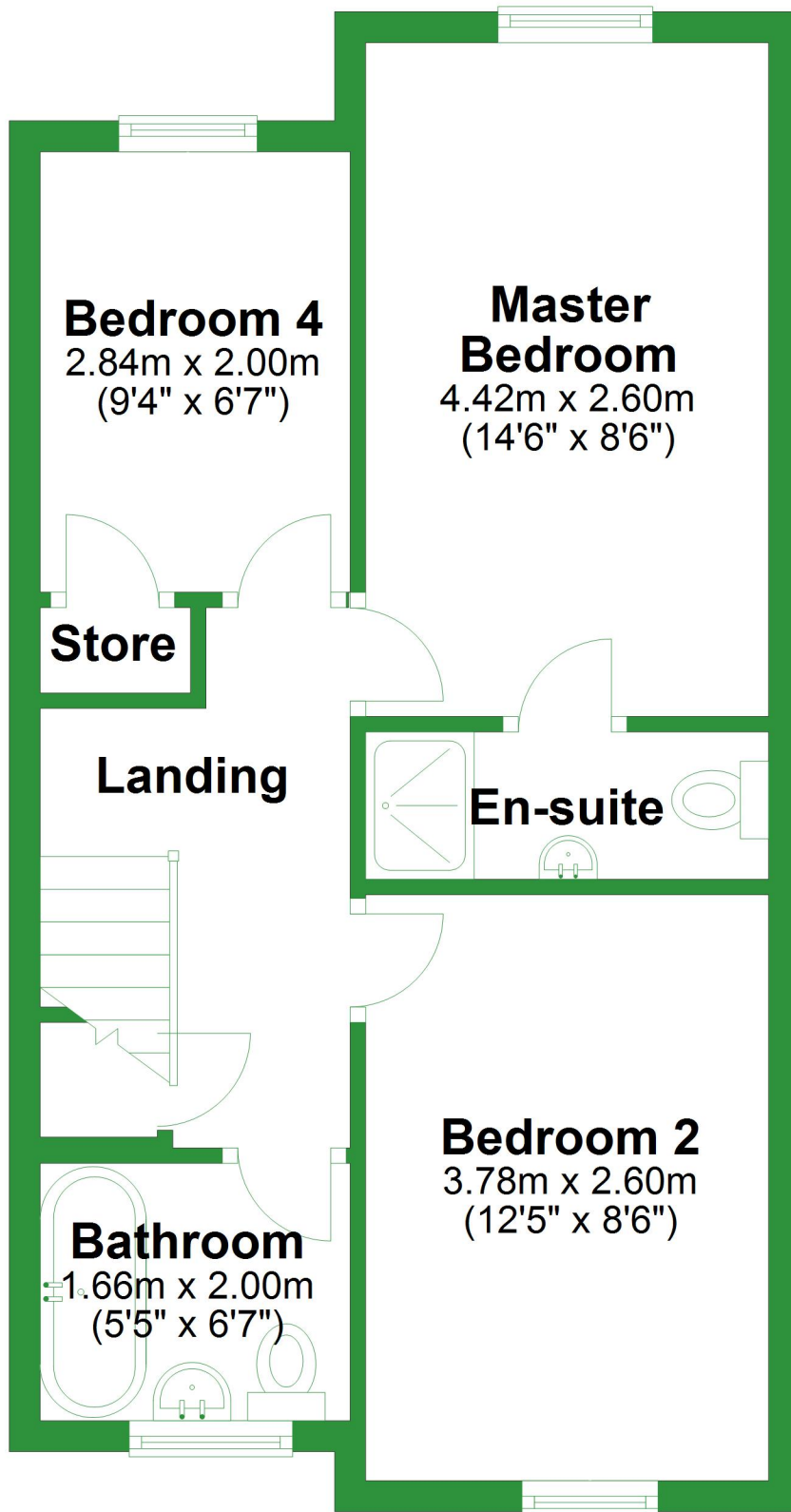

Ground Floor

Approx. 41.1 sq. metres (442.4 sq. feet)

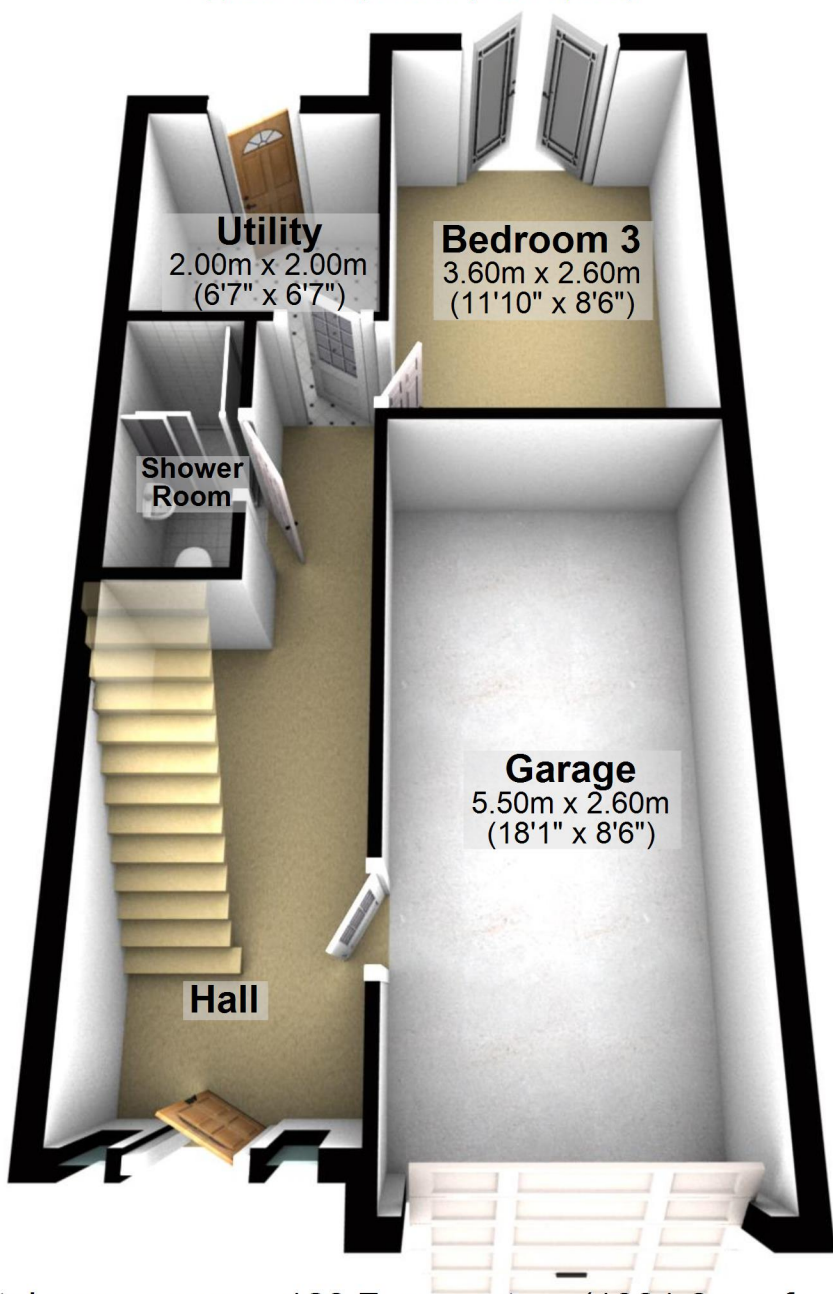

Total area: approx. 123.7 sq. metres (1331.8 sq. feet)

For illustrative purposes only. Not to scale. All sizes are approximate.

Plan produced using PlanUp.

First Floor

Approx. 41.3 sq. metres (444.7 sq. feet)

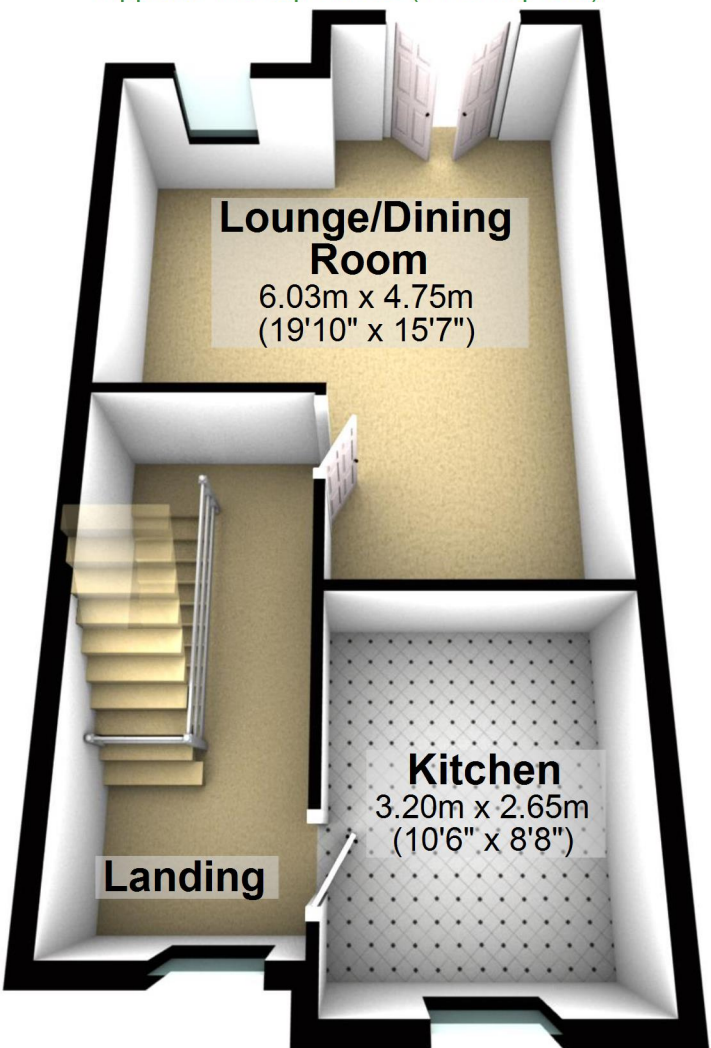

Lounge/Dining Room

6.03m x 4.75m
(19'10" x 15'7")

Landing

Kitchen

3.20m x 2.65m
(10'6" x 8'8")

Second Floor

Approx. 41.3 sq. metres (444.6 sq. feet)

