

# Ground Floor

Approx. 63.5 sq. metres (683.2 sq. feet)

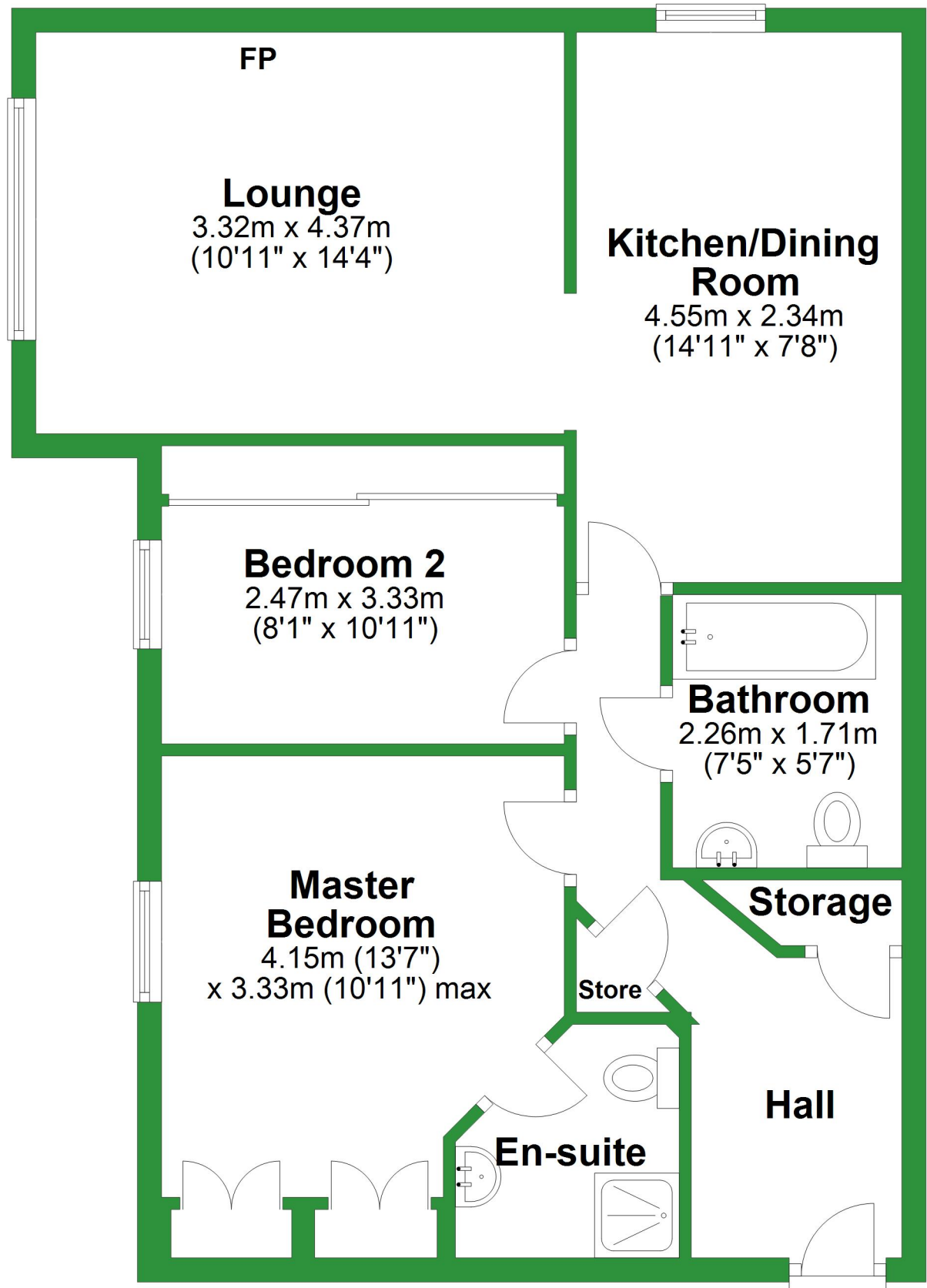

Total area: approx. 63.5 sq. metres (683.2 sq. feet)

For illustrative purposes only. Not to scale. All sizes are approximate.

Plan produced using PlanUp.

# Ground Floor

Approx. 63.5 sq. metres (683.2 sq. feet)

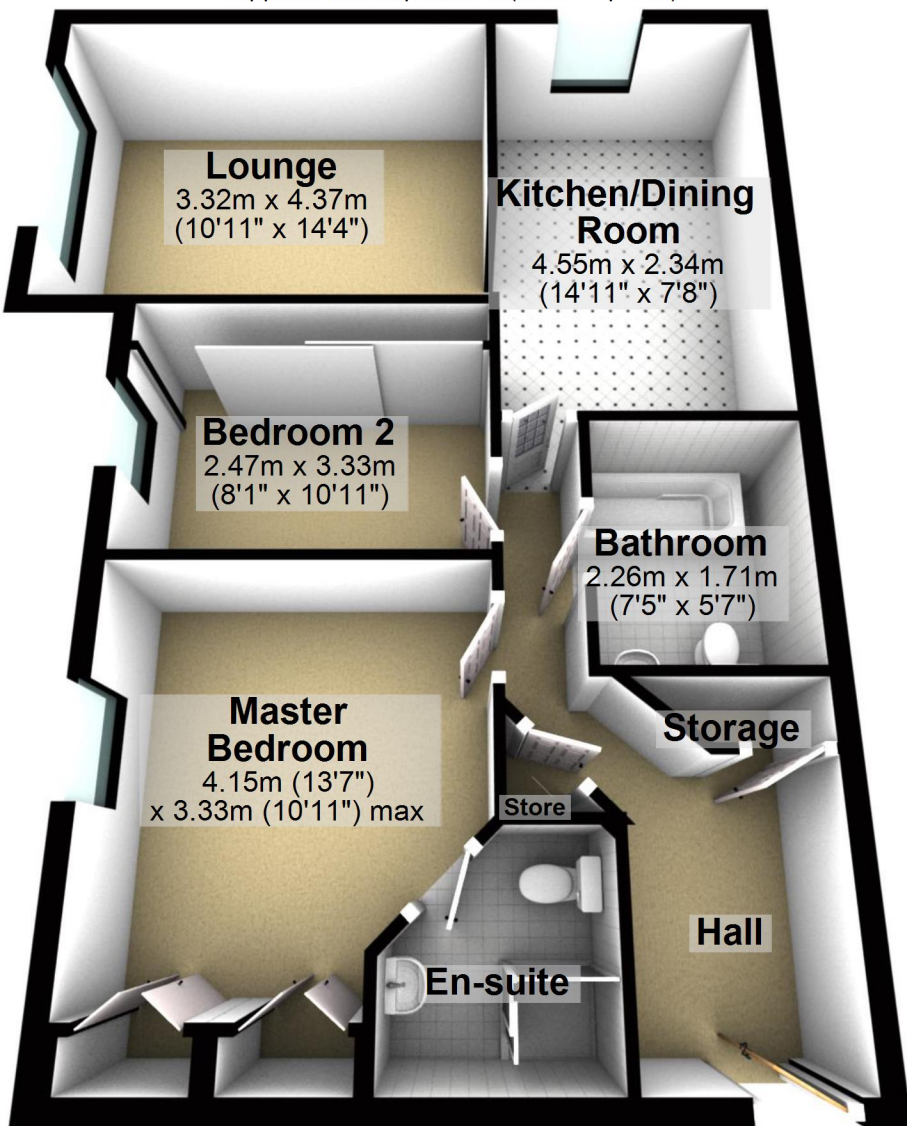

Total area: approx. 63.5 sq. metres (683.2 sq. feet)

For illustrative purposes only. Not to scale. All sizes are approximate.

Plan produced using PlanUp.