

# Ground Floor

Approx. 74.7 sq. metres (804.3 sq. feet)

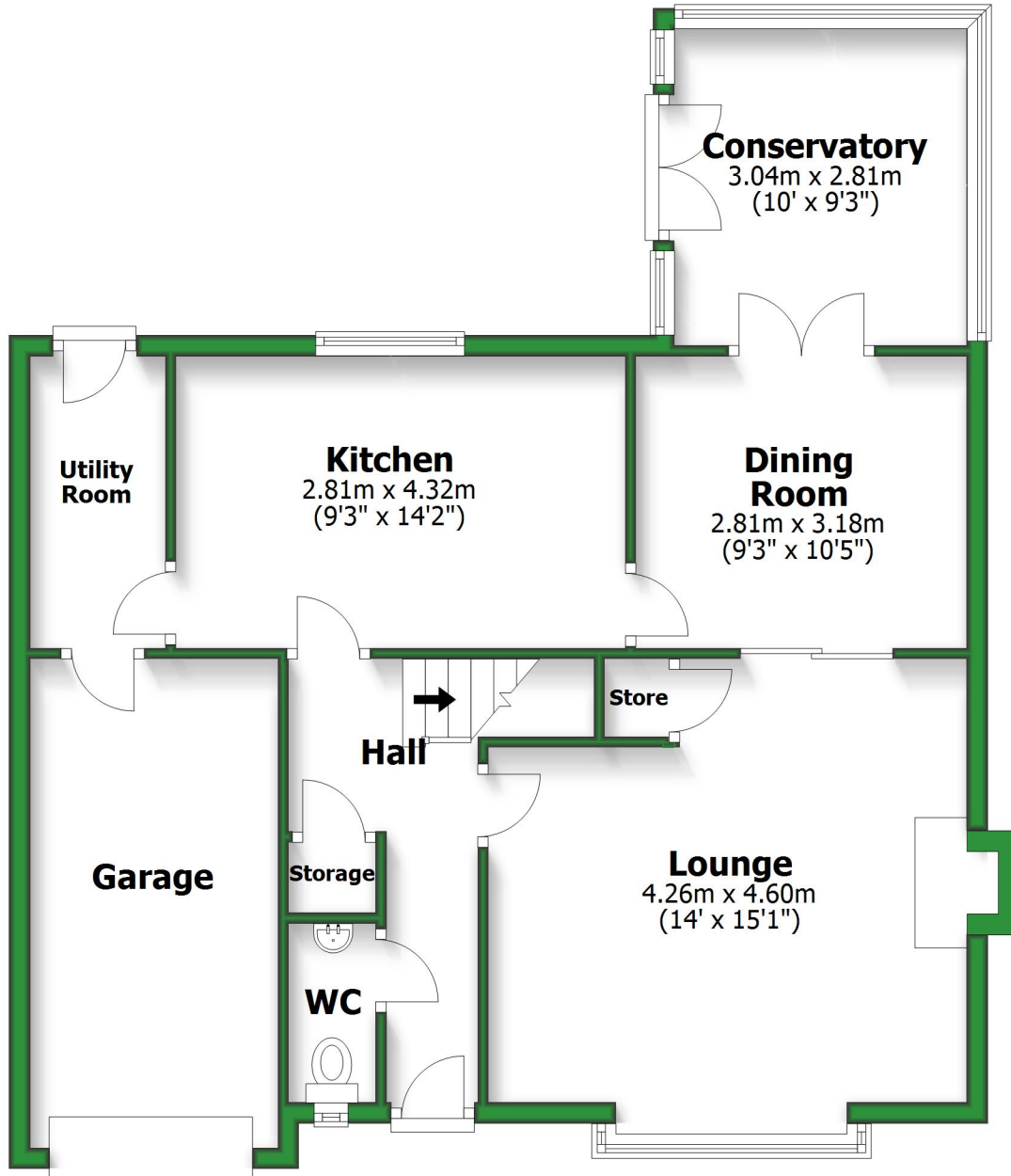

Total area: approx. 123.6 sq. metres (1330.4 sq. feet)

For illustrative purposes only. Not to scale. All sizes are approximate.

Plan produced using PlanUp.

# First Floor

Approx. 48.9 sq. metres (526.1 sq. feet)

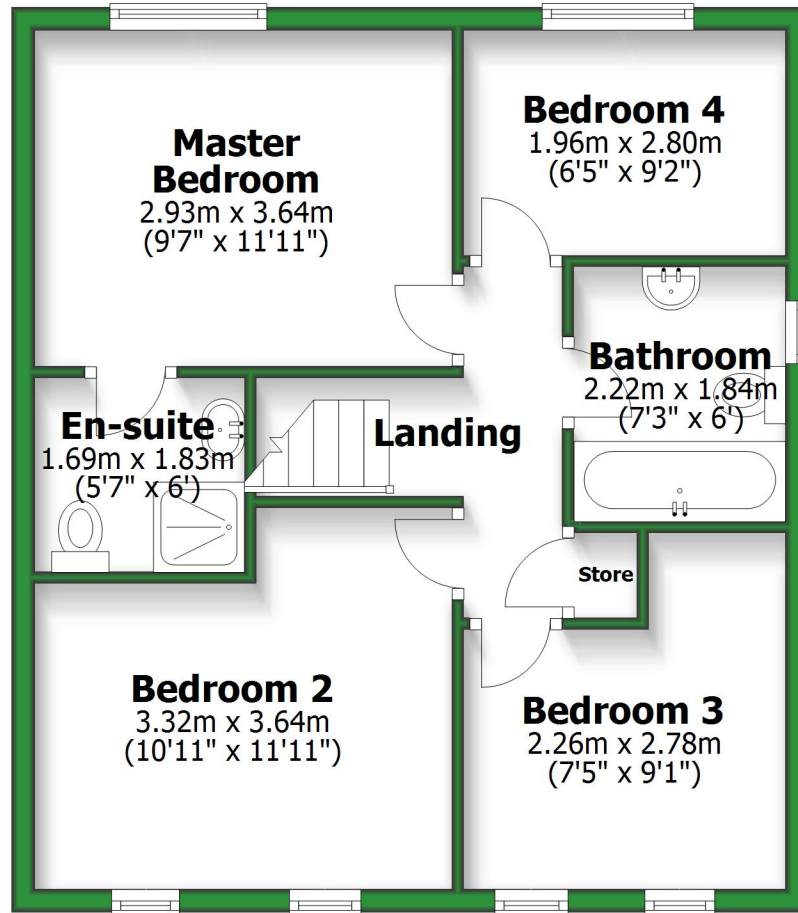

# Ground Floor

Approx. 74.7 sq. metres (804.3 sq. feet)

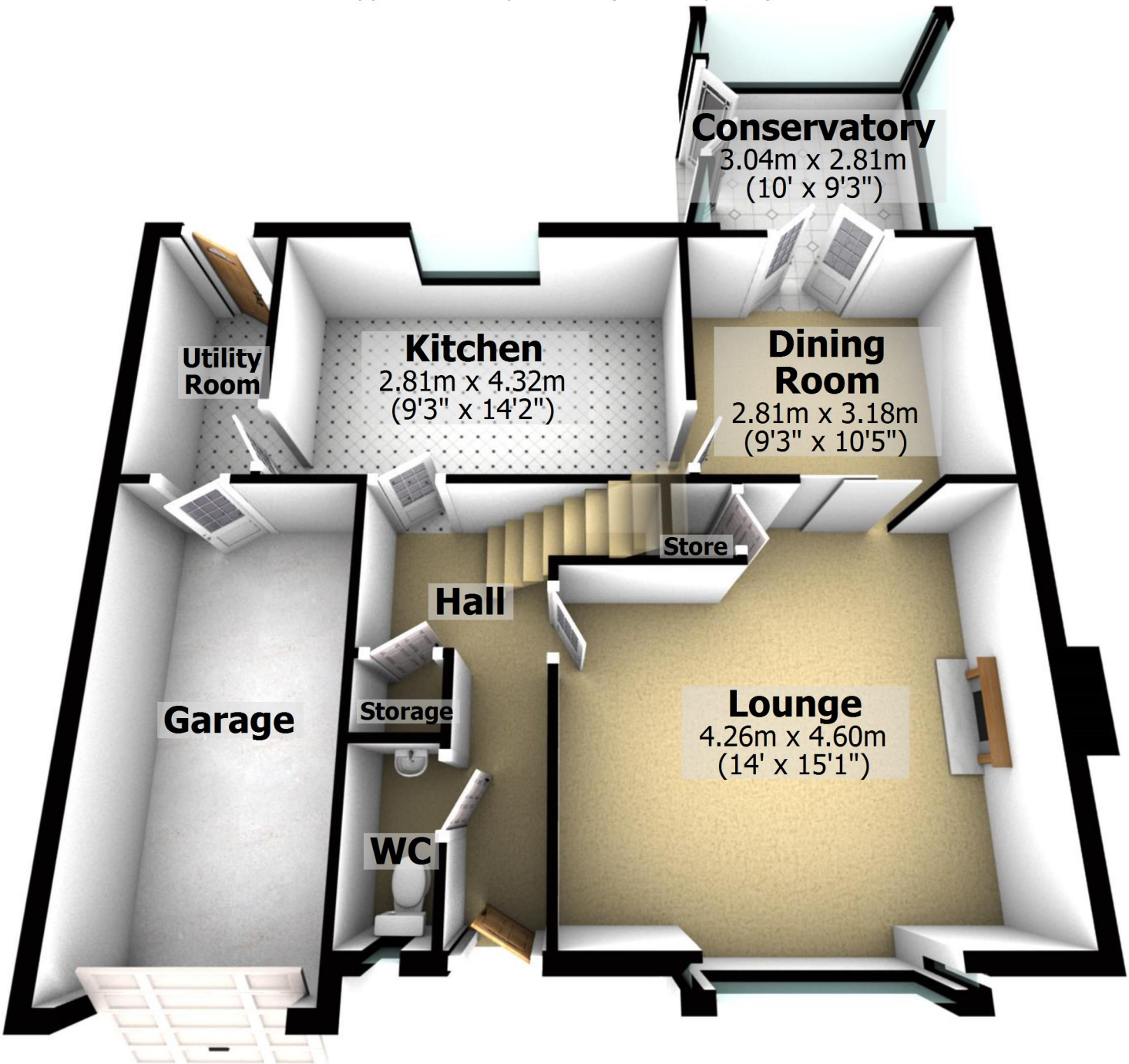

Total area: approx. 123.6 sq. metres (1330.4 sq. feet)

For illustrative purposes only. Not to scale. All sizes are approximate.  
Plan produced using PlanUp.

# First Floor

Approx. 48.9 sq. metres (526.1 sq. feet)

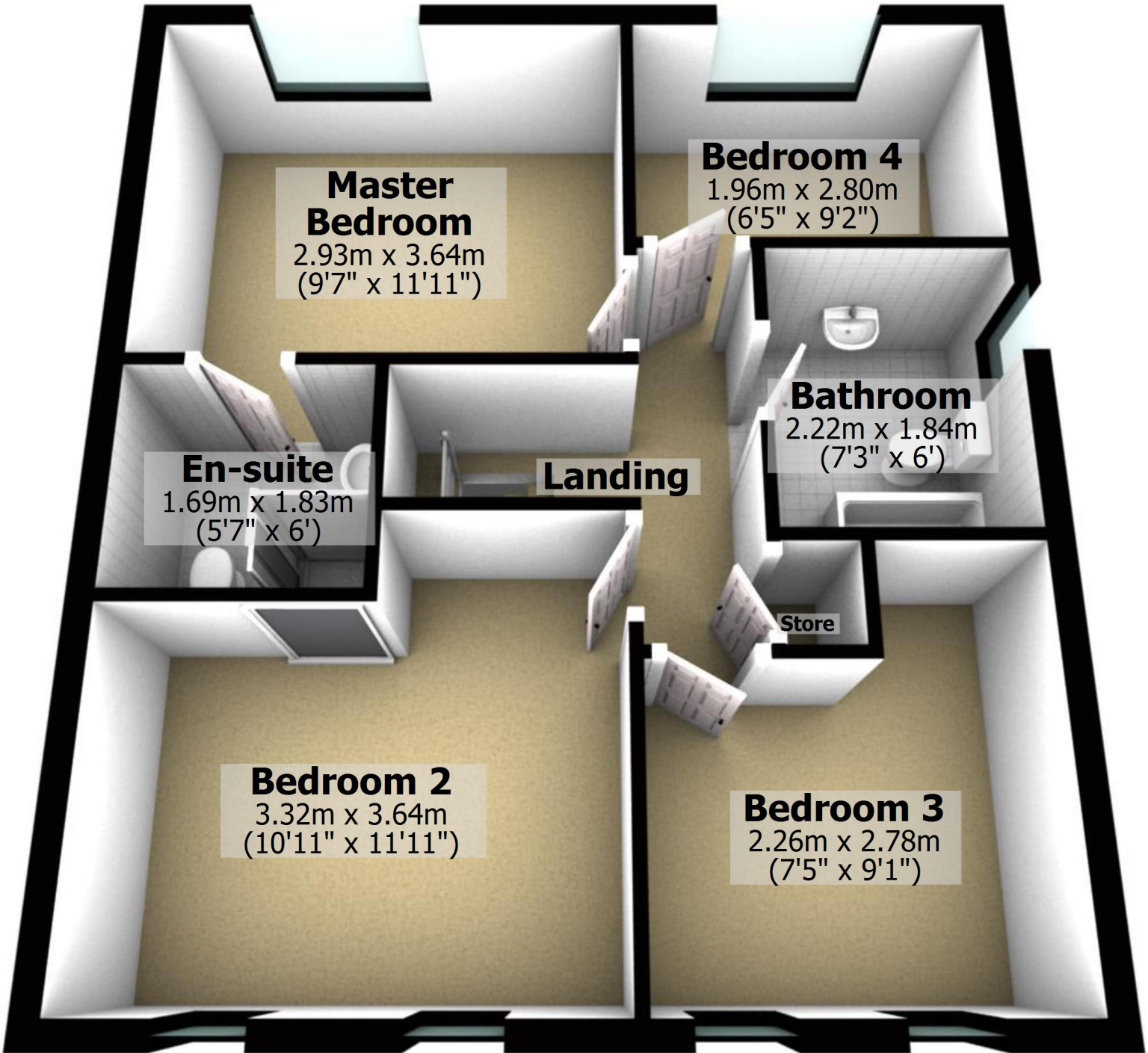

**Master Bedroom**  
2.93m x 3.64m  
(9'7" x 11'11")

**Bedroom 4**  
1.96m x 2.80m  
(6'5" x 9'2")

**En-suite**  
1.69m x 1.83m  
(5'7" x 6')

**Landing**

**Bathroom**  
2.22m x 1.84m  
(7'3" x 6')

**Store**

**Bedroom 2**  
3.32m x 3.64m  
(10'11" x 11'11")

**Bedroom 3**  
2.26m x 2.78m  
(7'5" x 9'1")