

# Ground Floor

Approx. 47.6 sq. metres (512.0 sq. feet)

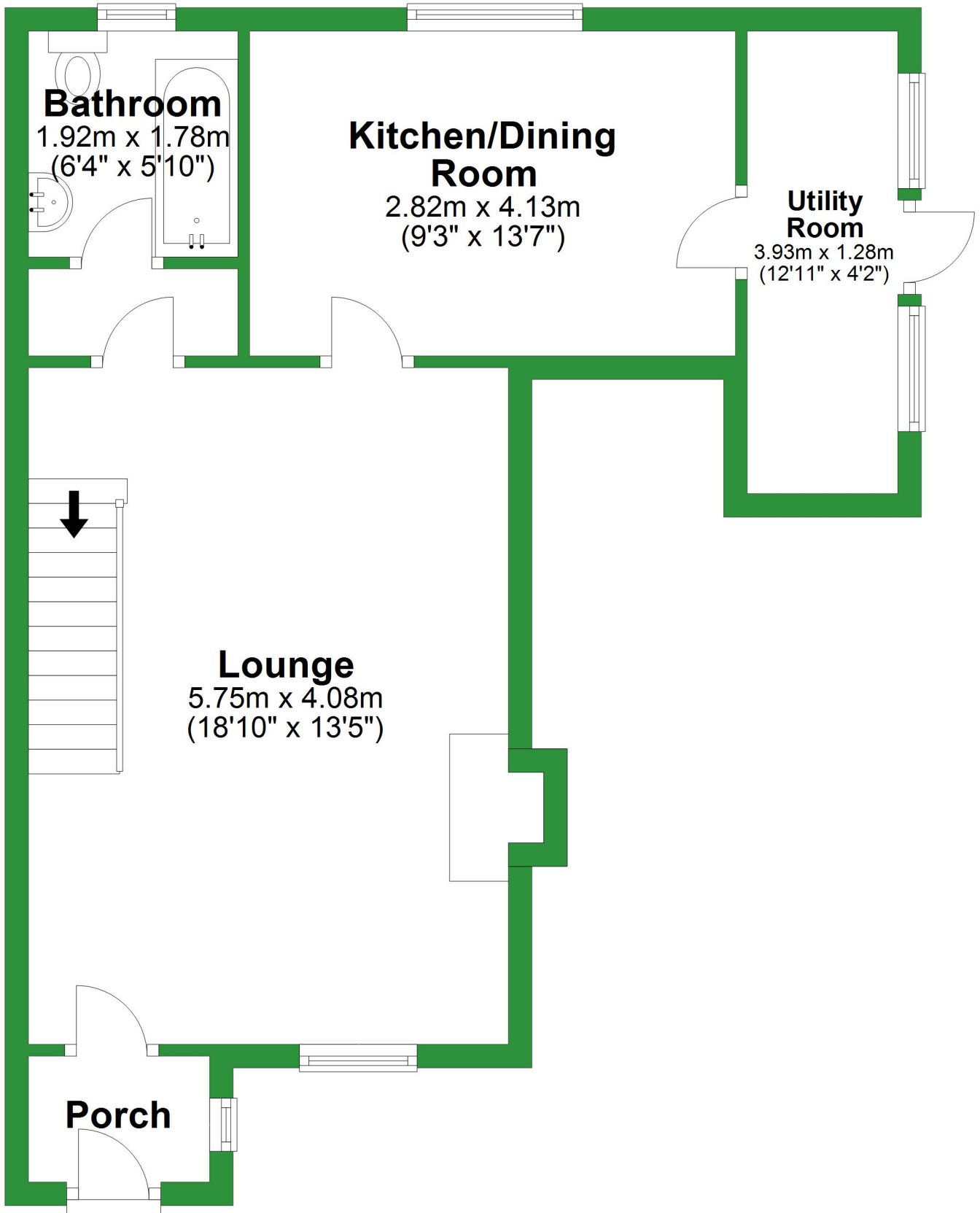

Total area: approx. 70.3 sq. metres (756.9 sq. feet)

For illustrative purposes only. Not to scale. All sizes are approximate.  
Plan produced using PlanUp.

# First Floor

Approx. 22.8 sq. metres (245.0 sq. feet)

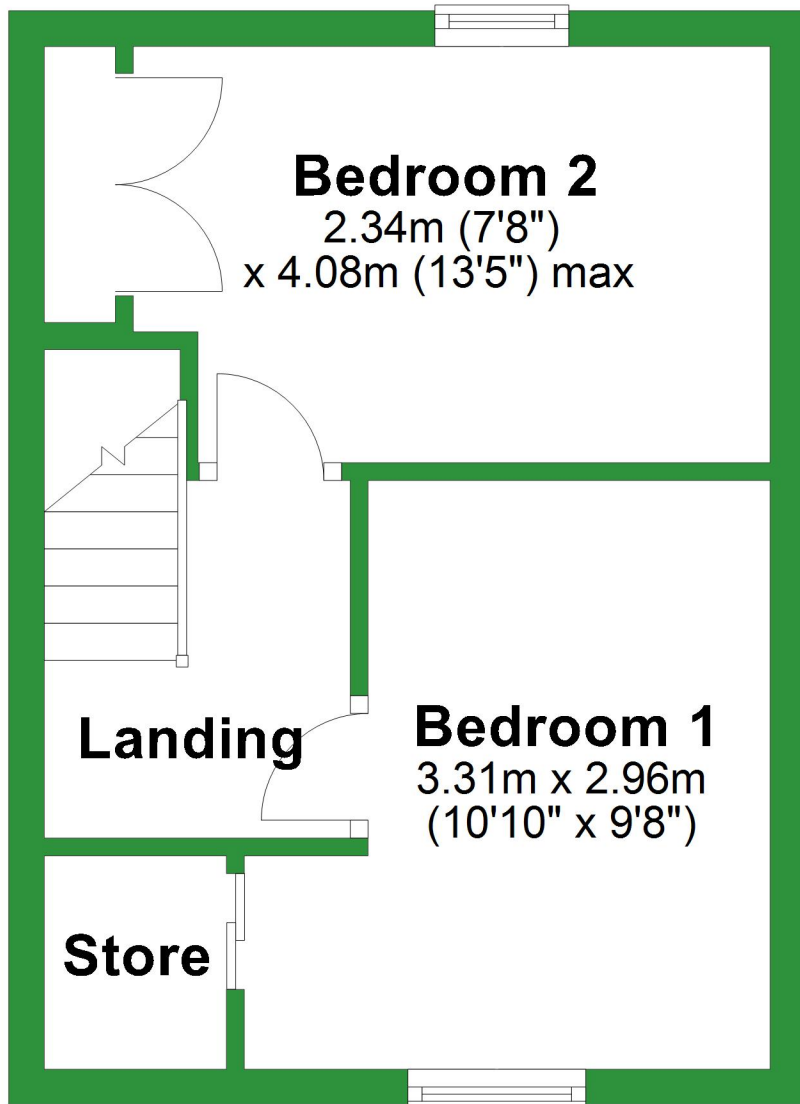

# Ground Floor

Approx. 47.6 sq. metres (512.0 sq. feet)

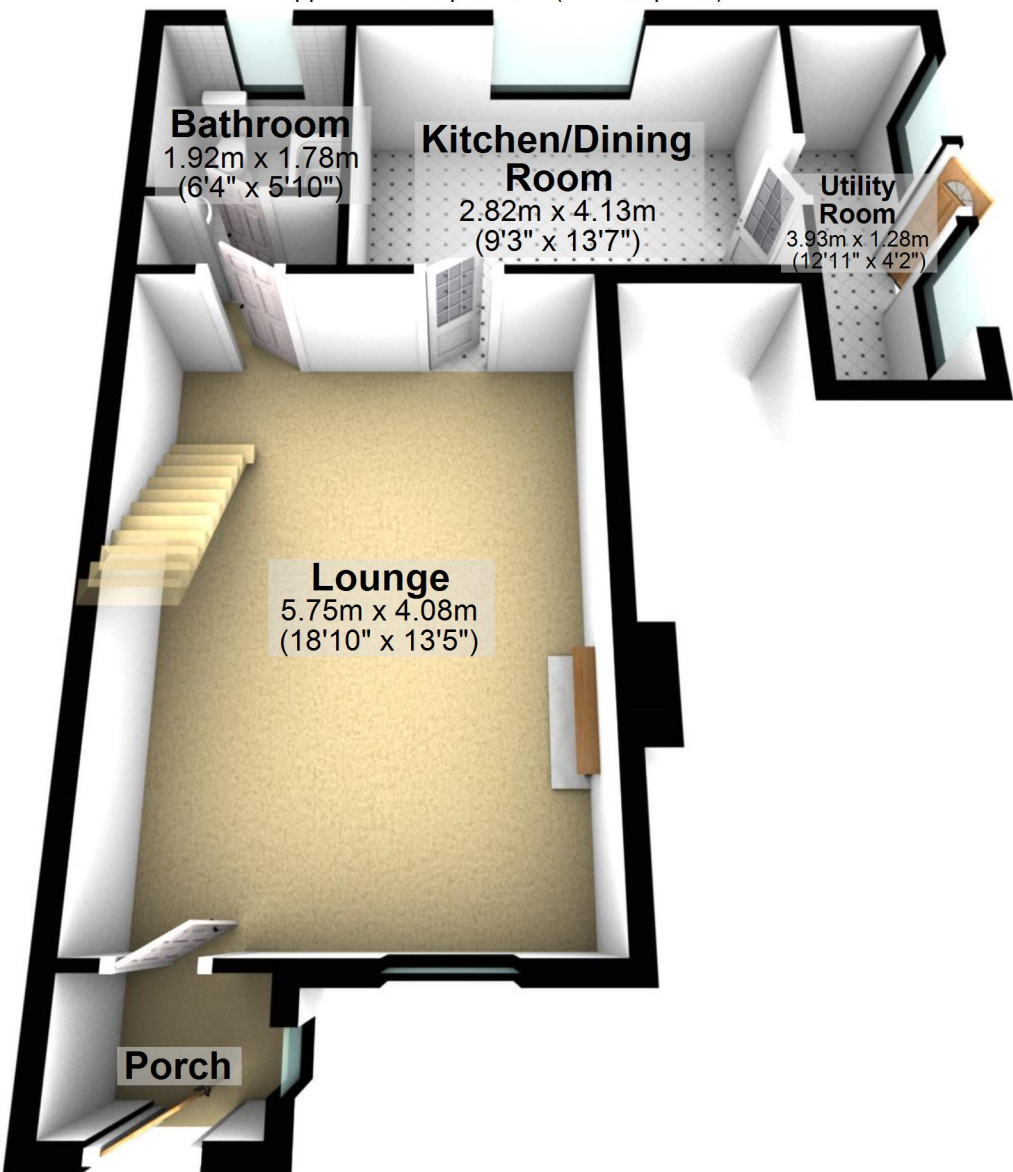

Total area: approx. 70.3 sq. metres (756.9 sq. feet)

For illustrative purposes only. Not to scale. All sizes are approximate.

Plan produced using PlanUp.

# First Floor

Approx. 22.8 sq. metres (245.0 sq. feet)

## Bedroom 2

2.34m (7'8")  
x 4.08m (13'5") max

## Landing

## Bedroom 1

3.31m x 2.96m  
(10'10" x 9'8")

## Store

