

# Ground Floor

Approx. 48.1 sq. metres (517.3 sq. feet)

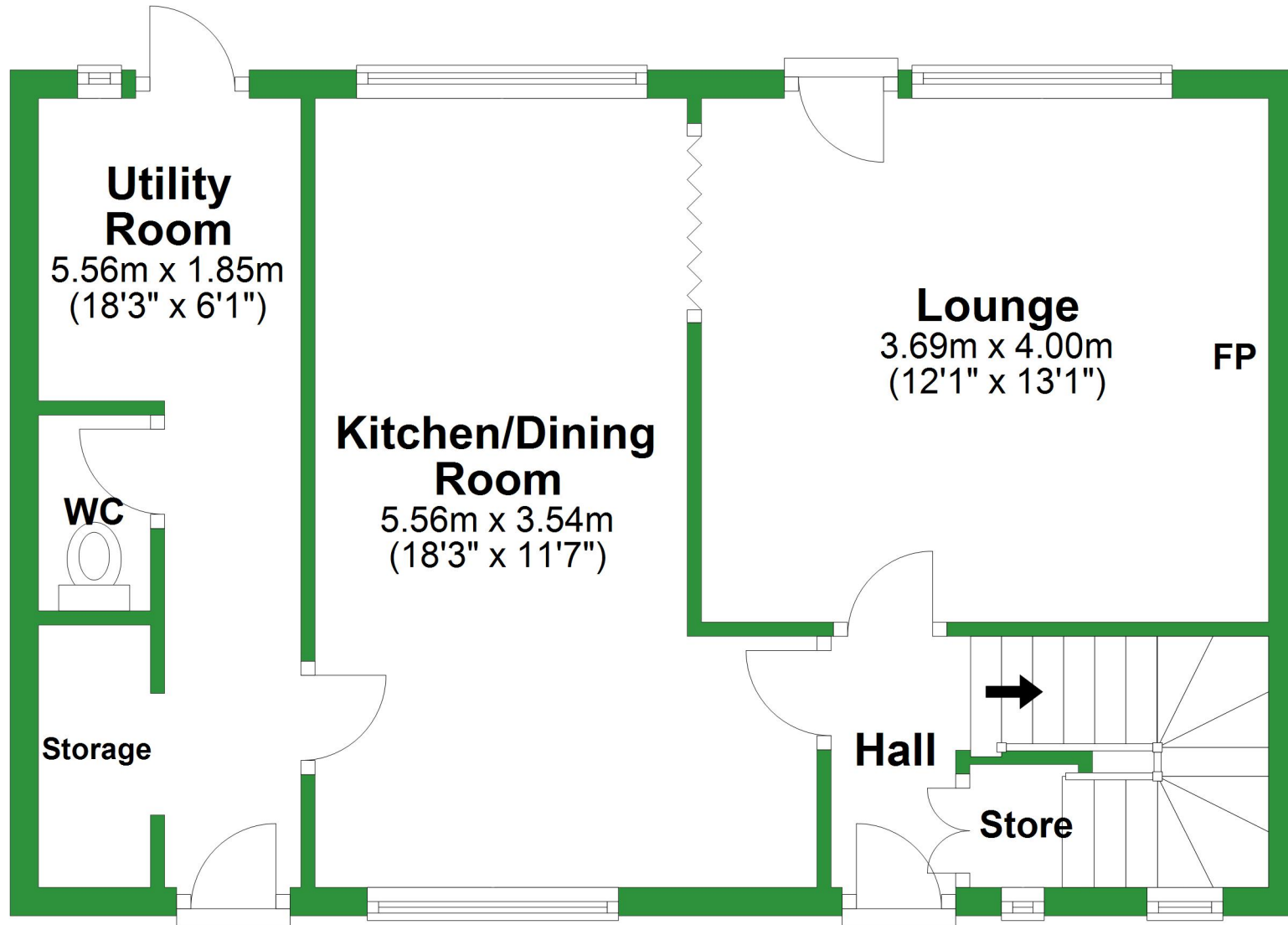

Total area: approx. 96.3 sq. metres (1036.9 sq. feet)

For illustrative purposes only. Not to scale. All sizes are approximate.  
Plan produced using PlanUp.

# First Floor

Approx. 48.3 sq. metres (519.5 sq. feet)

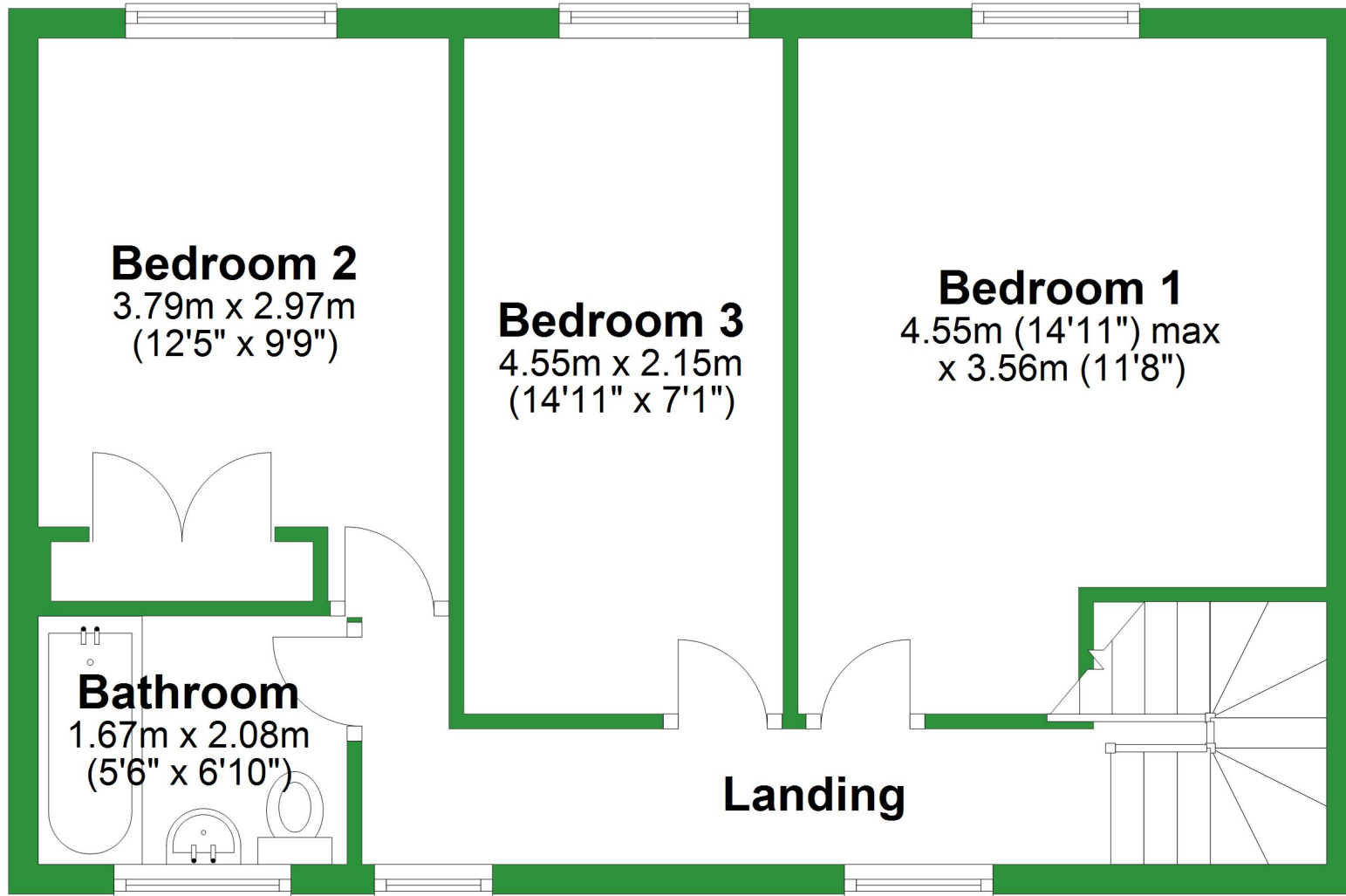

# Ground Floor

Approx. 48.1 sq. metres (517.3 sq. feet)

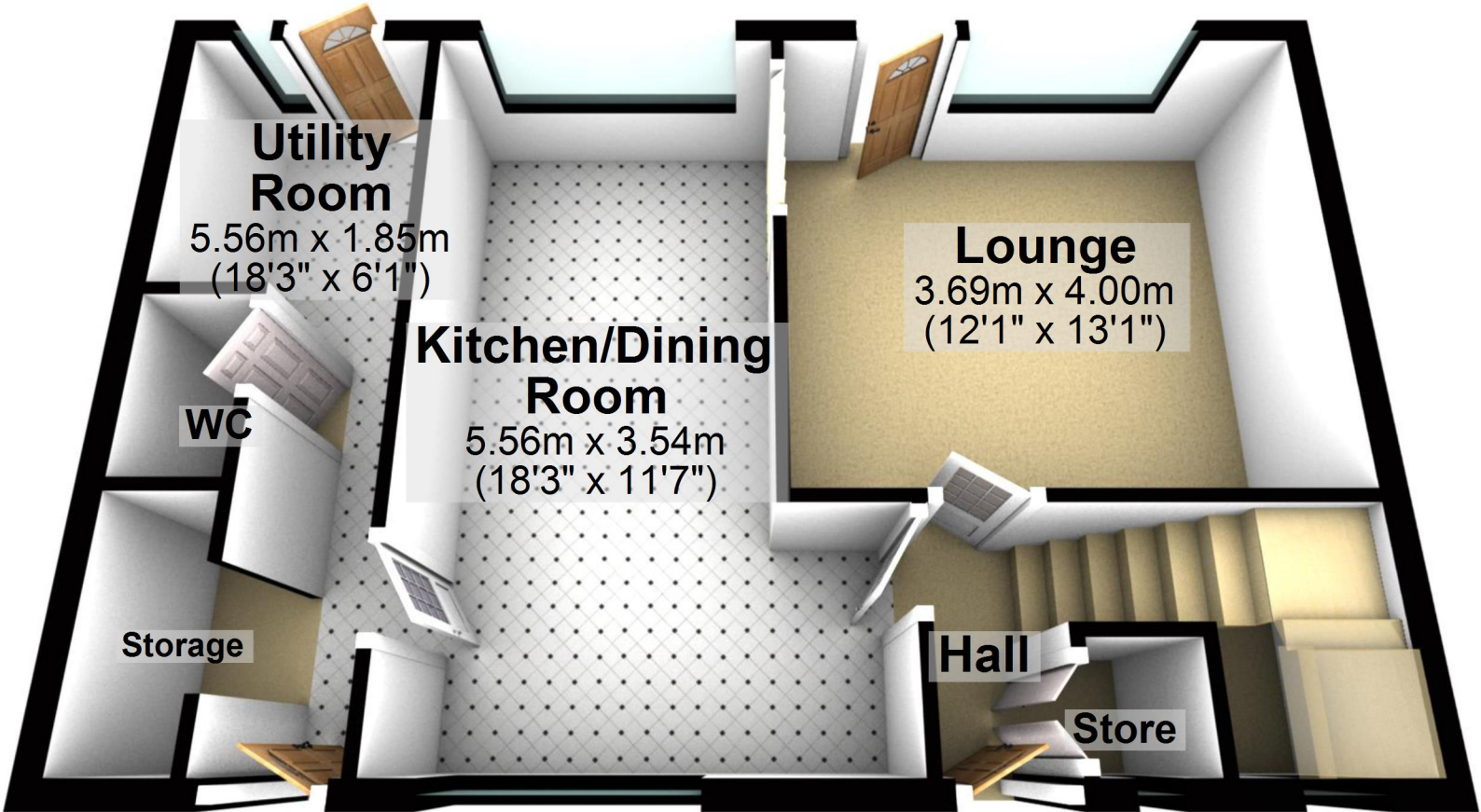

Total area: approx. 96.3 sq. metres (1036.9 sq. feet)

For illustrative purposes only. Not to scale. All sizes are approximate.  
Plan produced using PlanUp.

# First Floor

Approx. 48.3 sq. metres (519.5 sq. feet)

## Bedroom 2

3.79m x 2.97m  
(12'5" x 9'9")

## Bedroom 3

4.55m x 2.15m  
(14'11" x 7'1")

## Bedroom 1

4.55m (14'11") max  
x 3.56m (11'8")

## Bathroom

1.67m x 2.08m  
(5'6" x 6'10")

## Landing

