

# Ground Floor

Approx. 48.9 sq. metres (526.2 sq. feet)

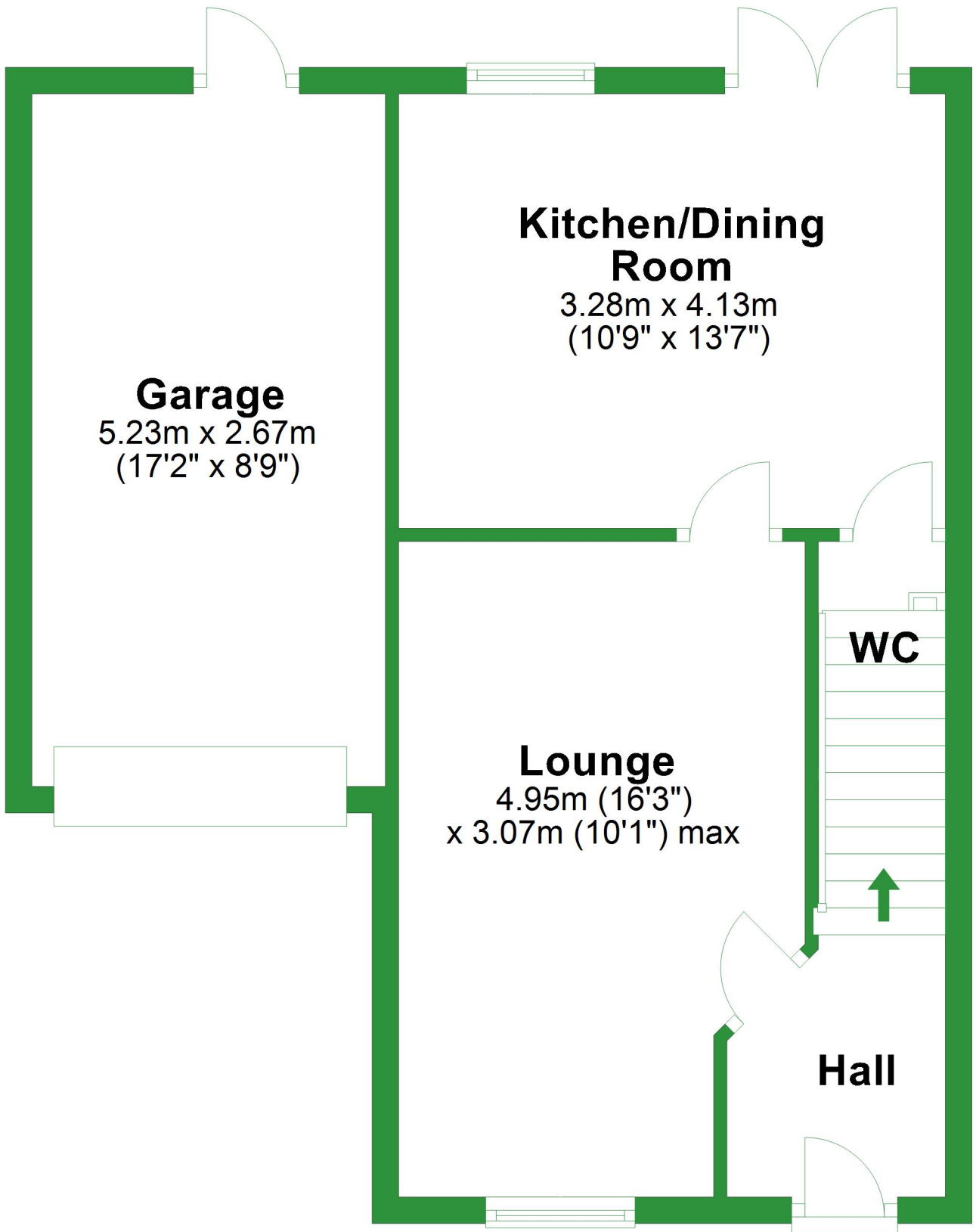

Total area: approx. 83.3 sq. metres (896.6 sq. feet)

For illustrative purposes only. Not to scale. All sizes are approximate.

Plan produced using PlanUp.

# First Floor

Approx. 34.4 sq. metres (370.3 sq. feet)

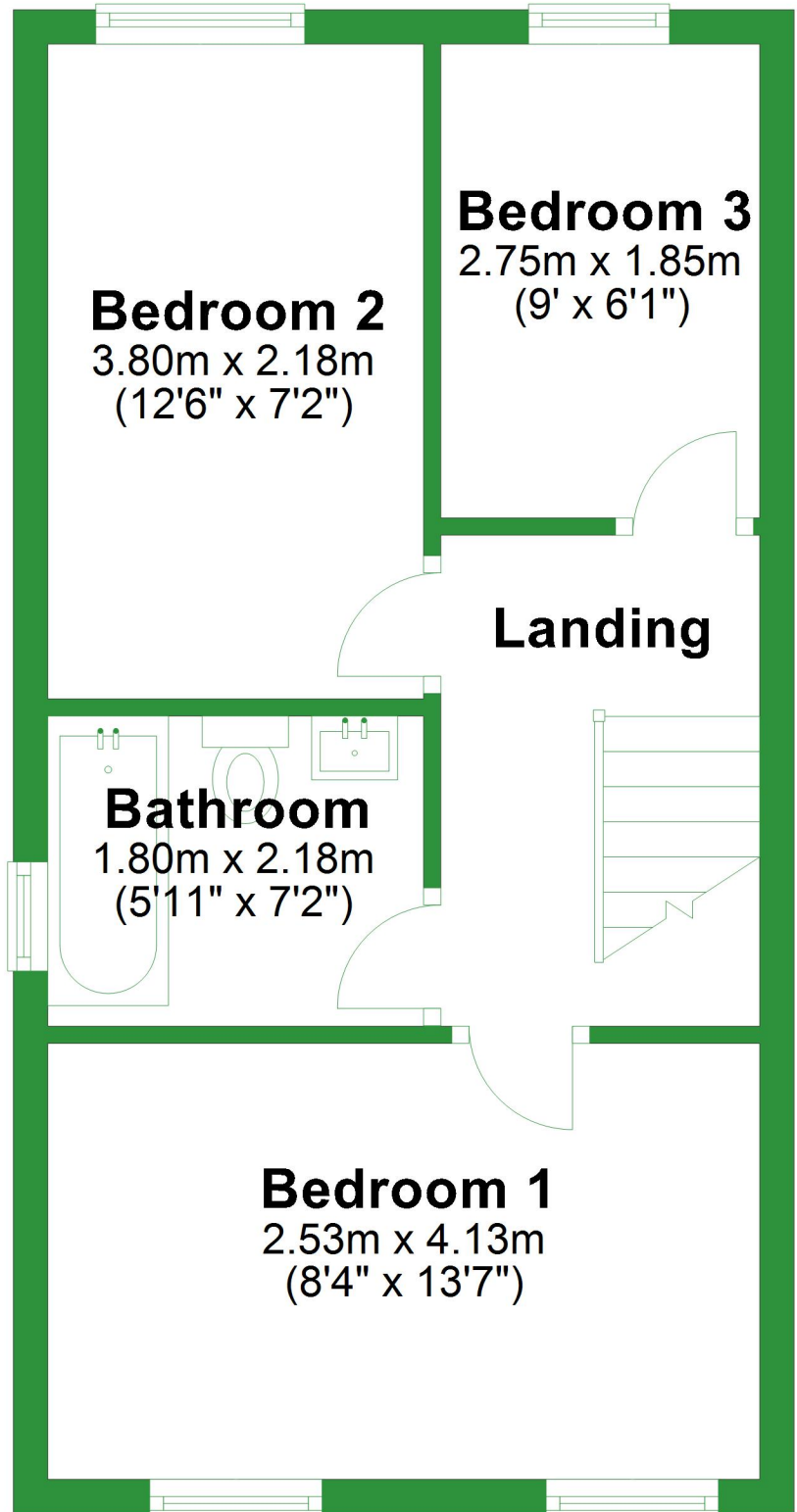

## Ground Floor

Approx. 48.9 sq. metres (526.2 sq. feet)

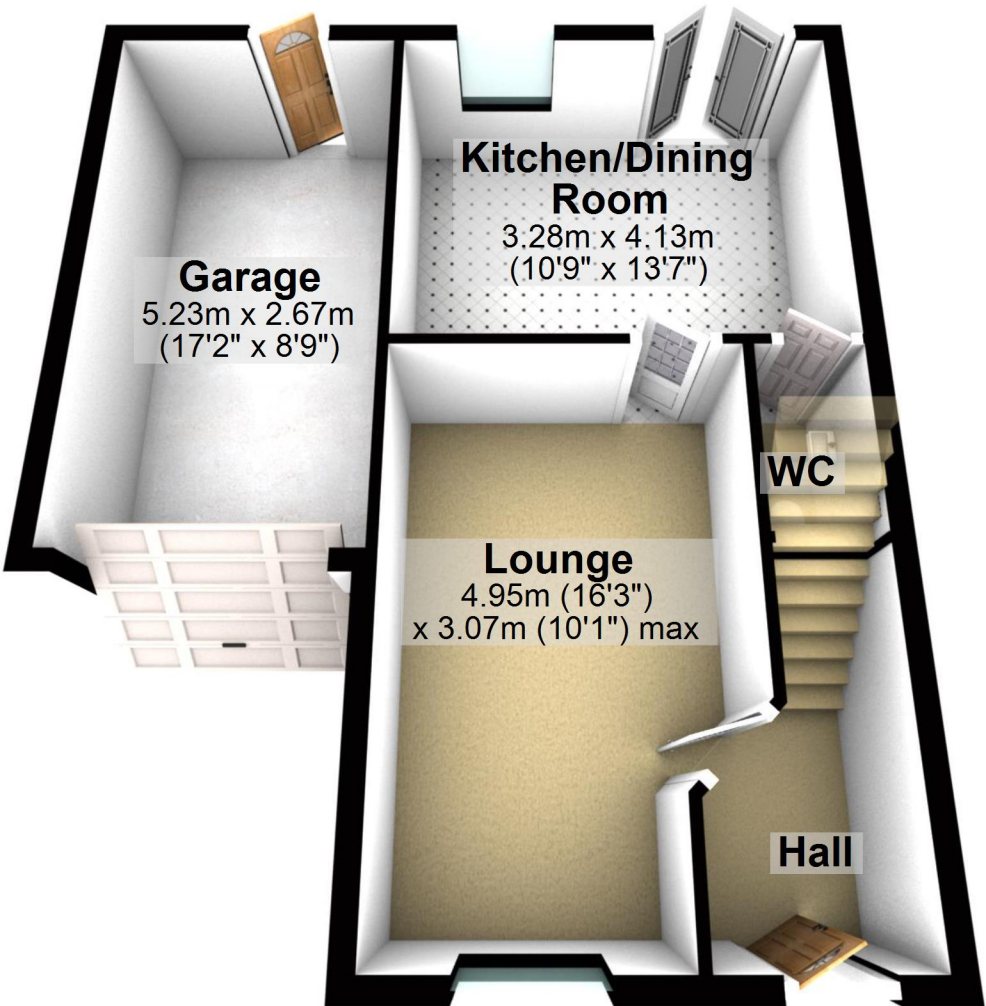

Total area: approx. 83.3 sq. metres (896.6 sq. feet)

For illustrative purposes only. Not to scale. All sizes are approximate.

Plan produced using PlanUp.

# First Floor

Approx. 34.4 sq. metres (370.3 sq. feet)

**Bedroom 2**  
3.80m x 2.18m  
(12'6" x 7'2")

**Bedroom 3**  
2.75m x 1.85m  
(9' x 6'1")

**Landing**

**Bathroom**  
1.80m x 2.18m  
(5'11" x 7'2")

**Bedroom 1**  
2.53m x 4.13m  
(8'4" x 13'7")

