

Ground Floor

Approx. 50.3 sq. metres (540.9 sq. feet)

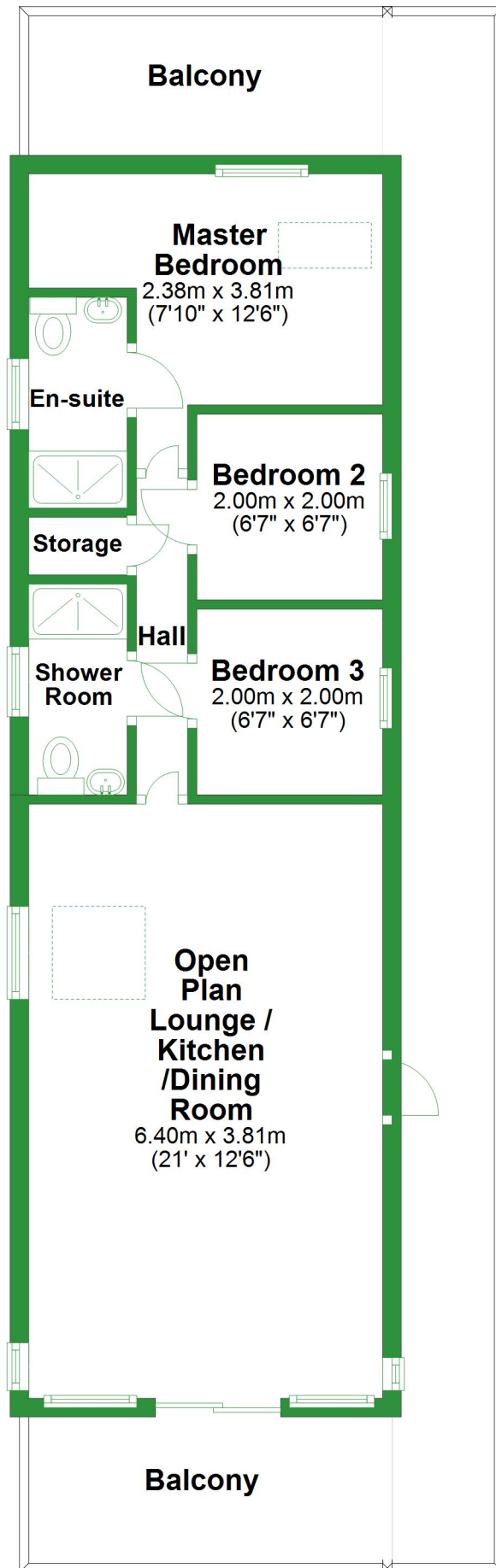

Total area: approx. 50.3 sq. metres (540.9 sq. feet)

For illustrative purposes only. Not to scale. All sizes are approximate.
Plan produced using PlanUp.

Ground Floor

Approx. 50.3 sq. metres (540.9 sq. feet)

Balcony

Master
Bedroom

2.38m x 3.81m
(7'10" x 12'6")

En-suite

Bedroom 2

2.00m x 2.00m
(6'7" x 6'7")

Storage

Hall

Bedroom 3

2.00m x 2.00m
(6'7" x 6'7")

Shower
Room

Open
Plan
Lounge /
Kitchen
/Dining
Room

6.40m x 3.81m
(21' x 12'6")

Balcony

Total area: approx. 50.3 sq. metres (540.9 sq. feet)

For illustrative purposes only. Not to scale. All sizes are approximate.

Plan produced using PlanUp.