

Ground Floor

Approx. 49.6 sq. metres (533.6 sq. feet)

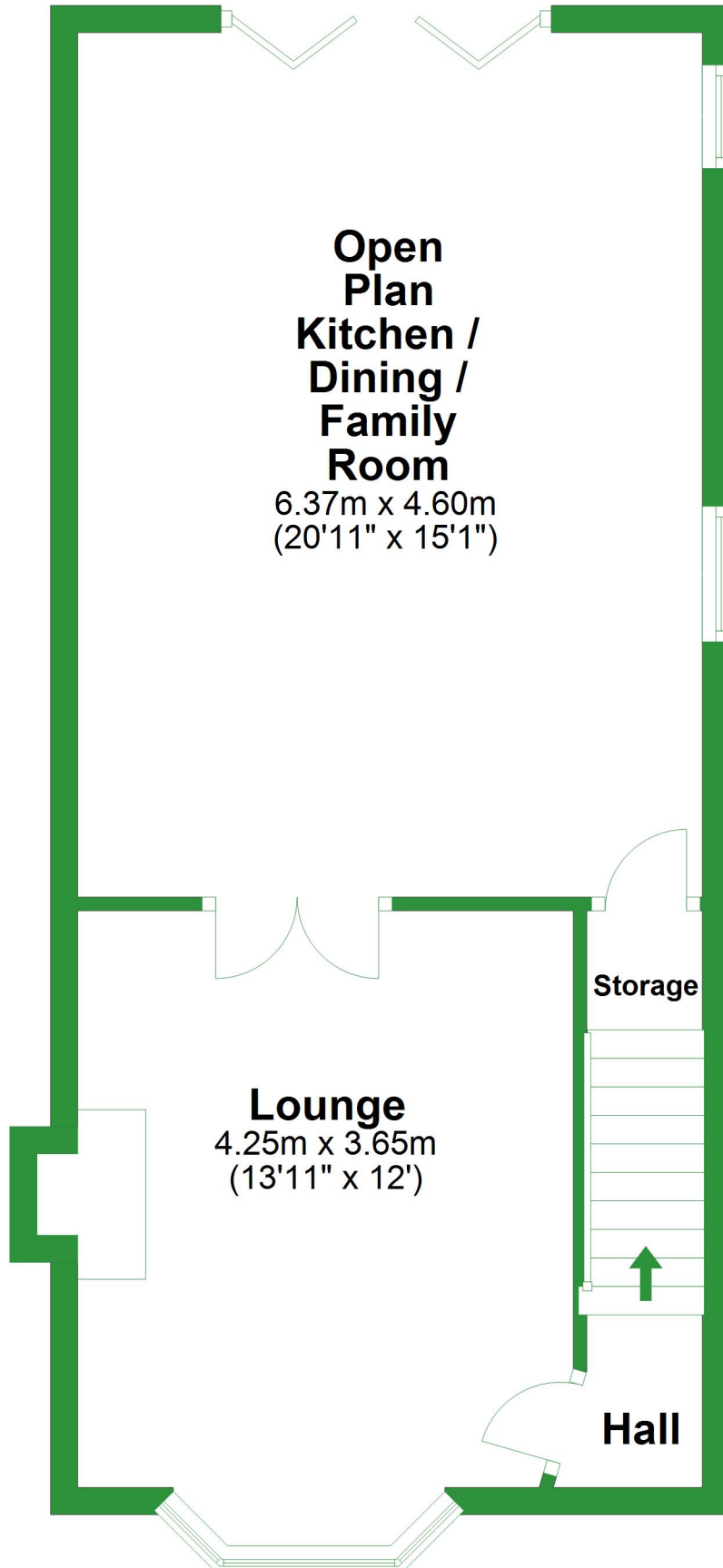

Total area: approx. 84.5 sq. metres (909.4 sq. feet)

For illustrative purposes only. Not to scale. All sizes are approximate.
Plan produced using PlanUp.

First Floor

Approx. 34.9 sq. metres (375.8 sq. feet)

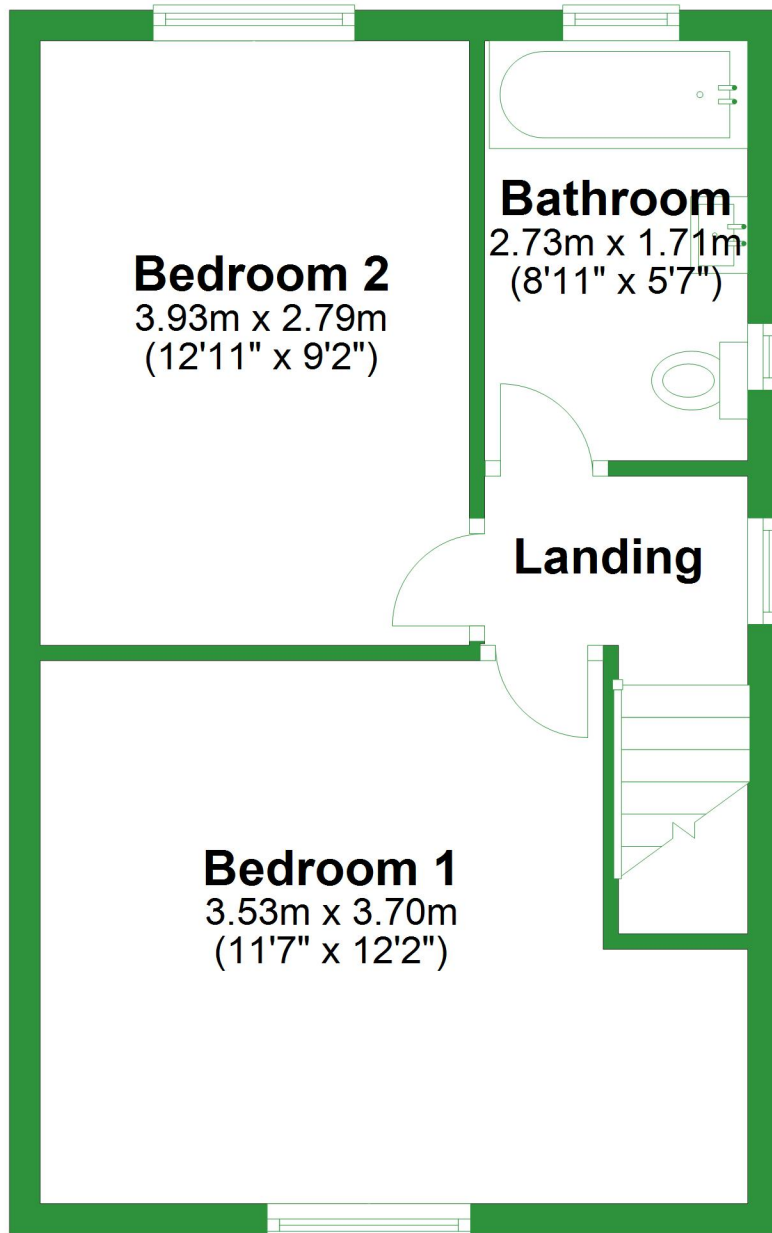

Ground Floor

Approx. 49.6 sq. metres (533.6 sq. feet)

**Open
Plan
Kitchen /
Dining /
Family
Room**

6.37m x 4.60m
(20'11" x 15'1")

Lounge

4.25m x 3.65m
(13'11" x 12')

Storage

Hall

Total area: approx. 84.5 sq. metres (909.4 sq. feet)

For illustrative purposes only. Not to scale. All sizes are approximate.

Plan produced using PlanUp.

First Floor

Approx. 34.9 sq. metres (375.8 sq. feet)

