

# Ground Floor

Approx. 101.0 sq. metres (1087.3 sq. feet)

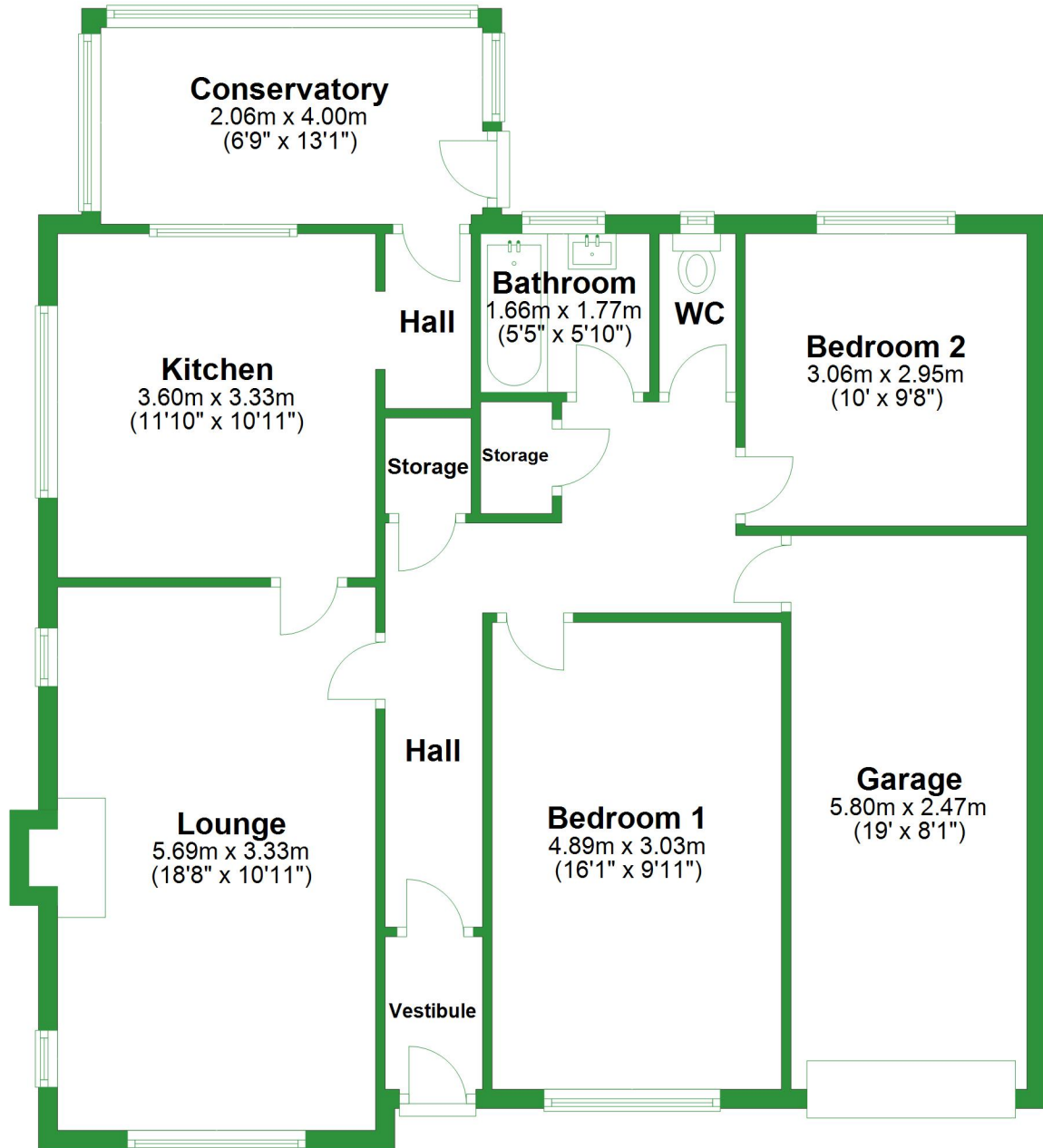

Total area: approx. 101.0 sq. metres (1087.3 sq. feet)

For illustrative purposes only. Not to scale. All sizes are approximate.

Plan produced using PlanUp.

## Ground Floor

Approx. 101.0 sq. metres (1087.3 sq. feet)

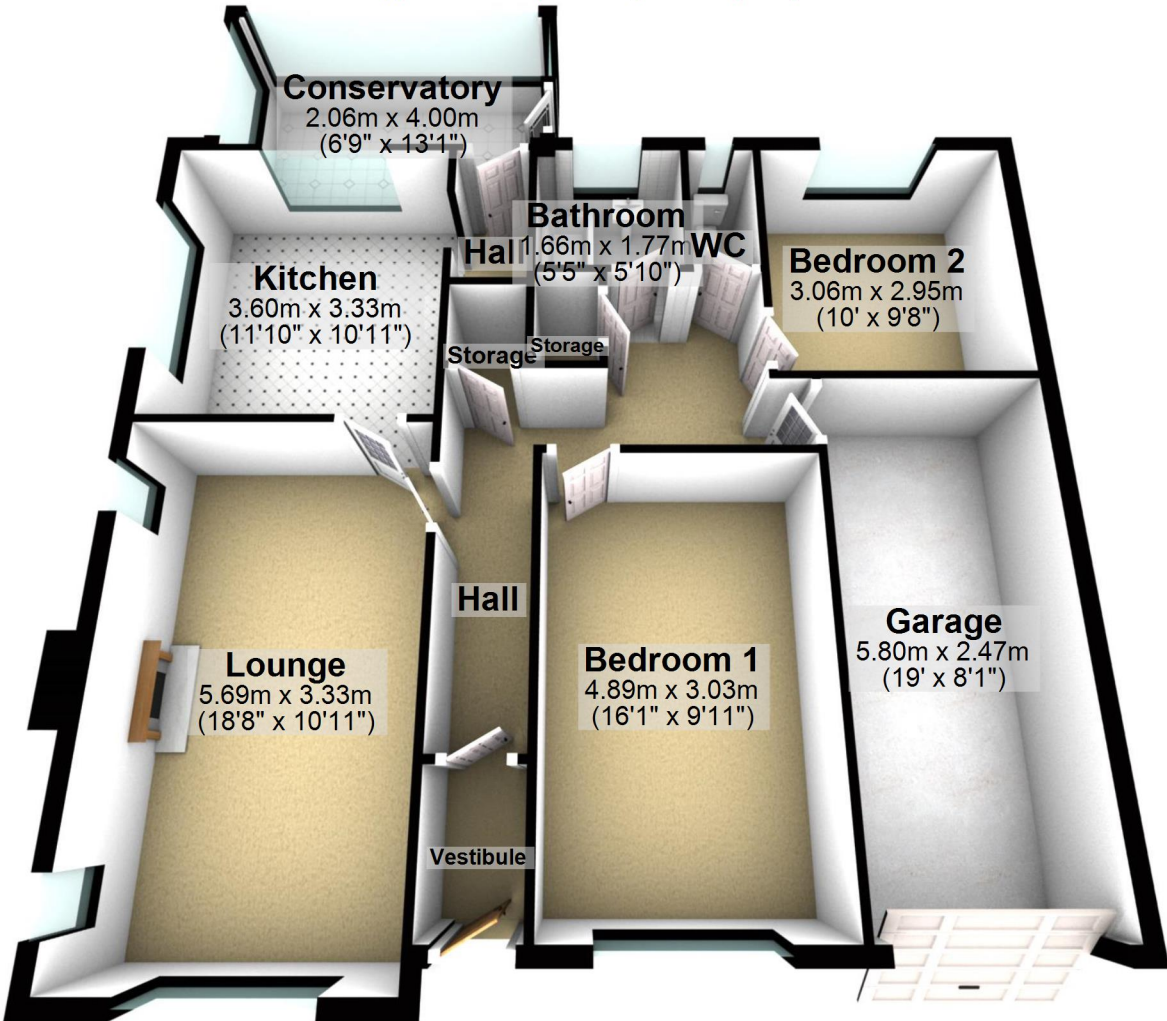

Total area: approx. 101.0 sq. metres (1087.3 sq. feet)

For illustrative purposes only. Not to scale. All sizes are approximate.

Plan produced using PlanUp.