

# Ground Floor

Approx. 82.9 sq. metres (892.7 sq. feet)

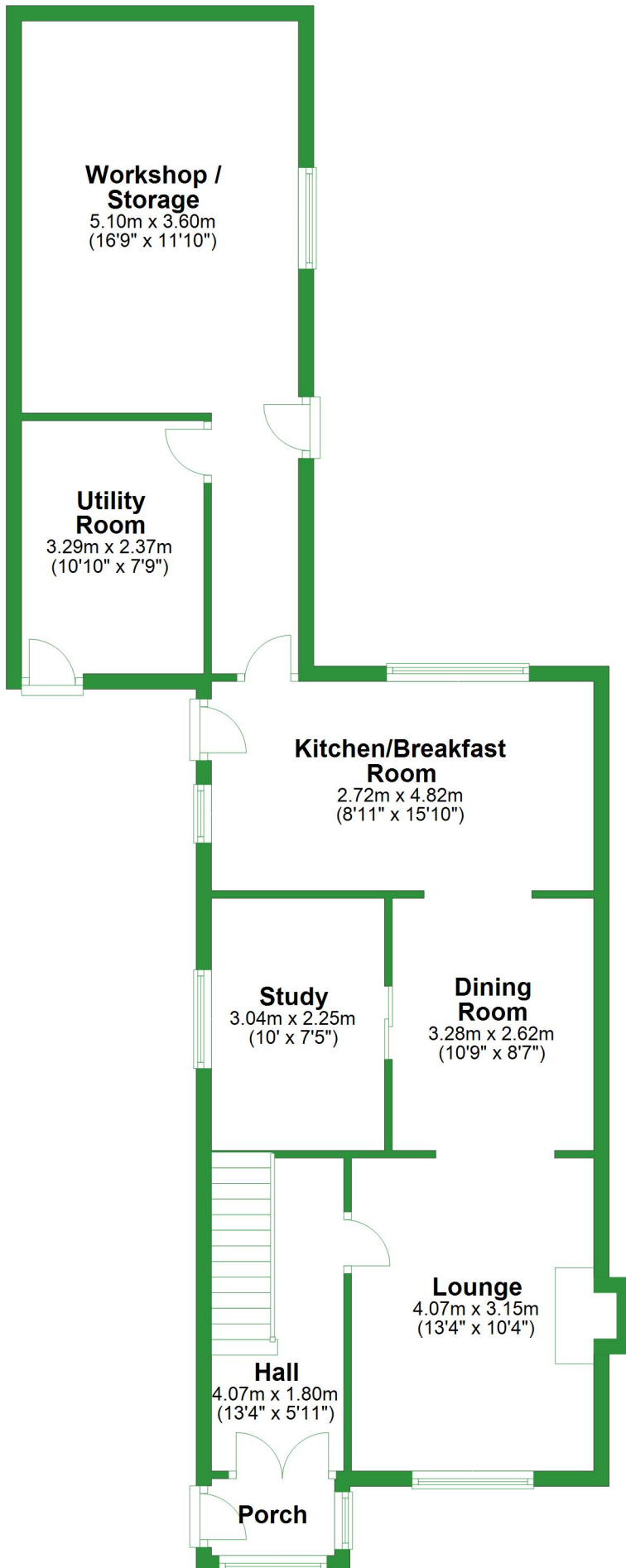

Total area: approx. 120.0 sq. metres (1291.3 sq. feet)

For illustrative purposes only. Not to scale. All sizes are approximate.  
Plan produced using PlanUp.

## First Floor

Approx. 37.0 sq. metres (398.5 sq. feet)

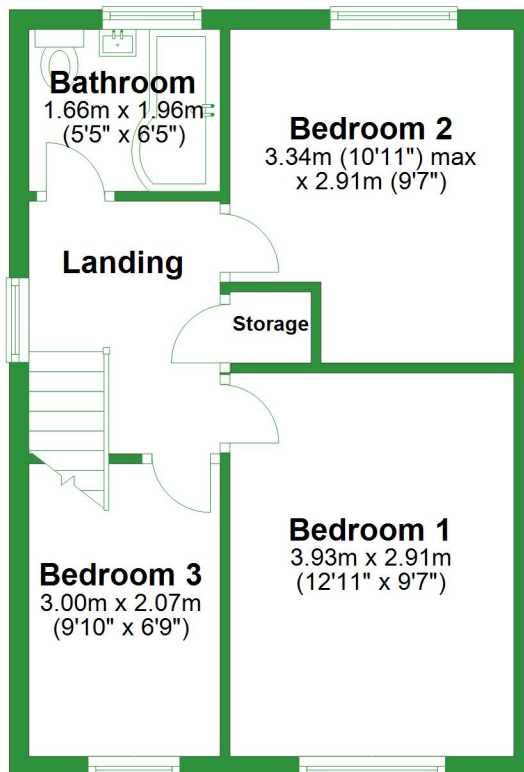

## Ground Floor

Approx. 82.9 sq. metres (892.7 sq. feet)

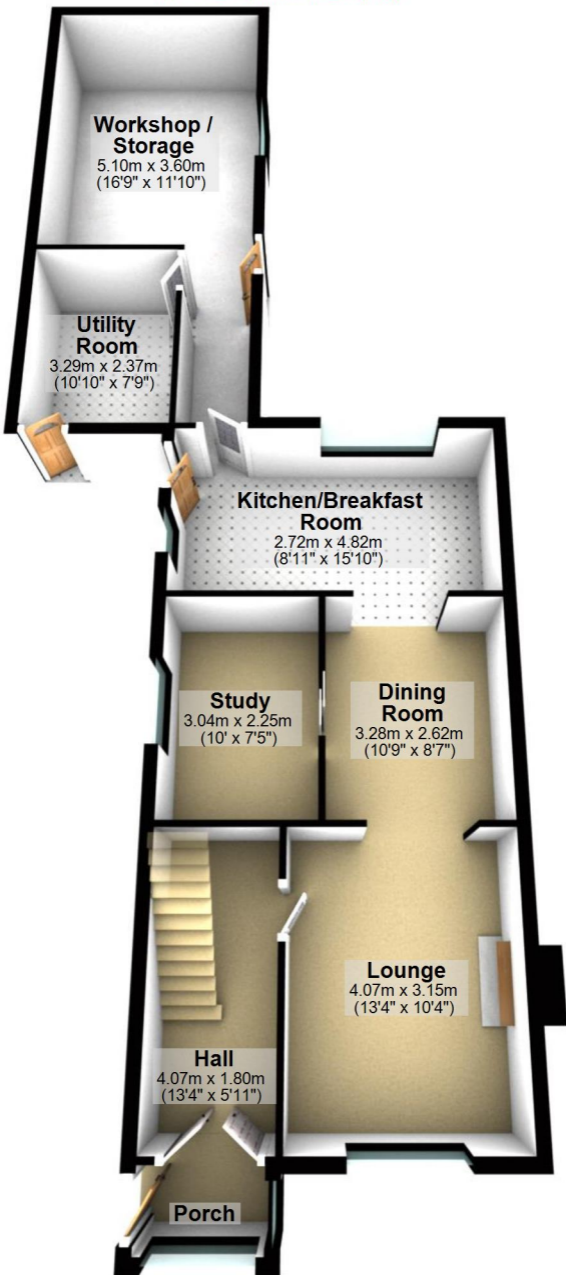

Total area: approx. 120.0 sq. metres (1291.3 sq. feet)

For illustrative purposes only. Not to scale. All sizes are approximate.

Plan produced using PlanUp.

## First Floor

Approx. 37.0 sq. metres (398.5 sq. feet)

