

Ground Floor

Approx. 62.3 sq. metres (670.9 sq. feet)

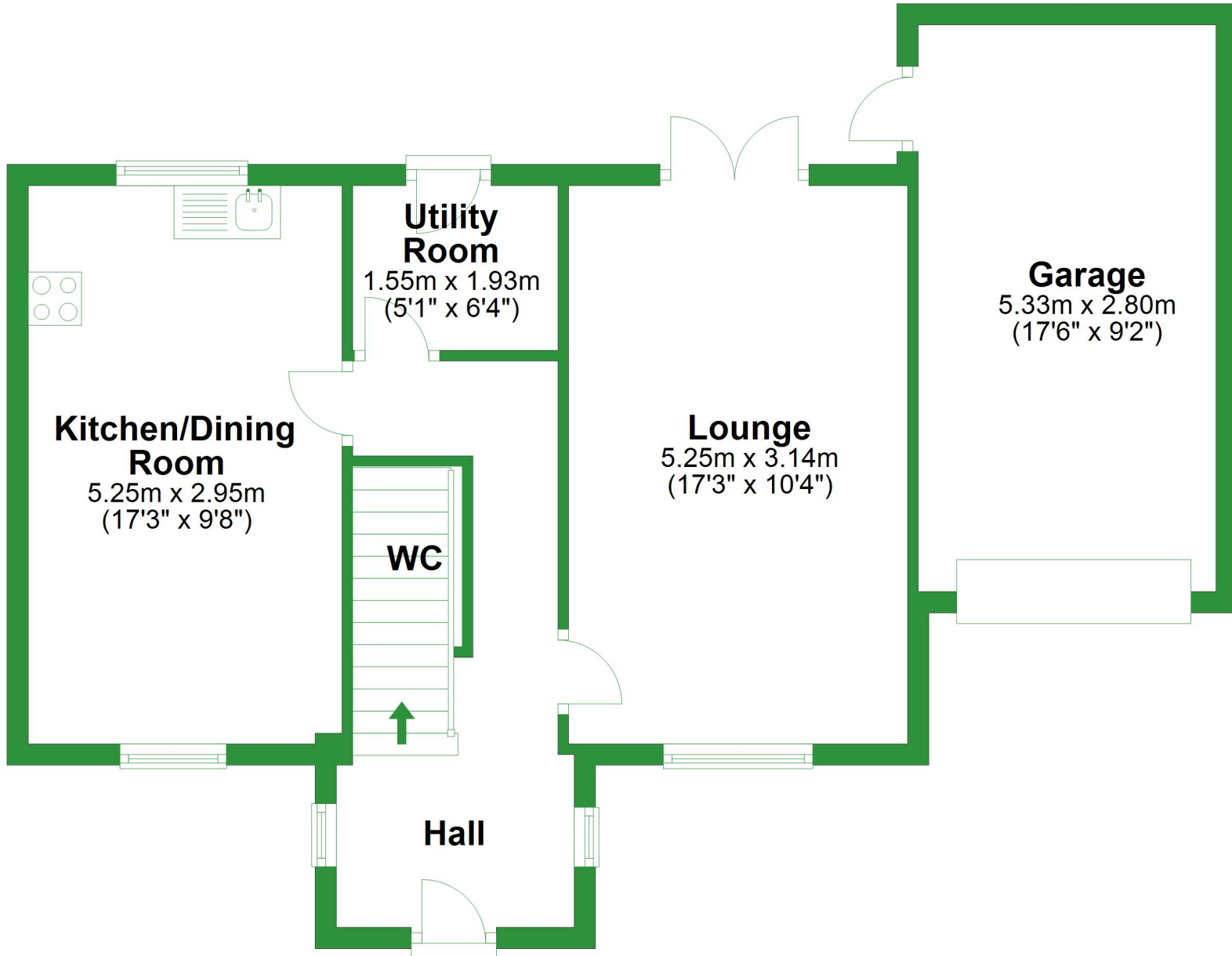

Total area: approx. 109.4 sq. metres (1177.3 sq. feet)

For illustrative purposes only. Not to scale. All sizes are approximate.
Plan produced using PlanUp.

First Floor

Approx. 47.0 sq. metres (506.4 sq. feet)

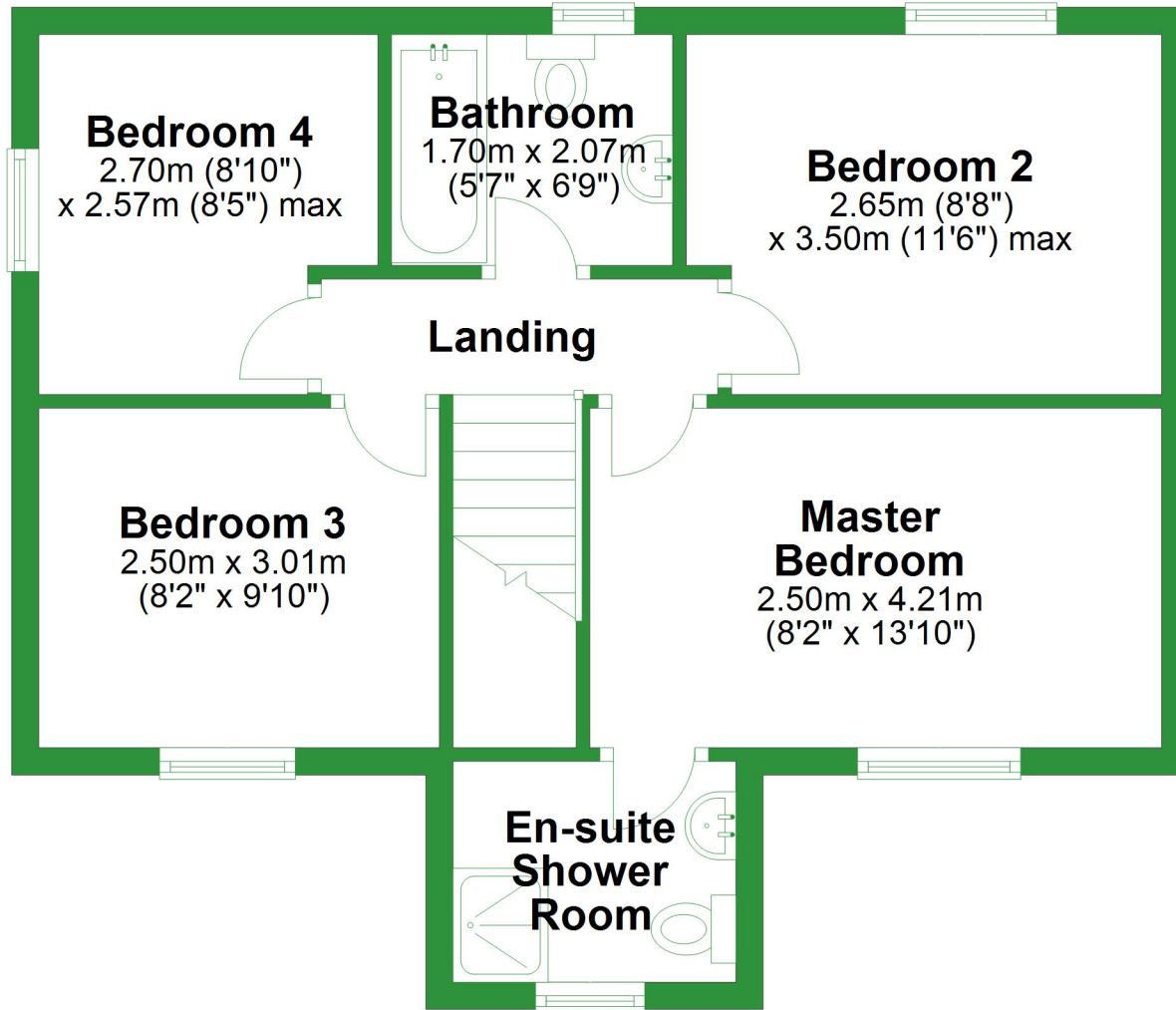

Ground Floor

Approx. 62.3 sq. metres (670.9 sq. feet)

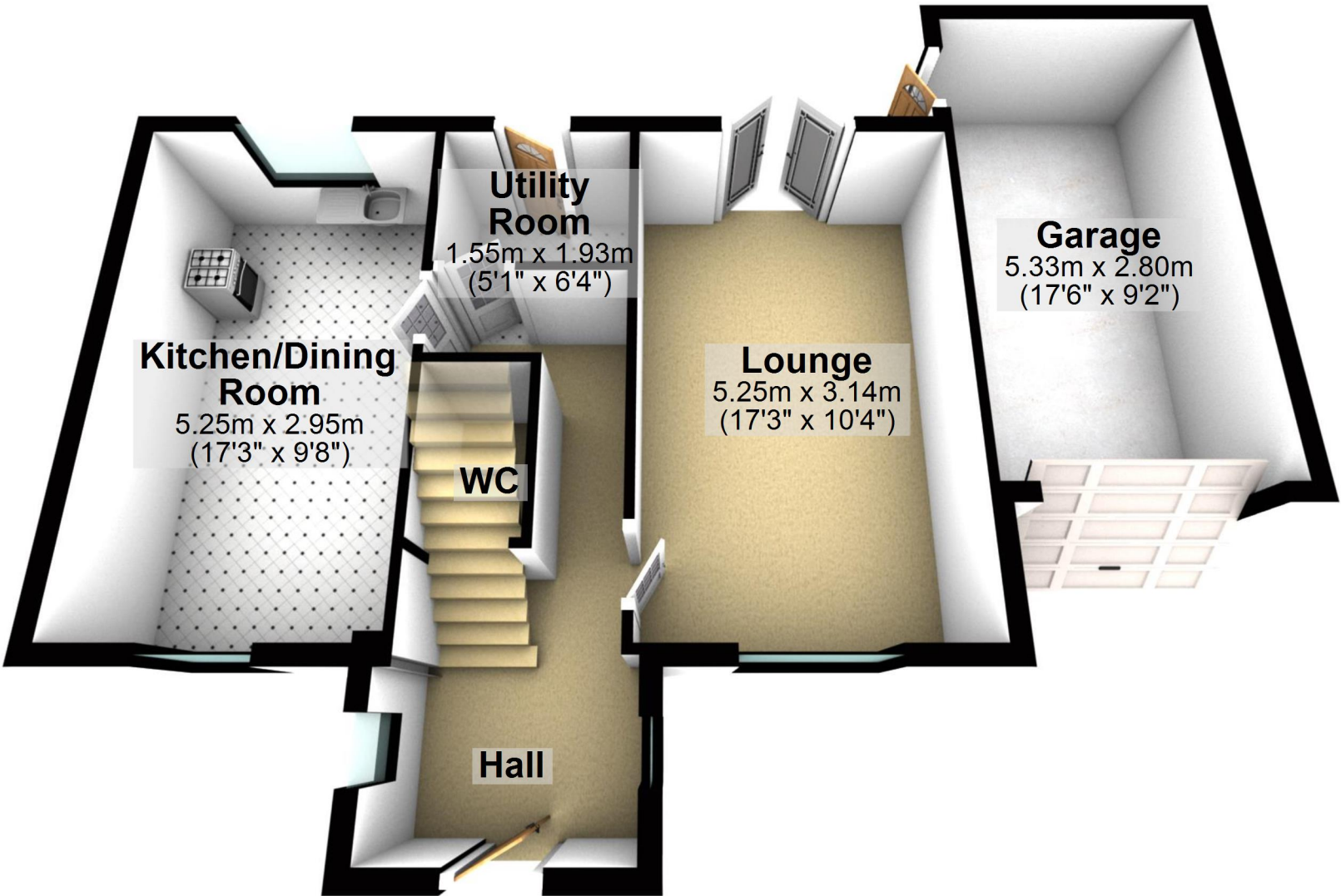

Total area: approx. 109.4 sq. metres (1177.3 sq. feet)

For illustrative purposes only. Not to scale. All sizes are approximate.
Plan produced using PlanUp.

First Floor

Approx. 47.0 sq. metres (506.4 sq. feet)

Bedroom 4
2.70m (8'10")
x 2.57m (8'5") max

Bathroom
1.70m x 2.07m
(5'7" x 6'9")

Bedroom 2
2.65m (8'8")
x 3.50m (11'6") max

Landing

Bedroom 3
2.50m x 3.01m
(8'2" x 9'10")

Master Bedroom
2.50m x 4.21m
(8'2" x 13'10")

**En-suite
Shower
Room**

