

# Ground Floor

Approx. 34.1 sq. metres (367.2 sq. feet)

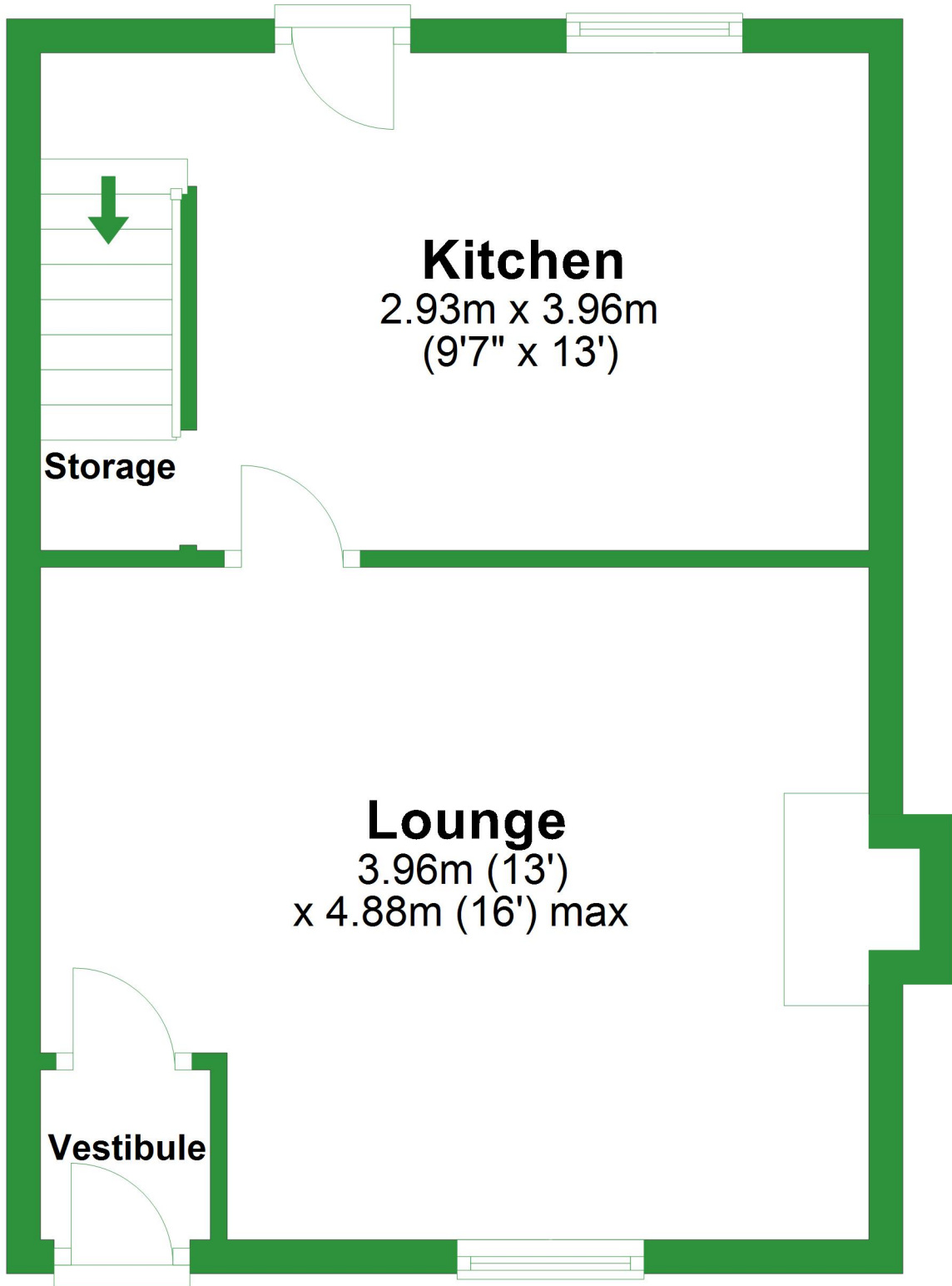

Total area: approx. 68.4 sq. metres (735.8 sq. feet)

For illustrative purposes only. Not to scale. All sizes are approximate.

Plan produced using PlanUp.

# First Floor

Approx. 34.2 sq. metres (368.6 sq. feet)

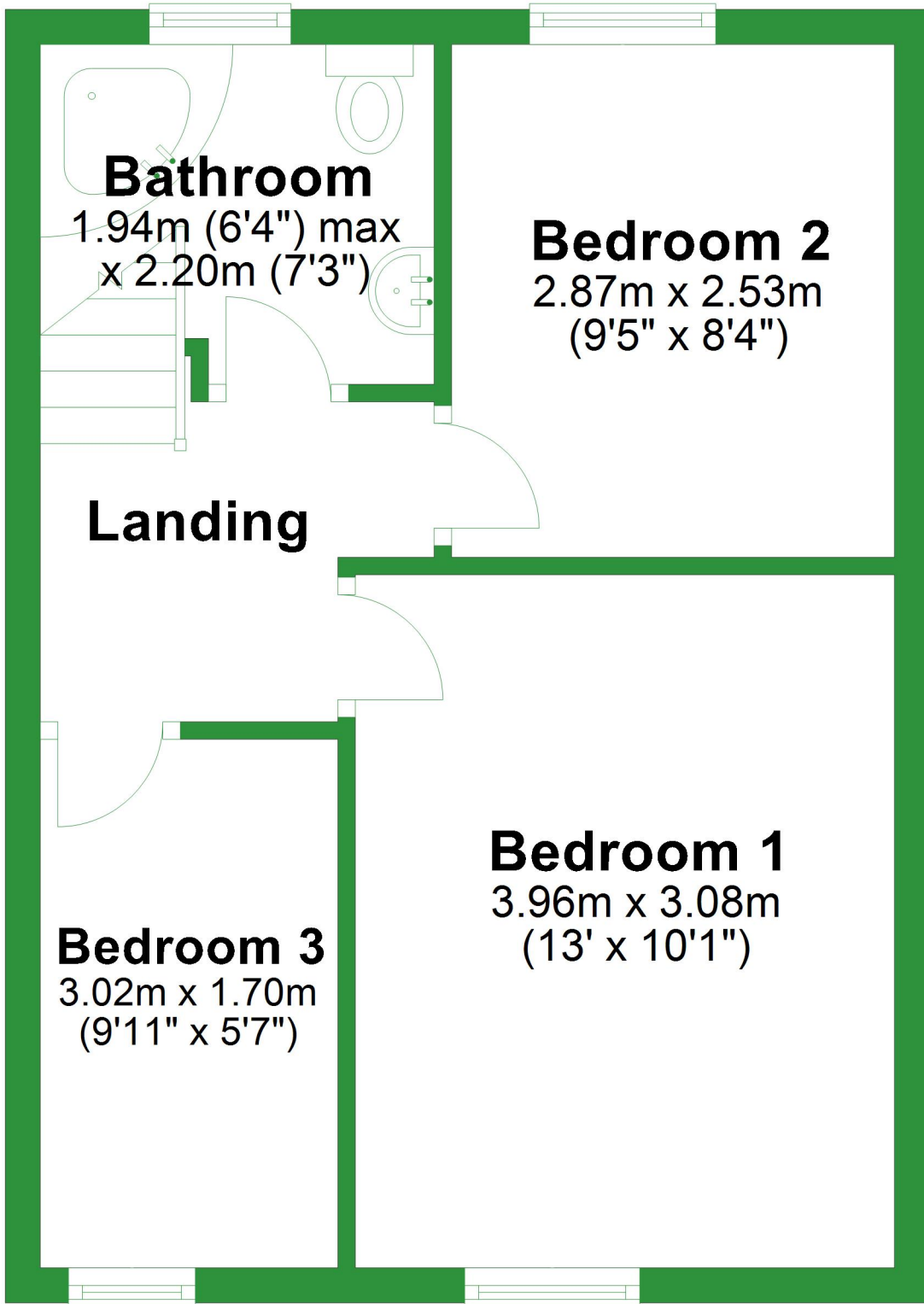

# Ground Floor

Approx. 34.1 sq. metres (367.2 sq. feet)

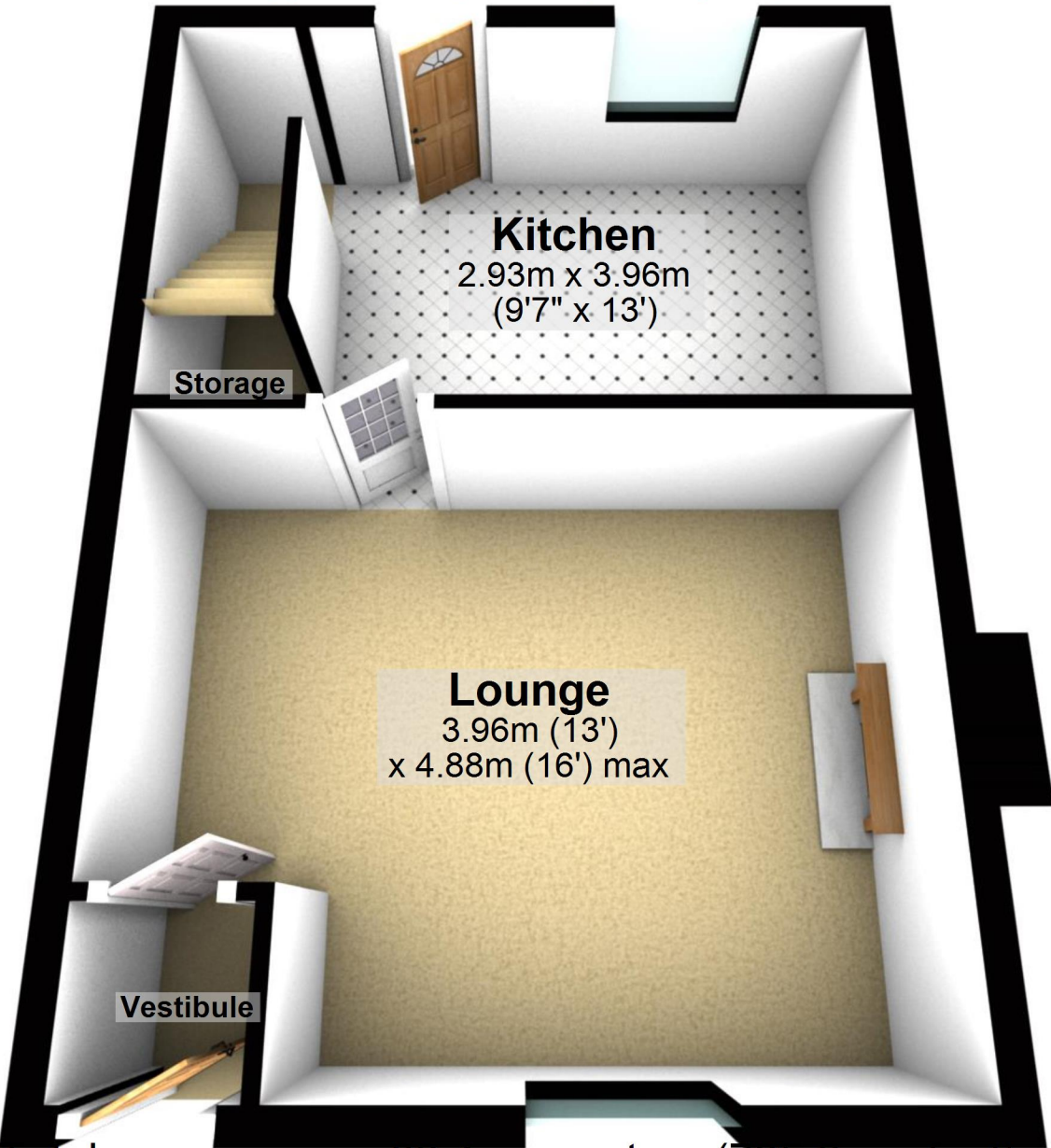

## Kitchen

2.93m x 3.96m  
(9'7" x 13')

Storage

## Lounge

3.96m (13')  
x 4.88m (16') max

Vestibule

Total area: approx. 68.4 sq. metres (735.8 sq. feet)

For illustrative purposes only. Not to scale. All sizes are approximate.

Plan produced using PlanUp.

# First Floor

Approx. 34.2 sq. metres (368.6 sq. feet)

## Bathroom

1.94m (6'4") max  
x 2.20m (7'3")

## Bedroom 2

2.87m x 2.53m  
(9'5" x 8'4")

## Landing

## Bedroom 1

3.96m x 3.08m  
(13' x 10'1")

## Bedroom 3

3.02m x 1.70m  
(9'11" x 5'7")

