

# Ground Floor

Approx. 77.9 sq. metres (838.0 sq. feet)

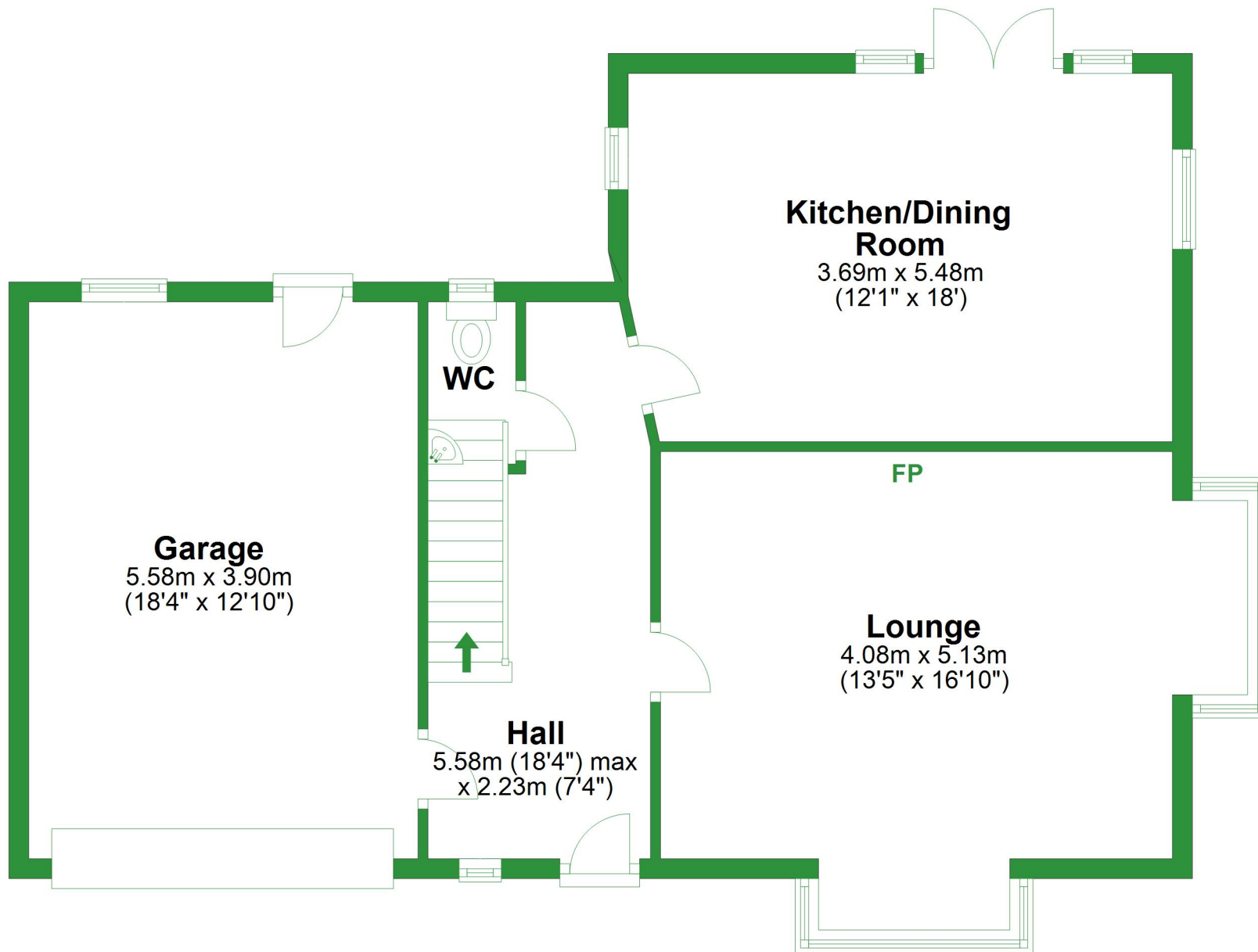

Total area: approx. 154.3 sq. metres (1660.7 sq. feet)

For illustrative purposes only. Not to scale. All sizes are approximate.

Plan produced using PlanUp.

# First Floor

Approx. 76.4 sq. metres (822.7 sq. feet)

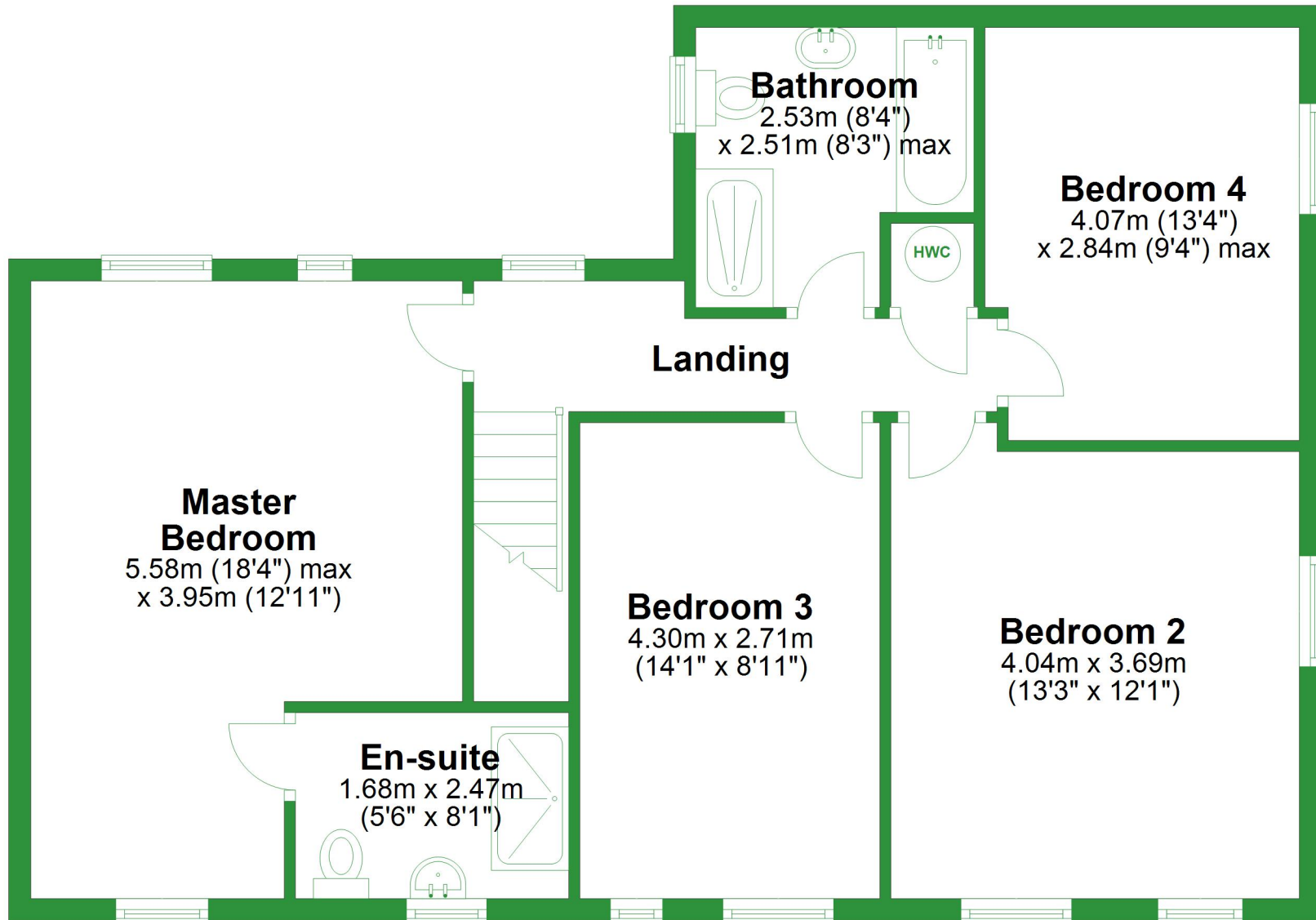

## Ground Floor

Approx. 77.9 sq. metres (838.0 sq. feet)

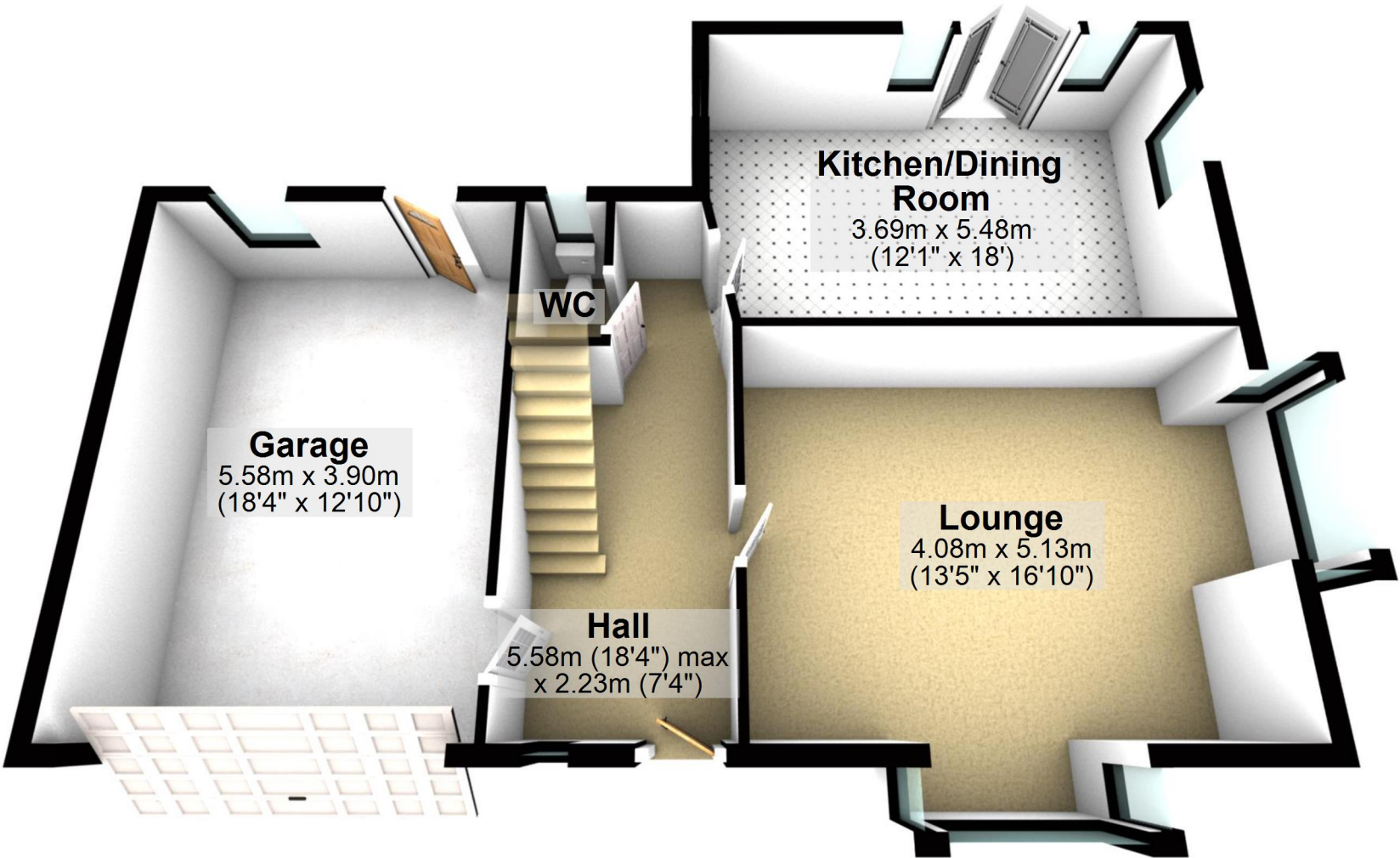

Total area: approx. 154.3 sq. metres (1660.7 sq. feet)

For illustrative purposes only. Not to scale. All sizes are approximate.  
Plan produced using PlanUp.

## First Floor

Approx. 76.4 sq. metres (822.7 sq. feet)

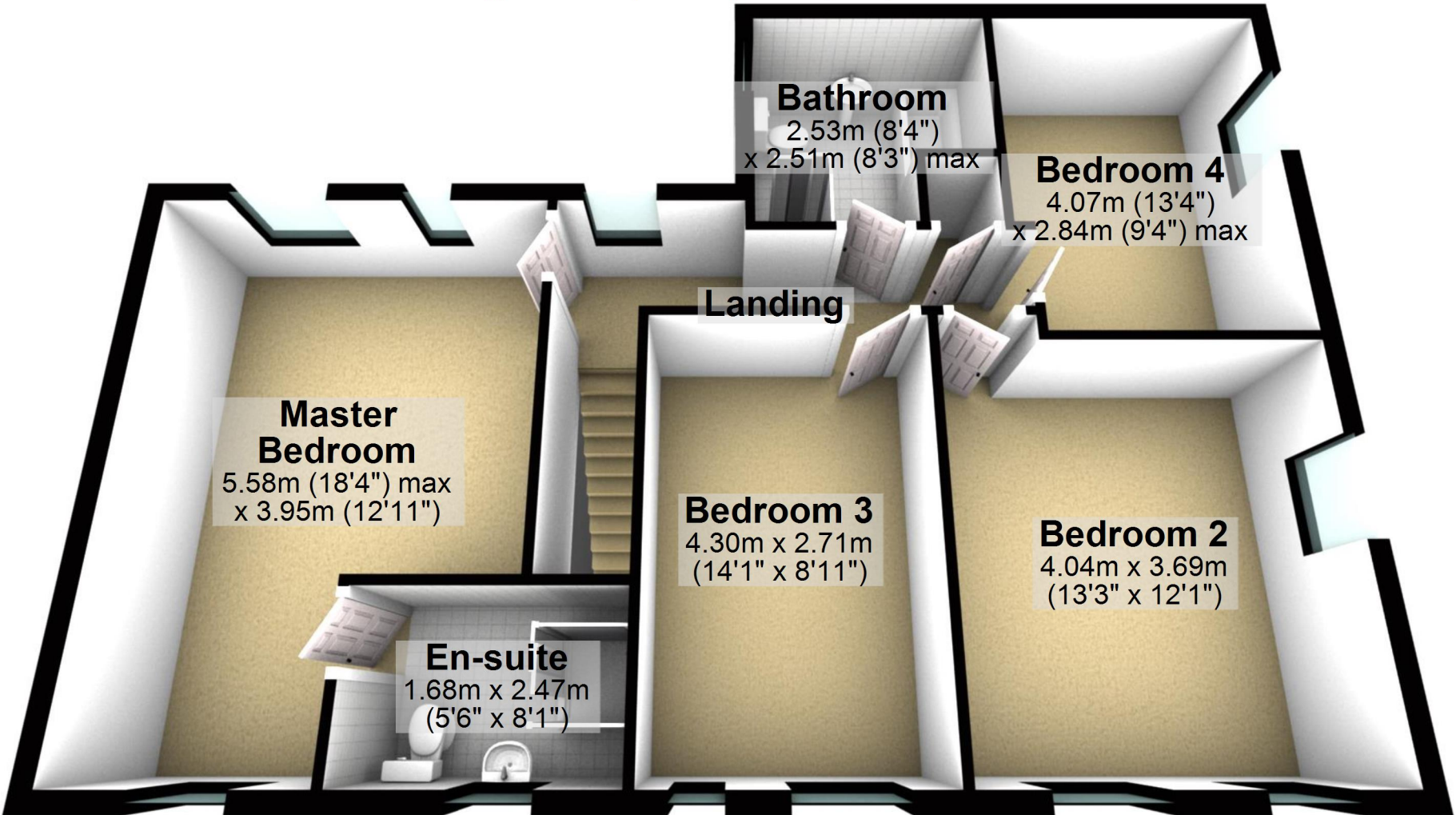

**Master  
Bedroom**  
5.58m (18'4") max  
x 3.95m (12'11")

**En-suite**  
1.68m x 2.47m  
(5'6" x 8'1")

**Bedroom 3**  
4.30m x 2.71m  
(14'1" x 8'11")

**Bathroom**  
2.53m (8'4")  
x 2.51m (8'3") max

**Bedroom 4**  
4.07m (13'4")  
x 2.84m (9'4") max

**Bedroom 2**  
4.04m x 3.69m  
(13'3" x 12'1")

**Landing**