

# Ground Floor

Approx. 32.8 sq. metres (352.7 sq. feet)

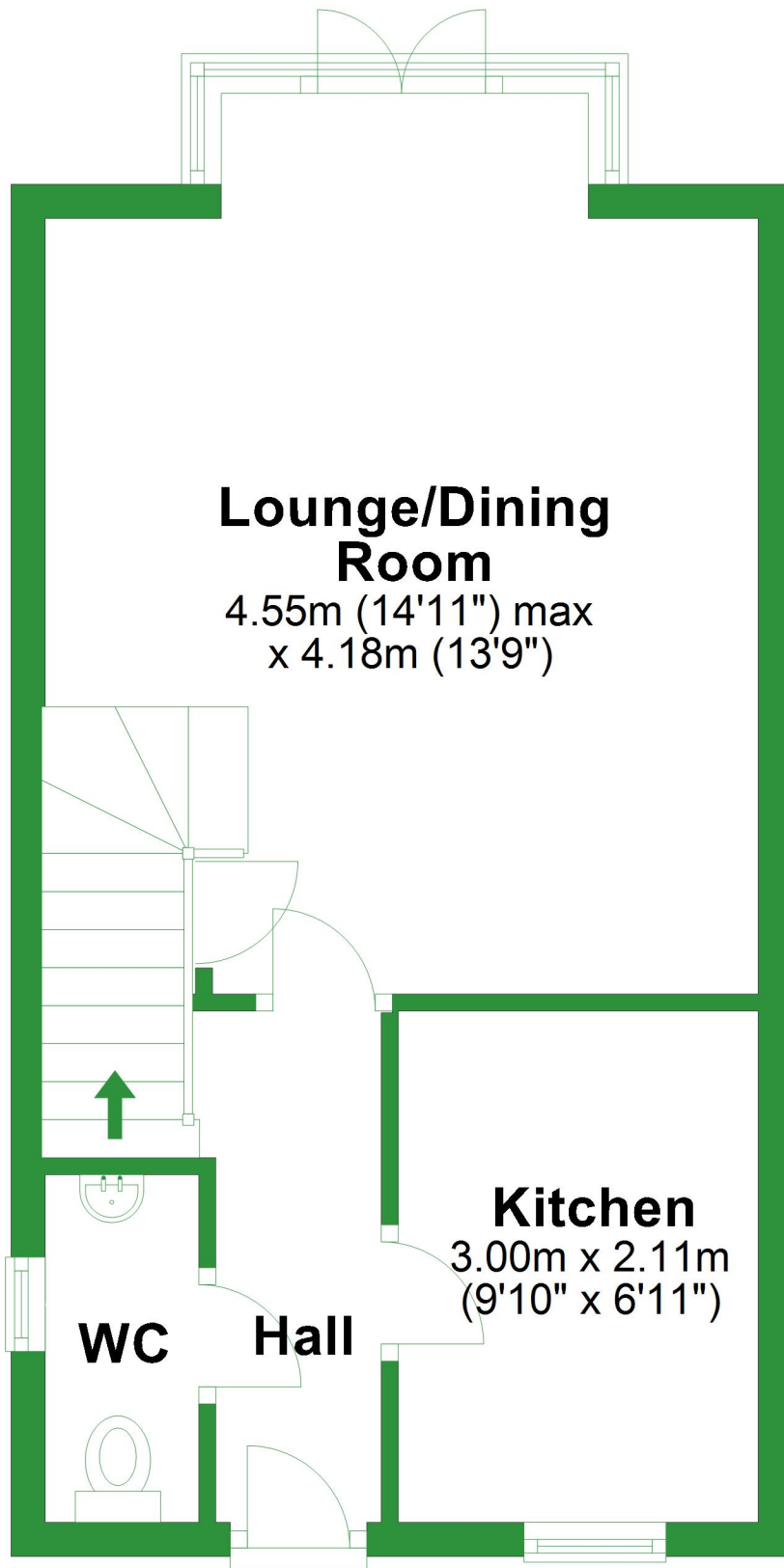

Total area: approx. 64.7 sq. metres (696.9 sq. feet)

For illustrative purposes only. Not to scale. All sizes are approximate.

Plan produced using PlanUp.

# First Floor

Approx. 32.0 sq. metres (344.2 sq. feet)

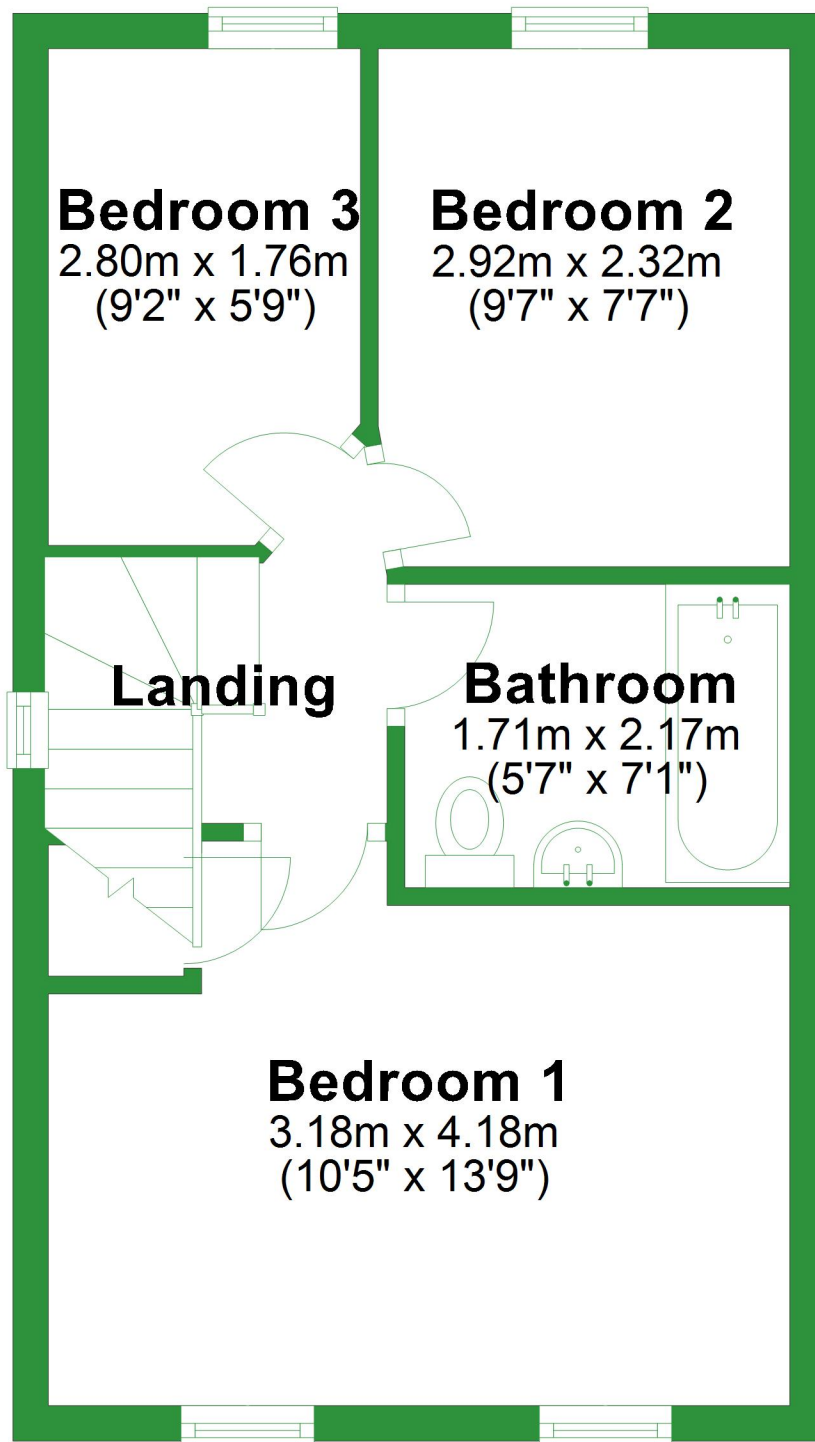

# Ground Floor

Approx. 32.8 sq. metres (352.7 sq. feet)

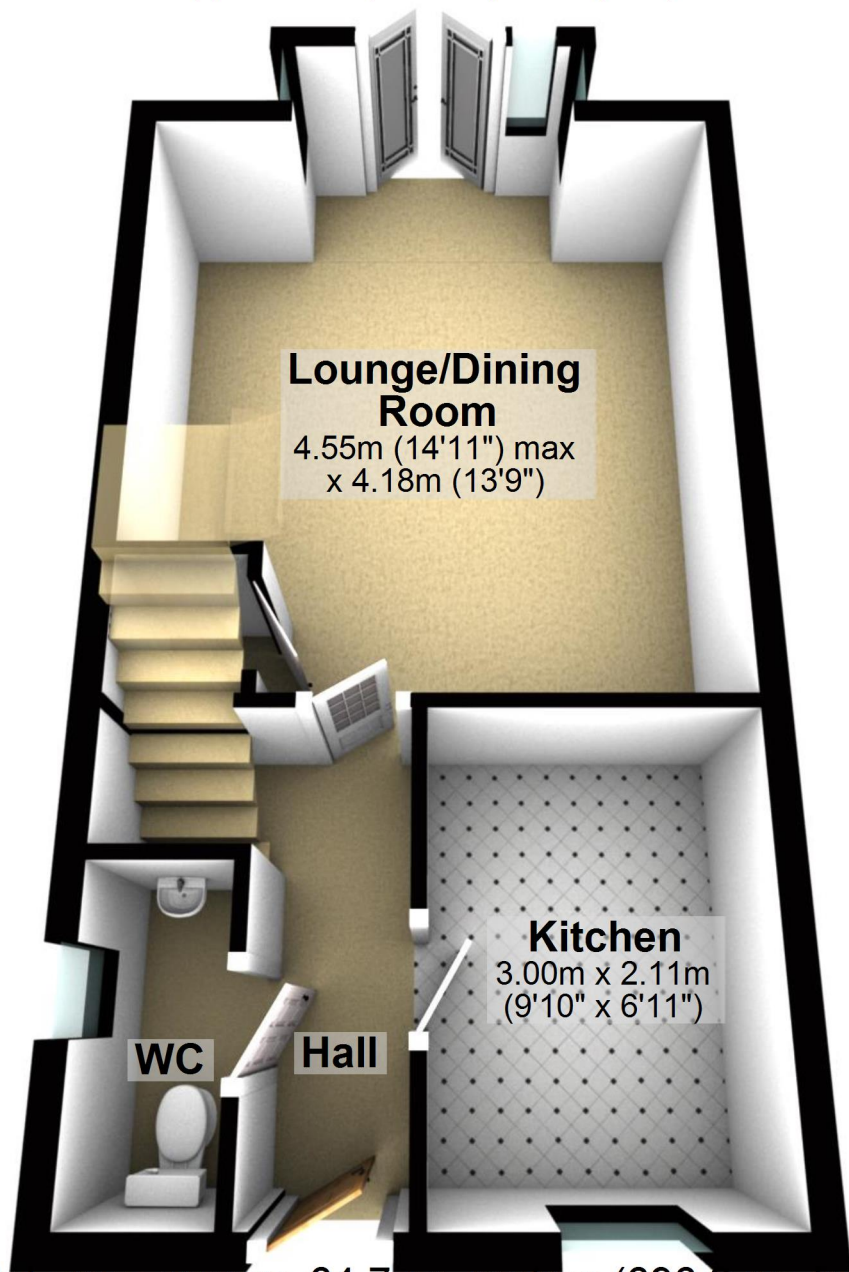

## Lounge/Dining Room

4.55m (14'11") max  
x 4.18m (13'9")

## Kitchen

3.00m x 2.11m  
(9'10" x 6'11")

WC

Hall

Total area: approx. 64.7 sq. metres (696.9 sq. feet)

For illustrative purposes only. Not to scale. All sizes are approximate.

Plan produced using PlanUp.

# First Floor

Approx. 32.0 sq. metres (344.2 sq. feet)

**Bedroom 3**  
2.80m x 1.76m  
(9'2" x 5'9")

**Bedroom 2**  
2.92m x 2.32m  
(9'7" x 7'7")

**Landing**

**Bathroom**  
1.71m x 2.17m  
(5'7" x 7'1")

**Bedroom 1**  
3.18m x 4.18m  
(10'5" x 13'9")

