

# Ground Floor

Approx. 75.3 sq. metres (810.8 sq. feet)

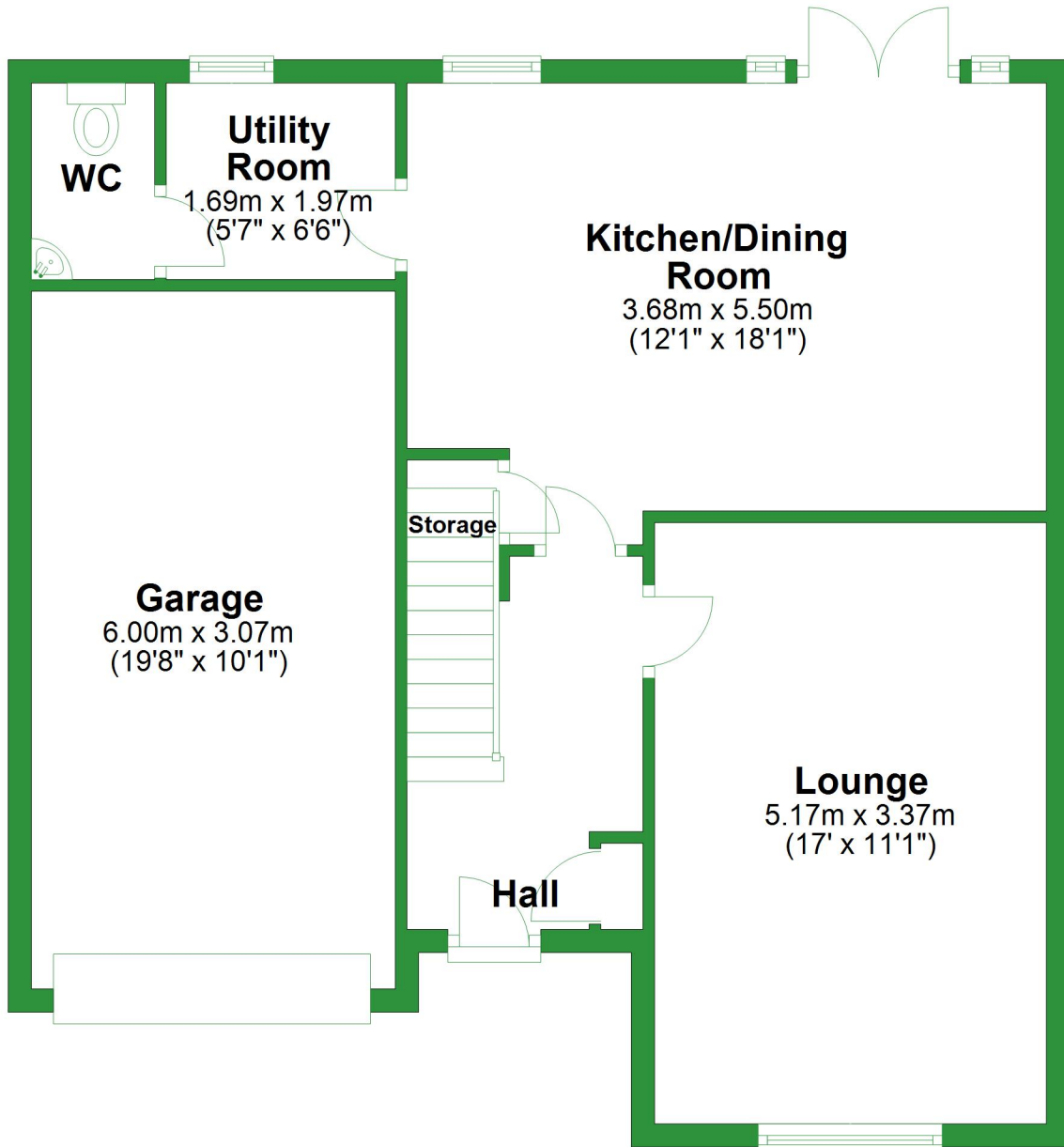

Total area: approx. 144.2 sq. metres (1552.6 sq. feet)

For illustrative purposes only. Not to scale. All sizes are approximate.

Plan produced using PlanUp.

# First Floor

Approx. 68.9 sq. metres (741.8 sq. feet)

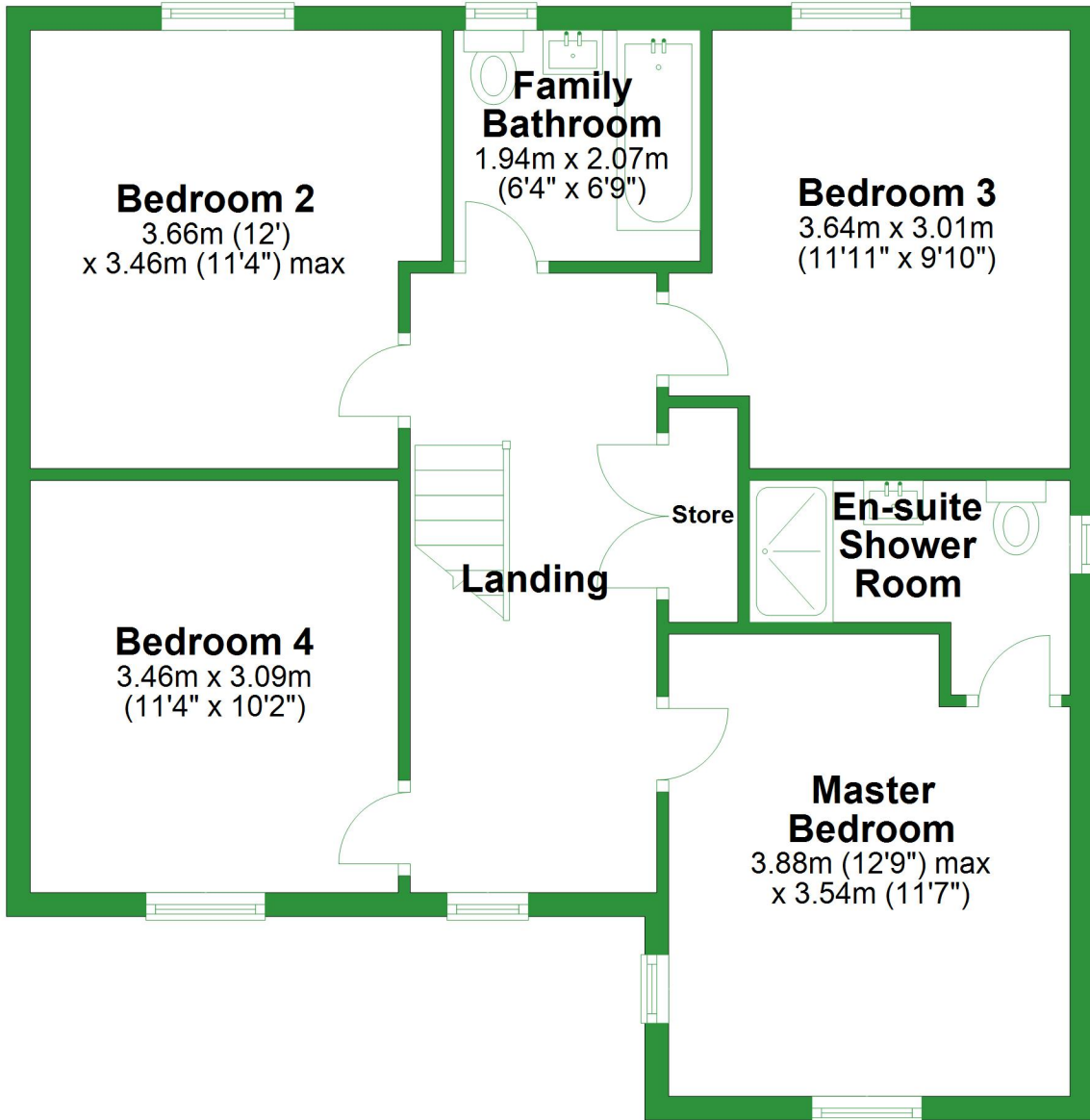

# Ground Floor

Approx. 75.3 sq. metres (810.8 sq. feet)

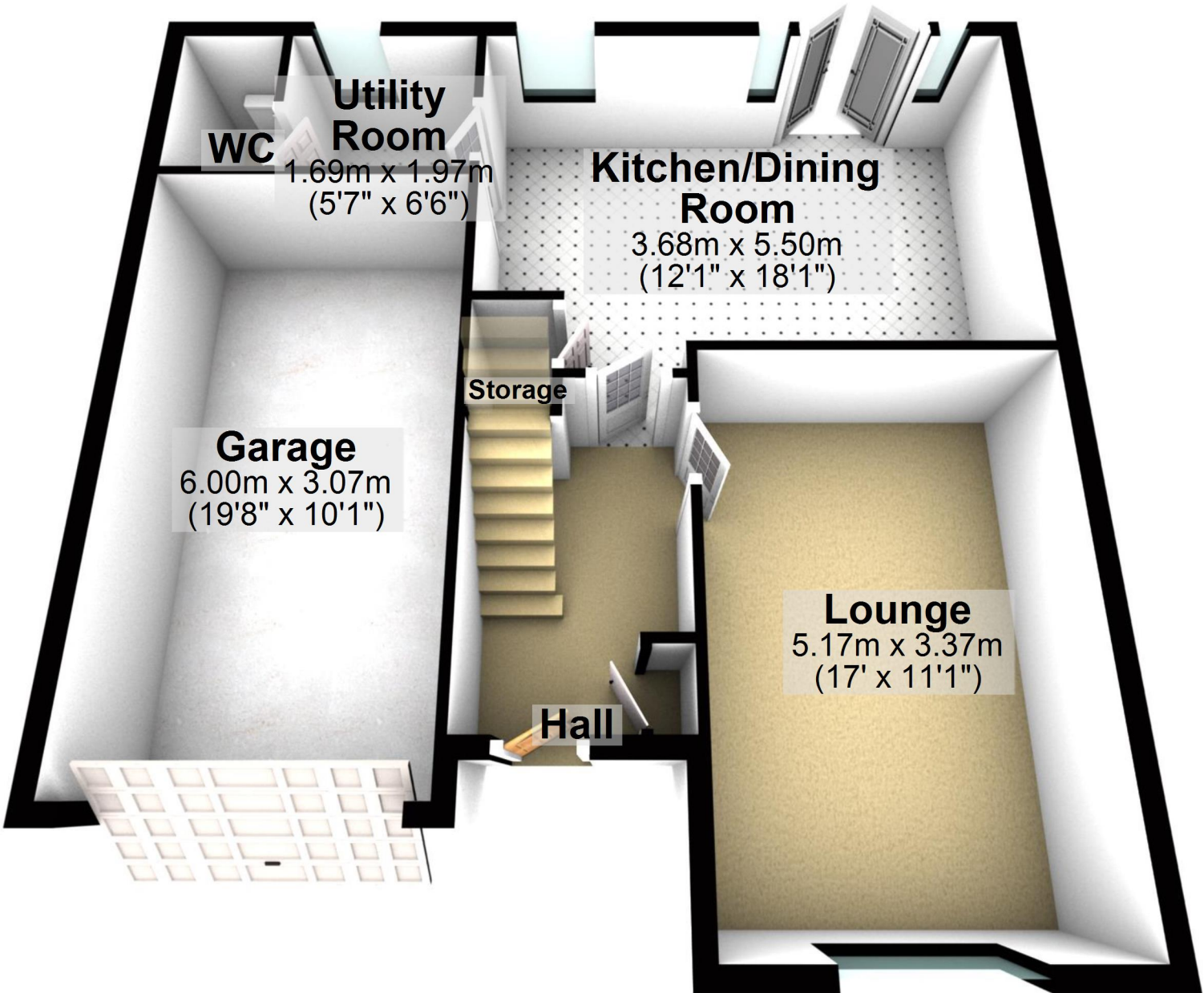

Total area: approx. 144.2 sq. metres (1552.6 sq. feet)

For illustrative purposes only. Not to scale. All sizes are approximate.  
Plan produced using PlanUp.

# First Floor

Approx. 68.9 sq. metres (741.8 sq. feet)

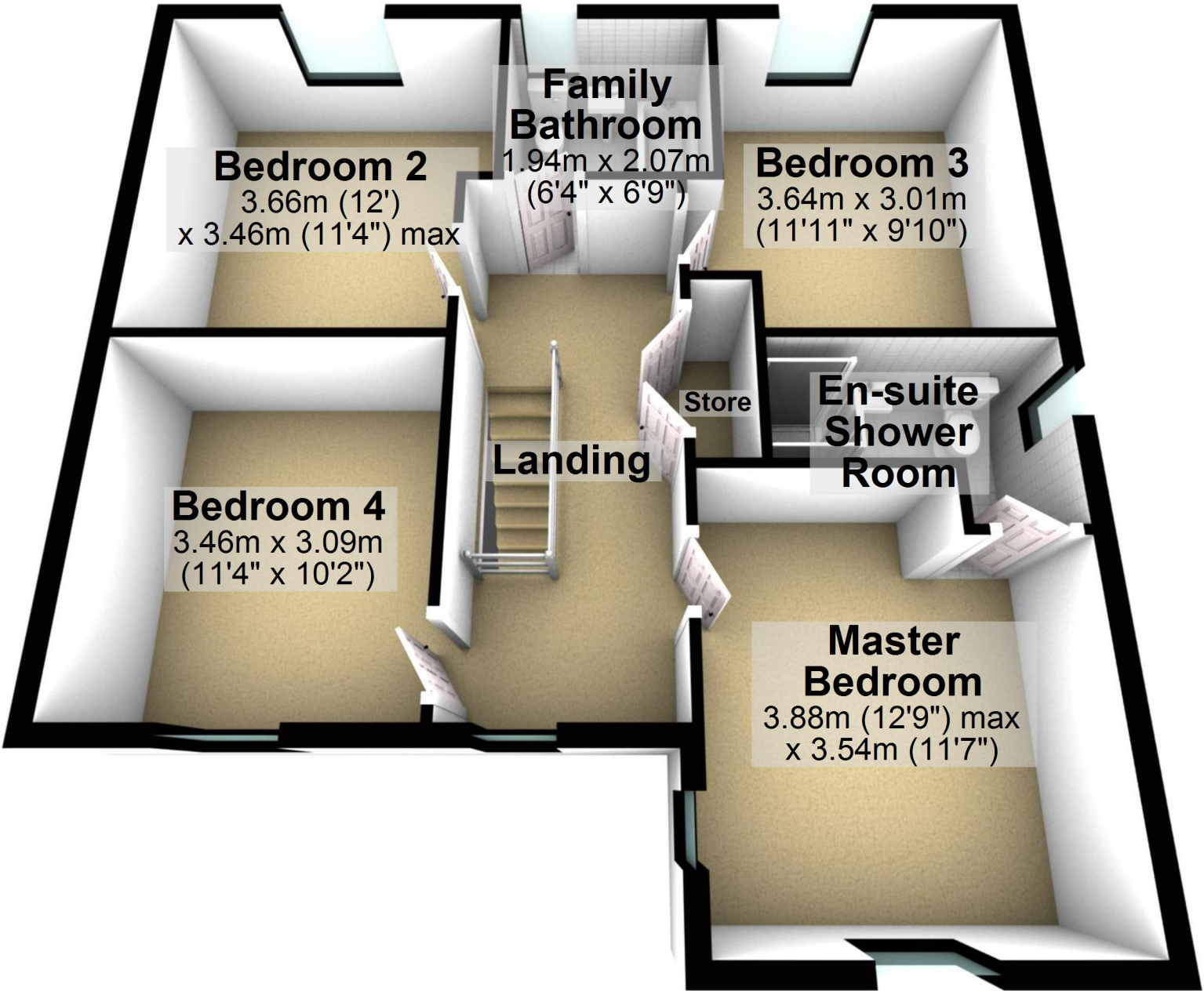

**Bedroom 2**

3.66m (12')  
x 3.46m (11'4") max

**Family  
Bathroom**

1.94m x 2.07m  
(6'4" x 6'9")

**Bedroom 3**

3.64m x 3.01m  
(11'11" x 9'10")

**Bedroom 4**

3.46m x 3.09m  
(11'4" x 10'2")

**Landing**

**Store**

**En-suite  
Shower  
Room**

**Master  
Bedroom**

3.88m (12'9") max  
x 3.54m (11'7")