

Ground Floor

Approx. 37.8 sq. metres (407.2 sq. feet)

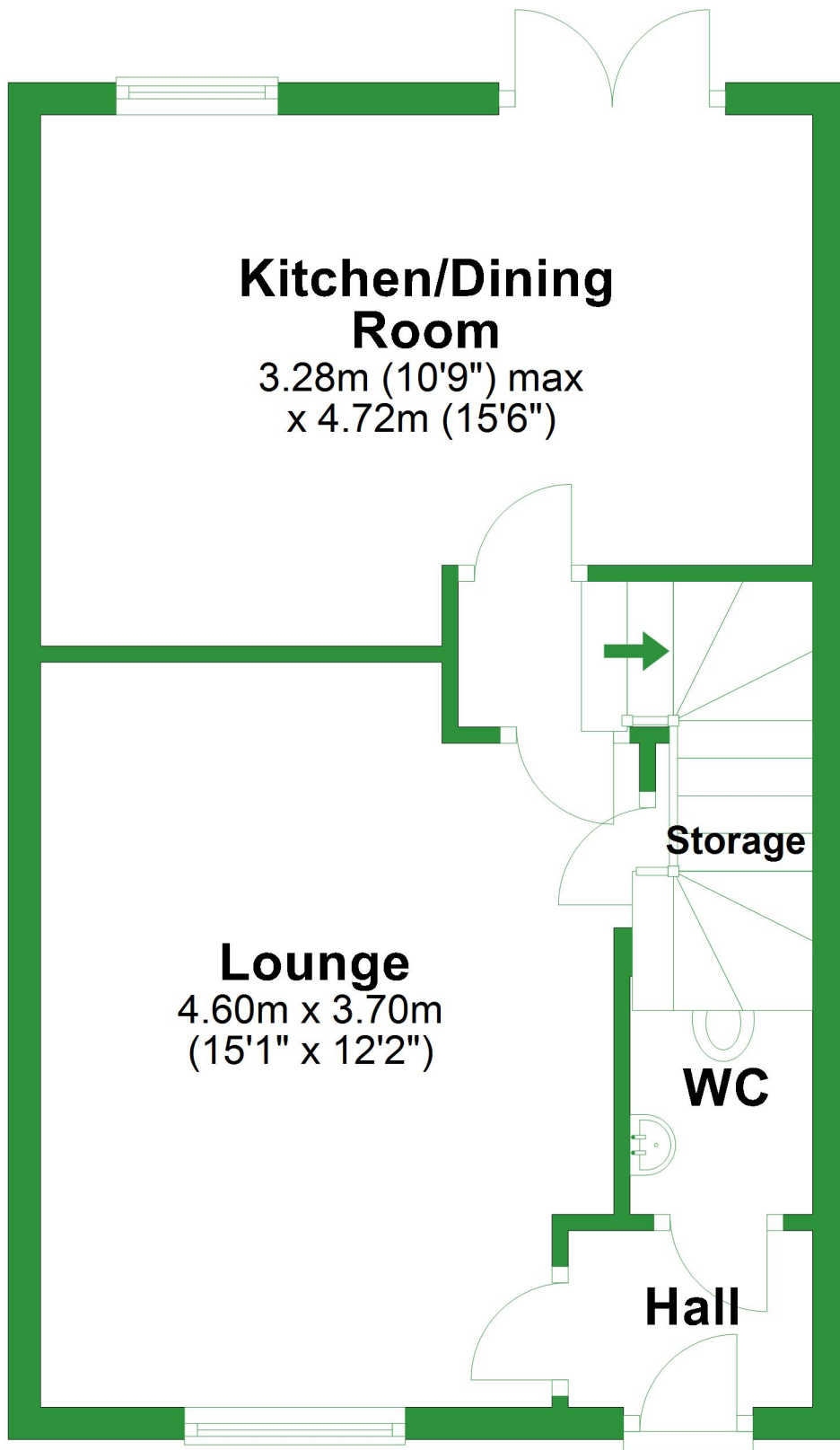

Total area: approx. 75.9 sq. metres (816.9 sq. feet)

For illustrative purposes only. Not to scale. All sizes are approximate.

Plan produced using PlanUp.

First Floor

Approx. 38.1 sq. metres (409.7 sq. feet)

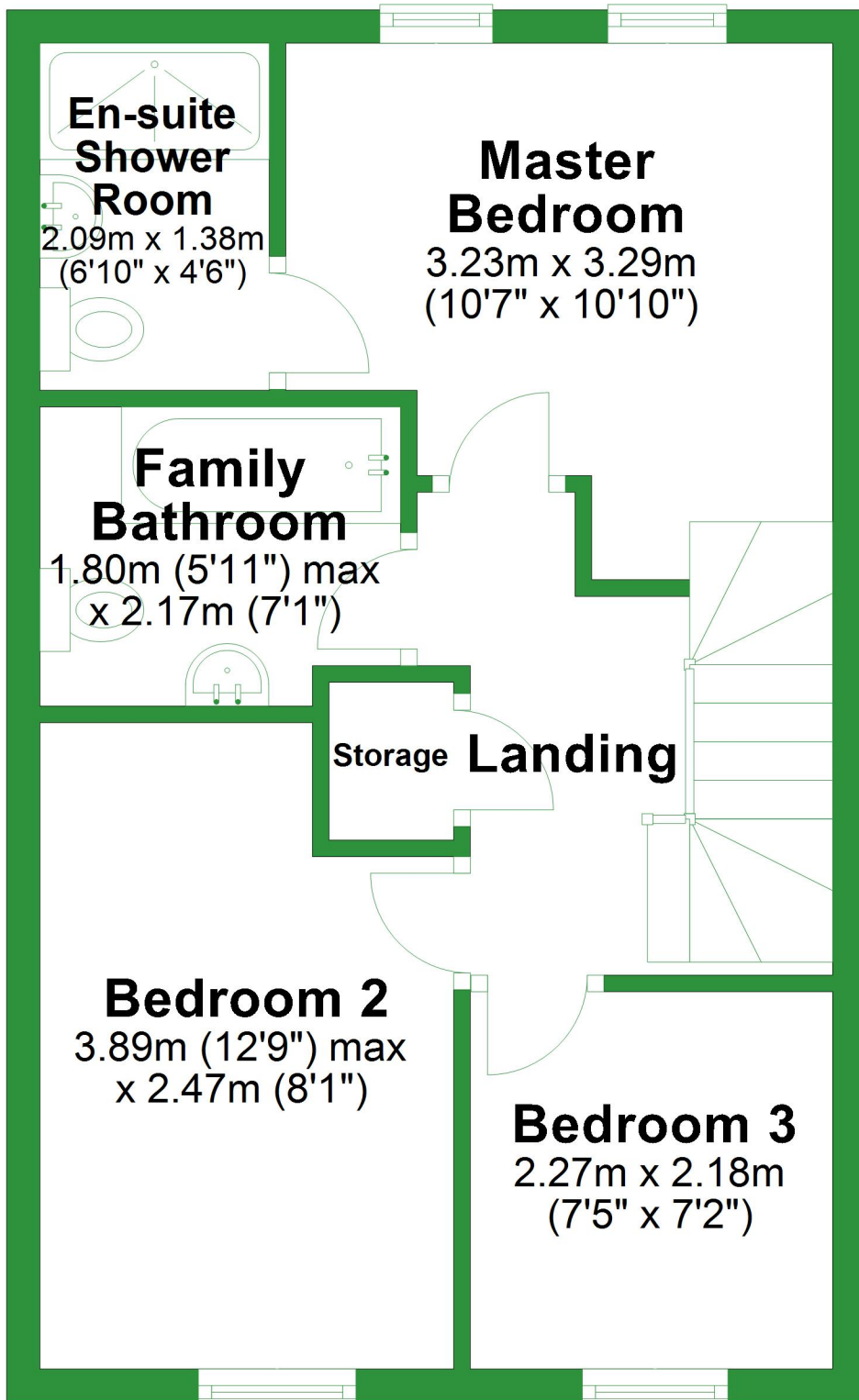

Ground Floor

Approx. 37.8 sq. metres (407.2 sq. feet)

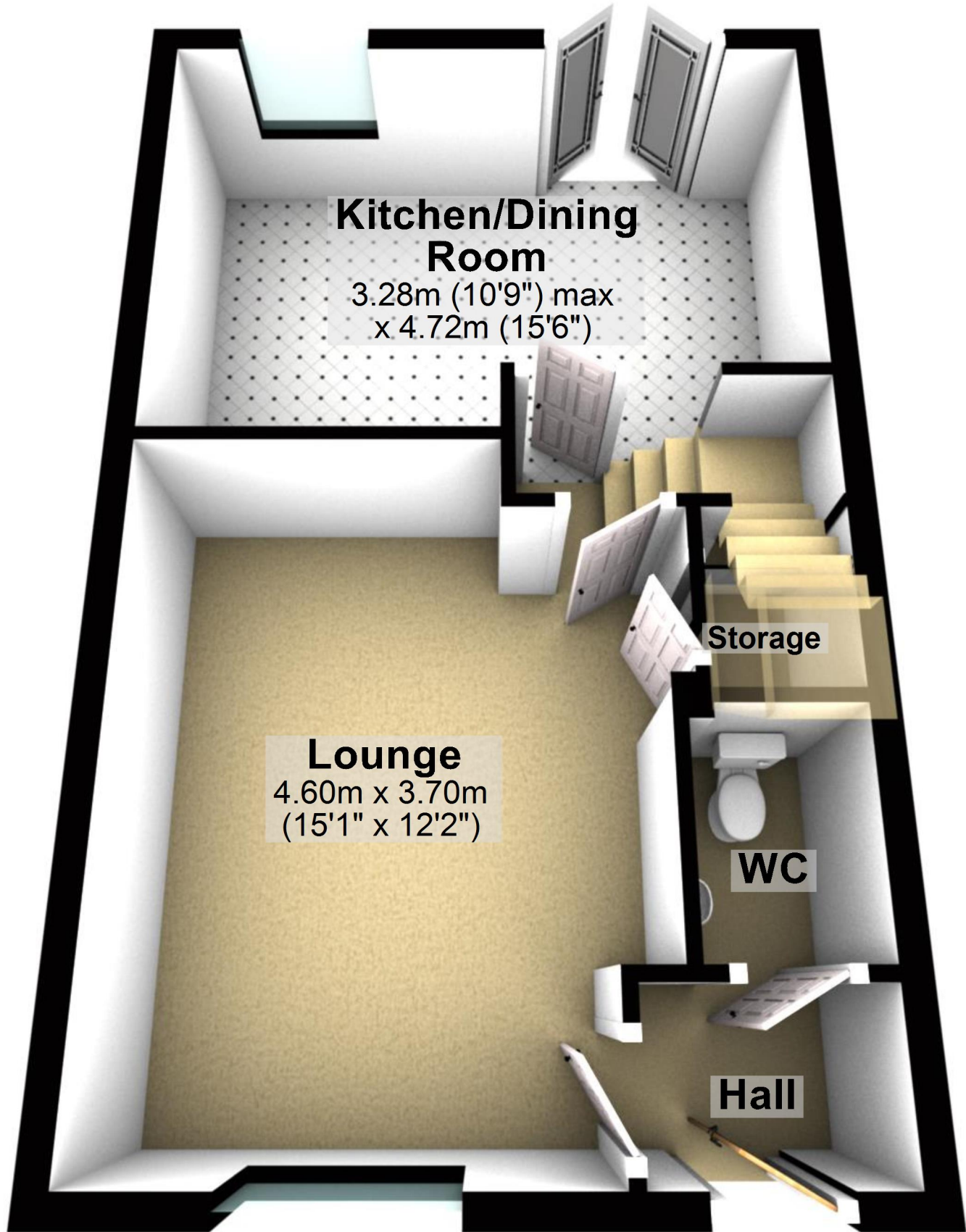

Kitchen/Dining Room

3.28m (10'9") max
x 4.72m (15'6")

Lounge

4.60m x 3.70m
(15'1" x 12'2")

Storage

WC

Hall

Total area: approx. 75.9 sq. metres (816.9 sq. feet)

For illustrative purposes only. Not to scale. All sizes are approximate.

Plan produced using PlanUp.

First Floor

Approx. 38.1 sq. metres (409.7 sq. feet)

**En-suite
Shower
Room**

2.09m x 1.38m
(6'10" x 4'6")

**Master
Bedroom**

3.23m x 3.29m
(10'7" x 10'10")

**Family
Bathroom**

1.80m (5'11") max
x 2.17m (7'1")

Storage

Landing

Bedroom 2

3.89m (12'9") max
x 2.47m (8'1")

Bedroom 3

2.27m x 2.18m
(7'5" x 7'2")

