

# Ground Floor

Approx. 59.1 sq. metres (636.2 sq. feet)

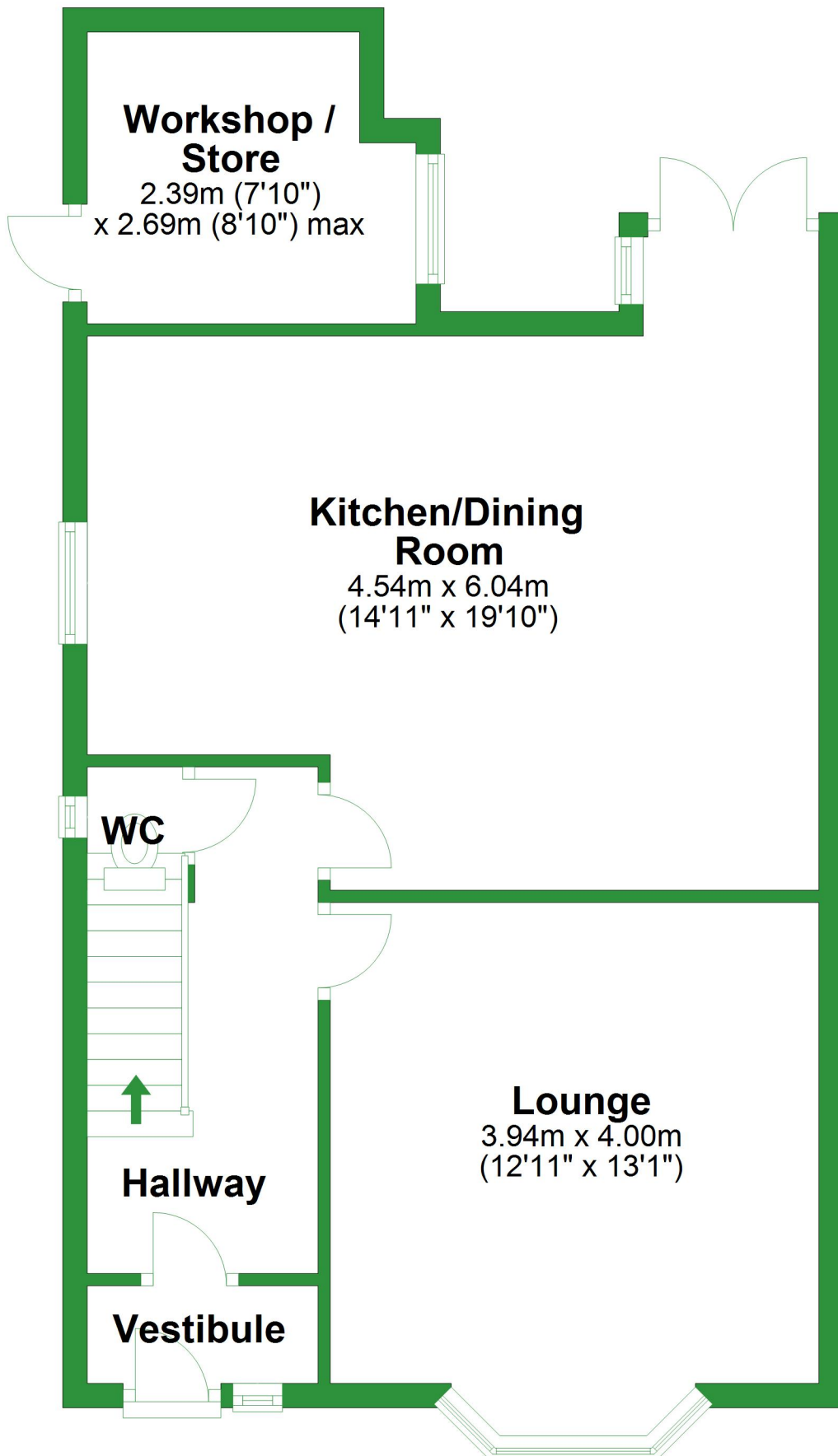

Total area: approx. 110.5 sq. metres (1189.4 sq. feet)

For illustrative purposes only. Not to scale. All sizes are approximate.  
Plan produced using PlanUp.

# First Floor

Approx. 51.4 sq. metres (553.2 sq. feet)

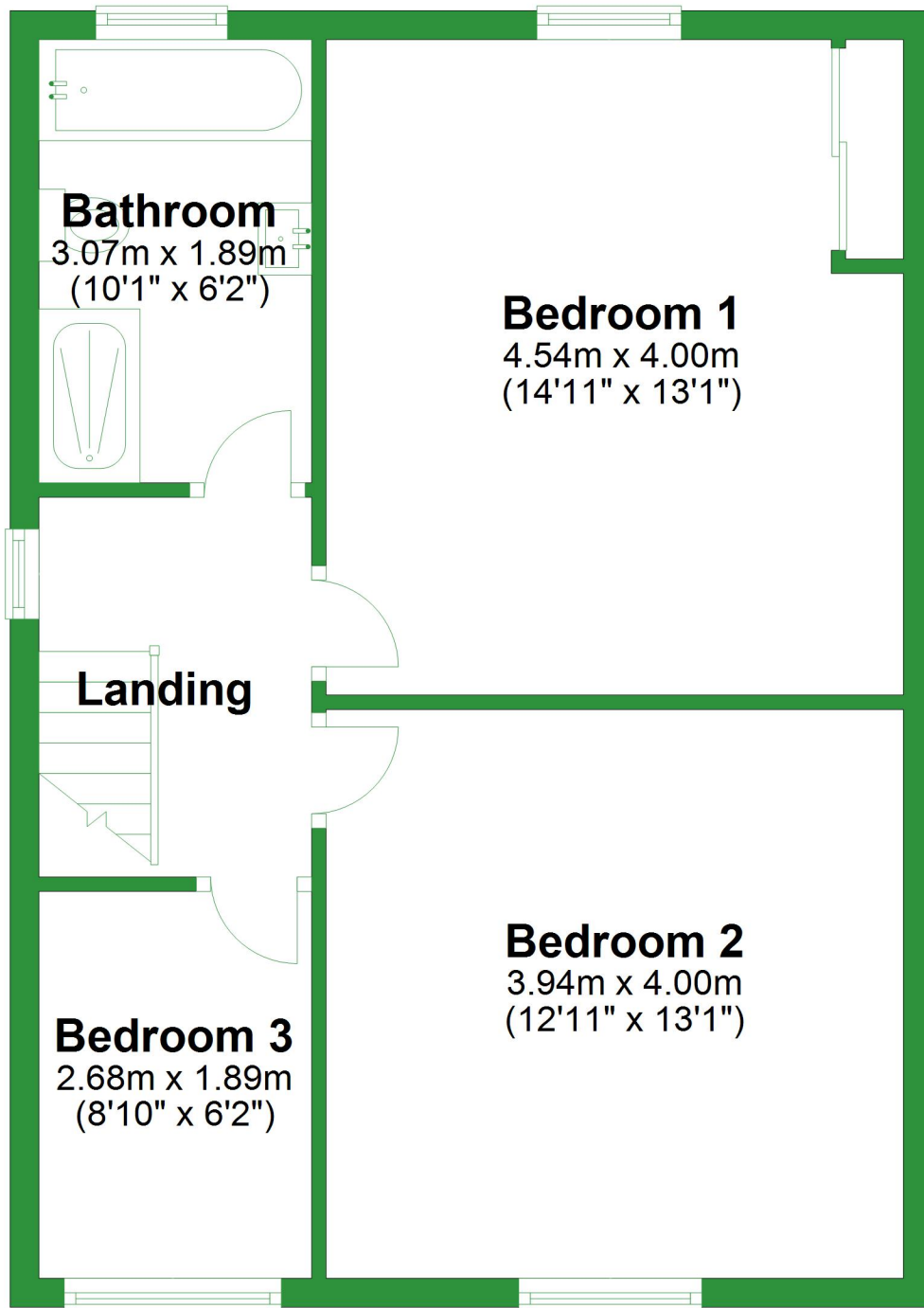

# Ground Floor

Approx. 59.1 sq. metres (636.2 sq. feet)

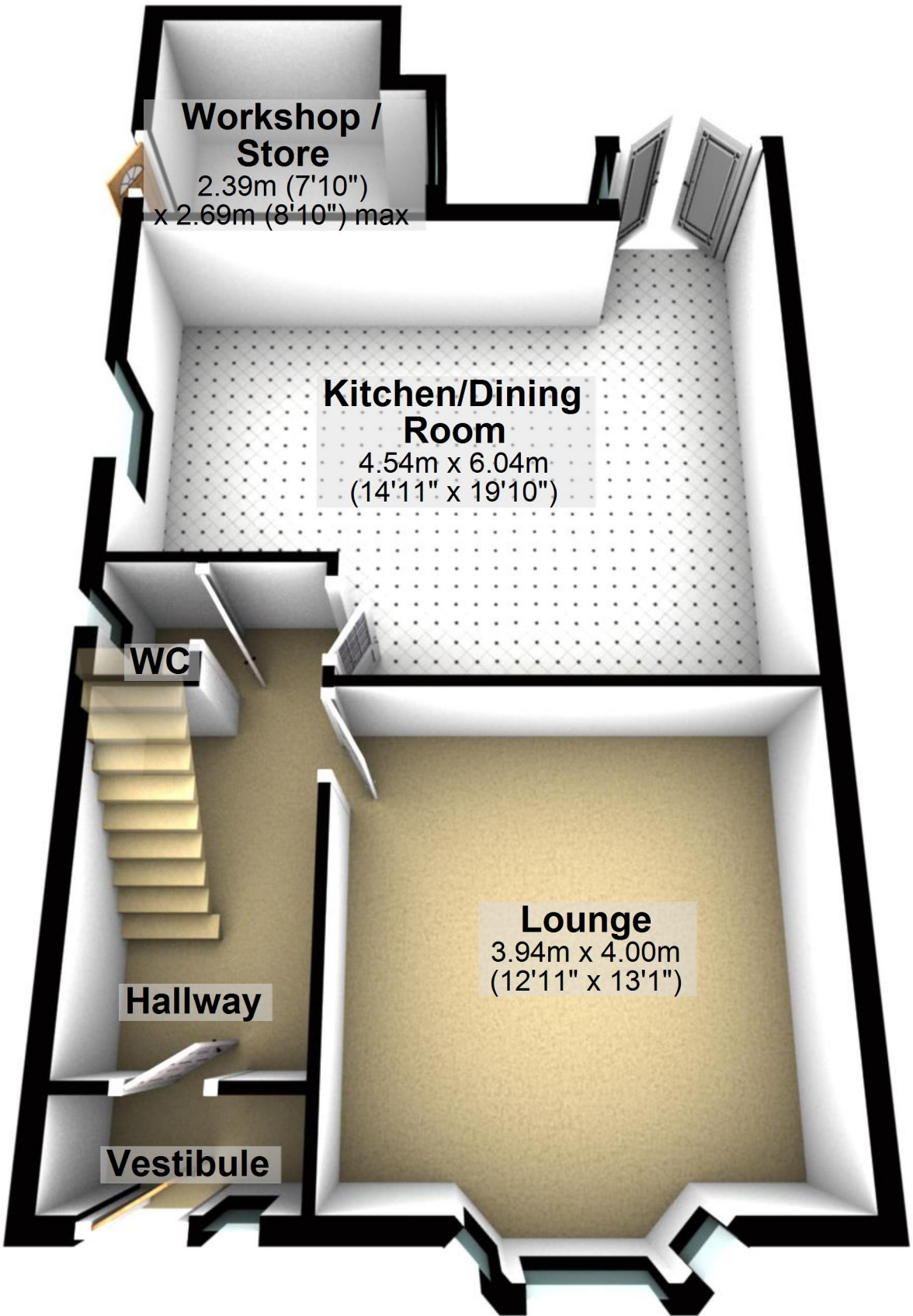

Total area: approx. 110.5 sq. metres (1189.4 sq. feet)

For illustrative purposes only. Not to scale. All sizes are approximate.

Plan produced using PlanUp.

# First Floor

Approx. 51.4 sq. metres (553.2 sq. feet)

## Bathroom

3.07m x 1.89m  
(10'1" x 6'2")

## Bedroom 1

4.54m x 4.00m  
(14'11" x 13'1")

## Landing

## Bedroom 2

3.94m x 4.00m  
(12'11" x 13'1")

## Bedroom 3

2.68m x 1.89m  
(8'10" x 6'2")

