

# Ground Floor

Approx. 43.0 sq. metres (463.3 sq. feet)

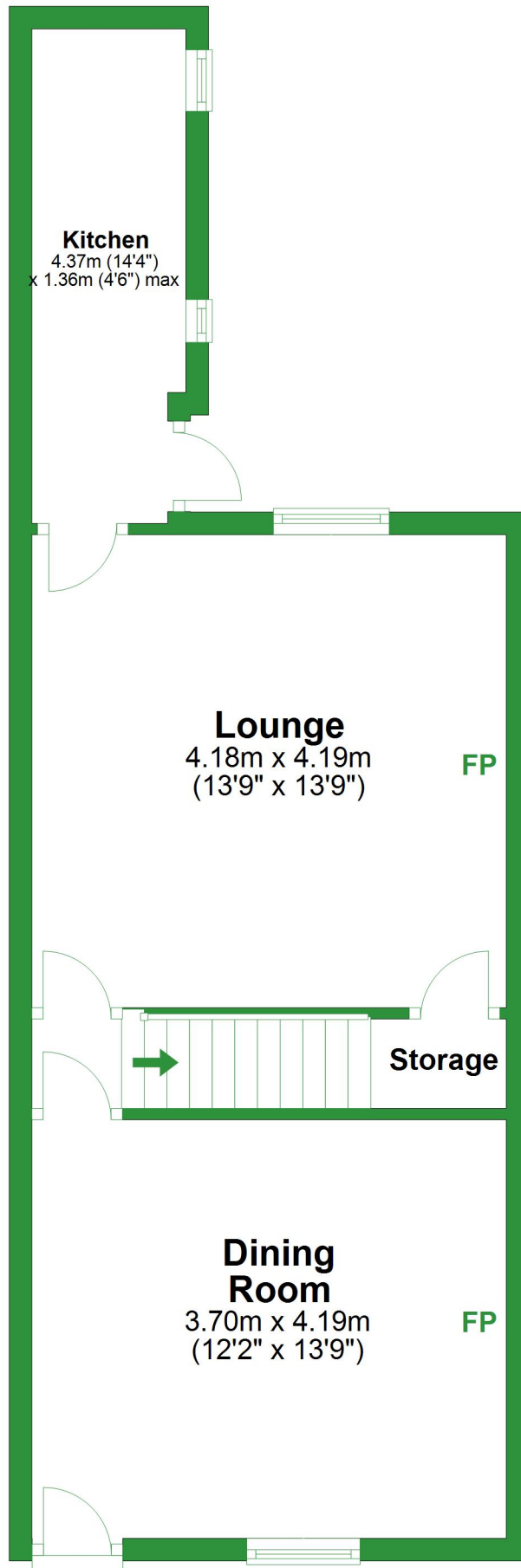

Total area: approx. 80.9 sq. metres (870.4 sq. feet)

For illustrative purposes only. Not to scale. All sizes are approximate.  
Plan produced using PlanUp.

## First Floor

Approx. 37.8 sq. metres (407.1 sq. feet)

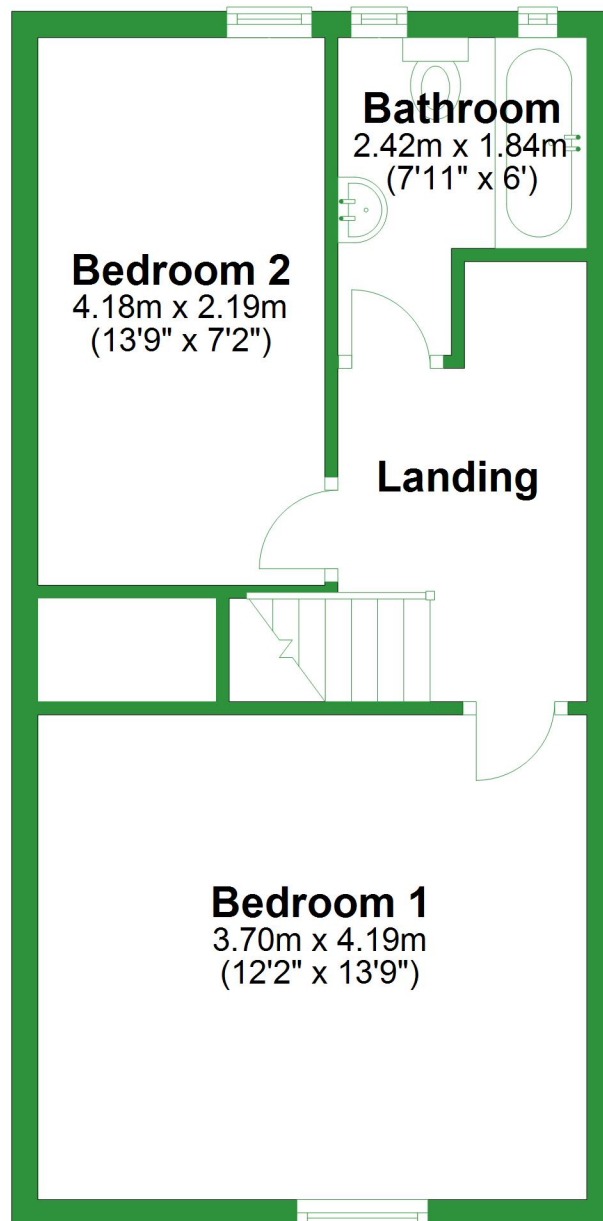

# Ground Floor

Approx. 43.0 sq. metres (463.3 sq. feet)

**Kitchen**  
4.37m (14'4")  
x 1.36m (4'6") max

**Lounge**  
4.18m x 4.19m  
(13'9" x 13'9")

**Storage**

**Dining Room**  
3.70m x 4.19m  
(12'2" x 13'9")

Total area: approx. 80.9 sq. metres (870.4 sq. feet)

For illustrative purposes only. Not to scale. All sizes are approximate.

Plan produced using PlanUp.

## First Floor

Approx. 37.8 sq. metres (407.1 sq. feet)

