

# Ground Floor

Approx. 99.5 sq. metres (1070.7 sq. feet)

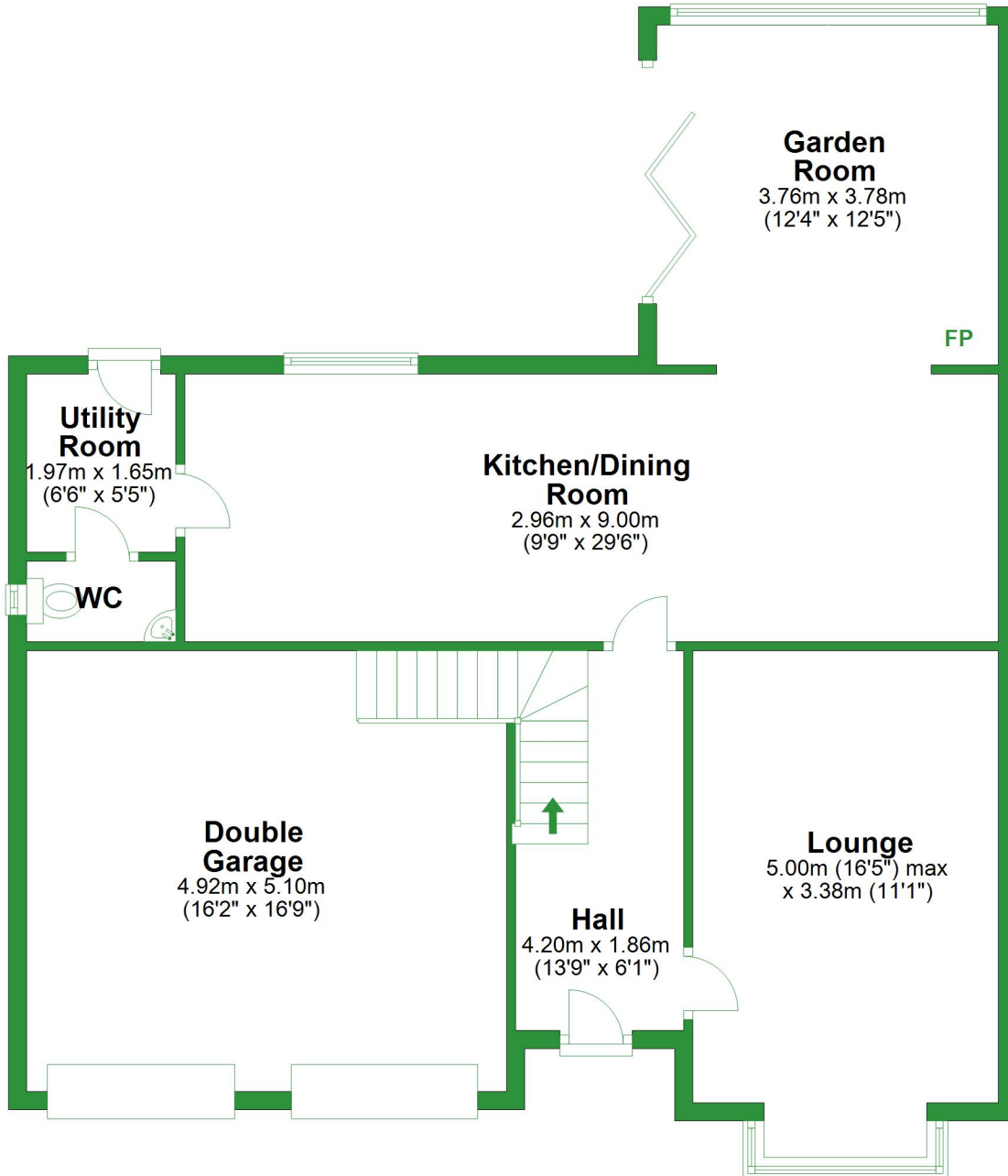

Total area: approx. 177.0 sq. metres (1905.6 sq. feet)

For illustrative purposes only. Not to scale. All sizes are approximate.

Plan produced using PlanUp.

## First Floor

Approx. 77.6 sq. metres (834.9 sq. feet)

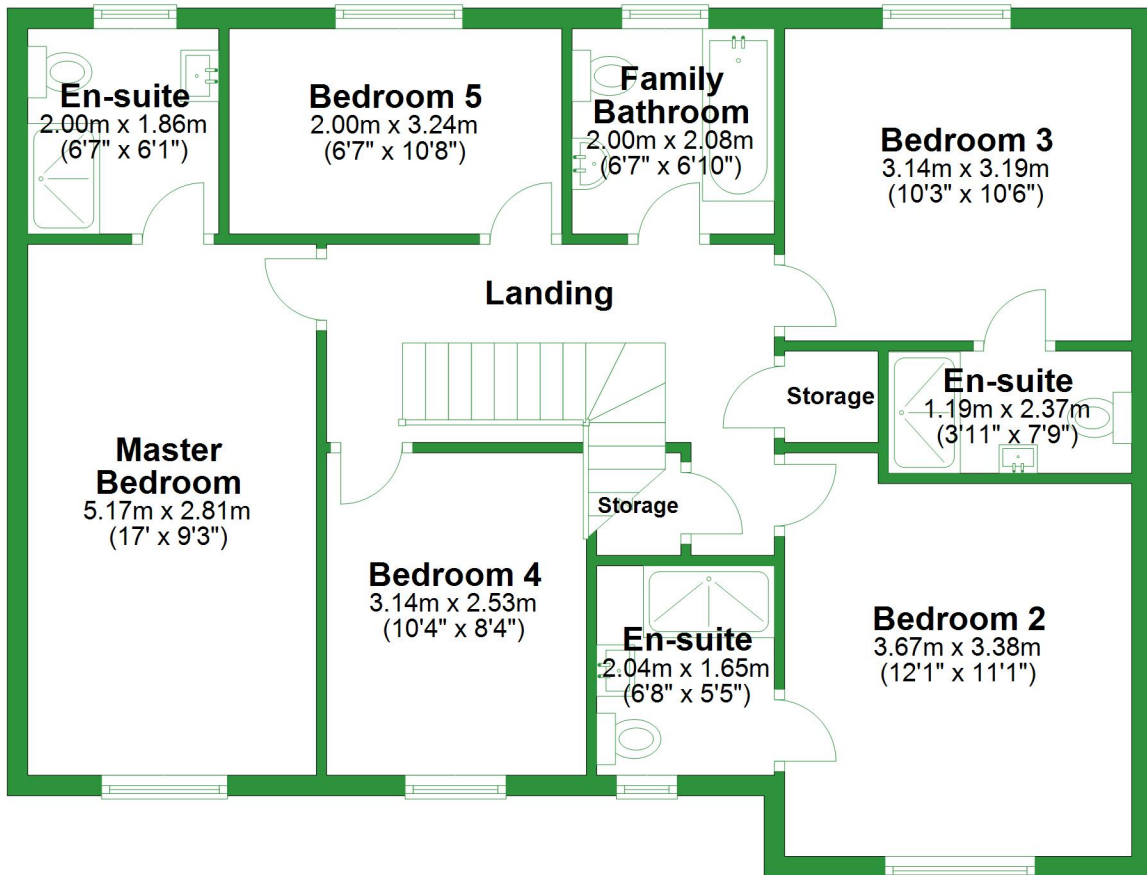

## Ground Floor

Approx. 99.5 sq. metres (1070.7 sq. feet)

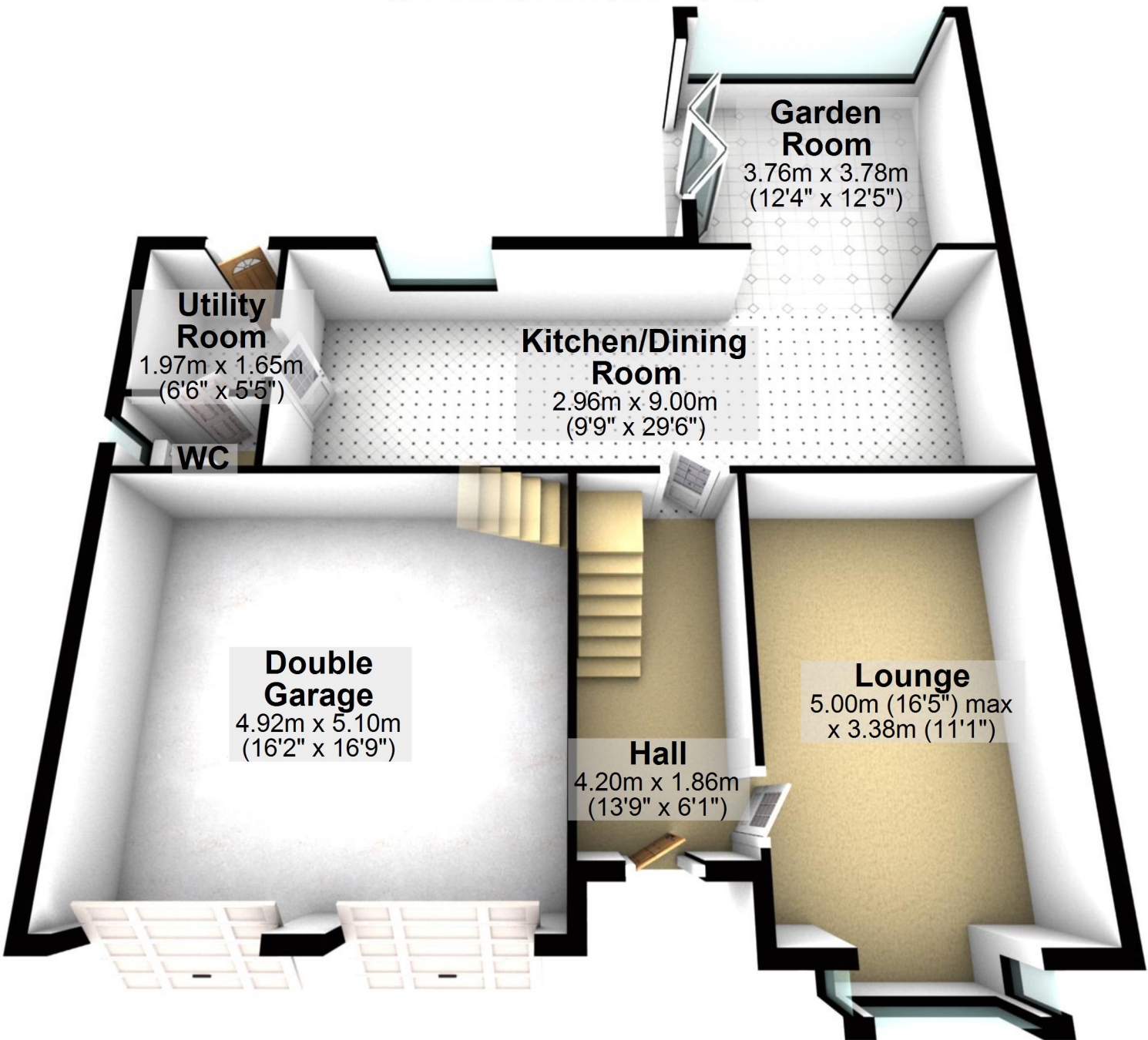

Total area: approx. 177.0 sq. metres (1905.6 sq. feet)

For illustrative purposes only. Not to scale. All sizes are approximate.

Plan produced using PlanUp.

## First Floor

Approx. 77.6 sq. metres (834.9 sq. feet)

