

Ground Floor

Approx. 41.1 sq. metres (442.8 sq. feet)

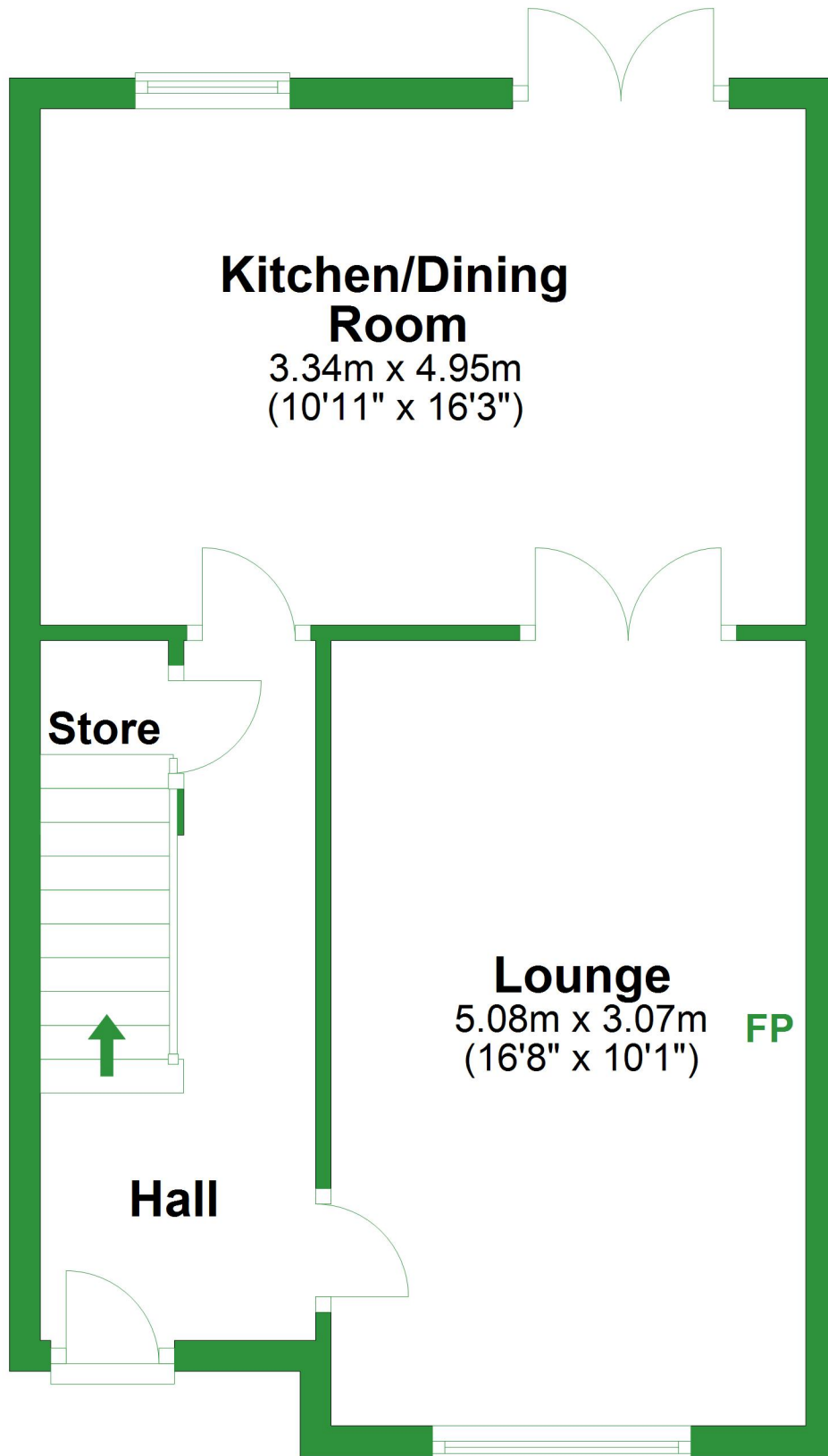

Total area: approx. 96.1 sq. metres (1034.8 sq. feet)

For illustrative purposes only. Not to scale. All sizes are approximate.

Plan produced using PlanUp.

First Floor

Approx. 41.4 sq. metres (445.2 sq. feet)

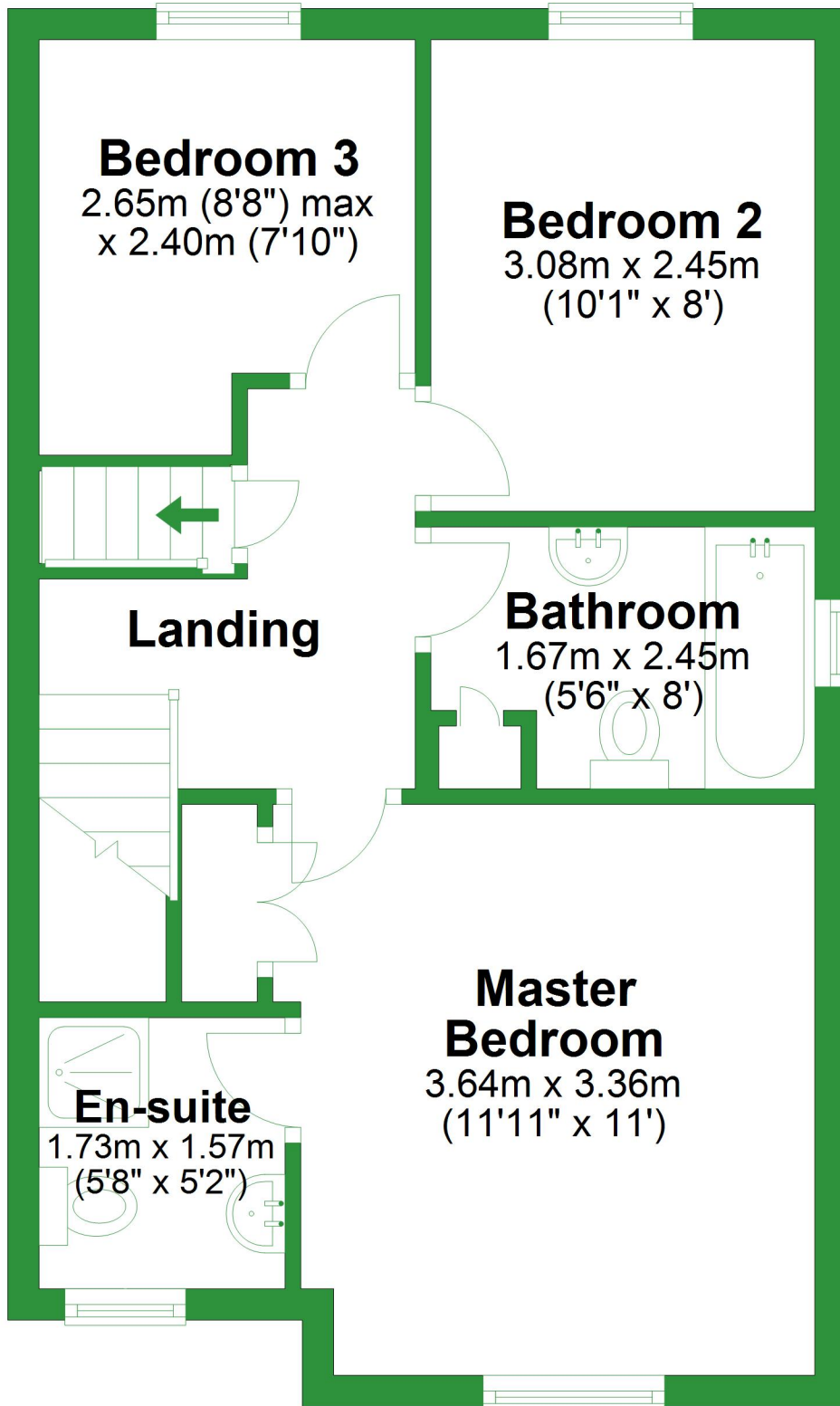

Second Floor

Approx. 13.6 sq. metres (146.8 sq. feet)

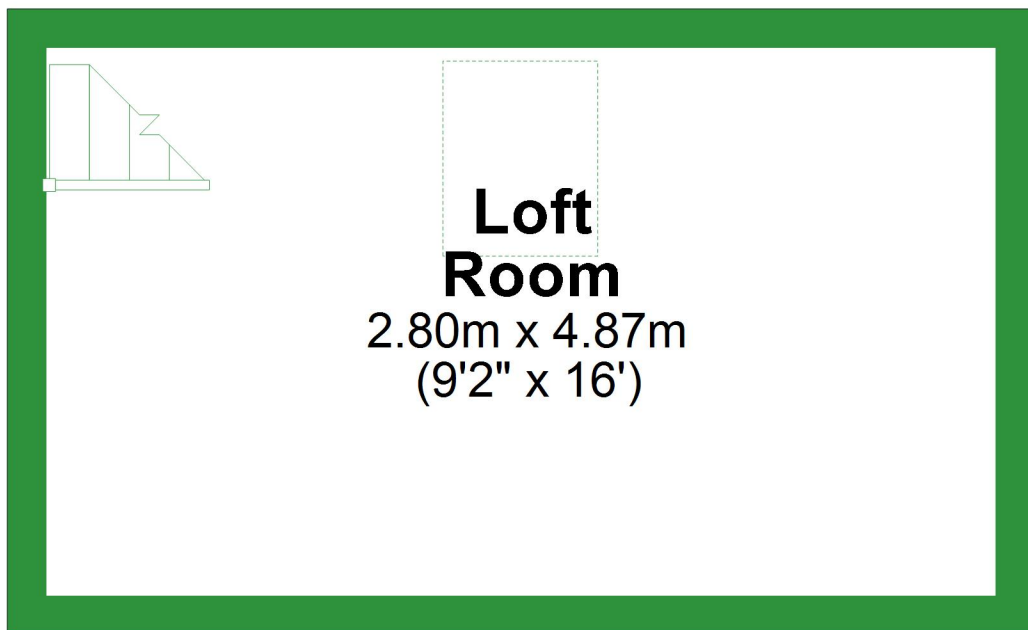

Ground Floor

Approx. 41.1 sq. metres (442.8 sq. feet)

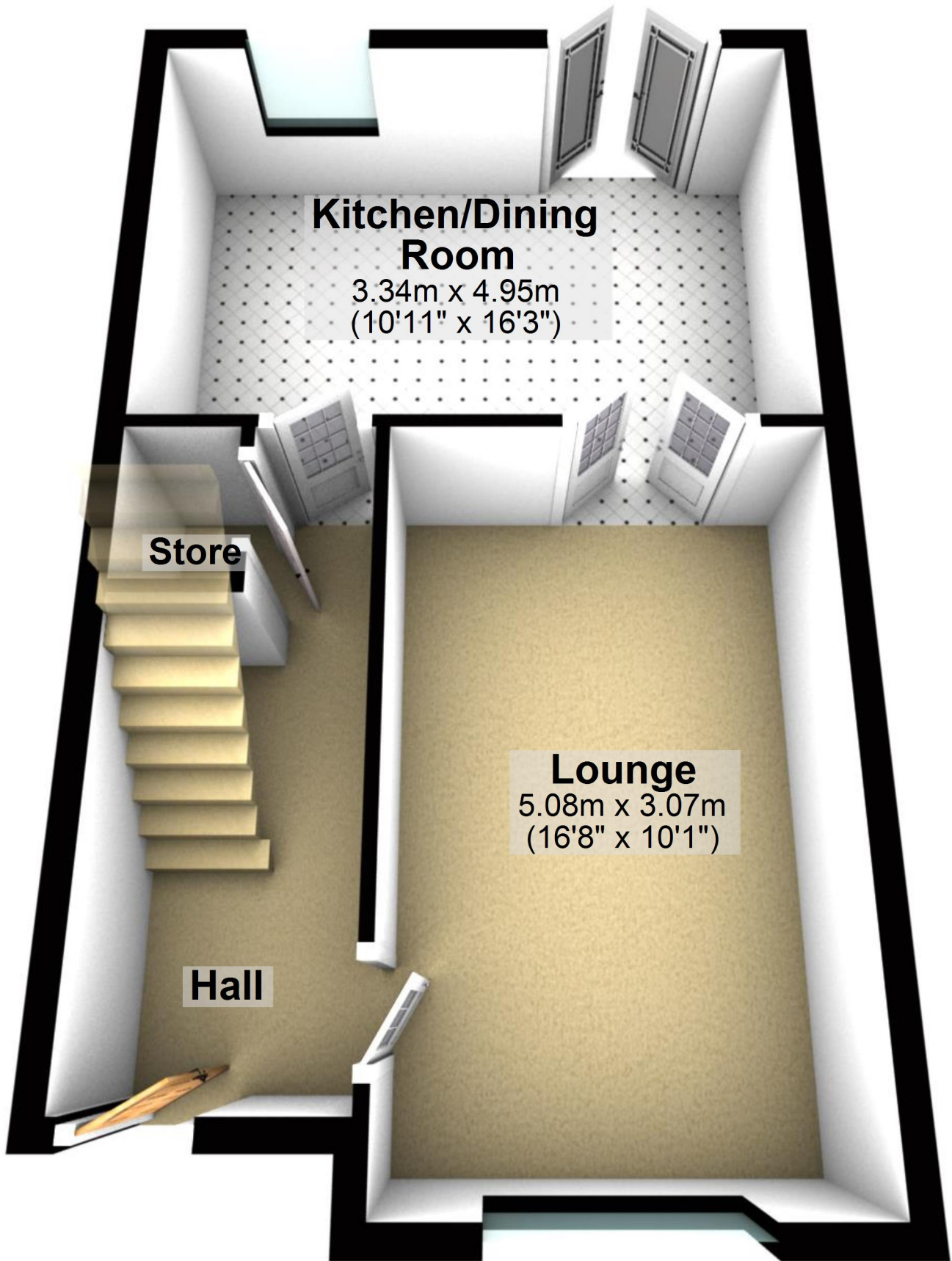

Kitchen/Dining Room

3.34m x 4.95m
(10'11" x 16'3")

Store

Lounge

5.08m x 3.07m
(16'8" x 10'1")

Hall

Total area: approx. 96.1 sq. metres (1034.8 sq. feet)

For illustrative purposes only. Not to scale. All sizes are approximate.

Plan produced using PlanUp.

First Floor

Approx. 41.4 sq. metres (445.2 sq. feet)

Bedroom 3

2.65m (8'8") max
x 2.40m (7'10")

Bedroom 2

3.08m x 2.45m
(10'1" x 8')

Landing

Bathroom

1.67m x 2.45m
(5'6" x 8')

En-suite

1.73m x 1.57m
(5'8" x 5'2")

Master Bedroom

3.64m x 3.36m
(11'11" x 11')



Second Floor

Approx. 13.6 sq. metres (146.8 sq. feet)



A 3D perspective rendering of a loft room. The room has light-colored walls and a light-colored floor. A staircase with a metal railing is visible on the left side. A central text overlay provides the room's name and dimensions.

Loft

Room

2.80m x 4.87m
(9'2" x 16')