

# Ground Floor

Approx. 67.5 sq. metres (726.4 sq. feet)

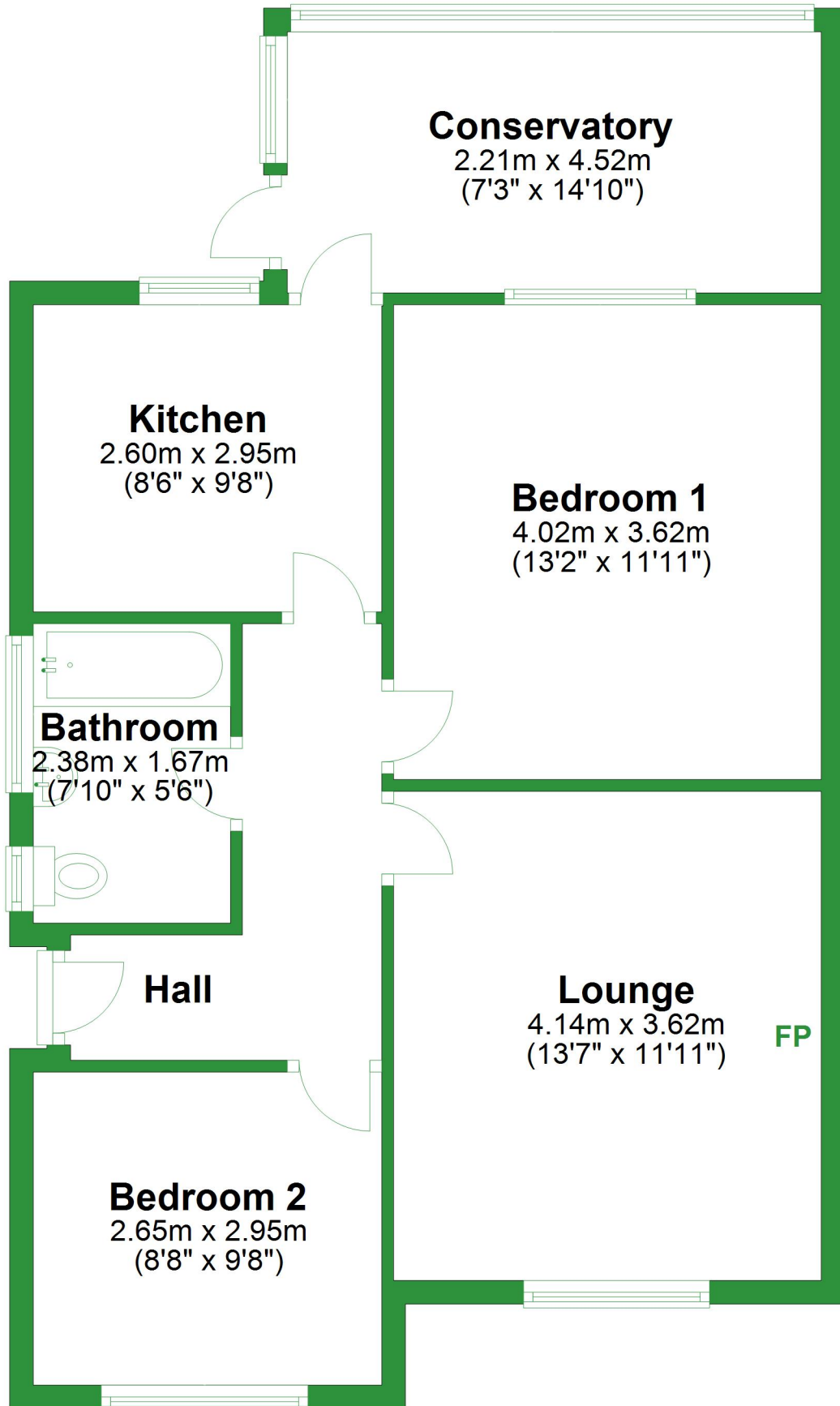

Total area: approx. 97.1 sq. metres (1045.4 sq. feet)

For illustrative purposes only. Not to scale. All sizes are approximate.

Plan produced using PlanUp.

## **First Floor**

Approx. 29.6 sq. metres (319.0 sq. feet)



**Loft**

**Room**

5.54m x 5.35m  
(18'2" x 17'7")

## Ground Floor

Approx. 67.5 sq. metres (726.4 sq. feet)

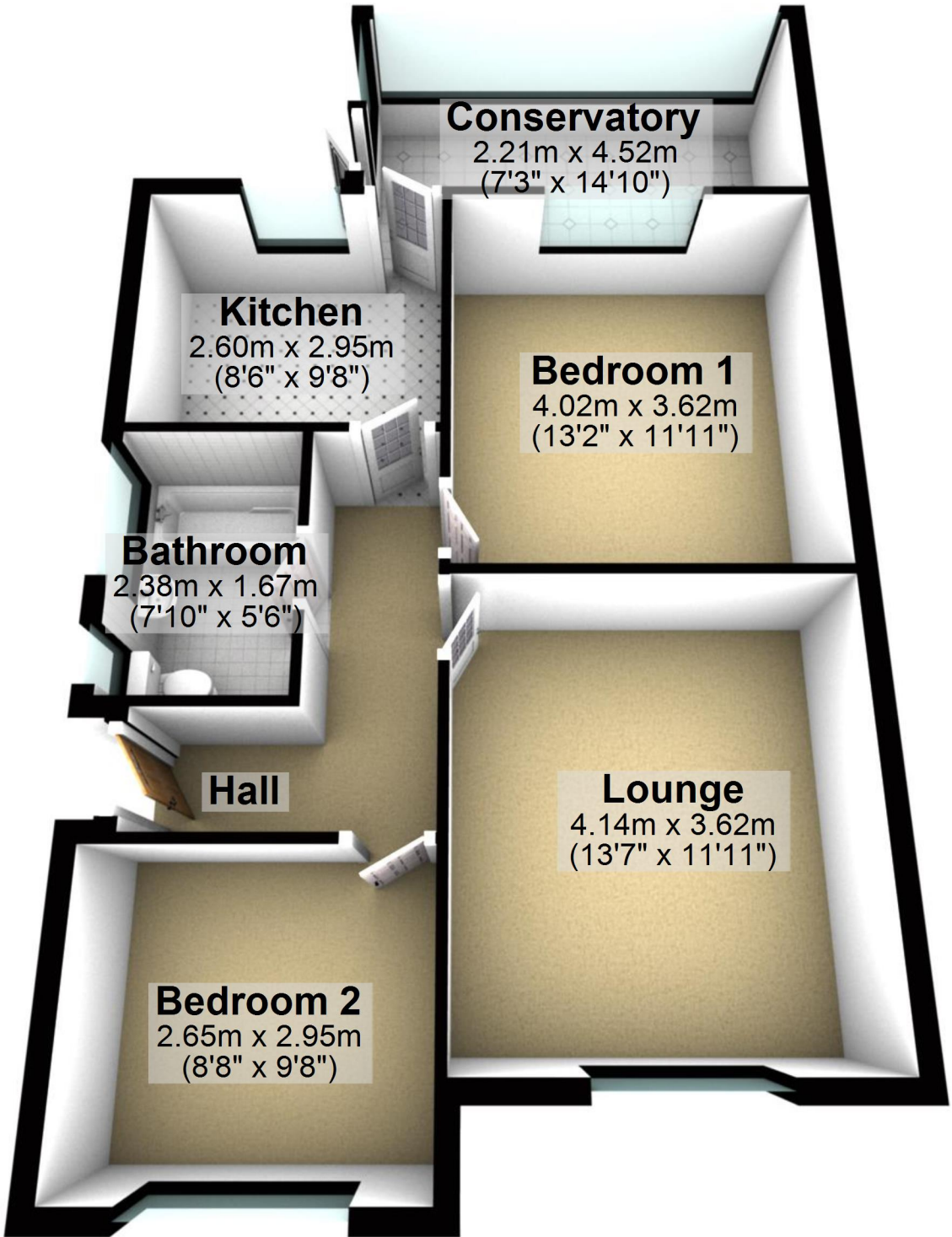

Total area: approx. 97.1 sq. metres (1045.4 sq. feet)

For illustrative purposes only. Not to scale. All sizes are approximate.

Plan produced using PlanUp.

## First Floor

Approx. 29.6 sq. metres (319.0 sq. feet)

### Loft Room

5.54m x 5.35m  
(18'2" x 17'7")