

# Ground Floor

Approx. 110.9 sq. metres (1194.0 sq. feet)

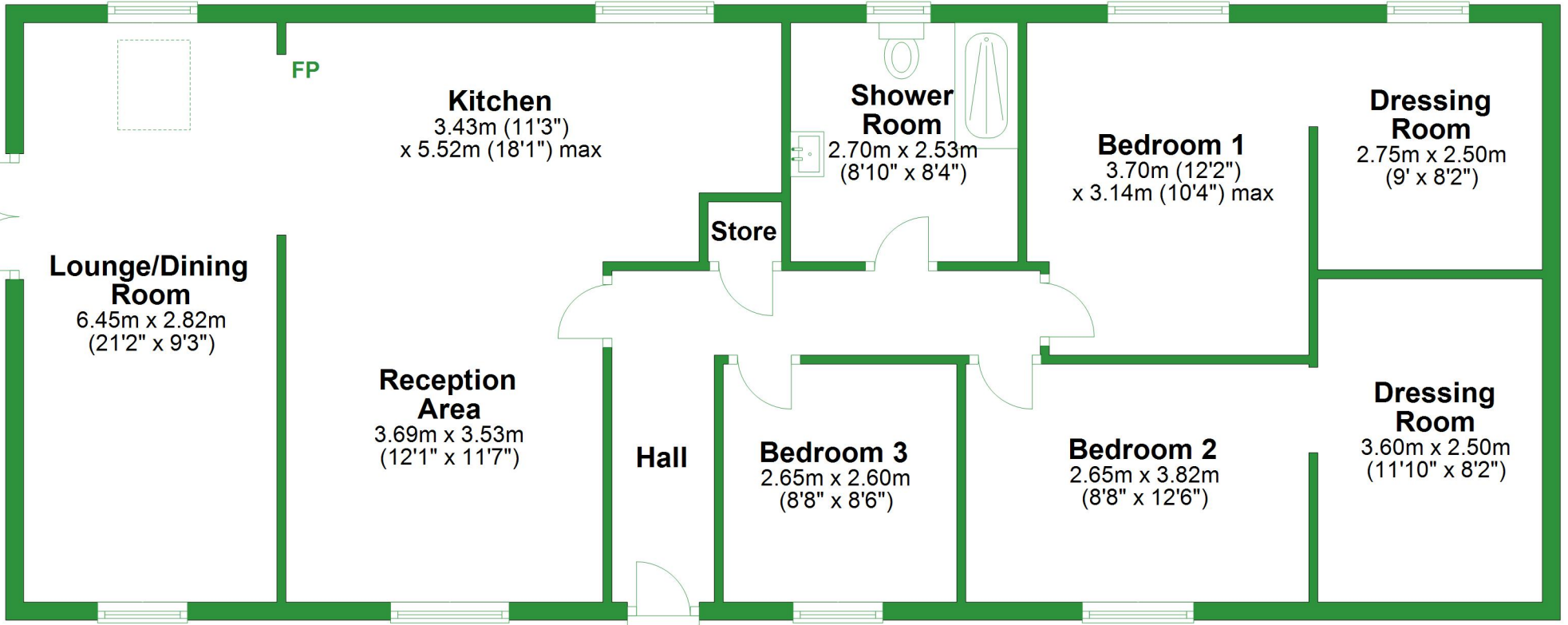

## Basement

Approx. 16.5 sq. metres (177.3 sq. feet)

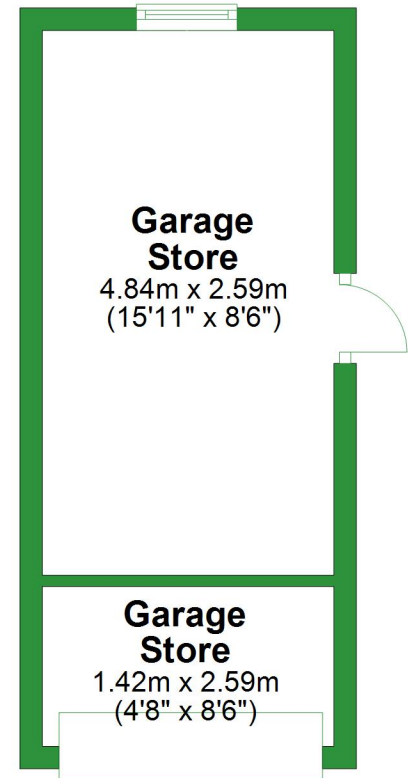

Total area: approx. 127.4 sq. metres (1371.3 sq. feet)

For illustrative purposes only. Not to scale. All sizes are approximate.  
Plan produced using PlanUp.

## Ground Floor

Approx. 110.9 sq. metres (1194.0 sq. feet)

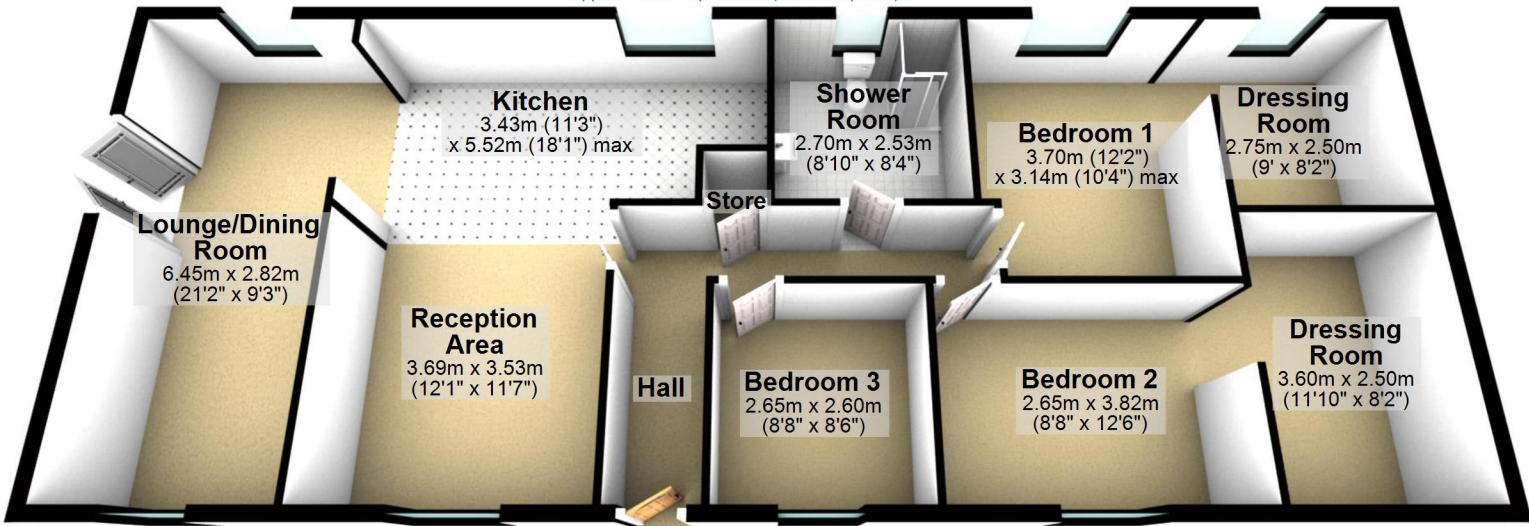

## Basement

Approx. 16.5 sq. metres (177.3 sq. feet)

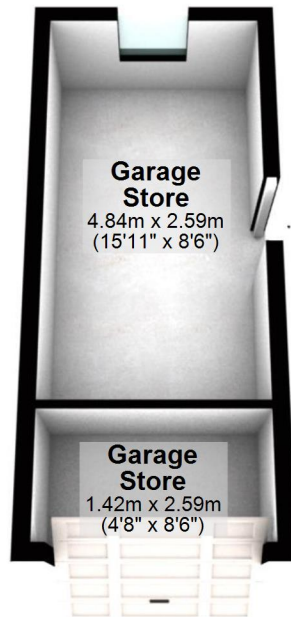

Total area: approx. 127.4 sq. metres (1371.3 sq. feet)

For illustrative purposes only. Not to scale. All sizes are approximate.  
Plan produced using PlanUp.