

# Ground Floor

Approx. 110.4 sq. metres (1188.1 sq. feet)

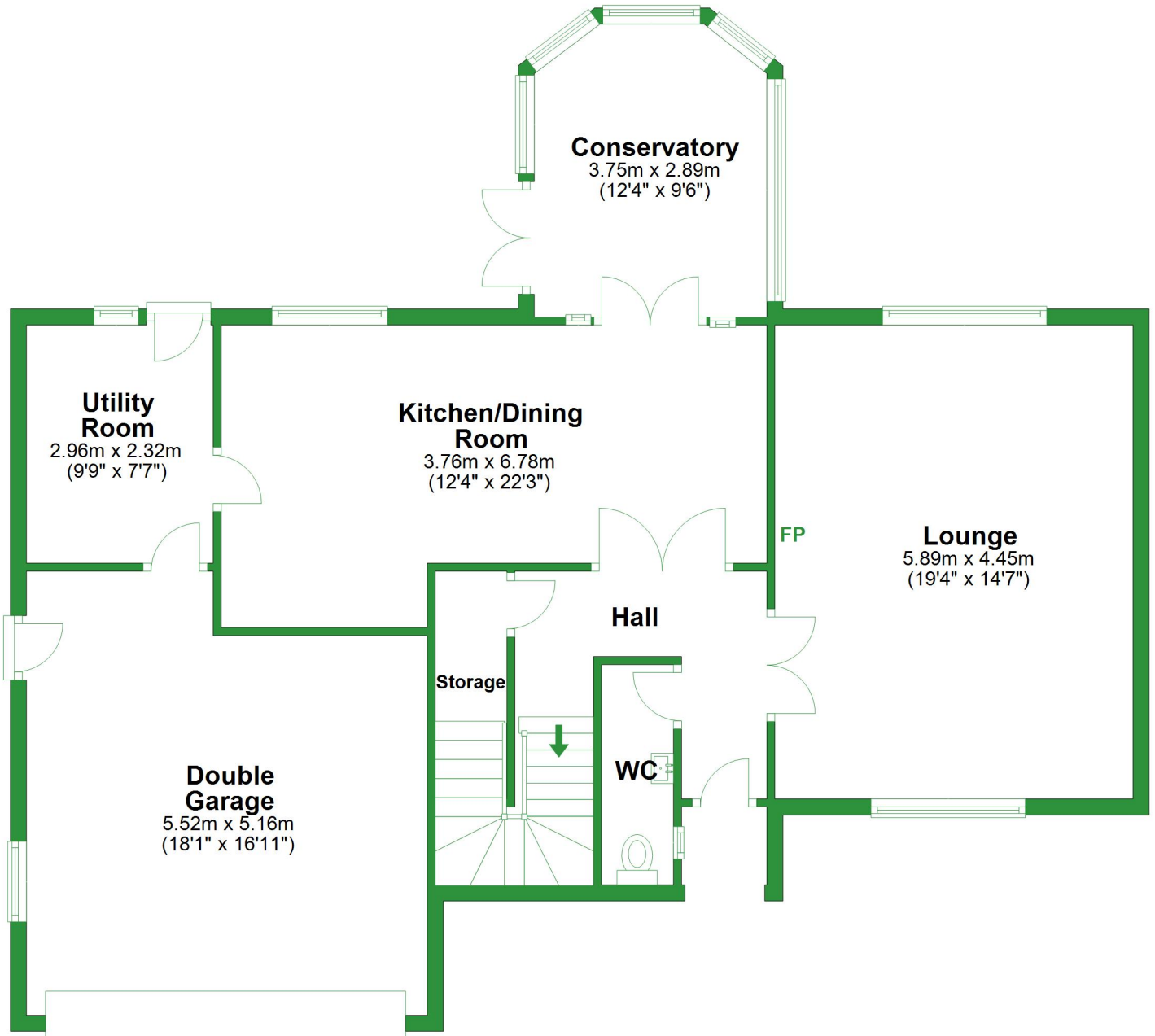

Total area: approx. 182.2 sq. metres (1961.1 sq. feet)

For illustrative purposes only. Not to scale. All sizes are approximate.  
Plan produced using PlanUp.

## First Floor

Approx. 71.8 sq. metres (773.0 sq. feet)

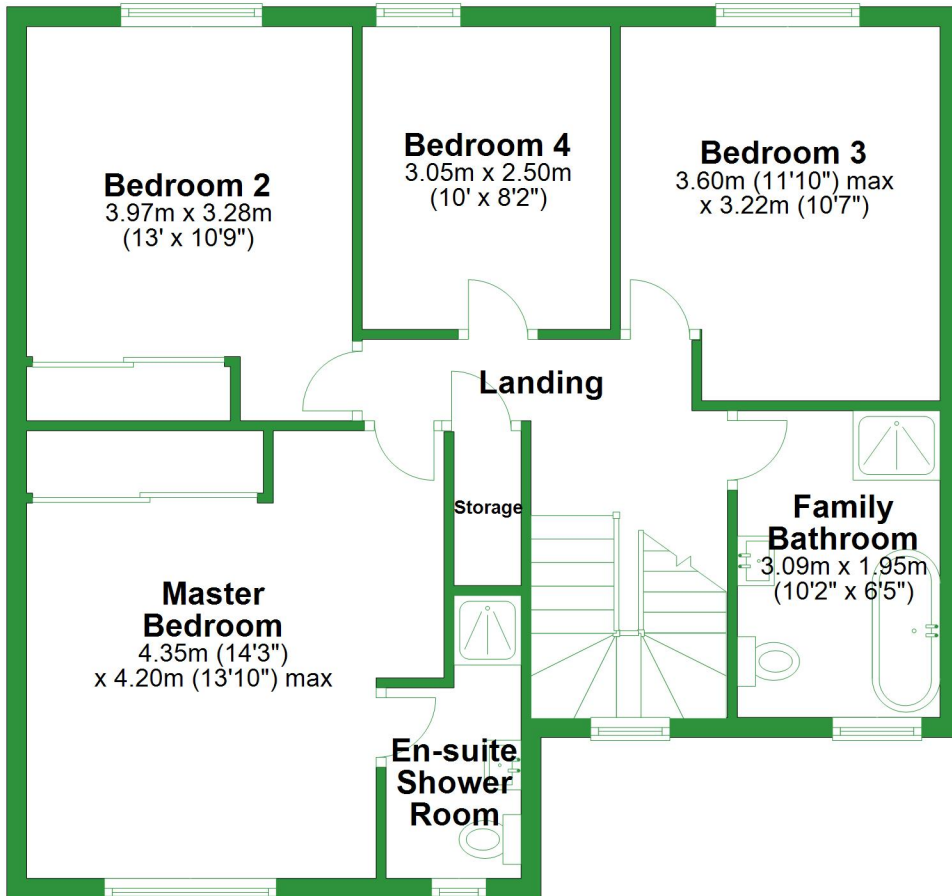

## Ground Floor

Approx. 110.4 sq. metres (1188.1 sq. feet)

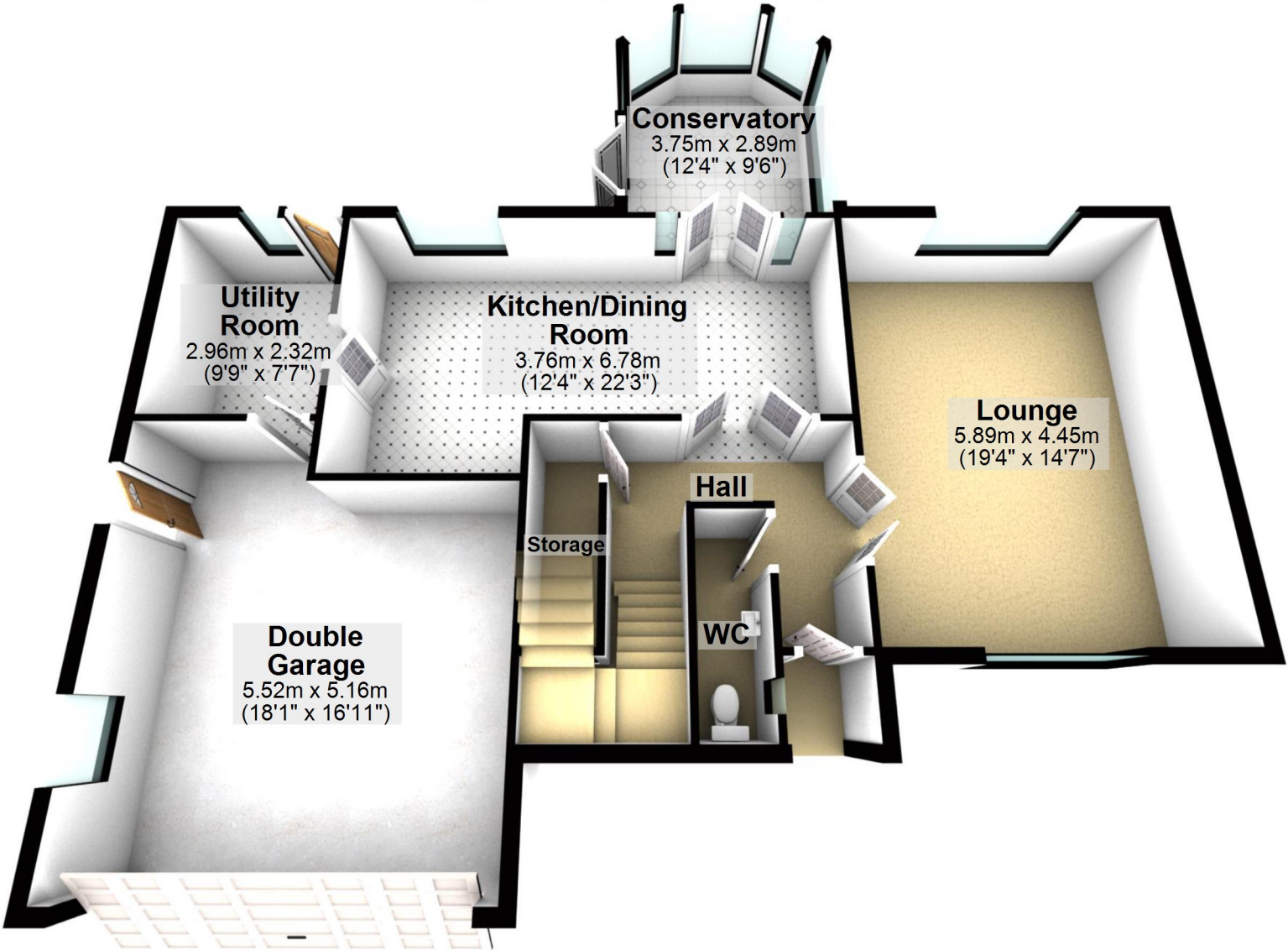

Total area: approx. 182.2 sq. metres (1961.1 sq. feet)

For illustrative purposes only. Not to scale. All sizes are approximate.  
Plan produced using PlanUp.

## First Floor

Approx. 71.8 sq. metres (773.0 sq. feet)

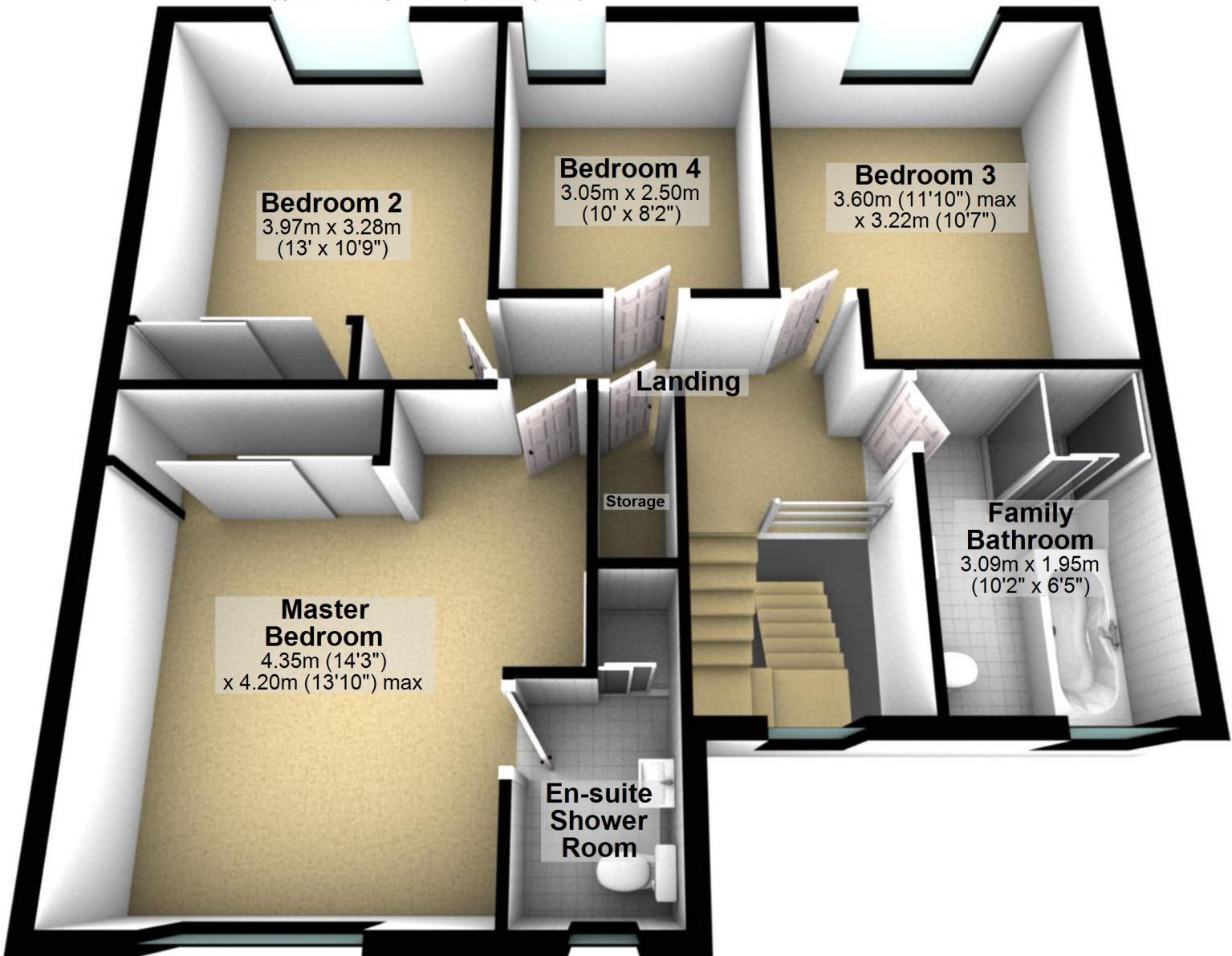

**Bedroom 2**  
3.97m x 3.28m  
(13' x 10'9")

**Bedroom 4**  
3.05m x 2.50m  
(10' x 8'2")

**Bedroom 3**  
3.60m (11'10") max  
x 3.22m (10'7")

**Landing**

**Storage**

**Master  
Bedroom**  
4.35m (14'3")  
x 4.20m (13'10") max

**Family  
Bathroom**  
3.09m x 1.95m  
(10'2" x 6'5")

**En-suite  
Shower  
Room**