

# Ground Floor

Approx. 89.8 sq. metres (966.8 sq. feet)

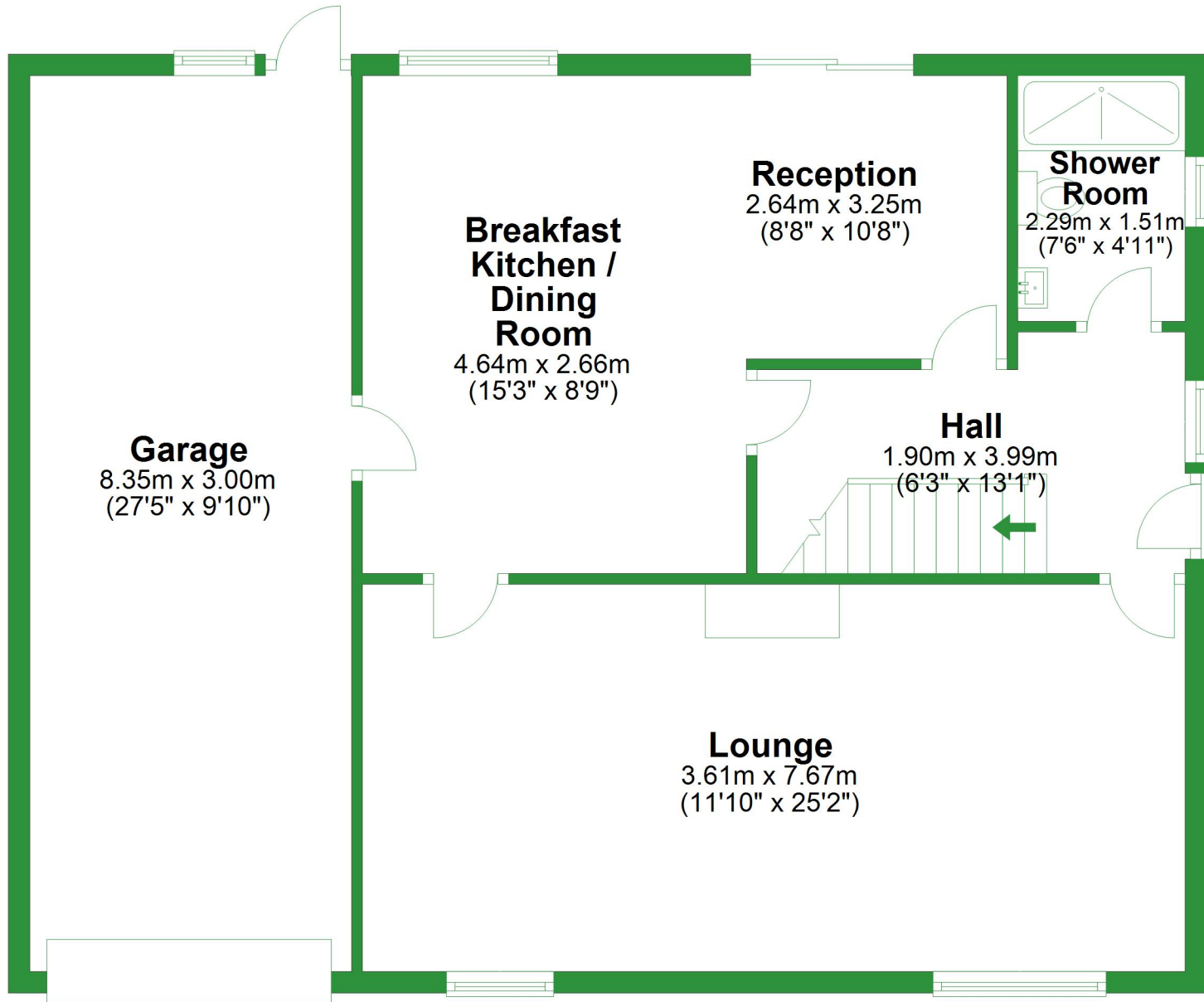

Total area: approx. 154.2 sq. metres (1660.0 sq. feet)

For illustrative purposes only. Not to scale. All sizes are approximate.

Plan produced using PlanUp.

# First Floor

Approx. 64.4 sq. metres (693.3 sq. feet)

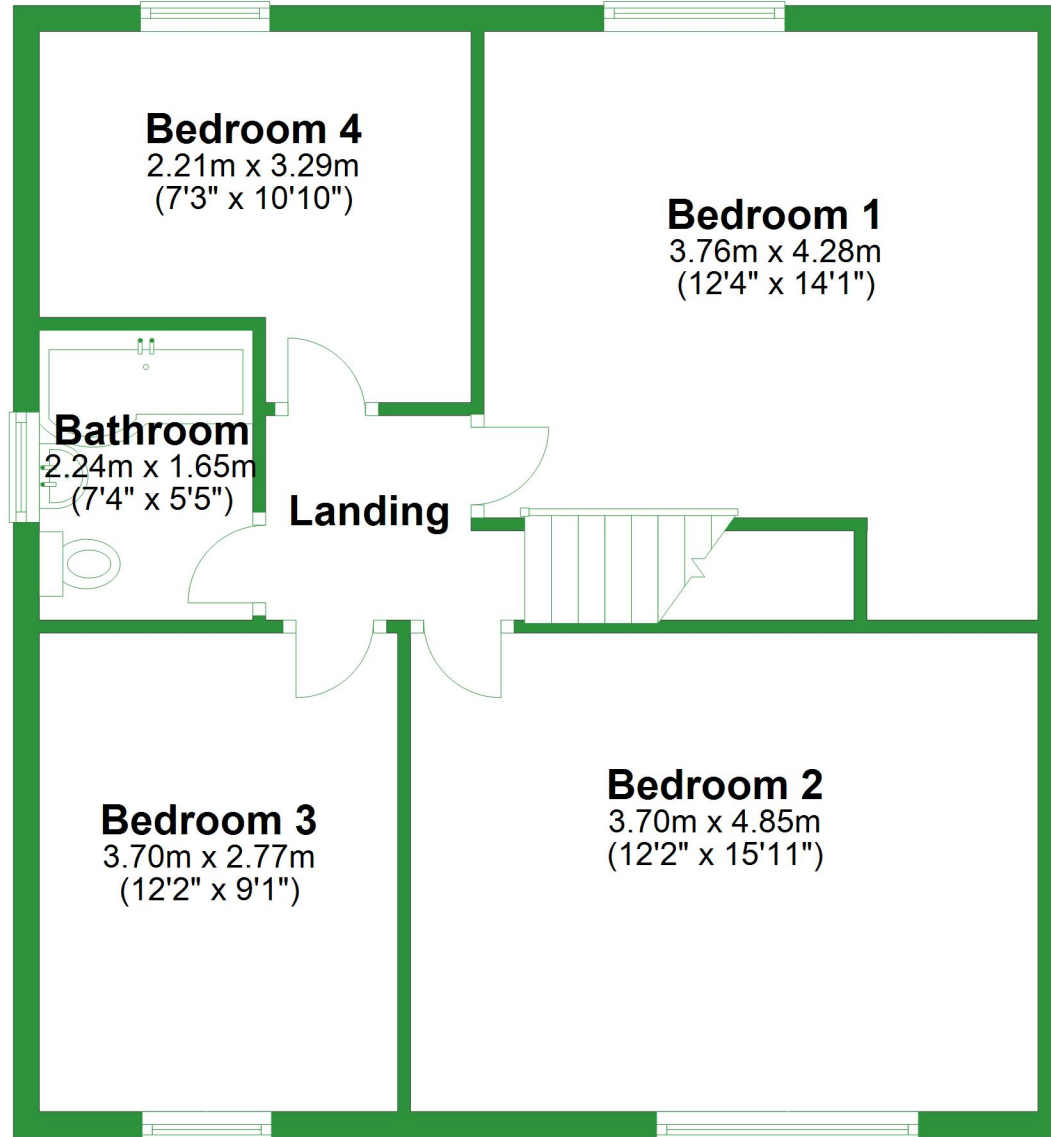

## Ground Floor

Approx. 89.8 sq. metres (966.8 sq. feet)

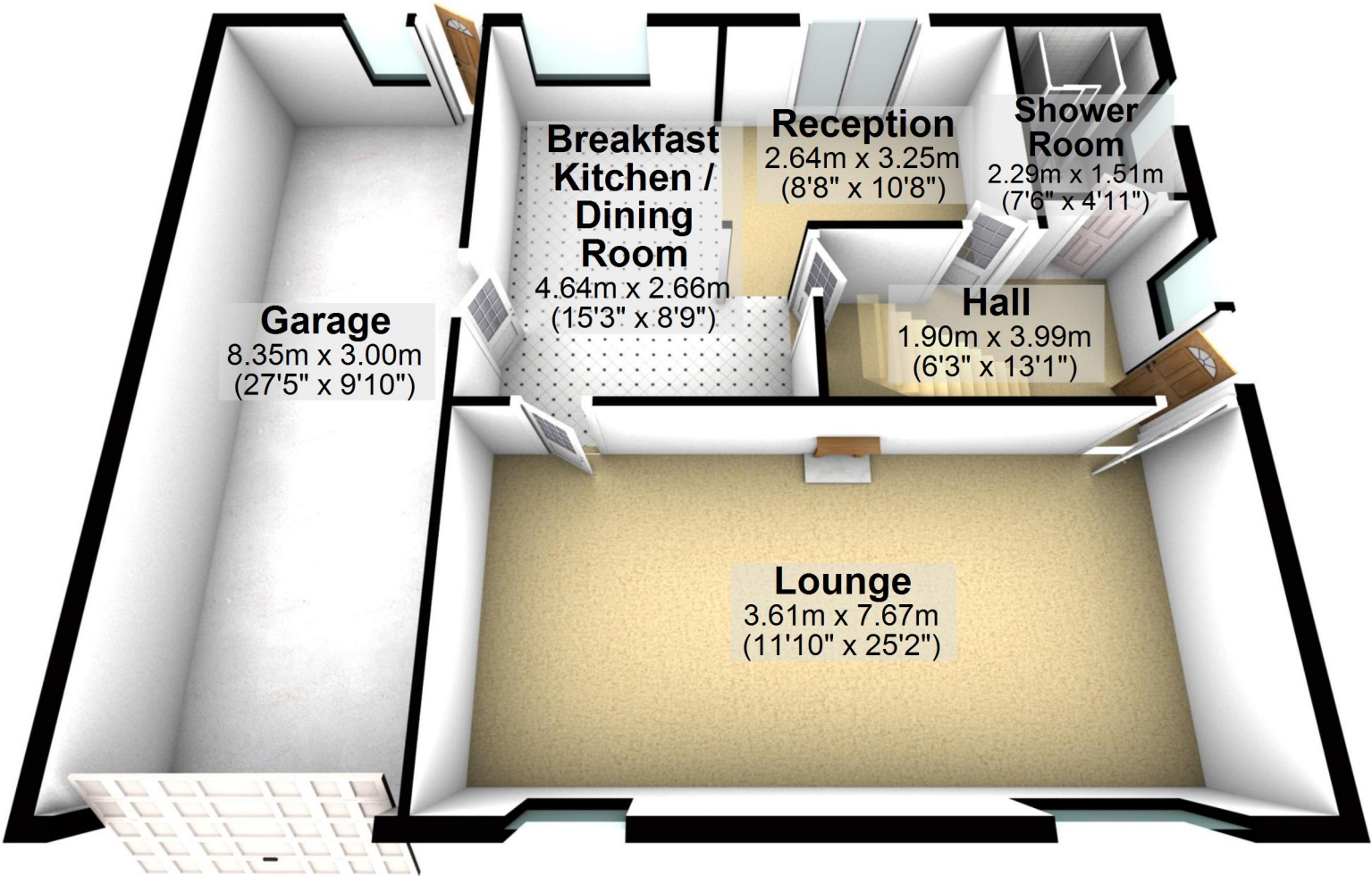

Total area: approx. 154.2 sq. metres (1660.0 sq. feet)

For illustrative purposes only. Not to scale. All sizes are approximate.  
Plan produced using PlanUp.

# First Floor

Approx. 64.4 sq. metres (693.3 sq. feet)

**Bedroom 4**  
2.21m x 3.29m  
(7'3" x 10'10")

**Bedroom 1**  
3.76m x 4.28m  
(12'4" x 14'1")

**Bathroom**  
2.24m x 1.65m  
(7'4" x 5'5")

**Landing**

**Bedroom 3**  
3.70m x 2.77m  
(12'2" x 9'1")

**Bedroom 2**  
3.70m x 4.85m  
(12'2" x 15'11")

