

# Ground Floor

Approx. 51.0 sq. metres (549.3 sq. feet)

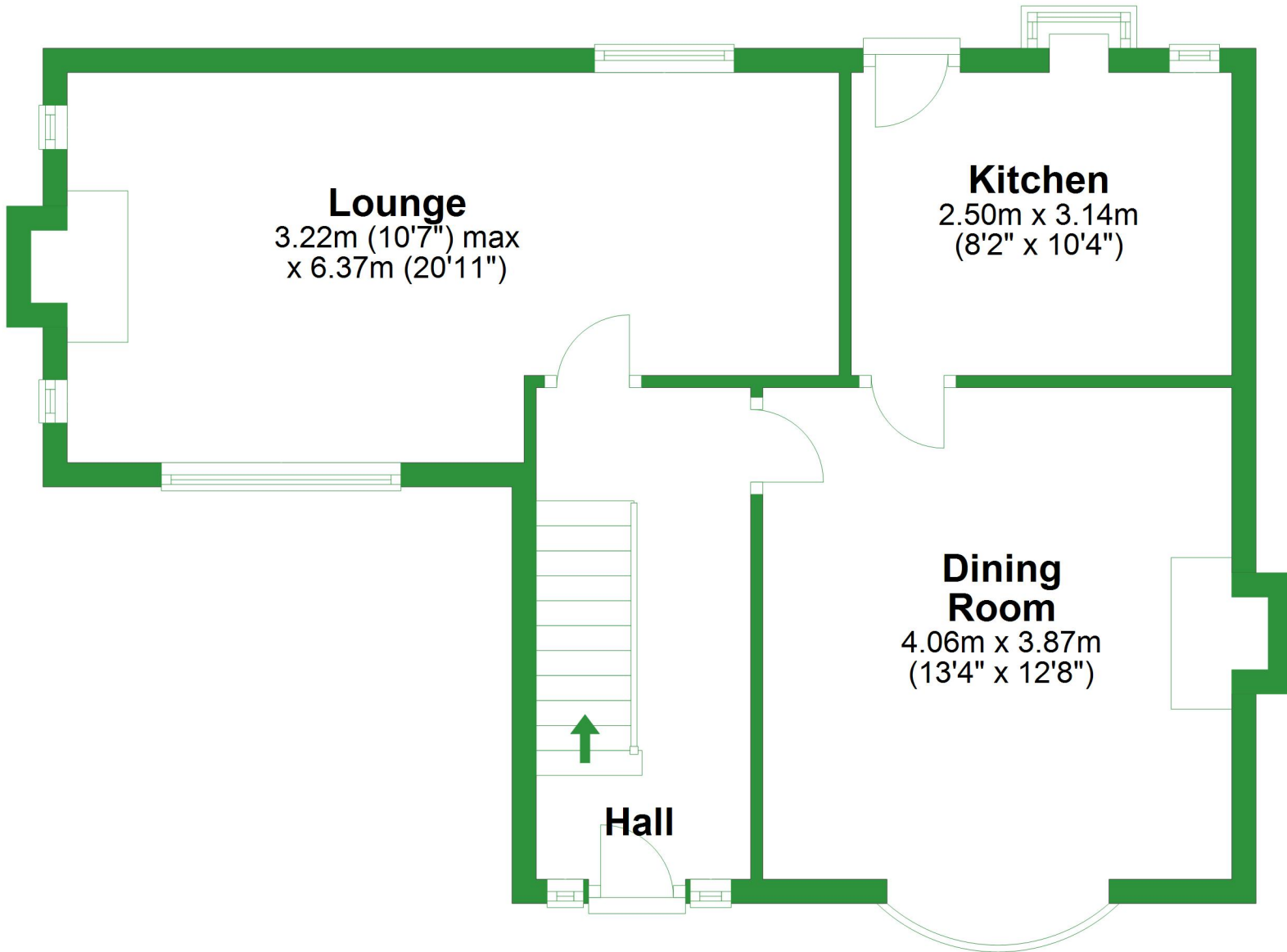

Total area: approx. 101.9 sq. metres (1096.7 sq. feet)

For illustrative purposes only. Not to scale. All sizes are approximate.  
Plan produced using PlanUp.

# First Floor

Approx. 50.9 sq. metres (547.4 sq. feet)

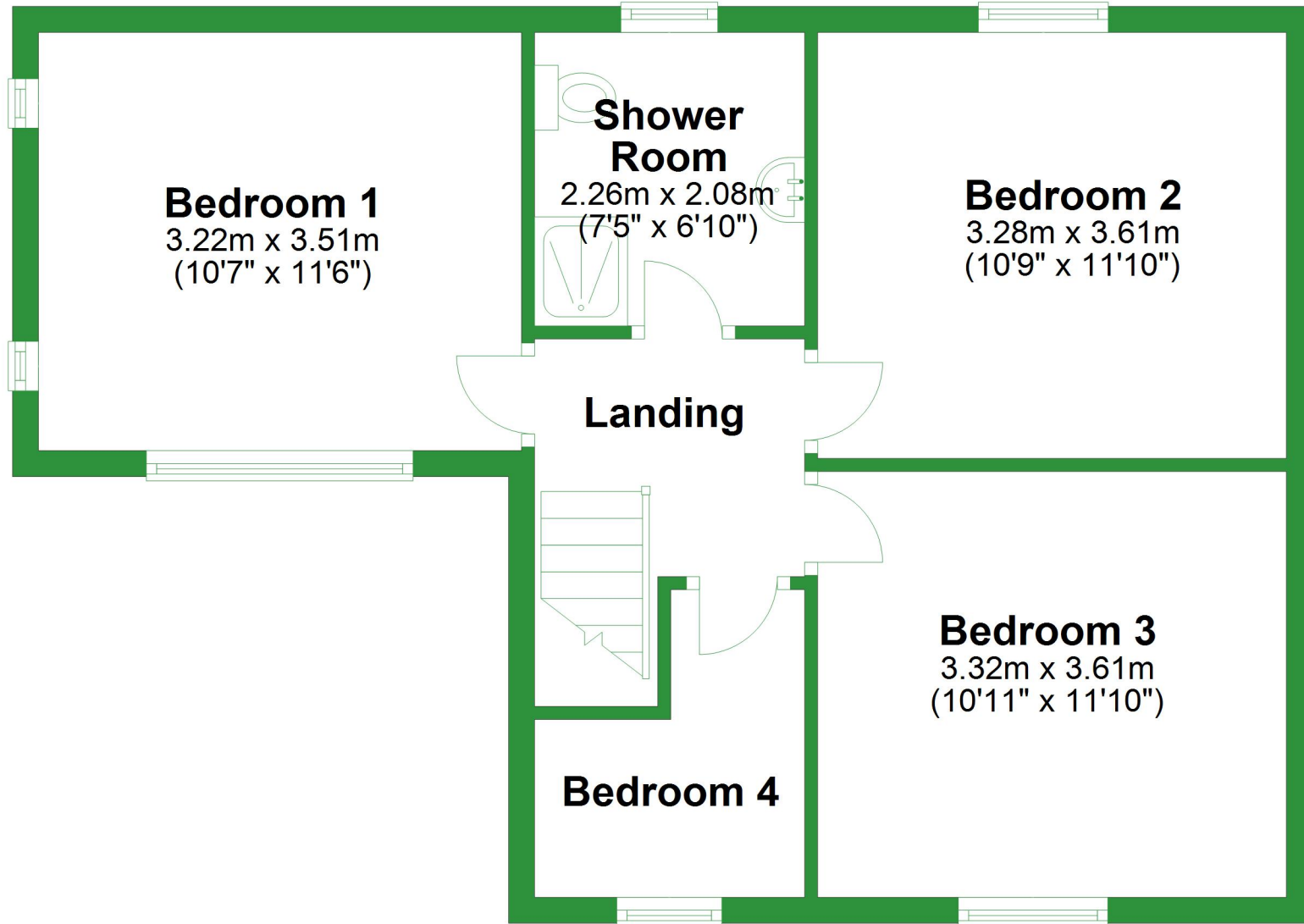

## Ground Floor

Approx. 51.0 sq. metres (549.3 sq. feet)

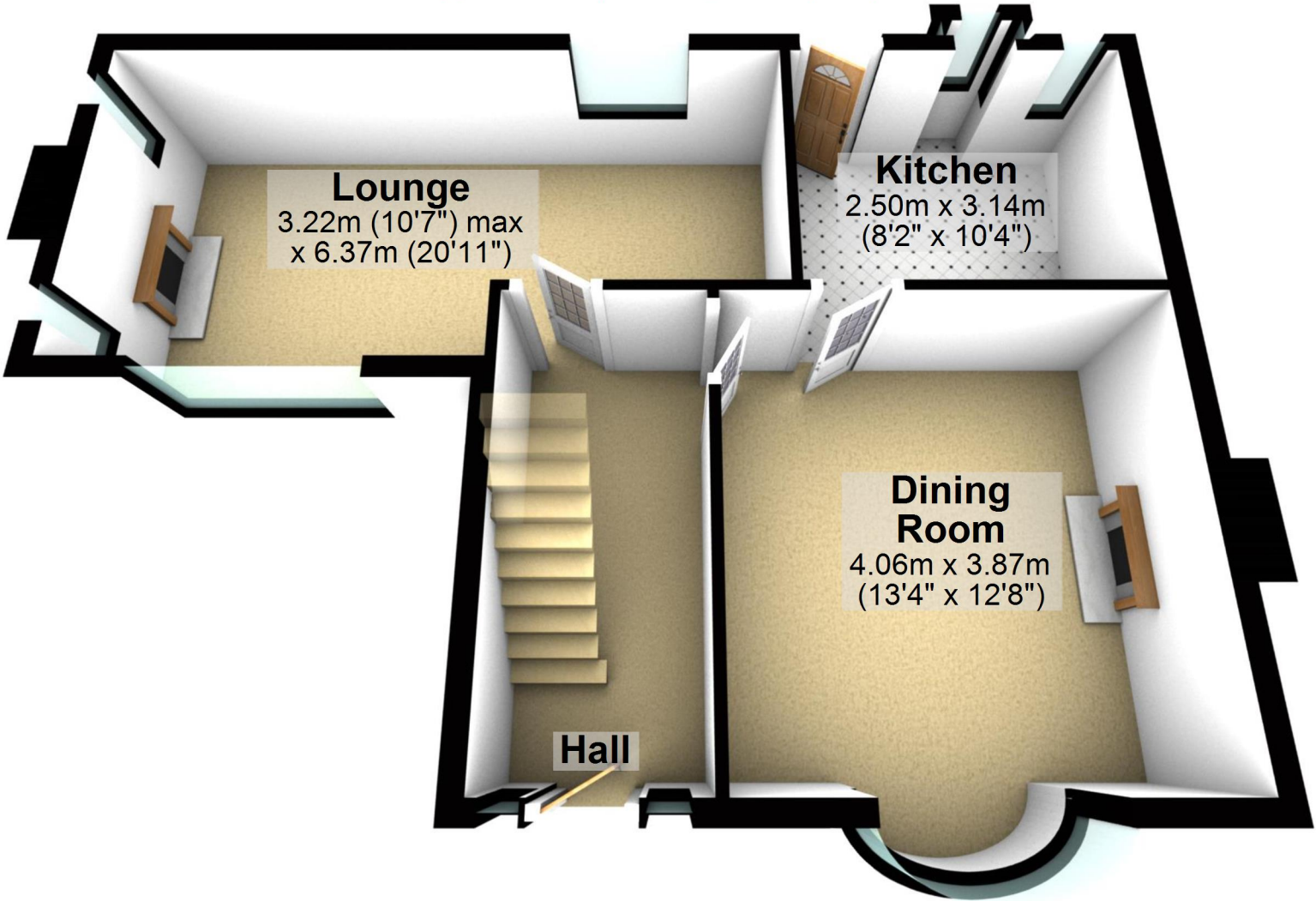

Total area: approx. 101.9 sq. metres (1096.7 sq. feet)

For illustrative purposes only. Not to scale. All sizes are approximate.  
Plan produced using PlanUp.

# First Floor

Approx. 50.9 sq. metres (547.4 sq. feet)

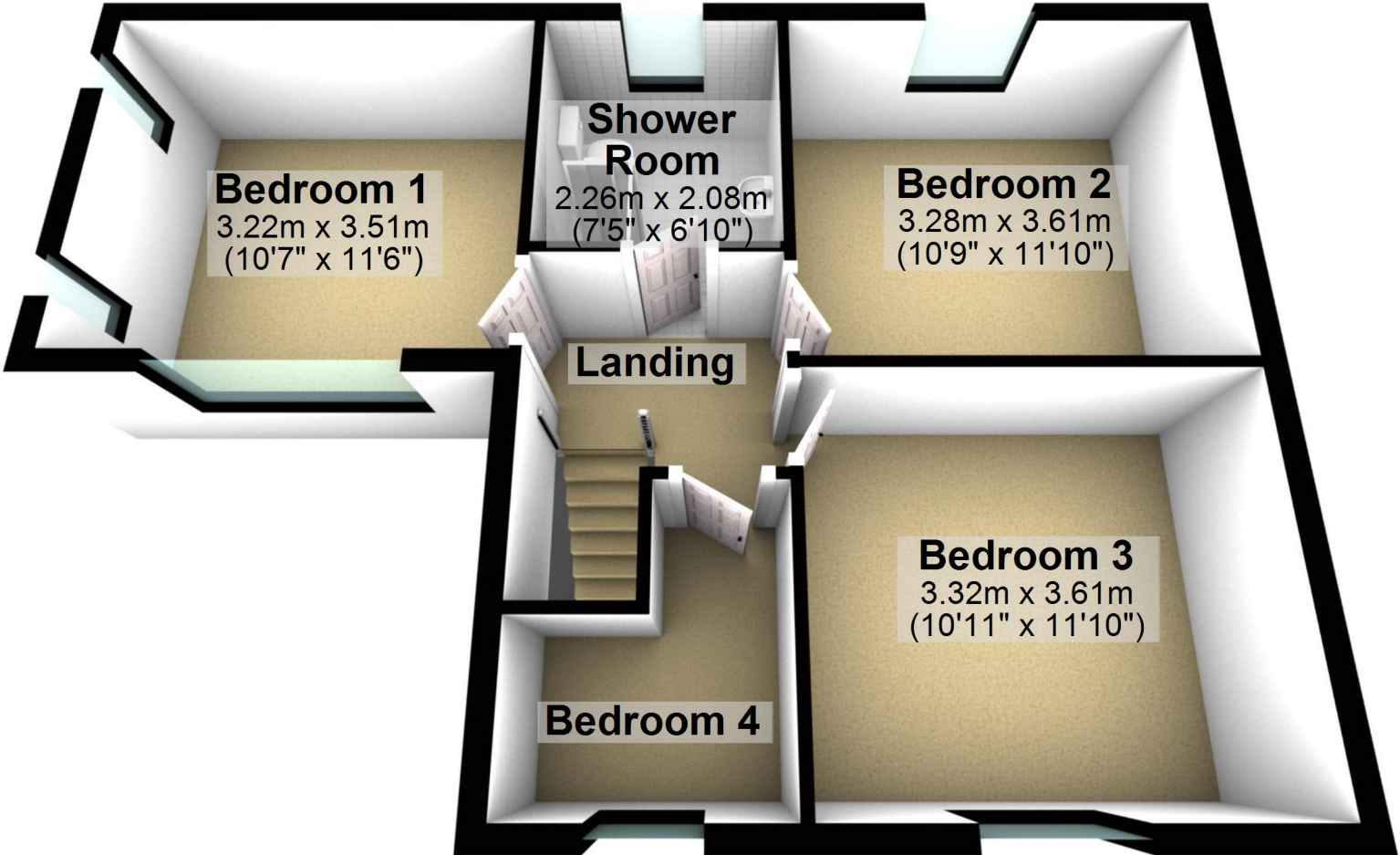

**Bedroom 1**  
3.22m x 3.51m  
(10'7" x 11'6")

**Shower Room**  
2.26m x 2.08m  
(7'5" x 6'10")

**Bedroom 2**  
3.28m x 3.61m  
(10'9" x 11'10")

**Landing**

**Bedroom 3**  
3.32m x 3.61m  
(10'11" x 11'10")

**Bedroom 4**