

# Ground Floor

Approx. 55.9 sq. metres (601.4 sq. feet)

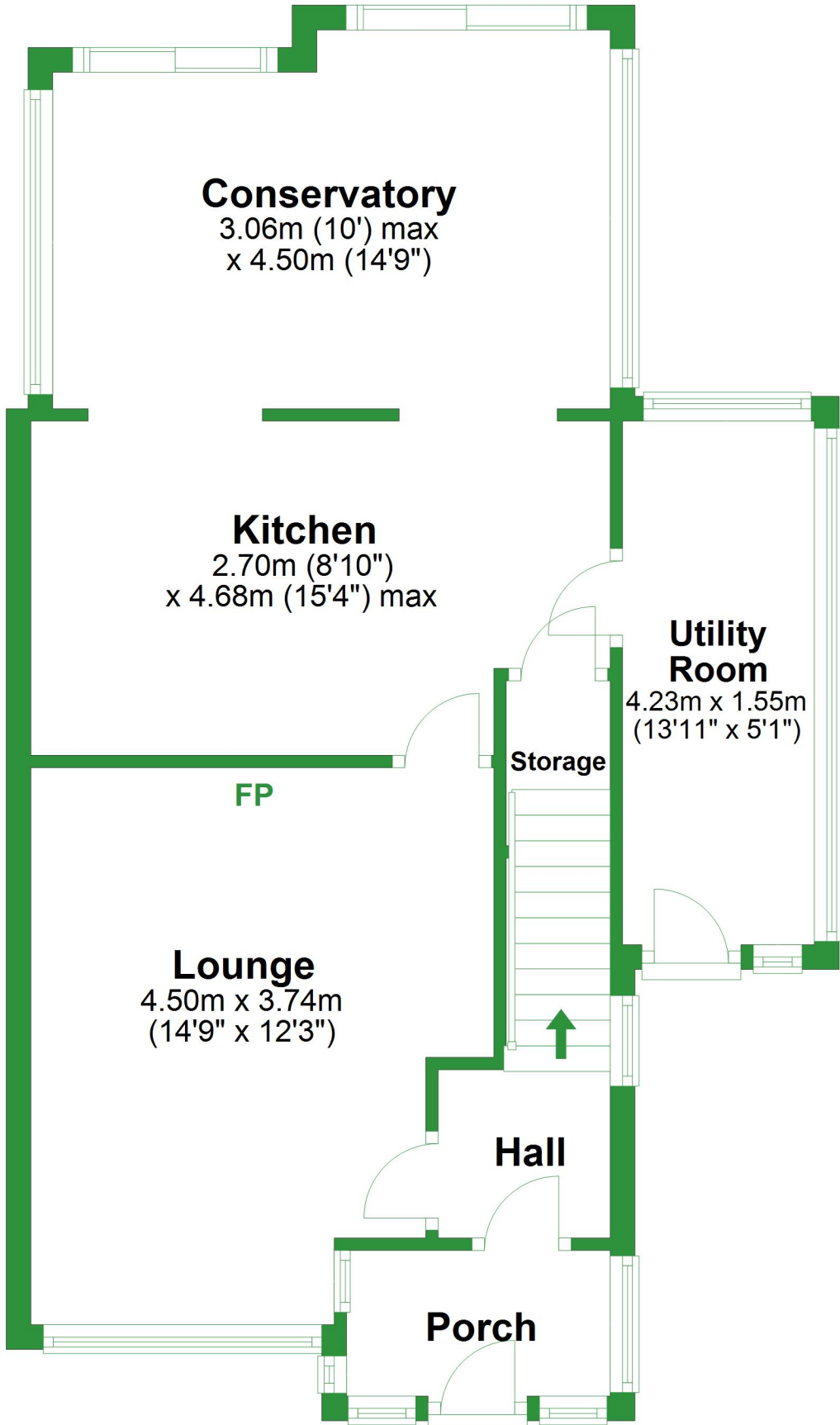

Total area: approx. 88.0 sq. metres (947.4 sq. feet)

For illustrative purposes only. Not to scale. All sizes are approximate.

Plan produced using PlanUp.

# First Floor

Approx. 32.1 sq. metres (346.0 sq. feet)

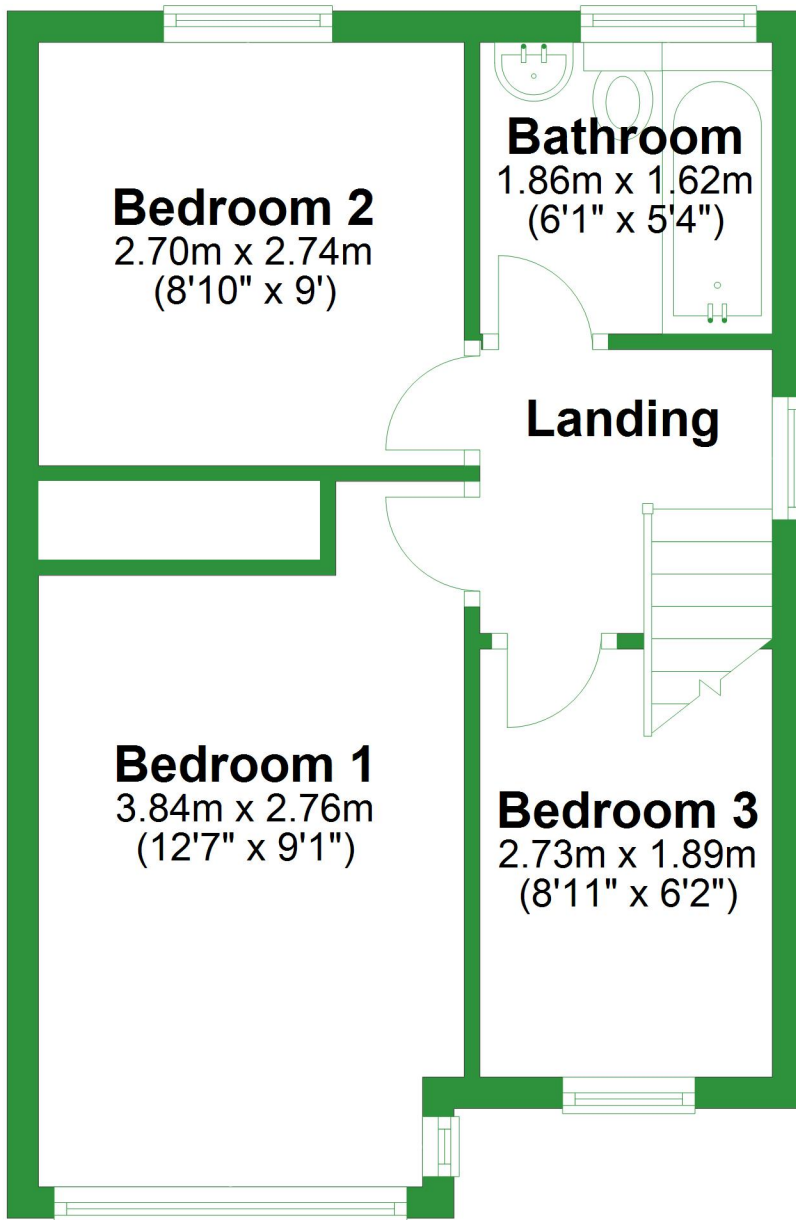

# Ground Floor

Approx. 55.9 sq. metres (601.4 sq. feet)

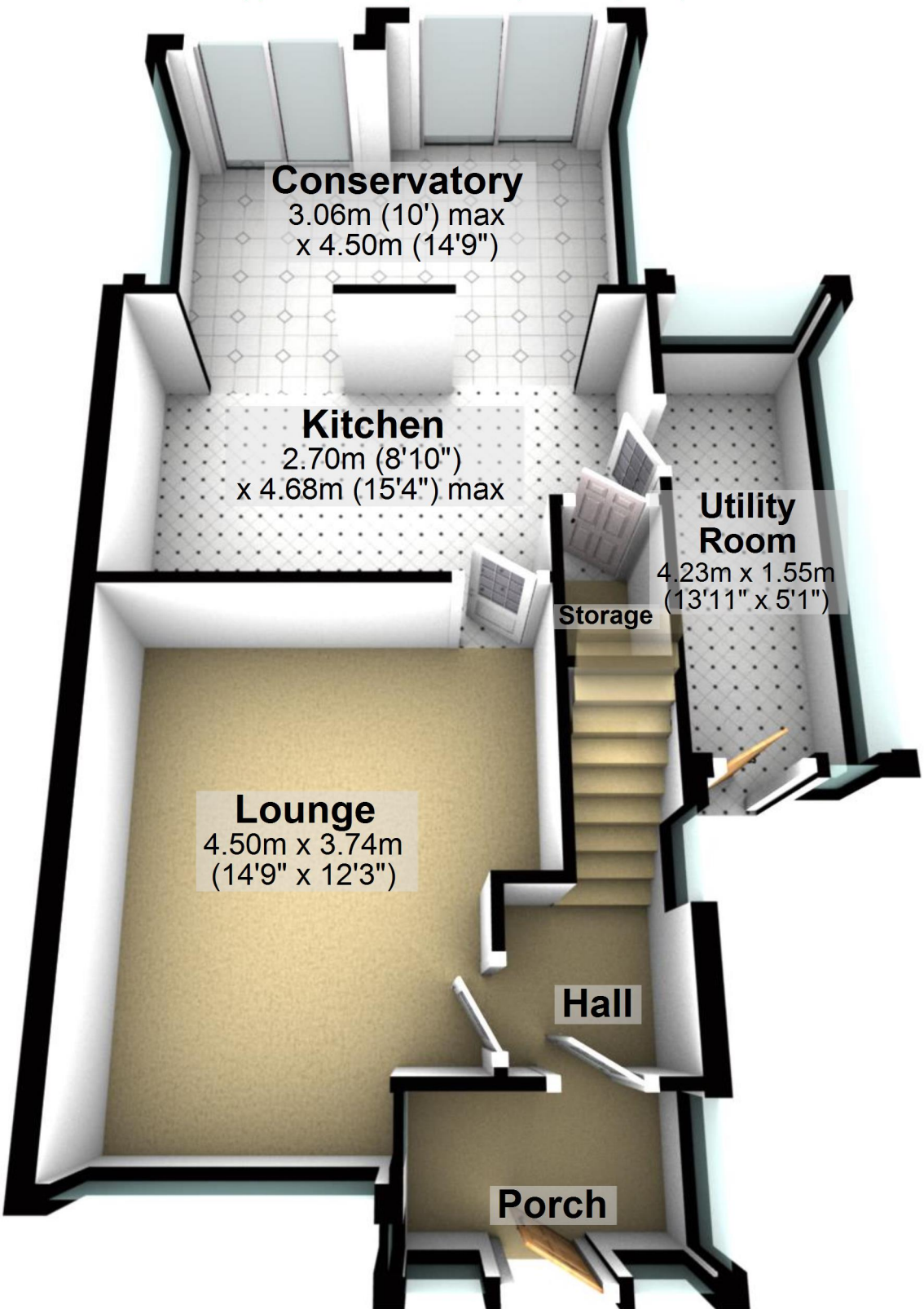

Total area: approx. 88.0 sq. metres (947.4 sq. feet)

For illustrative purposes only. Not to scale. All sizes are approximate.

Plan produced using PlanUp.

# First Floor

Approx. 32.1 sq. metres (346.0 sq. feet)

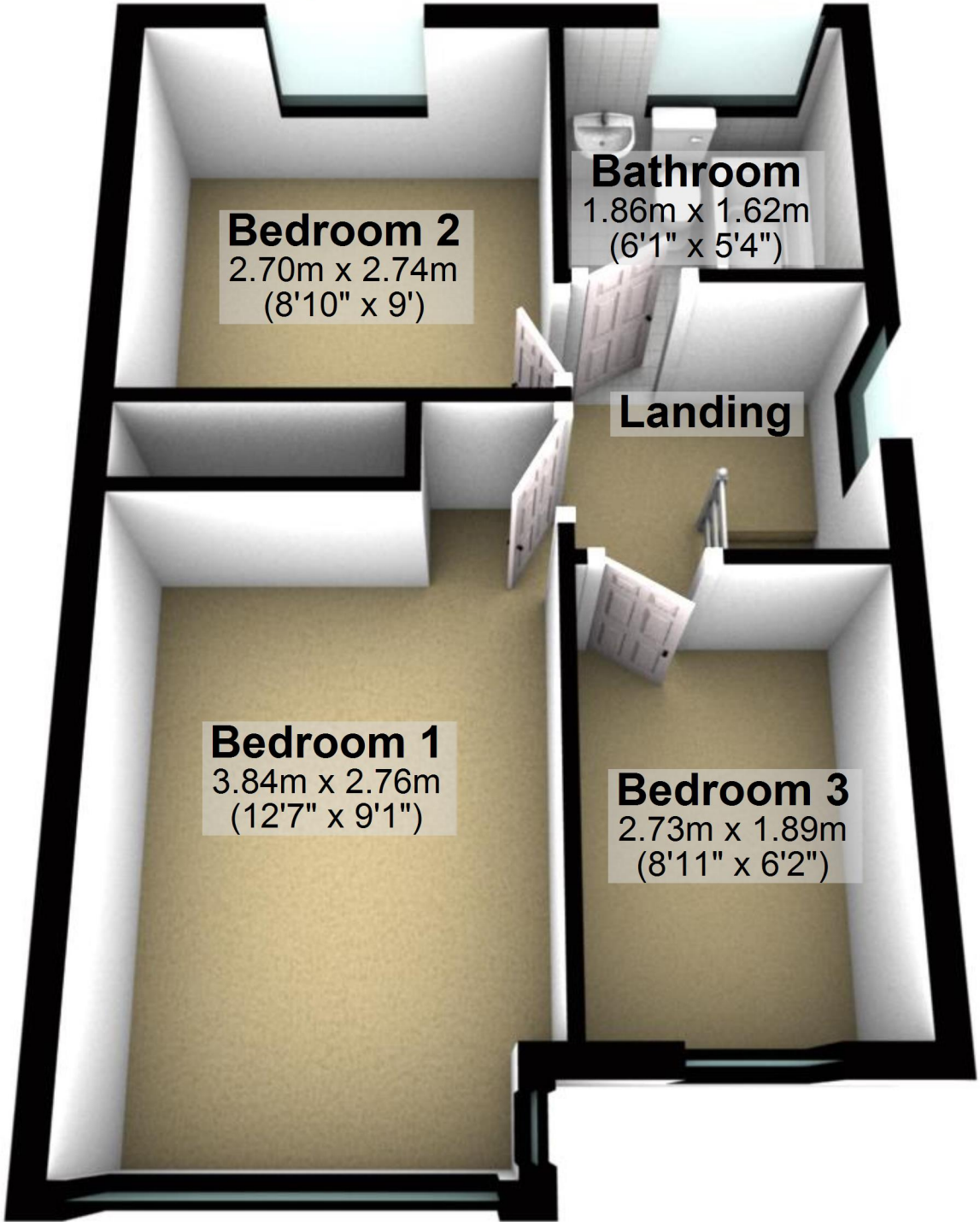

**Bedroom 2**  
2.70m x 2.74m  
(8'10" x 9')

**Bathroom**  
1.86m x 1.62m  
(6'1" x 5'4")

**Landing**

**Bedroom 1**  
3.84m x 2.76m  
(12'7" x 9'1")

**Bedroom 3**  
2.73m x 1.89m  
(8'11" x 6'2")