

Ground Floor

Approx. 113.5 sq. metres (1221.7 sq. feet)

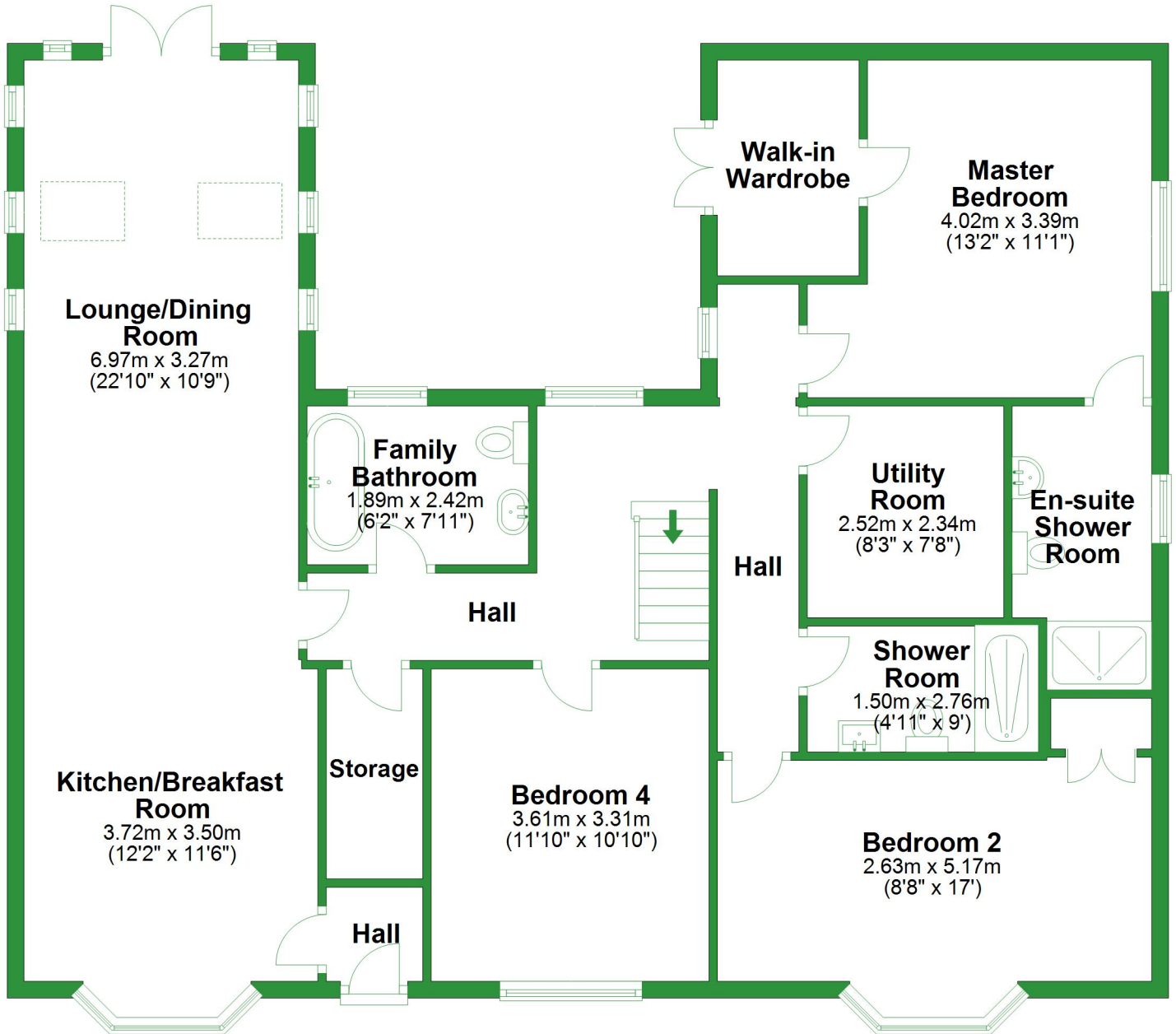

Total area: approx. 141.7 sq. metres (1525.0 sq. feet)

For illustrative purposes only. Not to scale. All sizes are approximate.
Plan produced using PlanUp.

First Floor

Approx. 28.2 sq. metres (303.3 sq. feet)

Bedroom 3
3.15m x 4.52m
(10'4" x 14'10")

**Landing /
Study**
3.15m x 3.21m
(10'4" x 10'6")

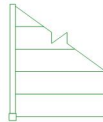

Ground Floor

Approx. 113.5 sq. metres (1221.7 sq. feet)

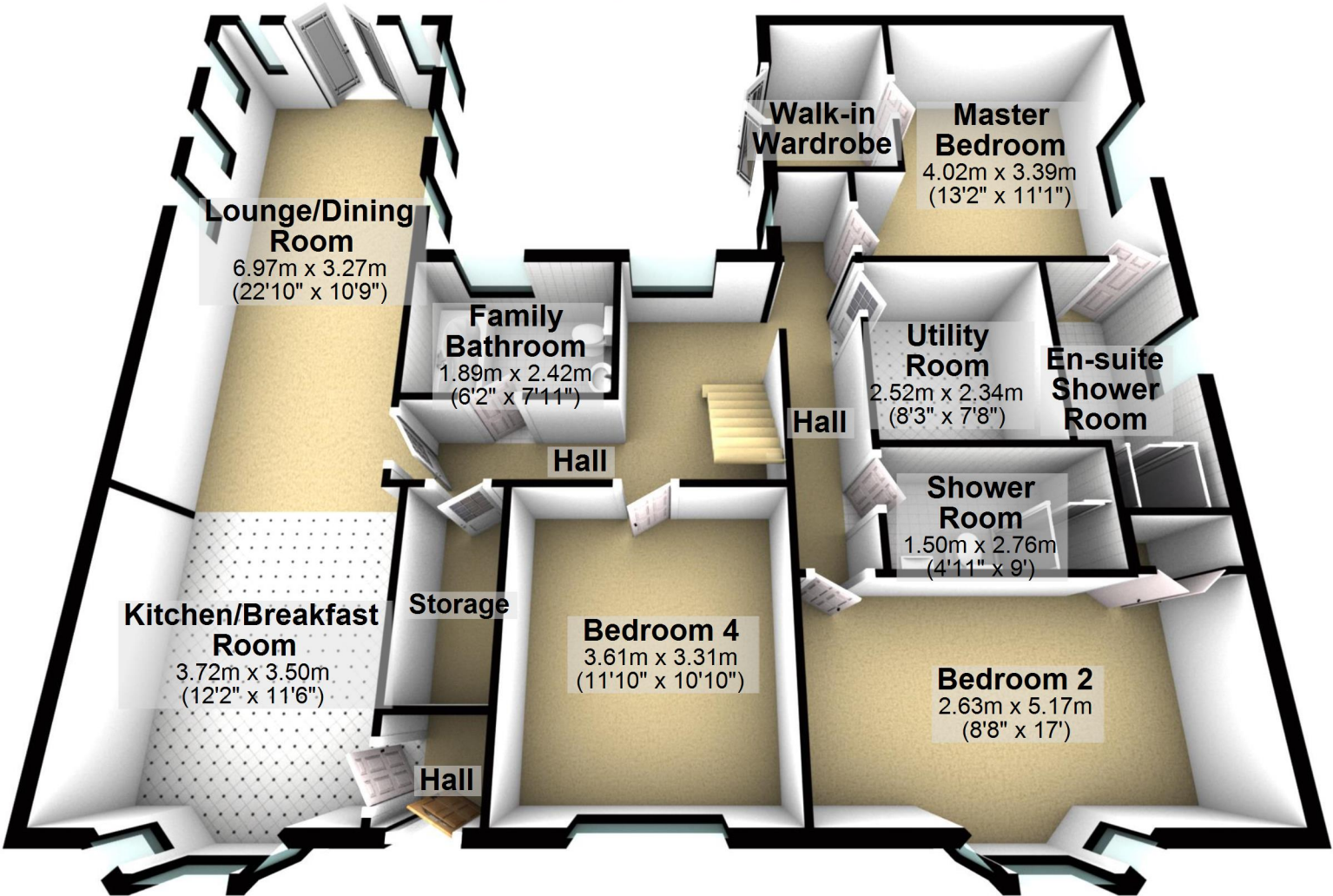

Total area: approx. 141.7 sq. metres (1525.0 sq. feet)

For illustrative purposes only. Not to scale. All sizes are approximate.

Plan produced using PlanUp.

First Floor

Approx. 28.2 sq. metres (303.3 sq. feet)

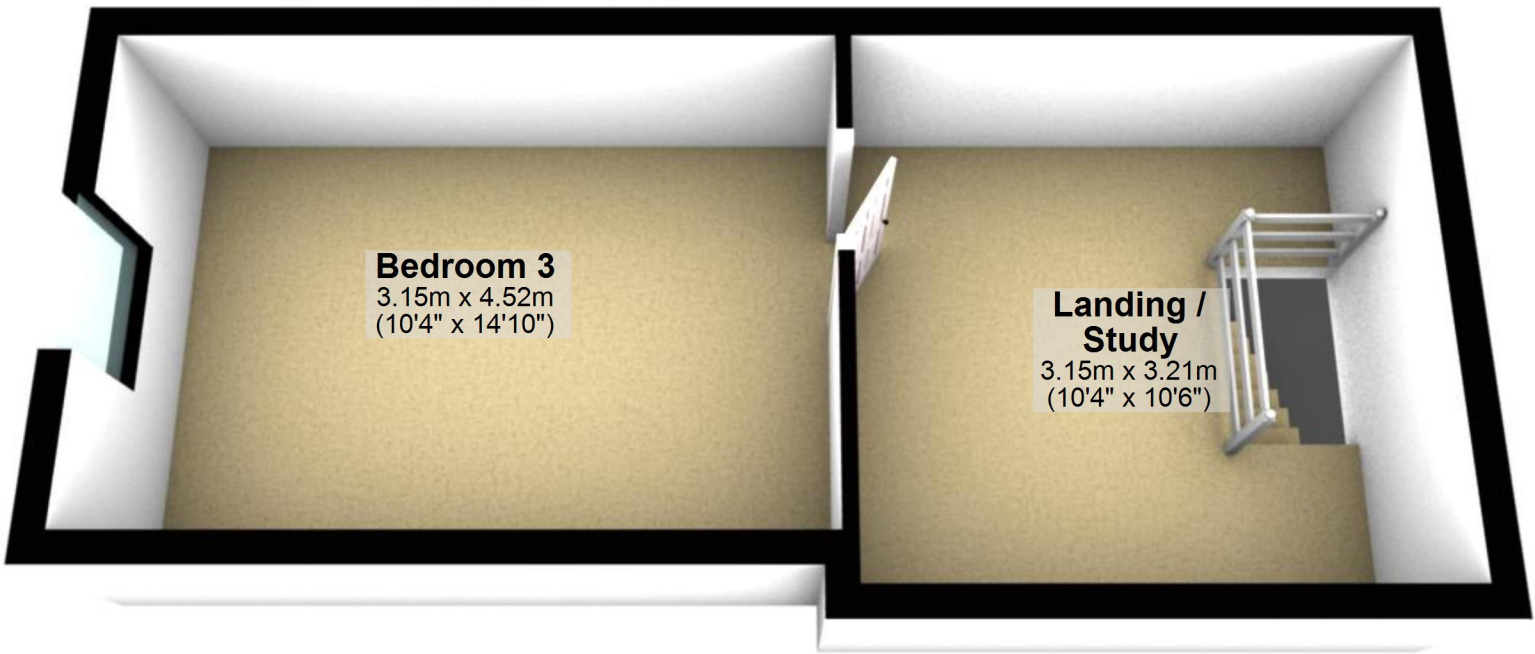

Bedroom 3
3.15m x 4.52m
(10'4" x 14'10")

A 3D architectural rendering of the first floor. The floor is a light beige color. On the left is a large room labeled 'Bedroom 3' with a window on the left wall. On the right is a smaller area labeled 'Landing / Study' with a staircase and a white railing. The walls are white, and the ceiling is also white. The entire floor plan is outlined in black.

**Landing /
Study**
3.15m x 3.21m
(10'4" x 10'6")