

## Ground Floor

Approx. 132.8 sq. metres (1429.3 sq. feet)

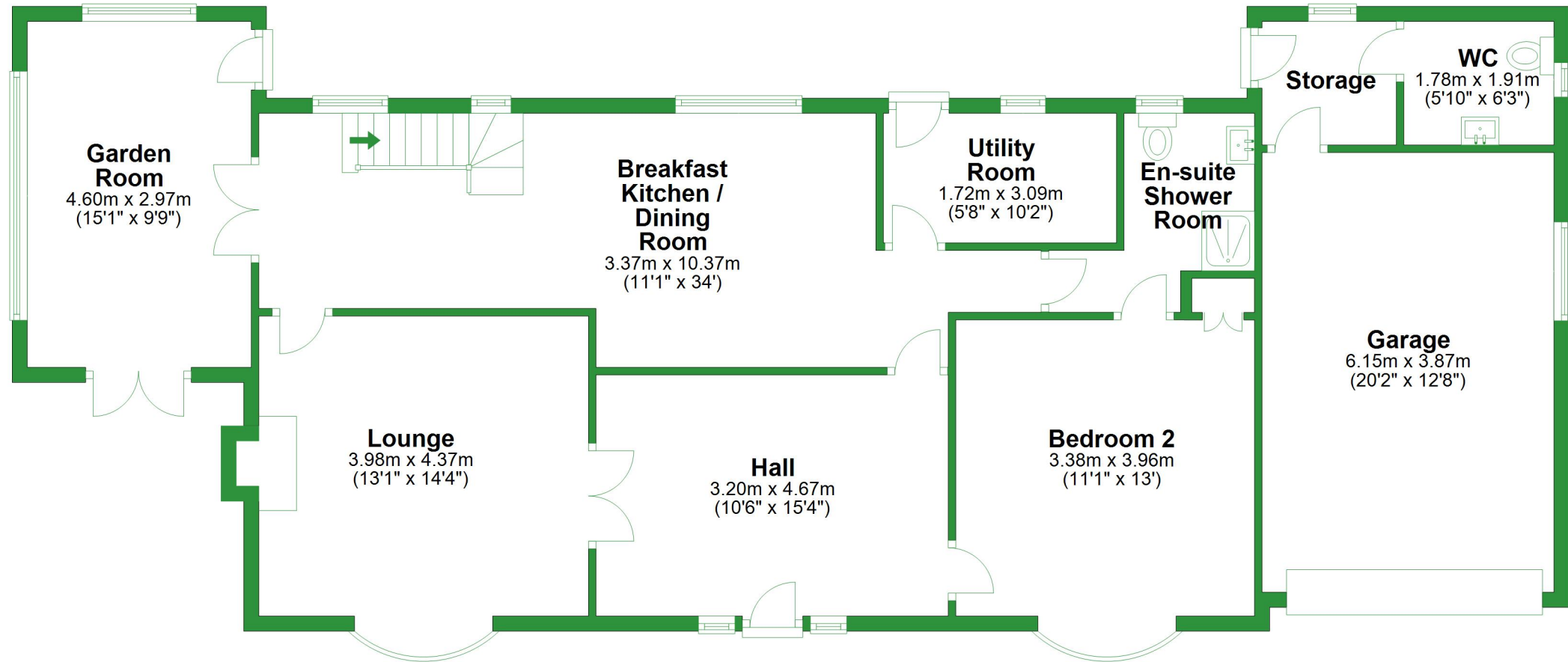

Total area: approx. 211.4 sq. metres (2275.5 sq. feet)

For illustrative purposes only. Not to scale. All sizes are approximate.  
Plan produced using PlanUp.

## First Floor

Approx. 78.6 sq. metres (846.2 sq. feet)

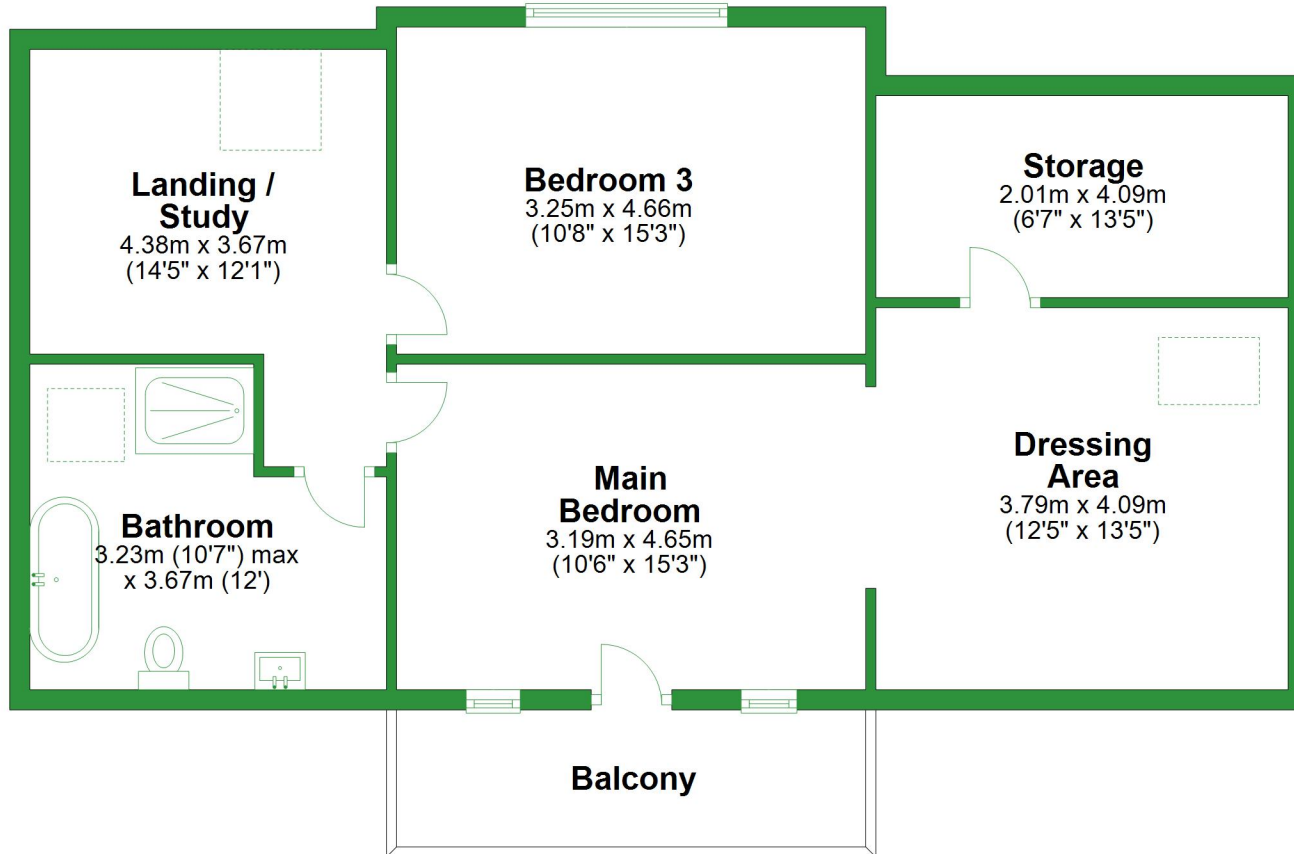

## Ground Floor

Approx. 132.8 sq. metres (1429.3 sq. feet)

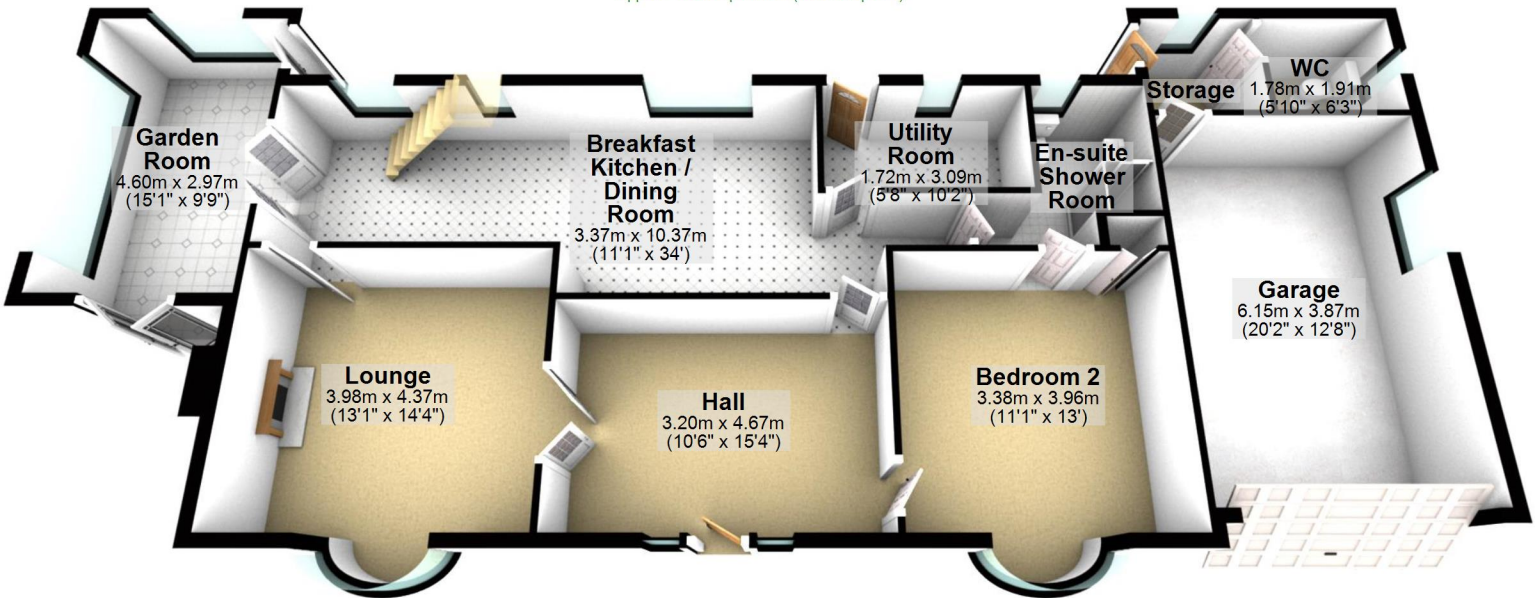

Total area: approx. 211.4 sq. metres (2275.5 sq. feet)

For illustrative purposes only. Not to scale. All sizes are approximate.

Plan produced using PlanUp.

## First Floor

Approx. 78.6 sq. metres (846.2 sq. feet)

