

# Ground Floor

Approx. 62.5 sq. metres (673.1 sq. feet)

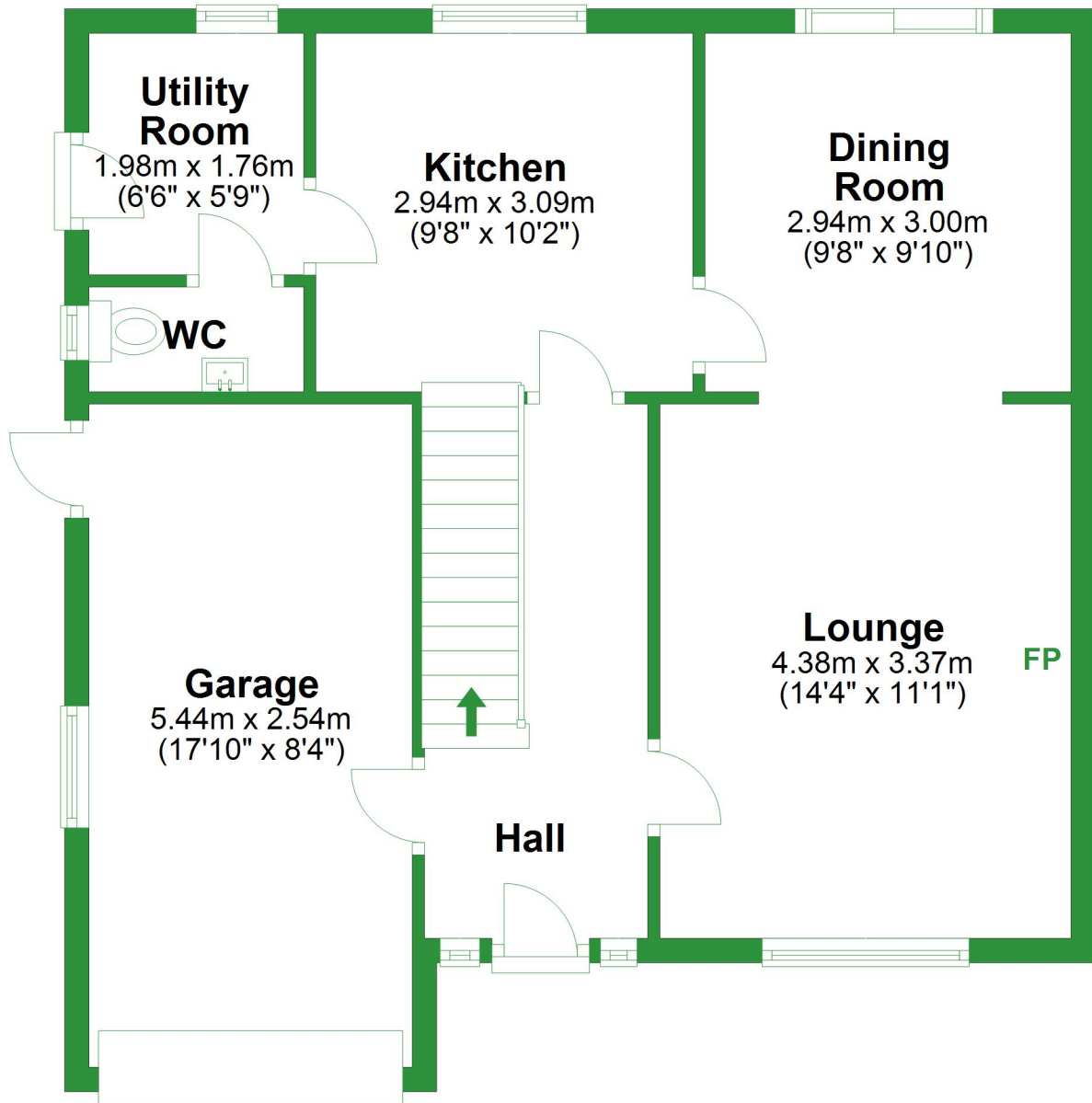

Total area: approx. 121.4 sq. metres (1306.9 sq. feet)

For illustrative purposes only. Not to scale. All sizes are approximate.

Plan produced using PlanUp.

Approx. 58.9 sq. metres (633.8 sq. feet)

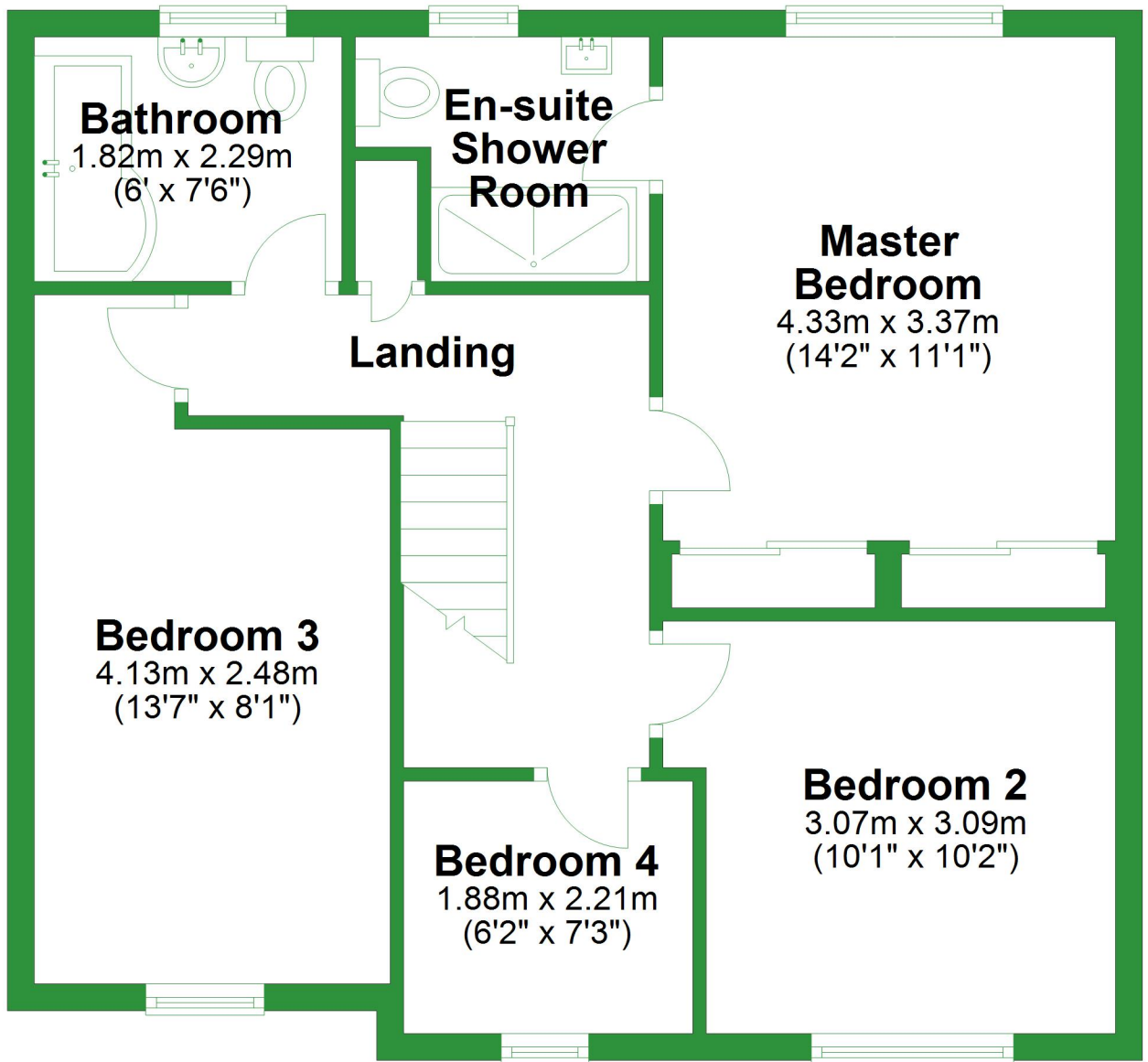

# Ground Floor

Approx. 62.5 sq. metres (673.1 sq. feet)

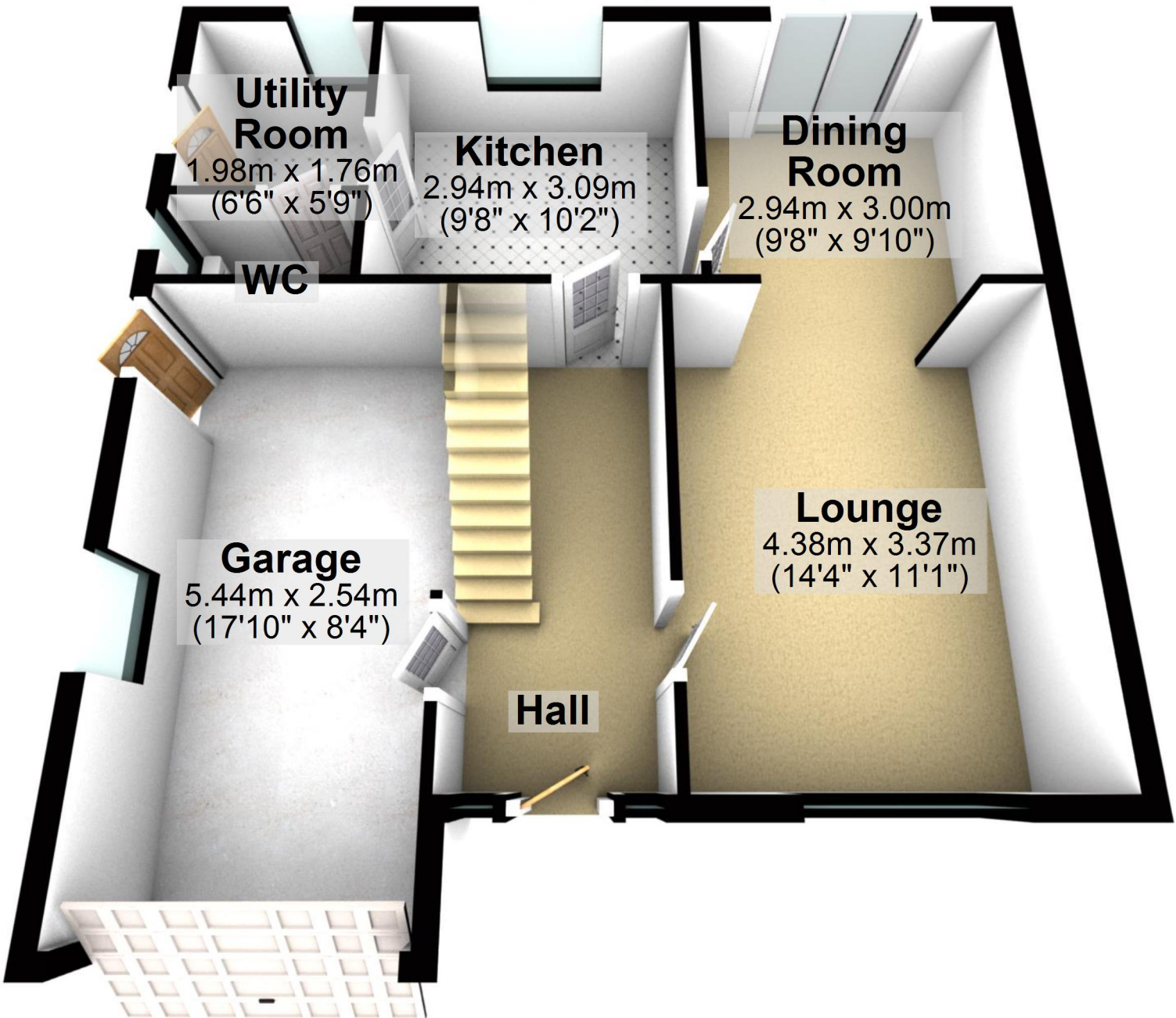

Total area: approx. 121.4 sq. metres (1306.9 sq. feet)

For illustrative purposes only. Not to scale. All sizes are approximate.

Plan produced using PlanUp.

# First Floor

Approx. 58.9 sq. metres (633.8 sq. feet)

**Bathroom**

1.82m x 2.29m  
(6' x 7'6")

**En-suite  
Shower  
Room**

**Landing**

**Master  
Bedroom**

4.33m x 3.37m  
(14'2" x 11'1")

**Bedroom 3**

4.13m x 2.48m  
(13'7" x 8'1")

**Bedroom 4**

1.88m x 2.21m  
(6'2" x 7'3")

**Bedroom 2**

3.07m x 3.09m  
(10'1" x 10'2")

